

F.A.P. RTE.	SECTION	COUNTY	TOTAL SHEETS	SHEET NO.
301	177-2 (-1A, B-1, VB-1)	STEPHENSON	386	95
STA.		TO STA.		
FED. ROAD DIST. NO.	ILLINOIS	FED. AID PROJECT		
P-92-029-02		STG-10 OF 23		
CONTRACT #64799				

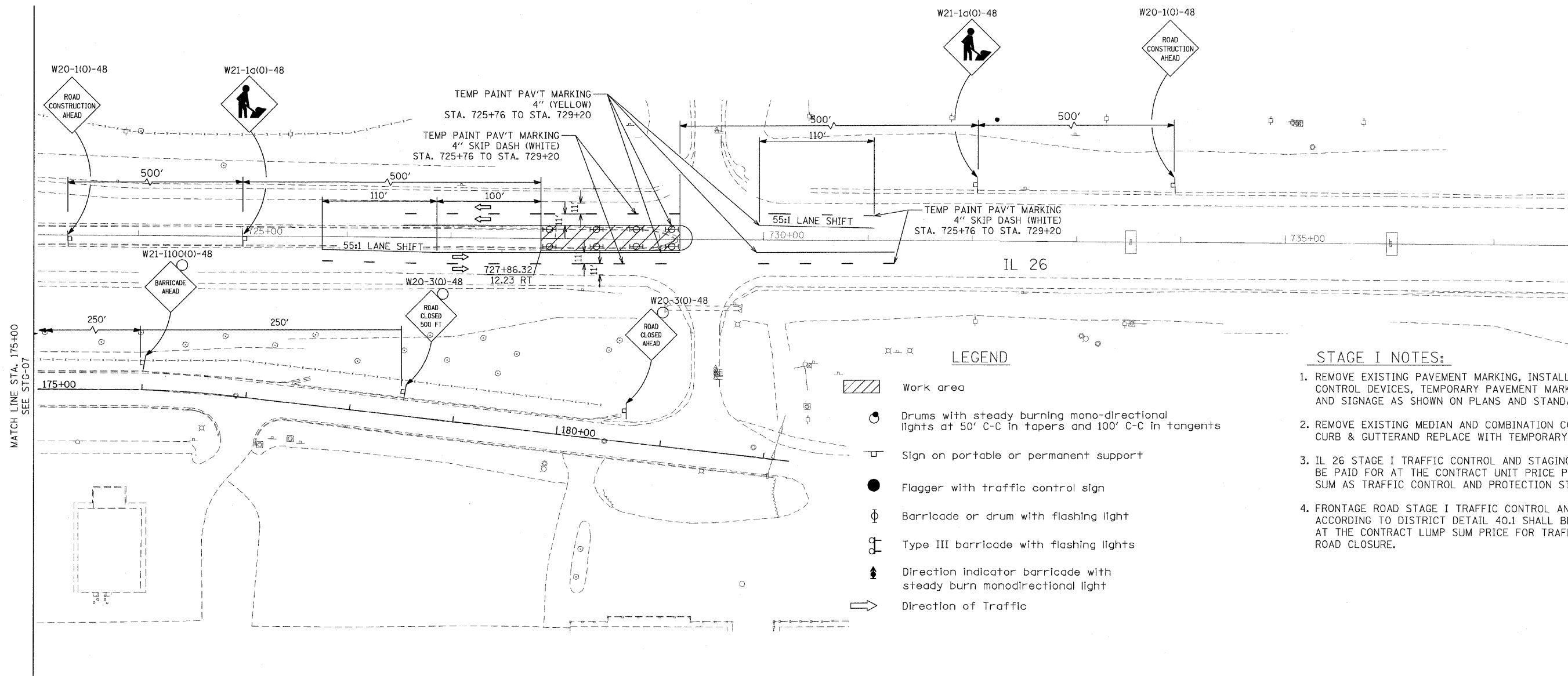

LEGEND

- Work area
- Drums with steady burning mono-directional lights at 50' C-C in tapers and 100' C-C in tangents
- Sign on portable or permanent support
- Flagger with traffic control sign
- Barricade or drum with flashing light
- Type III barricade with flashing lights
- Direction indicator barricade with steady burn monodirectional light
- Direction of Traffic

STAGE I NOTES:

1. REMOVE EXISTING PAVEMENT MARKING, INSTALL TRAFFIC CONTROL DEVICES, TEMPORARY PAVEMENT MARKING AND SIGNAGE AS SHOWN ON PLANS AND STANDARDS.
2. REMOVE EXISTING MEDIAN AND COMBINATION CONCRETE CURB & GUTTER AND REPLACE WITH TEMPORARY PAVEMENT.
3. IL 26 STAGE I TRAFFIC CONTROL AND STAGING SHALL BE PAID FOR AT THE CONTRACT UNIT PRICE PER LUMP SUM AS TRAFFIC CONTROL AND PROTECTION STANDARD 701701.
4. FRONTAGE ROAD STAGE I TRAFFIC CONTROL AND STAGING ACCORDING TO DISTRICT DETAIL 40.1 SHALL BE PAID FOR AT THE CONTRACT LUMP SUM PRICE FOR TRAFFIC CONTROL ROAD CLOSURE.

MATCH LINE STA. 175+00
SEE STG-07

STAGE I

REVISIONS	
NAME	DATE

ILLINOIS DEPARTMENT OF TRANSPORTATION
F.A.P. ROUTE 301 (US RTE. 20)
FROM BOLTON ROAD TO WEST OF IL RTE. 26

SUGGESTED TRAFFIC CONTROL
AND STAGING PLANS
FRONTAGE ROAD

SCALE: 1"=50'
DATE: 01-22-10

DRAWN BY SJV
CHECKED BY RMH

