

F.A.P. RTE.	SECTION	COUNTY	TOTAL SHEETS	SHEET NO.
301	177-2 (-1A, B-1, VB-1)	STEPHENSON	386	121
STA.	TO STA.			
FED. ROAD DIST. NO.	ILLINOIS FED. AID PROJECT			
P-92-029-02 CONTRACT #64799			DET-2 OF 4	

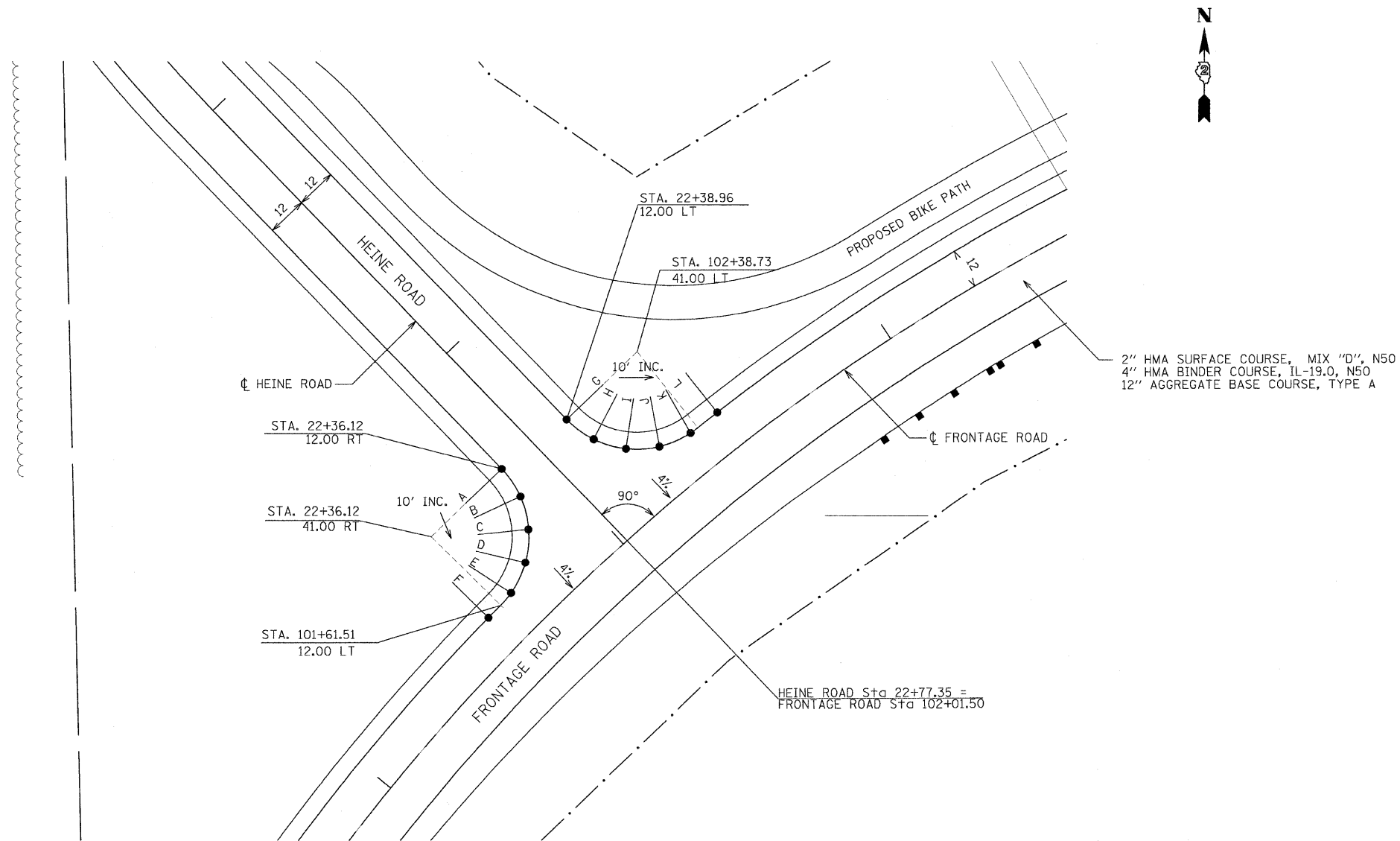

LEFT SIDE EDGE OF PAVEMENT					LEFT SIDE EDGE OF PAVEMENT				
LABEL	STATION	SLOPE FROM CL	ELEVATION	OFFSET FROM CL	LABEL	STATION	SLOPE FROM CL	ELEVATION	OFFSET FROM CL
G	22+38.96	-1.50%	765.00	12.00	A	22+36.12	-1.50%	765.06	12.00
H	22+48.78	-1.50%	764.99	13.73	B	22+45.94	-1.50%	765.00	13.71
I	22+57.45	-0.43%	765.10	18.65	C	22+54.57	-1.50%	764.91	18.74
J	22+63.92	-0.08%	765.25	26.22	D	22+61.09	-0.61%	765.01	26.24
K	102+36.13	4.00%	765.36	12.12	E	101+66.19	4.00%	765.03	12.41
L	102+45.95	4.00%	765.41	12.00	F	101+56.40	4.00%	764.97	12.00

REVISIONS	
NAME	DATE

ILLINOIS DEPARTMENT OF TRANSPORTATION
 F.A.P. ROUTE 301 (US RTE. 20)
 FROM BOLTON ROAD TO WEST OF IL RTE. 26

PAVEMENT ELEVATION DETAILS
 INTERSECTION OF HEINE ROAD
 AND FRONTAGE ROAD

SCALE: 1"=20'
 DATE: 01-22-10

DRAWN BY SJV
 CHECKED BY RMH

