

STATE OF ILLINOIS
DEPARTMENT OF TRANSPORTATION

ROUTE NO.	SECTION	COUNTY	SHEET NO.	SHEET NO.
FAP 301	177-2	STEPHENSON	386	177
FED. ROAD DIST. NO. 7	ILLINOIS	FED. AID PROJECT-		

Contract No. 64799

- Notes:
- All exposed edges shall have standard $\frac{3}{4}$ " Chamfers.
 - Space reinforcement in cap to miss anchor bolts.
 - Four steps monolithically with cap.
 - If a portion of the pier wall or concrete encasement is under water, reinforcement may be placed underwater into forms. Concrete shall be tremied according to Article 503.08 of the Standard Specifications to an elevation of 1'-0" above the water line at the time of construction.
 - For details of piles, see Sheet No. 41.

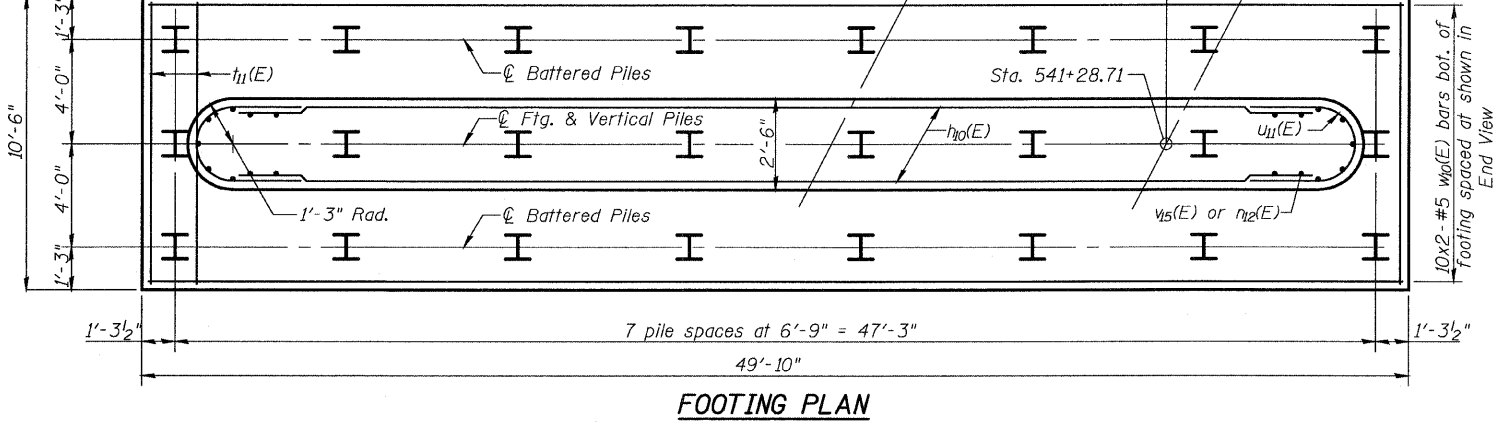
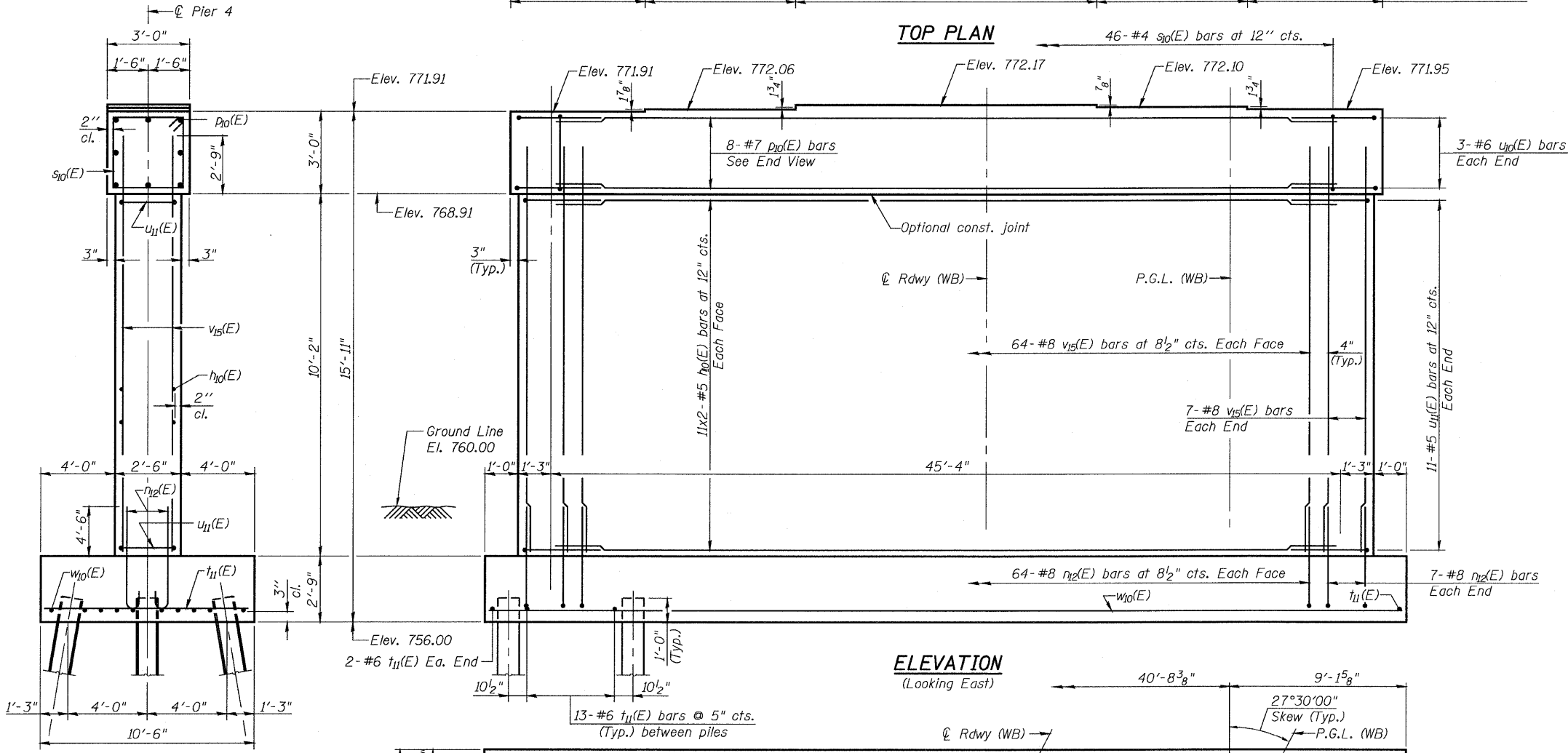
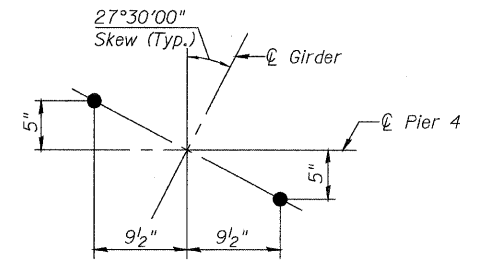
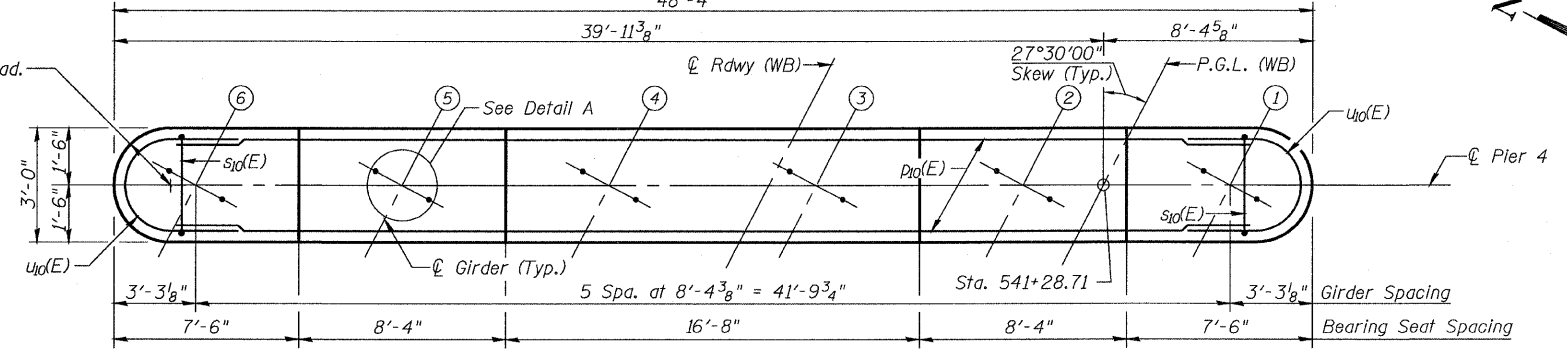

DETAIL A

BILL OF MATERIAL

Bar	No.	Size	Length	Shape
h10(E)	44	#5	23'-9"	—
n12(E)	142	#8	7'-11"	U
p10(E)	8	#7	45'-4"	—
s10(E)	46	#4	11'-5"	□
t11(E)	95	#6	10'-2"	—
u10(E)	6	#6	9'-4"	U
u11(E)	22	#5	7'-9"	U
v15(E)	142	#8	12'-11"	—
w10(E)	20	#5	26'-0"	—
Structure Excavation		Cu. Yd.	116	
Concrete Structures		Cu. Yd.	114.7	
Reinforcement Bars, Epoxy Coated		Pound	12,340	
Furnishing Steel Piles, HP 12x53		Foot	1,380	
Driving Piles		Foot	1,380	
Test Pile, HP 12x53		Each	1	
Pile Shoes		Each	23	

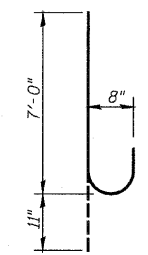

BAR n12(E)

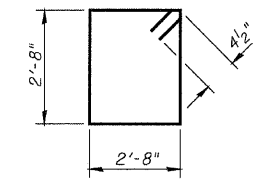

BAR s10(E)

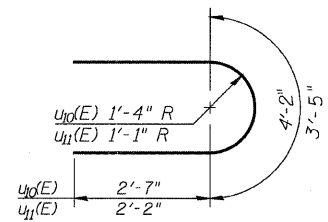

BARS u10(E) & u11(E)

MINIMUM BAR LAP

- #5 bar = 2'-2"
- #6 bar = 2'-7"
- #7 bar = 3'-5"
- #8 bar = 4'-6"

PILE DATA

Type: Steel HP 12x53 w/Pile Shoes
Nominal Required Bearing: 419 kips
Factored Resistance Available: 120 kips
Est. Length: 60 Ft.
No. Production Piles: 23
No. Test Piles: 1

PIER NO. 4
F.A.P. ROUTE 301 SECTION 177-2B-1
STEPHENSON COUNTY
STATION 540+65.71
STRUCTURE NO. 089-0082



DESIGNED	S.CHELBIAN
CHECKED	R.TINGLEY
DRAWN	D.C.PATEL
CHECKED	J.GRAINAWI

T:\16814A\Struct\Cadd\PreFinal\US20 Bridge 089-0082 (Pecatonica River Bridge)\000000-64799-000-000-037.dgn 25-JAN-2010 13:47