

INDEX OF SHEETS

- 1 COVER SHEET & HIGHWAY STANDARDS
- 2 GENERAL NOTES
- 3 SUMMARY OF QUANTITIES
- 4 TYPICAL SECTIONS
- 5 - 6 SCHEDULE OF QUANTITIES
- 7 TIE POINTS
- 8 - 15 PLAN VIEWS
- 16 - 17 DETAILS

STANDARDS

- 000001-05 STANDARD SYMBOLS, ABBREVIATIONS AND PATTERNS
- 406201-01 MAILBOX TURNOUT
- 482011-03 HMA SHOULDER STRIPS/SHOULDERS WITH RS OR WIDENING & RS PROJECTS
- 667101-01 PERMANENT SURVEY MARKERS
- 701001-02 OFF-ROAD OPERATIONS 2L, 2W, MORE THAN 15' (4.5 m) AWAY
- 701006-03 OFF-ROAD OPERATIONS 2L, 2W, 15' (4.5 m) TO 24" (600 mm) FROM PAVEMENT EDGE
- 701011-02 OFF-ROAD MOVING OPERATIONS 2L, 2W, DAY ONLY
- 701301-03 LANE CLOSURE, 2L, 2W, SHORT TIME OPERATIONS
- 701306-02 LANE CLOSURE, 2L, 2W, SLOW MOVING OPERATIONS DAY ONLY, FOR SPEEDS ≥ 45 MPH
- 701311-03 LANE CLOSURE, 2L, 2W, MOVING OPERATIONS - DAY ONLY
- 701326-03 LANE CLOSURE, 2L, 2W, PAVEMENT WIDENING, FOR SPEEDS ≥ 45 MPH
- 701901-01 TRAFFIC CONTROL DEVICES
- 780001-02 TYPICAL PAVEMENT MARKINGS
- 781001-03 TYPICAL APPLICATIONS RAISED REFLECTIVE PAVEMENT MARKERS

MICROFILMED _____
 REEL NUMBER _____
 AWARDED _____
 RESIDENT ENGINEER _____
 AS BUILT CHANGES WERE MADE
 ON THE FOLLOWING SHEETS _____

J.U.L.I.E.
 JOINT UTILITY LOCATION INFORMATION FOR EXCAVATION
 1-800-892-0123
 OR 811

PROJECT ENGINEER: CRAIG REED
UNIT CHIEF: BRAD DUNCAN
TOWNSHIP: GENOA

CONTRACT NO. 66951

STATE OF ILLINOIS
DEPARTMENT OF TRANSPORTATION
DIVISION OF HIGHWAYS
PROPOSED
HIGHWAY PLANS

FAP ROUTE 324 (IL 23)
SECTION (25)RS-4

3P MILLING & RESURFACING
IL 72 TO MCHENRY CO LINE
DEKALB COUNTY

C-93-085-09

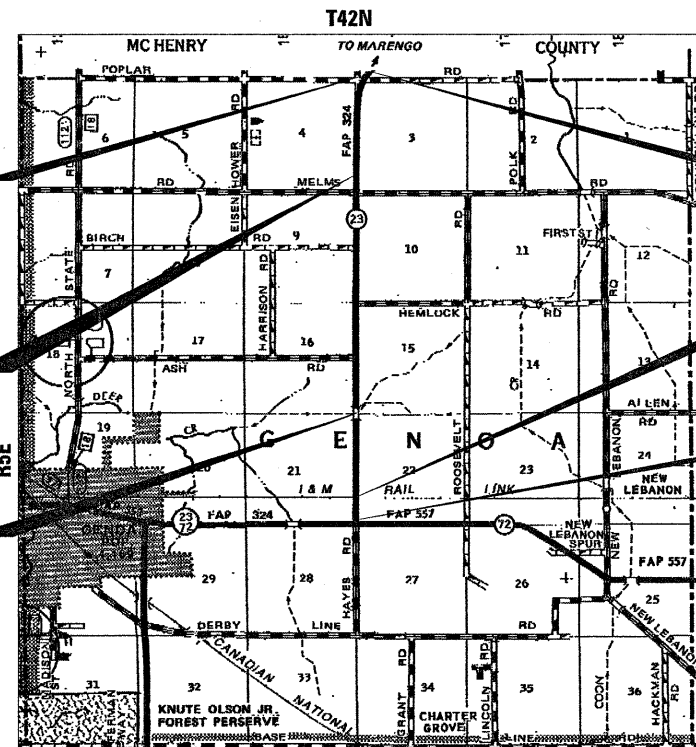

STATION EQUATION
STA. 356 + 15BK = STA. 1 + 52AH

SN 019-2551
STA. 311 + 75
6'X4' BOX CULVERT

SN 019-0035 OMISSION
STA. 196 + 77 - STA. 197 + 61

END IMPROVEMENT
STA. 6 + 23

RAILROAD OMISSION
STA. 156 + 82.5 - STA. 156 + 91.5

BEGIN IMPROVEMENT
STA. 145 + 76

GROSS LENGTH = 21510 FT. = 4.07 MILE
 NET LENGTH = 21417 FT. = 4.06 MILE

F.A.P. RTE.	SECTION	COUNTY	TOTAL SHEETS	SHEET NO.
324	(25)RS-4	DEKALB	17	1
		ILLINOIS	CONTRACT NO. 66951	

D-93-048-09



OTHER PRINCIPAL ARTERIAL (RURAL)

2009 ADT = 2900
 PV = 82% SU = 10% MU = 8%

STATE OF ILLINOIS
 DEPARTMENT OF TRANSPORTATION
 DIVISION OF HIGHWAYS

SUBMITTED January 22 20 10

George Pughon
 DEPUTY DIRECTOR OF HIGHWAYS, REGION ENGINEER

March 19, 20 10
Scott E. Scott, P.E./RD
 Acting ENGINEER OF DESIGN AND ENVIRONMENT

March 19, 20 10
Christine M. Reed RD
 DIRECTOR OF HIGHWAYS, CHIEF ENGINEER

PRINTED BY THE AUTHORITY
OF THE STATE OF ILLINOIS