

STATION	DESCRIPTION	EXIST MONUMENT TYPE	PROP MONUMENT TYPE	MONUMENT RECORD TO BE RECORDED	RESPONSIBILITY
171+00	W 1/4 SEC 22 T42N R5E (MONUMENT RECORD)	PK NAIL	TYPE 1 PSM	YES	2
223+26	E 1/4 SEC 16 T42N R5E (MONUMENT RECORD)	3/8" REBAR	TYPE 1 PSM	YES	2
329+00	W 1/4 SEC 3 T42N R5E (MONUMENT RECORD)	PK NAIL	TYPE 1 PSM	YES	2

NOTE: FOR ALL MONUMENT LOCATIONS SEE TIE SKETCHES

- 1) ENGINEER TO RE-ESTABLISH MONUMENT
- 2) RESIDENT TO RE-ESTABLISH MONUMENT AND FURNISH TIE SKETCHES TO DIST. 3 PLANS & PLANS
- 3) PROFESSIONAL LAND SURVEYOR TO RE-ESTABLISH MONUMENT, RECORD NEW MONUMENT RECORD AND PROVIDE COPY TO DIST. 3 PLATS & PLANS

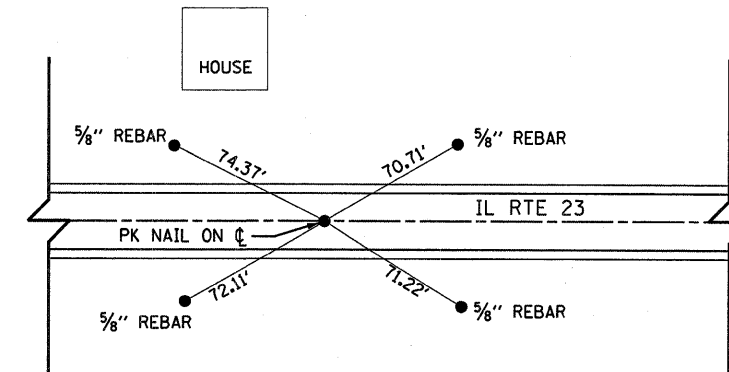

TIES TO WEST QUARTER CORNER OF SECTION 22, T.42 N., R.5E.
REPLACE WITH PERMANENT SURVEY MARKER
(APPROX. STA. 171+00)

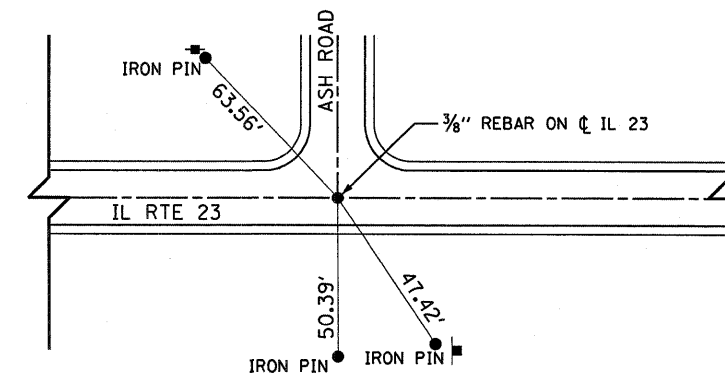

TIES TO EAST QUARTER CORNER OF SECTION 16, T.42 N., R.5E.
REPLACE WITH PERMANENT SURVEY MARKER
(APPROX. STA. 223+26)

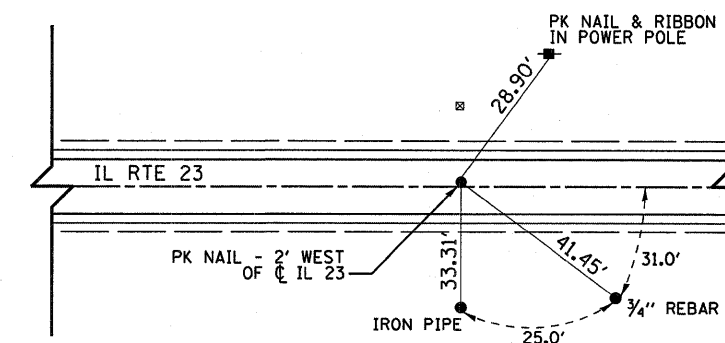

TIES TO WEST QUARTER CORNER OF SECTION 3, T.42 N., R.5E.
REPLACE WITH PERMANENT SURVEY MARKER
(APPROX. STA. 329+00)

FILE NAME =	USER NAME = duncenbd	DESIGNED -	REVISED -
ci:\pw_work\VPWIDOT\DUNCANBD\0129029\d366951-ahf-cover.dgn		DRAWN -	REVISED -
		CHECKED -	REVISED -
		DATE -	REVISED -

STATE OF ILLINOIS
DEPARTMENT OF TRANSPORTATION

TIE POINTS				F.A.P. RTE.	SECTION	COUNTY	TOTAL SHEETS	SHEET NO.
SCALE: N.T.S.	SHEET NO.	OF	SHEETS	324	(25)RS-4	DEKALB	17	7
STA.	TO STA.			FED. ROAD DIST. NO.		ILLINOIS FED. AID PROJECT		
						CONTRACT NO. 66951		