

**INDEX OF SHEETS**

- 1 COVER SHEET & HIGHWAY STANDARDS
- 2 GENERAL NOTES
- 3 SUMMARY OF QUANTITIES
- 4 TYPICAL SECTIONS
- 5 - 6 SCHEDULE OF QUANTITIES
- 7 TIE POINTS
- 8 - 15 PLAN VIEWS
- 16 - 17 DETAILS

**STANDARDS**

- 000001-05 STANDARD SYMBOLS, ABBREVIATIONS AND PATTERNS
- 406201-01 MAILBOX TURNOUT
- 482011-03 HMA SHOULDER STRIPS/SHOULDERS WITH RS OR WIDENING & RS PROJECTS
- 667101-01 PERMANENT SURVEY MARKERS
- 701001-02 OFF-ROAD OPERATIONS 2L, 2W, MORE THAN 15' (4.5 m) AWAY
- 701006-03 OFF-ROAD OPERATIONS 2L, 2W, 15' (4.5 m) TO 24" (600 mm) FROM PAVEMENT EDGE
- 701011-02 OFF-ROAD MOVING OPERATIONS 2L, 2W, DAY ONLY
- 701301-03 LANE CLOSURE, 2L, 2W, SHORT TIME OPERATIONS
- 701306-02 LANE CLOSURE, 2L, 2W, SLOW MOVING OPERATIONS DAY ONLY, FOR SPEEDS ≥ 45 MPH
- 701311-03 LANE CLOSURE, 2L, 2W, MOVING OPERATIONS - DAY ONLY
- 701326-03 LANE CLOSURE, 2L, 2W, PAVEMENT WIDENING, FOR SPEEDS ≥ 45 MPH
- 701901-01 TRAFFIC CONTROL DEVICES
- 780001-02 TYPICAL PAVEMENT MARKINGS
- 781001-03 TYPICAL APPLICATIONS RAISED REFLECTIVE PAVEMENT MARKERS

MICROFILMED \_\_\_\_\_  
 REEL NUMBER \_\_\_\_\_  
 AWARDED \_\_\_\_\_  
 RESIDENT ENGINEER \_\_\_\_\_  
 AS BUILT CHANGES WERE MADE  
 ON THE FOLLOWING SHEETS \_\_\_\_\_

**J.U.L.I.E.**  
 JOINT UTILITY LOCATION INFORMATION FOR EXCAVATION  
 1-800-892-0123  
 OR 811

**PROJECT ENGINEER: CRAIG REED**  
**UNIT CHIEF: BRAD DUNCAN**  
**TOWNSHIP: GENOA**

**CONTRACT NO. 66951**

**STATE OF ILLINOIS**  
**DEPARTMENT OF TRANSPORTATION**  
**DIVISION OF HIGHWAYS**  
**PROPOSED**  
**HIGHWAY PLANS**

**FAP ROUTE 324 (IL 23)**  
**SECTION (25)RS-4**

**3P MILLING & RESURFACING**  
**IL 72 TO MCHENRY CO LINE**  
**DEKALB COUNTY**

**C-93-085-09**

F.A.P. RTE.	SECTION	COUNTY	TOTAL SHEETS	SHEET NO.
324	(25)RS-4	DEKALB	17	1
		ILLINOIS	CONTRACT NO. 66951	

**D-93-048-09**

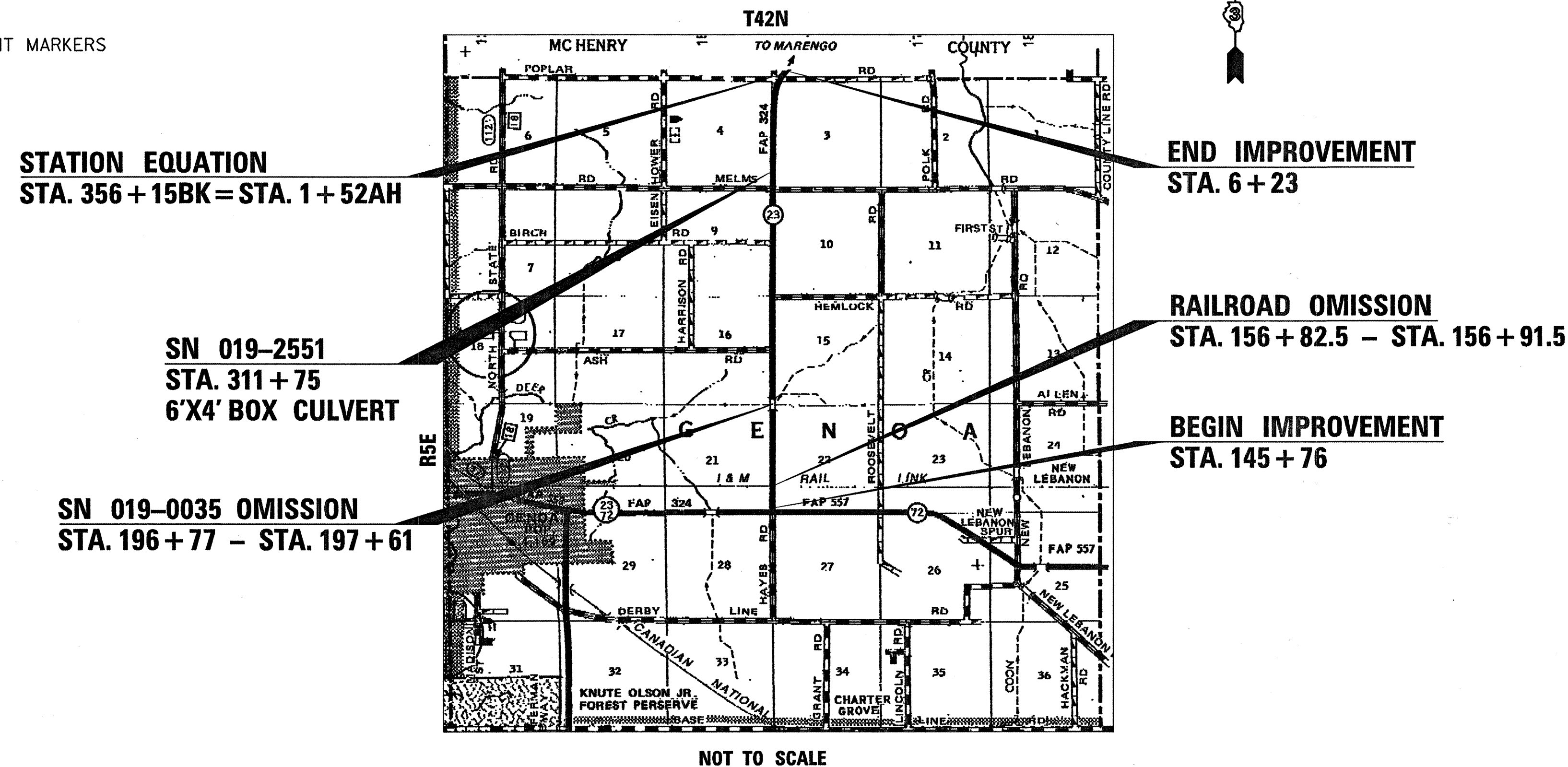

GROSS LENGTH = 21510 FT. = 4.07 MILE  
 NET LENGTH = 21417 FT. = 4.06 MILE

**OTHER PRINCIPAL ARTERIAL (RURAL)**  
 2009 ADT = 2900  
 PV = 82% SU = 10% MU = 8%

STATE OF ILLINOIS  
 DEPARTMENT OF TRANSPORTATION  
 DIVISION OF HIGHWAYS

SUBMITTED January 22 20 10

George Pyman  
 DEPUTY DIRECTOR OF HIGHWAYS, REGION ENGINEER

March 19, 20 10  
Scott E. Smith, P.E./RD  
 Acting ENGINEER OF DESIGN AND ENVIRONMENT

March 19, 20 10  
Christine M. Reed/RD  
 DIRECTOR OF HIGHWAYS, CHIEF ENGINEER

**PRINTED BY THE AUTHORITY**  
**OF THE STATE OF ILLINOIS**

**GENERAL NOTES**

THE THICKNESS OF HMA SHOWN ON THE PLANS IS THE NOMINAL THICKNESS. DEVIATIONS FROM THE NOMINAL THICKNESS WILL BE PERMITTED WHEN SUCH DEVIATIONS OCCUR DUE TO IRREGULARITIES IN THE EXISTING SURFACE OR BASE ON WHICH THE HMA IS PLACED.

THE HMA SURFACE OF ALL MAILBOX TURNOUTS, PRIVATE ENTRANCES, COMMERCIAL ENTRANCES, AND SIDE ROADS SHALL BE MADE NEATLY, IN A WORKMANLIKE MANNER, AND SHALL ACCURATELY CONFORM TO THE SHAPES AND DIMENSIONS SHOWN ON THE PLAN DETAILS. IF REQUIRED BY THE ENGINEER, THE CONTRACTOR SHALL BE REQUIRED TO SAW CUT THE HMA SURFACE TO CONFORM TO THE SHAPES AND DIMENSIONS SHOWN ON THE PLAN DETAILS. THIS WORK SHALL BE INCLUDED IN THE COST OF THE HMA SURFACE.

THE ENGINEER WILL BE THE SOLE JUDGE CONCERNING CURING TIME FOR THE VARIOUS HMA LIFTS.

SEEDING SHALL NOT BE PERMITTED AT ANY TIME WHEN THE GROUND IS FROZEN, WET, OR IN AN UNTILLABLE CONDITION. LOCATIONS TO BE SEEDED WILL BE DETERMINED BY THE ENGINEER.

ON EXISTING PAVEMENT WHICH MAY BE SUPERELEVATED, THE NEW HMA PAVEMENT SHALL BE BUILT WITH THE SAME SUPERELEVATION UNLESS NEW SUPERELEVATION RATES ARE GIVEN ON THE PLANS.

ANY REFERENCE TO A STANDARD IN THESE PLANS SHALL BE INTERPRETED TO MEAN THE EDITION AS INDICATED BY THE SUBNUMBER SHOWN IN THE LIST OF STANDARDS OR THE COPY INCLUDED IN THESE PLANS.

THE FOLLOWING RATES OF APPLICATION HAVE BEEN USED IN CALCULATING PLAN QUANTITIES:

GRANULAR MATERIALS	2.05	TONS / CU YD
BIT MATERIALS (PRIME COAT) ON AGGREGATE BASES	0.375	GAL / SQ YD
BITUMINOUS MATERIALS (PRIME COAT)	0.08	GAL / SQ YD
FOR ADDITIONAL HMA LIFTS "FOG COAT"	0.05	GAL / SQ YD
AGGREGATE PRIME COAT	0.002	TONS / SQ YD
HMA RESURFACING	112	LBS / SQ YD / IN
SHORT TERM PAVEMENT MARKING	10	FT / 100 FT OF APPLICATION
MIX FOR CRACKS, JTS & FLGWYS	0.0003	TONS / SQ YD
LEVEL BINDER (HAND METHOD)	0.0005	TONS / SQ YD

THE CONTRACTOR SHALL CONTACT JULIE AT LEAST 48 HOURS PRIOR TO EXCAVATION TO DETERMINE WHICH UTILITIES ARE IN THE AREA.

STATE OF ILLINOIS  
DEPARTMENT OF TRANSPORTATION  
DISTRICT THREE

PREPARED BY: *David Brown*  
*ACTING* DISTRICT STUDIES & PLANS ENGINEER

DATE: 01/22/10

EXAMINED BY: *Hubert K...*  
DISTRICT CONSTRUCTION ENGINEER

*Steph...*  
DISTRICT MATERIALS ENGINEER

*...*  
DISTRICT OPERATIONS ENGINEER

FILE NAME =	USER NAME = duncanbd	DESIGNED -	REVISED -	<b>STATE OF ILLINOIS DEPARTMENT OF TRANSPORTATION</b>	<b>GENERAL NOTES</b>	F.A.P. RTE.	SECTION	COUNTY	TOTAL SHEETS	SHEET NO.
ct:\pw\work\VPWIDOT\DUNCANBD\0129029\d36951-shr-cover.dgn	DRAWN -	REVISED -	324			(25)RS-4	DEKALB	17	2	
PLOT SCALE = 50.0000 ' / IN.	CHECKED -	REVISED -	CONTRACT NO. 66951							
PLOT DATE = Jan 19, 2010 - 10:53:20 AM	DATE -	REVISED -	SCALE:			SHEET NO. OF SHEETS	STA. TO STA.	ILLINOIS FED. AID PROJECT		

**SUMMARY OF QUANTITIES**

CODE NO.	ITEM	CONSTRUCTION CODE TYPE:		100% STATE ROADWAY
		UNIT	TOTAL QUANTITY	
20200600	EXCAVATING AND GRADING EXISTING SHOULDER	UNIT	422	422
20400800	FURNISHED EXCAVATION	CU YD	15	15
25100630	EROSION CONTROL BLANKET	SQ YD	227	227
40600100	BITUMINOUS MATERIALS (PRIME COAT)	GALLON	9463	9463
40600300	AGGREGATE (PRIME COAT)	TON	146	146
40600400	MIXTURE FOR CRACKS, JOINTS, AND FLANGEWAYS	TON	17	17
40600525	LEVELING BINDER (HAND METHOD), N50	TON	29	29
40600625	LEVELING BINDER (MACHINE METHOD), N50	TON	2998	2998
40600895	CONSTRUCTING TEST STRIP	EACH	1	1
40600990	TEMPORARY RAMP	SQ YD	221	221
40603310	HOT-MIX ASPHALT SURFACE COURSE, MIX "C", N50	TON	5997	5997
40800050	INCIDENTAL HOT-MIX ASPHALT SURFACING	TON	270	270
44000157	HOT-MIX ASPHALT SURFACE REMOVAL, 2"	SQ YD	59384	59384
48203021	HOT-MIX ASPHALT SHOULDERS, 6"	SQ YD	14064	14064
66700205	PERMANENT SURVEY MARKERS, TYPE I	EACH	3	3
67000400	ENGINEER'S FIELD OFFICE, TYPE A	CAL MO	2	2
67100100	MOBILIZATION	L SUM	1	1
70100460	TRAFFIC CONTROL AND PROTECTION, STANDARD 701306	L SUM	1	1
70100500	TRAFFIC CONTROL AND PROTECTION, STANDARD 701326	L SUM	1	1
70103815	TRAFFIC CONTROL SURVEILLANCE	CAL DA	5	5
70300100	SHORT-TERM PAVEMENT MARKING	FOOT	9015	9015
70300210	TEMPORARY PAVEMENT MARKING - LETTERS AND SYMBOLS	SQ FT	244.8	244.8
70300220	TEMPORARY PAVEMENT MARKING - LINE 4"	FOOT	9524	9524
70300240	TEMPORARY PAVEMENT MARKING - LINE 6"	FOOT	10520	10520
70300280	TEMPORARY PAVEMENT MARKING - LINE 24"	FOOT	144	144
70301000	WORK ZONE PAVEMENT MARKING REMOVAL	SQ FT	992	992
* 78000100	THERMOPLASTIC PAVEMENT MARKING - LETTERS AND SYMBOLS	SQ FT	122.4	122.4
* 78000650	THERMOPLASTIC PAVEMENT MARKING - LINE 24"	FOOT	72	72
* 78001110	PAINT PAVEMENT MARKING - LINE 4"	FOOT	47614	47614
* 78001130	PAINT PAVEMENT MARKING - LINE 6"	FOOT	5260	5260
* 78100100	RAISED REFLECTIVE PAVEMENT MARKER	EACH	268	268
78300200	RAISED REFLECTIVE PAVEMENT MARKER REMOVAL	EACH	214	214
X0322729	MATERIAL TRANSFER DEVICE	TON	5997	5997
Z0048665	RAILROAD PROTECTIVE LIABILITY INSURANCE	L SUM	1	1

\* SPECIALTY ITEMS

REV.

FILE NAME =	USER NAME = duncanbd	DESIGNED -	REVISED -	<b>STATE OF ILLINOIS DEPARTMENT OF TRANSPORTATION</b>	<b>SUMMARY OF QUANTITIES</b>				F.A.P. RTE.	SECTION	COUNTY	TOTAL SHEETS	SHEET NO.
es:\pwork\PWIDOT\DUNCANBD\0129029\d386951-shit-cover.dgn		DRAWN -	REVISED -		324	(25)RS-4	DEKALB	17	3				
PLOT SCALE = 50.0000' / IN.		CHECKED -	REVISED -		SCALE: SHEET NO. OF SHEETS STA. TO STA.				ILLINOIS FED. AID PROJECT				
PLOT DATE = Jan 19, 2010 - 10:45:48 AM		DATE -	REVISED -						CONTRACT NO. 66951				

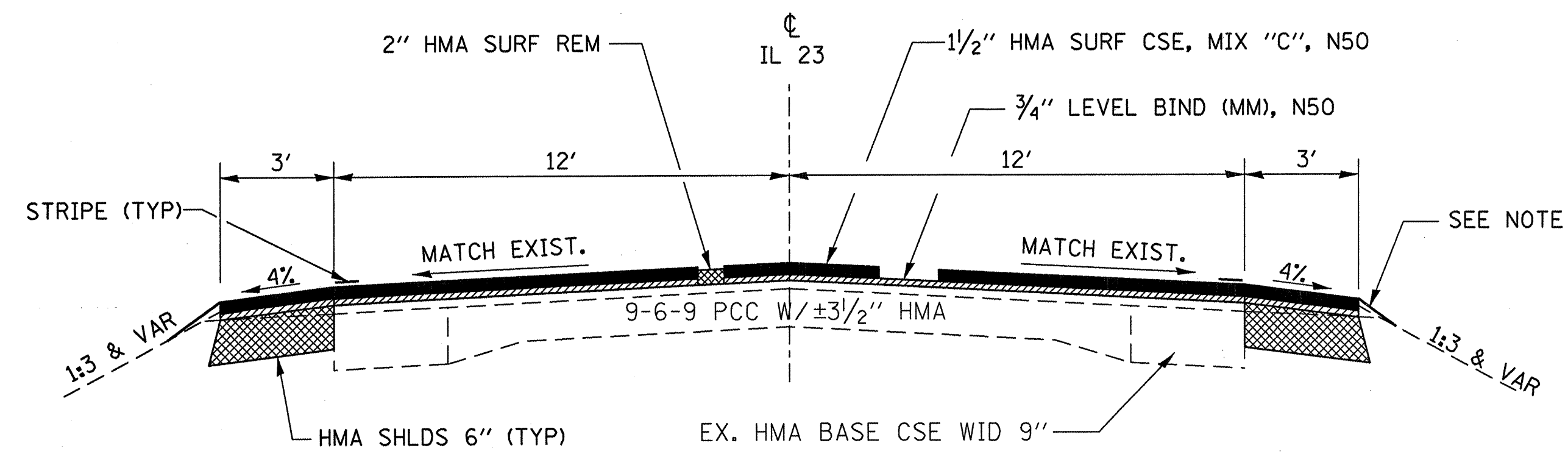

### TYPICAL SECTION

STA. 145+46 TO STA. 349+73.6

NOTE: USE EXCAVATED MATERIAL AT LOCATIONS WHERE PROPOSED HMA IS EXPOSED AS DIRECTED BY THE ENGINEER. THIS WORK TO BE INCLUDED IN THE COST OF EXCAVATING AND GRADING EXISTING SHOULDER. DISPOSAL OF SURPLUS MATERIALS SHALL BE IN ACCORDANCE TO SECTION 202 OF THE STANDARD SPECIFICATIONS.

### MIXTURE TABLE

	HMA SURFACE	HMA LEVEL BINDER	INCIDENTAL HMA SURFACE	HMA SHOULDERS
PG GRADE	PG64-22	PG64-22	PG64-22	PG58-22
DESIGN AIR VOIDS	4.0% @ N50	4.0% @ N50	4.0% @ N50	2.0% @ N30
MIXTURE COMPOSITION	IL 12.5 OR IL 9.5	IL 9.5	IL 12.5 OR IL 9.5	IL 19.0
FRICTION AGGREGATE	MIXTURE C		MIXTURE C	
DENSITY TEST METHOD	CORRELATION	SATISFACTION OF ENGINEER	SATISFACTION OF ENGINEER	CORES*

\* MATERIAL SHALL BE COMPACTED TO 93.0-97.4 PERCENT OF THE MAXIMUM THEORETICAL DENSITY, EXCEPT THAT WHEN PLACED AS FIRST LIFT ON AN UNIMPROVED SUBGRADE THE MINIMUM PERCENT COMPACTION SHALL BE 92.0 PERCENT. THE MAXIMUM THEORETICAL DENSITY SHALL BE DETERMINED FROM THE MOVING AVERAGE AS SPECIFIED IN THE QC/QA SPECIFICATION.

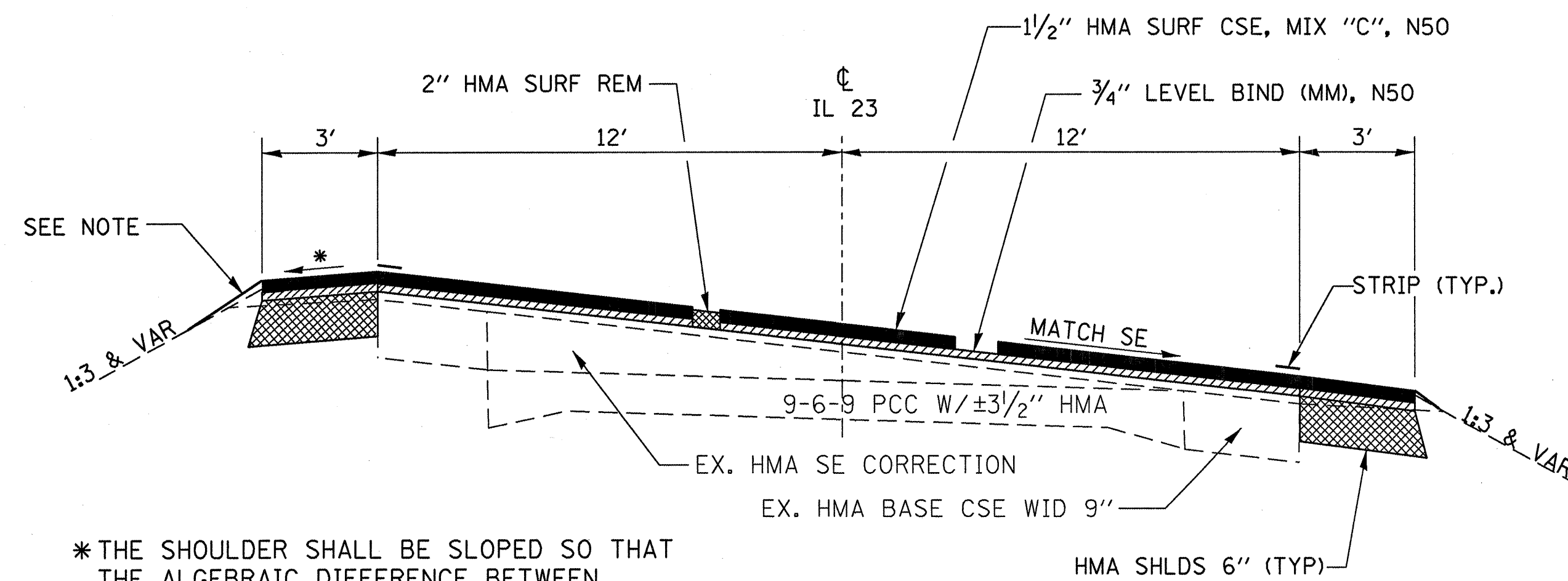

### TYPICAL SECTION

STA. 349+73.6 TO STA. 6+23

STATION EQUATION: STA. 356+15 BK = 1+52 AH

FILE NAME =	USER NAME = duncanbd	DESIGNED -	REVISED -	<b>STATE OF ILLINOIS DEPARTMENT OF TRANSPORTATION</b>	<b>TYPICAL SECTIONS</b>			F.A.P. RTE.	SECTION	COUNTY	TOTAL SHEETS	SHEET NO.
ca\pwwork\PWIDOT\DUNCANBD\129029\d36951-sht-cover.dgn		DRAWN -	REVISED -		324	(25)RS-4	DEKALB	17	4			
PLOT SCALE = 50.0000' / IN.		CHECKED -	REVISED -		CONTRACT NO. 66951							
PLOT DATE = Jan 19, 2010 - 10:44:59 AM		DATE -	REVISED -		ILLINOIS FED. AID PROJECT							
				SCALE:	SHEET NO.	OF	SHEETS	STA.	TO STA.			

MAINLINE PAVING SCHEDULE											
STA. TO STA.	LENGTH	WIDTH	AREA	HMA SURF REM 2"	HMA SURF CSE MIX C N50	LEV BIND (MM) N50	BIT MAT PRIME COAT	AGG. PRIME COAT	MIX JTS CRACKS. & FLANGEWAYS	LEV BIND (HM), N50	TEMP RAMP
	FT	FT	SQ YD	SQ YD	TONS	TONS	GALLONS	TONS	TONS	TONS	SQ YD
145+76 - 156+82.5	1106.5	30	3688.3	2950.7	309.82	154.91	479.48	7.38	0.89	1.48	35.58
156+82.5 - 156+91.5	RAILROAD OMISSION										
156+91.5 - 196+77	3985.5	30	13285.0	10628.0	1115.94	557.97	1727.05	26.57	3.19	5.31	35.58
196+77 - 197+61	BRIDGE OMISSION										
197+61 - 356+15 BK	15854	30	52846.7	42277.3	4439.12	2219.56	6870.07	105.69	12.68	21.14	17.79
1+52 AH - 6+23	471	30	1570.0	1256.0	131.88	65.94	204.10	3.14	0.38	0.63	17.79
TOTAL			71390.0	57112	5997	2998	9281	143	17	29	107

MCHENRY COUNTY LINE = 355+18

SHOULDER SCHEDULE						
STATION TO STATION	SIDE	WIDTH	LENGTH	AREA	EXC & GRAD EXIST SHOULDER	HMA SHLDS 6"
		FT	FT	SQ YD	UNIT	SQ YD
145+76 - 156+82.5	LT & RT	3	1106.50	737.67	22.1	737.67
156+91.5 - 195+74	RT	3	3882.50	1294.17	38.8	1294.17
156+91.5 - 196+85.6	LT	3	3994.10	1331.37	39.9	1331.37
198+63 - 249+43	RT	3	5080.00	1693.33	50.8	1693.33
197+48 - 222+98	LT	3	2550.00	850.00	25.5	850.00
223+54 - 275+87	LT	3	5233.00	1744.33	52.3	1744.33
249+99 - 302+22	RT	3	5223.00	1741.00	52.2	1741.00
276+43 - 302+22	LT	3	2579.00	859.67	25.8	859.67
302+78 - 354+92	RT	3	5214.00	1738.00	52.1	1738.00
302+78 - 354+32	LT	3	5154.00	1718.00	51.5	1718.00
355+56 - 356+15 BK	RT	3	59.00	19.67	0.6	19.67
355+46 - 356+15 BK	LT	3	69.00	23.00	0.7	23.00
1+52 AH - 6+23	LT & RT	3	471.00	314.00	9.4	314.00
TOTAL				14064	422	14064

SIDEROAD & ENTRANCES SCHEDULE											
MAINLINE STATION	SIDE	LOCATION	TYPE	AREA	HMA SURF REM 2"	INC HMA SURF	AGG. PRIME COAT	TEMP. RAMPS	BIT. MAT. PR. CT.	FURN EXC	EROS CONT BLANK
				SQ YD	SQ YD	TONS	TONS	SQ YD	GALLON	CU YD	SQ YD
146+80	LT	CE	HMA	58.90	58.90	7.01			4.71		
171+10	RT	MBTO	HMA	43.30	43.30	5.15			3.46		
171+19	LT	PE	HMA	46.60	46.60	5.55			3.73		
171+71	RT	PE W/MB	HMA	68.20	68.20	8.12			5.46		
181+33	LT	PE	HMA	46.60	46.60	5.55			3.73		
182+22	RT	MBTO	HMA	43.30	43.30	5.15			3.46		
182+70	LT	PE	HMA	46.60	46.60	5.55			3.73		
206+65	RT	PE W/MB	HMA	68.20	68.20	8.12			5.46		
206+76	LT	PE	HMA	46.60	46.60	5.55			3.73		
222+27	LT	PE	HMA	46.60	46.60	5.55			3.73		
223+26	LT	ASH ROAD	HMA	116.20	116.20	13.83	0.23	16.30	9.30	2	30
235+10	RT	PE W/MB	HMA	68.20	68.20	8.12			5.46		
236+57	RT	PE/CE	HMA	58.90	58.90	7.01			4.71		
249+71	RT	HEMLOCK ROAD	HMA	116.20	116.20	13.83	0.23	16.30	9.30	2	30
268+05	RT	PE	HMA	46.60	46.60	5.55			3.73		
276+15	LT	BIRCH ROAD	HMA	116.20	116.20	13.83	0.23	16.30	9.30	2	30
296+61	LT	PE W/MB	HMA	68.20	68.20	8.12			5.46		
302+50	LT	MELMS ROAD	HMA	116.20	116.20	13.83	0.23	16.30	9.30	2	30
302+50	RT	MELMS ROAD	HMA	116.20	116.20	13.83	0.23	16.30	9.30	2	30
306+20	LT	PE	HMA	46.60	46.60	5.55			3.73		
306+20	RT	MBTO	HMA	43.30	43.30	5.15			3.46		
317+83	LT	PE	HMA	46.60	46.60	5.55			3.73		
317+83	RT	MBTO	HMA	43.30	43.30	5.15			3.46		
332+04	RT	PE W/MB	HMA	68.20	68.20	8.12			5.46		
355+18	LT	POPLAR ROAD	HMA	536.90	536.90	63.89	1.07	16.30	42.95	3	47
355+18	RT	POPLAR ROAD	HMA	149.20	149.20	17.75	0.30	16.30	11.94	2	30
TOTAL				2272	2272	270	2.5	114	182	15	227

FILE NAME =	USER NAME = duncanbd	DESIGNED -	REVISED -	<b>STATE OF ILLINOIS DEPARTMENT OF TRANSPORTATION</b>	<b>SCHEDULE OF QUANTITIES</b>				F.A.P. RTE.	SECTION	COUNTY	TOTAL SHEETS	SHEET NO.
ca:\pw_work\PWIDOT\DUNCANBD\d0129029\d36951-shr-cover.dgn		DRAWN -	REVISED -						324	(25)RS-4	DEKALB	17	5
PLOT SCALE = 50.0000' / IN.		CHECKED -	REVISED -		SCALE:	SHEET NO.	OF	SHEETS	STA.	TO STA.	ILLINOIS FED. AID PROJECT CONTRACT NO. 66951		
PLOT DATE = Jan 19, 2010 - 10:45:04 AM		DATE -	REVISED -										

PAVEMENT MARKINGS										
STA. TO STA.	PAINT		THERMOPLASTIC		RAISED REFL PAVT MARK EACH	TEMPORARY PAINT			SHORT TERM (3 APP) FOOT	
	4"		6"			LETTERS & SYMBOLS SQ FT	LETTERS & SYMBOLS			
	YELLOW FOOT	WHITE FOOT	YELLOW FOOT	WHITE FOOT			(2 APPLICATIONS) FOOT FOOT FOOT SQ FT			
145+76 - 152+10										
CENTERLINE			160			8		300		189
EDGELINE		1268								
152+10 - 156+87										
CENTERLINE			120			6		240		144
NO PASSING ZONE	477						954			
EDGELINE		954								
RAILROAD				36	61.2				72	122.4
156+87 - 161+64										
CENTERLINE			120			6		240		144
NO PASSING ZONE	477						954			
EDGELINE		954								
RAILROAD				36	61.2				72	122.4
161+64 - 196+77										
CENTERLINE			880			44		1760		1053
EDGELINE		7026								
197+61 - 324+03										
CENTERLINE			3160			158		6320		3792
EDGELINE		25284								
324+03 - 331+42										
CENTERLINE			190					380		222
EDGELINE		1478				9				
NO PASSING ZONE	739						1478			
331+42 - 334+06										
CENTERLINE			60			4		120		78
EDGELINE		528								
334+06 - 341+98										
CENTERLINE			200			10		380		237
NO PASSING ZONE	792						1584			
EDGELINE		1584								
341+98 - 342+50										
CENTERLINE			20					40		15
EDGELINE		104								
342+50 - 352+54										
CENTERLINE			250			13		500		300
NO PASSING ZONE	1004						2008			
EDGELINE		2008								
352+54 - 356+15 BK										
NO PASSING ZONE	722					4	1444			108
EDGELINE		722								
1+52 AH - 2+32										
NO PASSING ZONE	160					1	320			24
EDGELINE		160								
2+32 - 6+23										
CENTERLINE			100			5		200		117
NO PASSING ZONE	391						782			
EDGELINE		782								
TOTAL	4762	42852	5260	72	122.4	268	9524	10520	144	244.8

FILE NAME =	USER NAME = duncanbd	DESIGNED -	REVISED -	<b>STATE OF ILLINOIS DEPARTMENT OF TRANSPORTATION</b>	<b>SCHEDULE OF QUANTITIES</b>			F.A.P. RTE.	SECTION	COUNTY	TOTAL SHEETS	SHEET NO.
ci:\pw\work\PWIDOT\DUNCANBD\0129029\0366951-sht-cover.dgn	PLOT SCALE = 50.0000' / IN.	DRAWN -	REVISED -					324	(25)RS-4	DEKALB	17	6
PLOT DATE = Jan 19, 2010 - 10:45:12 AM	DATE -	CHECKED -	REVISED -		SCALE:	SHEET NO.	OF	SHEETS	STA.	TO STA.	CONTRACT NO. 66951	
											ILLINOIS FED. AID PROJECT	

STATION	DESCRIPTION	EXIST MONUMENT TYPE	PROP MONUMENT TYPE	MONUMENT RECORD TO BE RECORDED	RESPONSIBILITY
171±00	W 1/4 SEC 22 T42N R5E (MONUMENT RECORD)	PK NAIL	TYPE 1 PSM	YES	2
223±26	E 1/4 SEC 16 T42N R5E (MONUMENT RECORD)	3/8" REBAR	TYPE 1 PSM	YES	2
329±00	W 1/4 SEC 3 T42N R5E (MONUMENT RECORD)	PK NAIL	TYPE 1 PSM	YES	2

NOTE: FOR ALL MONUMENT LOCATIONS SEE TIE SKETCHES

- 1) ENGINEER TO RE-ESTABLISH MONUMENT
- 2) RESIDENT TO RE-ESTABLISH MONUMENT AND FURNISH TIE SKETCHES TO DIST. 3 PLANS & PLANS
- 3) PROFESSIONAL LAND SURVEYOR TO RE-ESTABLISH MONUMENT, RECORD NEW MONUMENT RECORD AND PROVIDE COPY TO DIST. 3 PLATS & PLANS

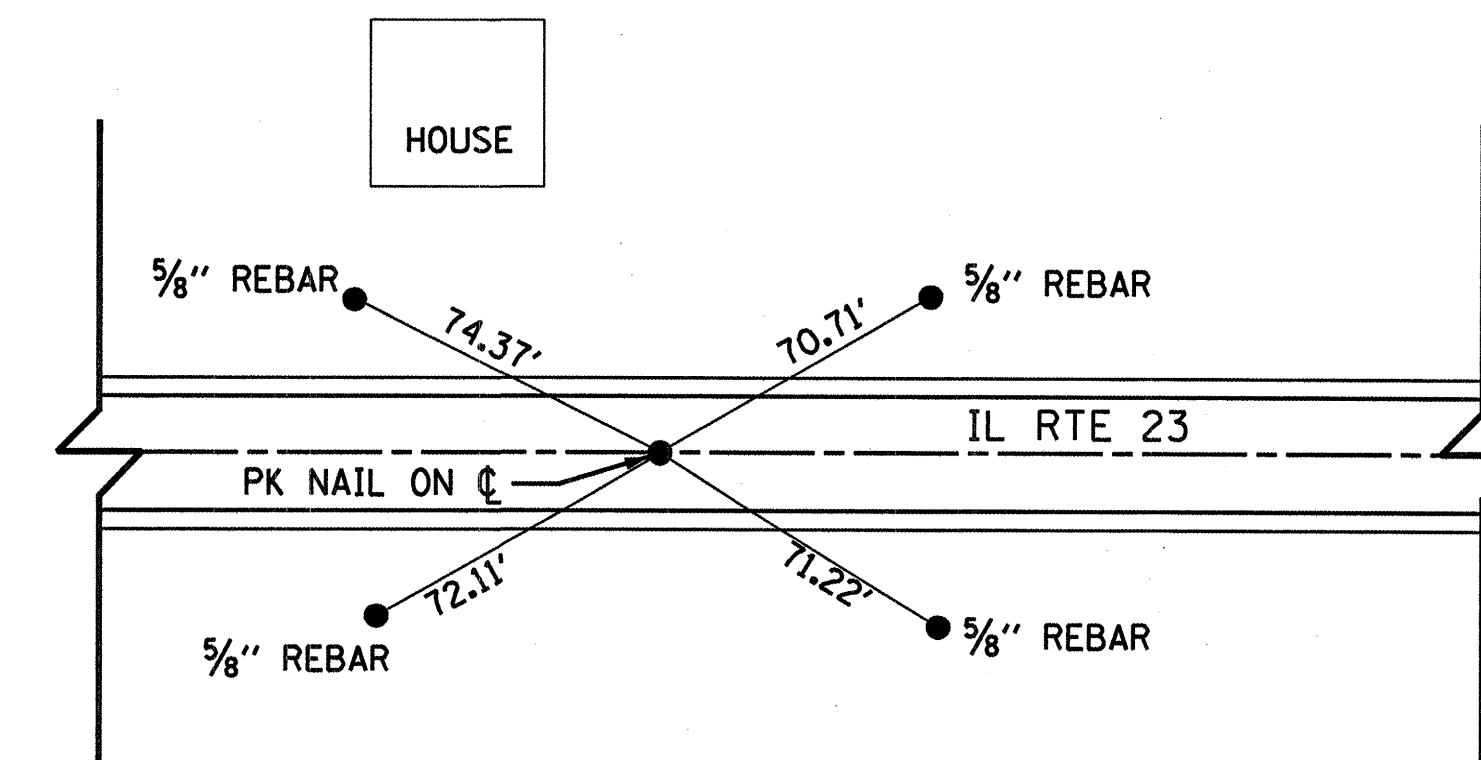

TIES TO WEST QUARTER CORNER OF SECTION 22, T.42 N., R.5E.  
REPLACE WITH PERMANENT SURVEY MARKER  
(APPROX. STA. 171+00)

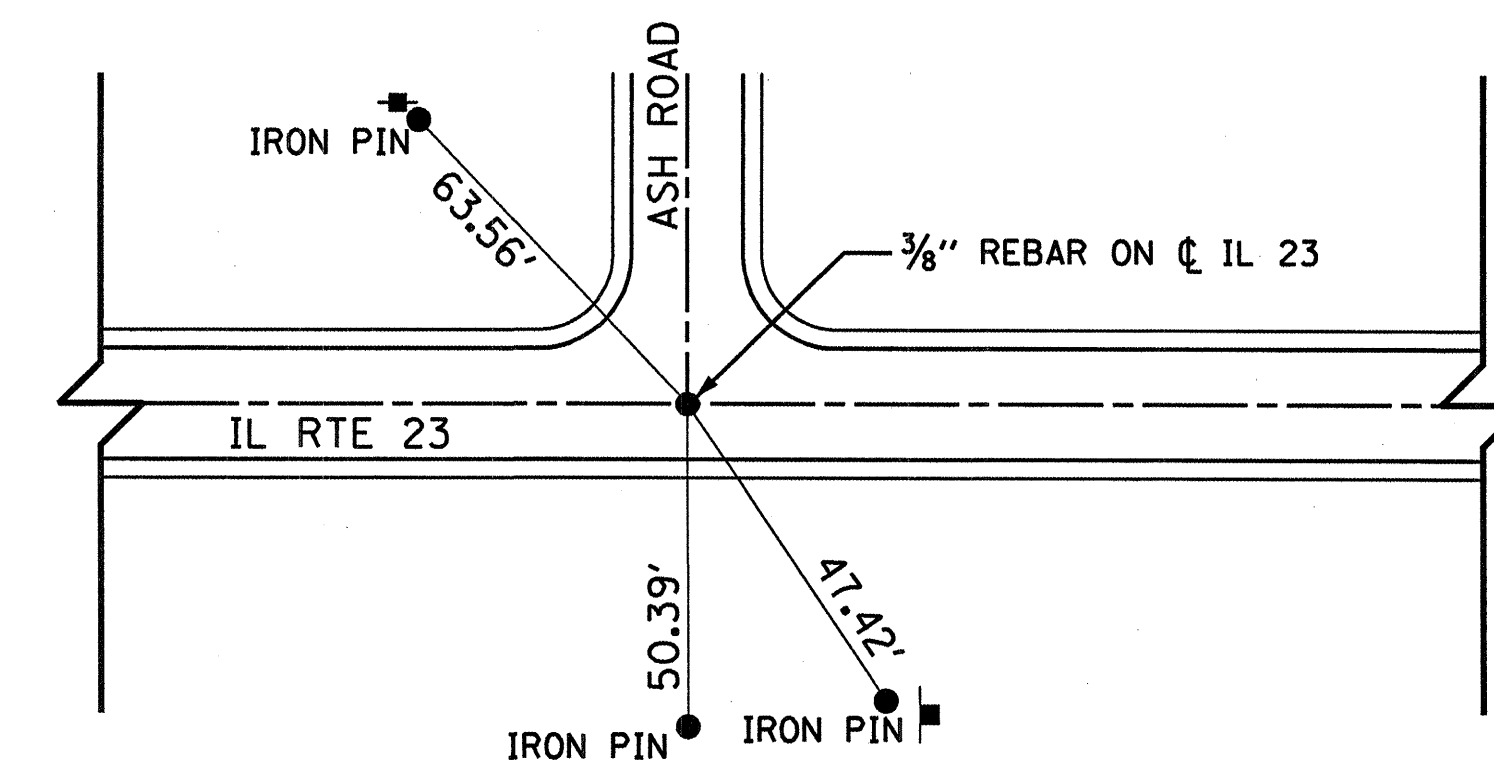

TIES TO EAST QUARTER CORNER OF SECTION 16, T.42 N., R.5E.  
REPLACE WITH PERMANENT SURVEY MARKER  
(APPROX. STA. 223+26)

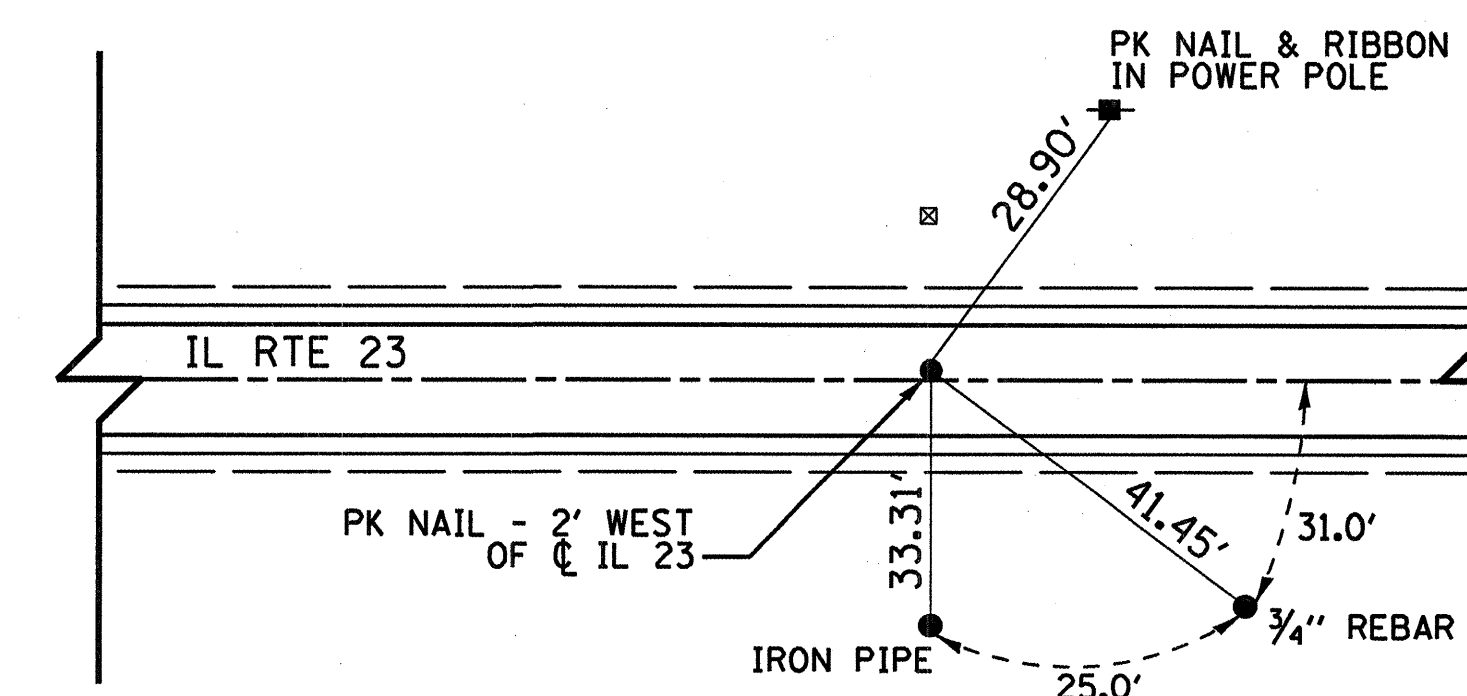

TIES TO WEST QUARTER CORNER OF SECTION 3, T.42 N., R.5E.  
REPLACE WITH PERMANENT SURVEY MARKER  
(APPROX. STA. 329+00)

FILE NAME =	USER NAME = duncanbd	DESIGNED -	REVISED -	<b>STATE OF ILLINOIS DEPARTMENT OF TRANSPORTATION</b>	<b>TIE POINTS</b>			F.A.P. RTE.	SECTION	COUNTY	TOTAL SHEETS	SHEET NO.
ct:\pwork\pwidot\duncanbd\0129029\d366951-sht-cover.dgn	PLOT SCALE = 50.0006' / IN.	DRAWN -	REVISED -					324	(25)RS-4	DEKALB	17	7
PLOT DATE = Jan 19, 2010 - 10:45:21 AM	DATE -	CHECKED -	REVISED -		SCALE: N.T.S. SHEET NO. OF SHEETS STA. TO STA.			FED. ROAD DIST. NO. ILLINOIS FED. AID PROJECT				
								CONTRACT NO. 66951				

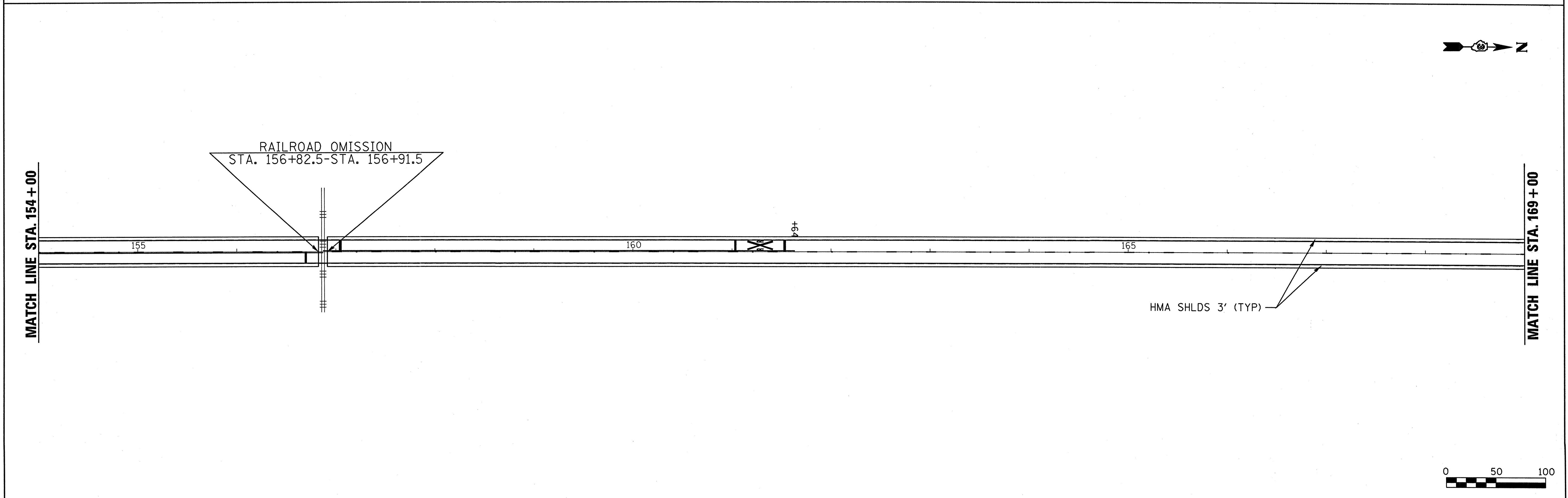
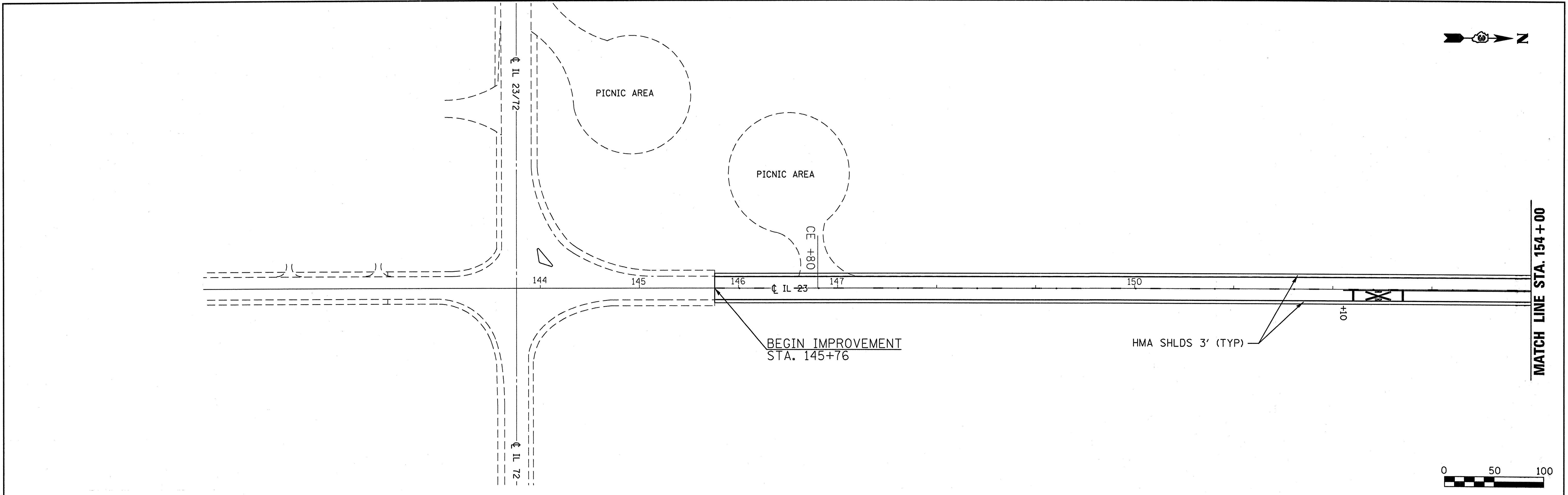

FILE NAME =	USER NAME = duncanbd	DESIGNED -	REVISED -	<b>STATE OF ILLINOIS DEPARTMENT OF TRANSPORTATION</b>	<b>PLAN VIEW</b>			F.A.P. RTE.	SECTION	COUNTY	TOTAL SHEETS	SHEET NO.
c:\pwork\pwork\DOT\DUNCANBD\0129029\366951-sht-cover.dgn		DRAWN -	REVISED -		SCALE: 1:50	SHEET NO. 1 OF 8 SHEETS	STA. 144+00 TO STA. 169+00	324	(25)RS-4	DEKALB	17	8
PLOT SCALE = 50.0000' / IN.		CHECKED -	REVISED -		CONTRACT NO. 66951							
PLOT DATE = Jan 15, 2010 - 02:02:08 PM		DATE -	REVISED -		ILLINOIS FED. AID PROJECT							





MATCH LINE STA. 169+00

MATCH LINE STA. 184+00

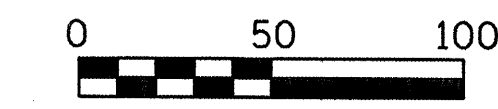
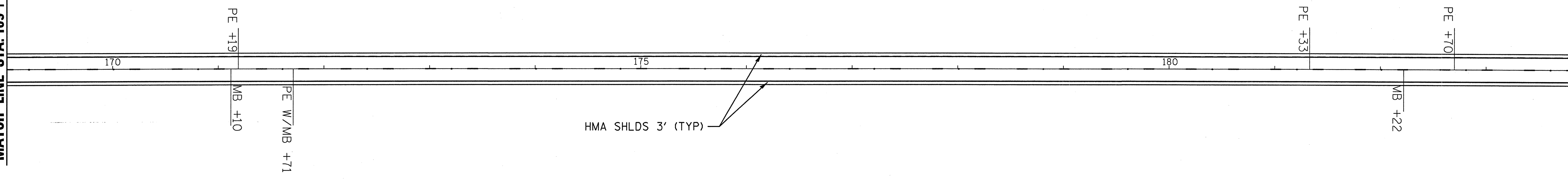

MATCH LINE STA. 184+00

MATCH LINE STA. 199+00

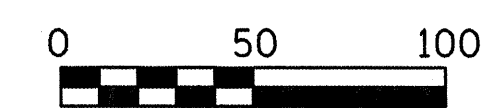
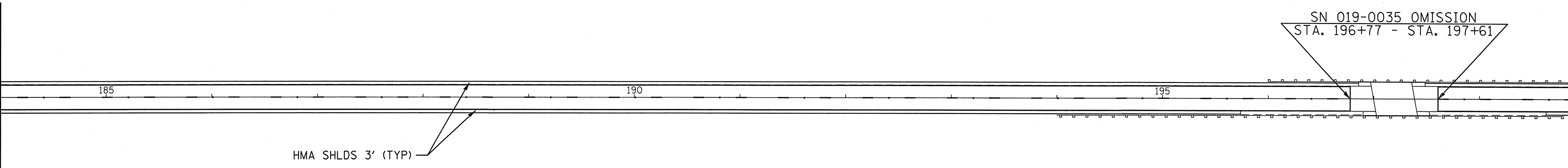

FILE NAME =	USER NAME = duncanbd	DESIGNED -	REVISED -
c:\pwork\pwidot\duncanbd\0129029\d366951-shr-cover.dgn		DRAWN -	REVISED -
	PLOT SCALE = 50.0000' / IN.	CHECKED -	REVISED -
	PLOT DATE = Jan 15, 2010 - 02:02:14 PM	DATE -	REVISED -

**STATE OF ILLINOIS  
DEPARTMENT OF TRANSPORTATION**

**PLAN VIEW**

SCALE: 1:50      SHEET NO. 2 OF 8 SHEETS      STA. 169+00 TO STA. 199+00

F.A.P. RTE.	SECTION	COUNTY	TOTAL SHEETS	SHEET NO.
324	(25)RS-4	DEKALB	17	9
				CONTRACT NO. 66951
ILLINOIS FED. AID PROJECT				

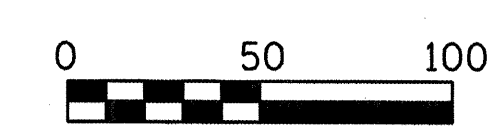
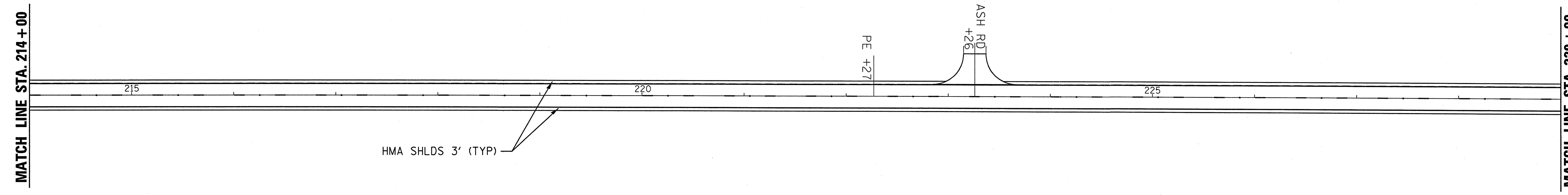
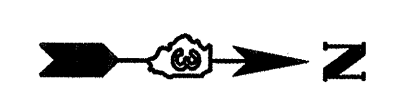
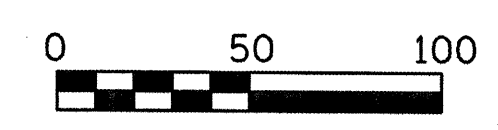
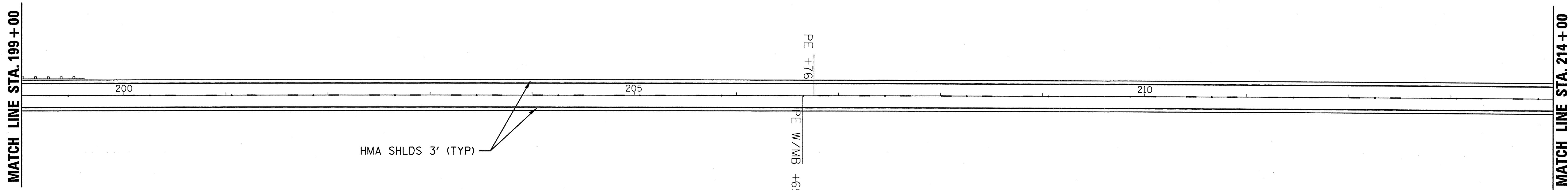

FILE NAME =	USER NAME = duncanbd	DESIGNED -	REVISED -
c:\pwork\pwork\DOT\DUNCANBD\0129029\366951-shd-cover.dgn		DRAWN -	REVISED -
	PLOT SCALE = 50.0000' / IN.	CHECKED -	REVISED -
	PLOT DATE = Jan 15, 2010 - 02:02:21 PM	DATE -	REVISED -

**STATE OF ILLINOIS  
DEPARTMENT OF TRANSPORTATION**

**PLAN VIEW**

SCALE: 1:50      SHEET NO. 3 OF 8 SHEETS      STA. 199+00 TO STA. 229+00

F.A.P. RTE.	SECTION	COUNTY	TOTAL SHEETS	SHEET NO.
324	(25)RS-4	DEKALB	17	10
CONTRACT NO. 66951				
ILLINOIS FED. AID PROJECT				



MATCH LINE STA. 229+00

MATCH LINE STA. 244+00

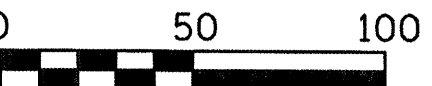
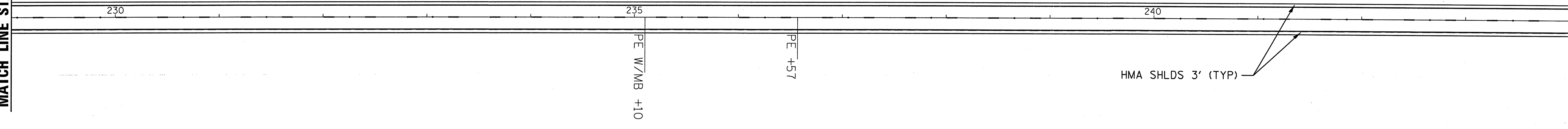

MATCH LINE STA. 244+00

MATCH LINE STA. 259+00

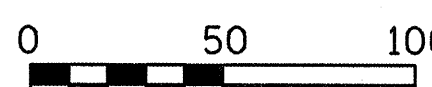
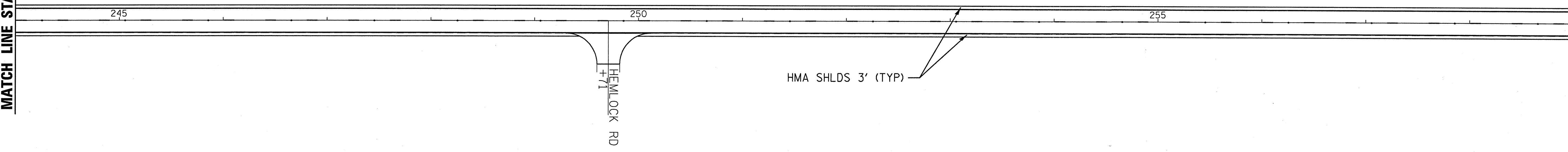

FILE NAME =	USER NAME = duncanbd	DESIGNED -	REVISED -	<b>STATE OF ILLINOIS DEPARTMENT OF TRANSPORTATION</b>	<b>PLAN VIEW</b>			F.A.P. RTE.	SECTION	COUNTY	TOTAL SHEETS	SHEET NO.
c:\pwork\pwi00t\duncanbd\0129029\d366951-sht-cover.dgn		DRAWN -	REVISED -		324	(25)RS-4	DEKALB	17	11			
PLOT SCALE = 50.0000' / IN.		CHECKED -	REVISED -		CONTRACT NO. 66951							
PLOT DATE = Jan 15, 2010 - 02:02:30 PM		DATE -	REVISED -		ILLINOIS FED. AID PROJECT							
				SCALE: 1:50	SHEET NO. 4 OF 8 SHEETS	STA. 229+00 TO STA. 259+00						



MATCH LINE STA. 259+00

MATCH LINE STA. 274+00

260

265

270

HMA SHLDS 3' (TYP)

PE +05

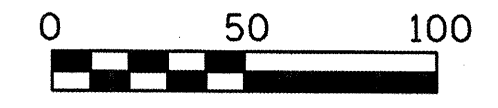

MATCH LINE STA. 274+00

MATCH LINE STA. 289+00

275

280

285

BIRCH RD  
+15

HMA SHLDS 3' (TYP)

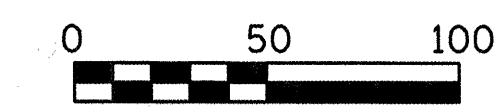

FILE NAME = c:\pwwork\FWID01\DUNCANBD\0129029\d386951-sht-cover.dgn	USER NAME = duncanbd	DESIGNED -	REVISED -
		DRAWN -	REVISED -
		CHECKED -	REVISED -
		DATE -	REVISED -

STATE OF ILLINOIS  
DEPARTMENT OF TRANSPORTATION

PLAN VIEW

SCALE: 1:50 SHEET NO. 5 OF 8 SHEETS STA. 259+00 TO STA. 289+00

F.A.P. RTE.	SECTION	COUNTY	TOTAL SHEETS	SHEET NO.
324	(25)RS-4	DEKALB	17	12
CONTRACT NO. 66951				
ILLINOIS FED. AID PROJECT				



MATCH LINE STA. 289+00

MATCH LINE STA. 304+00

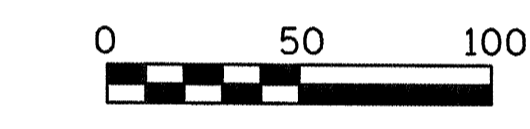
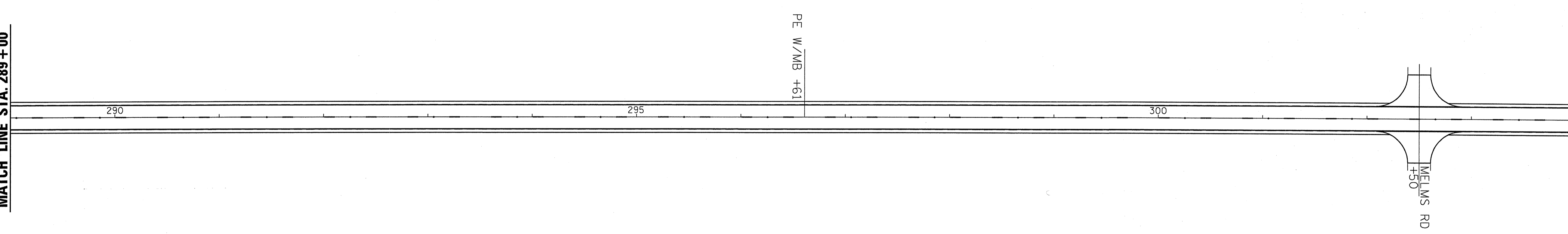

MATCH LINE STA. 304+00

MATCH LINE STA. 319+00

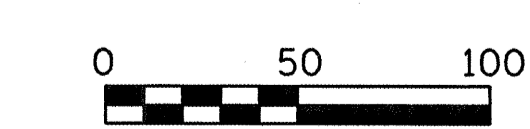
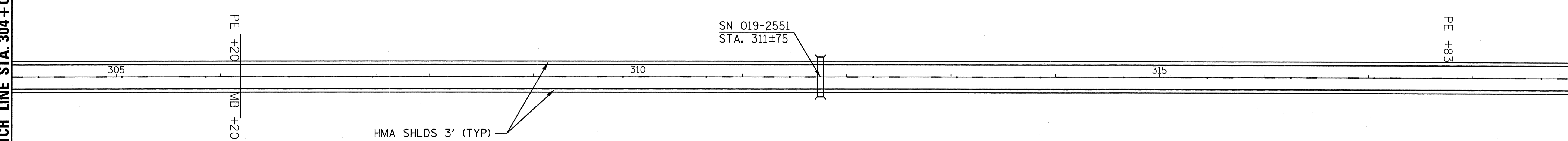

FILE NAME = c:\pwwork\pwwork\duncenbd\0129029\d36951-sht-cover.dgn	USER NAME = duncenbd	DESIGNED -	REVISED -
PLOT SCALE = 50,0000 ' / IN.		DRAWN -	REVISED -
PLOT DATE = Jan 20, 2010 - 04:54:41 PM		CHECKED -	REVISED -
		DATE -	REVISED -

**STATE OF ILLINOIS  
DEPARTMENT OF TRANSPORTATION**

**PLAN VIEW**

SCALE: 1:50      SHEET NO. 6 OF 8 SHEETS      STA. 289+00 TO STA. 319+00

F.A.P. RTE.	SECTION	COUNTY	TOTAL SHEETS	SHEET NO.
324	(25)RS-4	DEKALB	17	13
				CONTRACT NO. 66951
ILLINOIS FED. AID PROJECT				

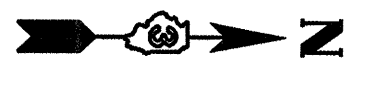

MATCH LINE STA. 319+00

MATCH LINE STA. 334+00

320

325

330

+03

+42

PE W/MB +04

HMA SHLDS 3' (TYP)

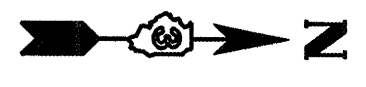
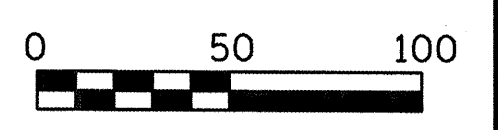

MATCH LINE STA. 334+00

MATCH LINE STA. 349+00

335

340

+86

+50

HMA SHLDS 3' (TYP)

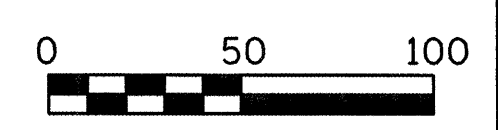

FILE NAME =	USER NAME = duncanbd	DESIGNED -	REVISED -
cr\pw\work\PWIDOT\DUNCANBD\0129029\d366951-shr-cover.dgn		DRAWN -	REVISED -
	PLOT SCALE = 50.0000' / IN.	CHECKED -	REVISED -
	PLOT DATE = Jan 19, 2010 - 10:40:49 AM	DATE -	REVISED -

STATE OF ILLINOIS  
DEPARTMENT OF TRANSPORTATION

PLAN VIEW

SCALE: 1:50 SHEET NO. 7 OF 8 SHEETS STA. 319+00 TO STA. 349+00

F.A.P. RTE.	SECTION	COUNTY	TOTAL SHEETS	SHEET NO.
324	(25)RS-4	DEKALB	17	14
			CONTRACT NO. 66951	
ILLINOIS FED. AID PROJECT				

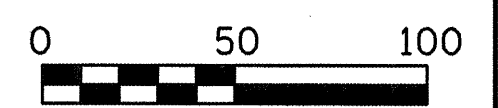
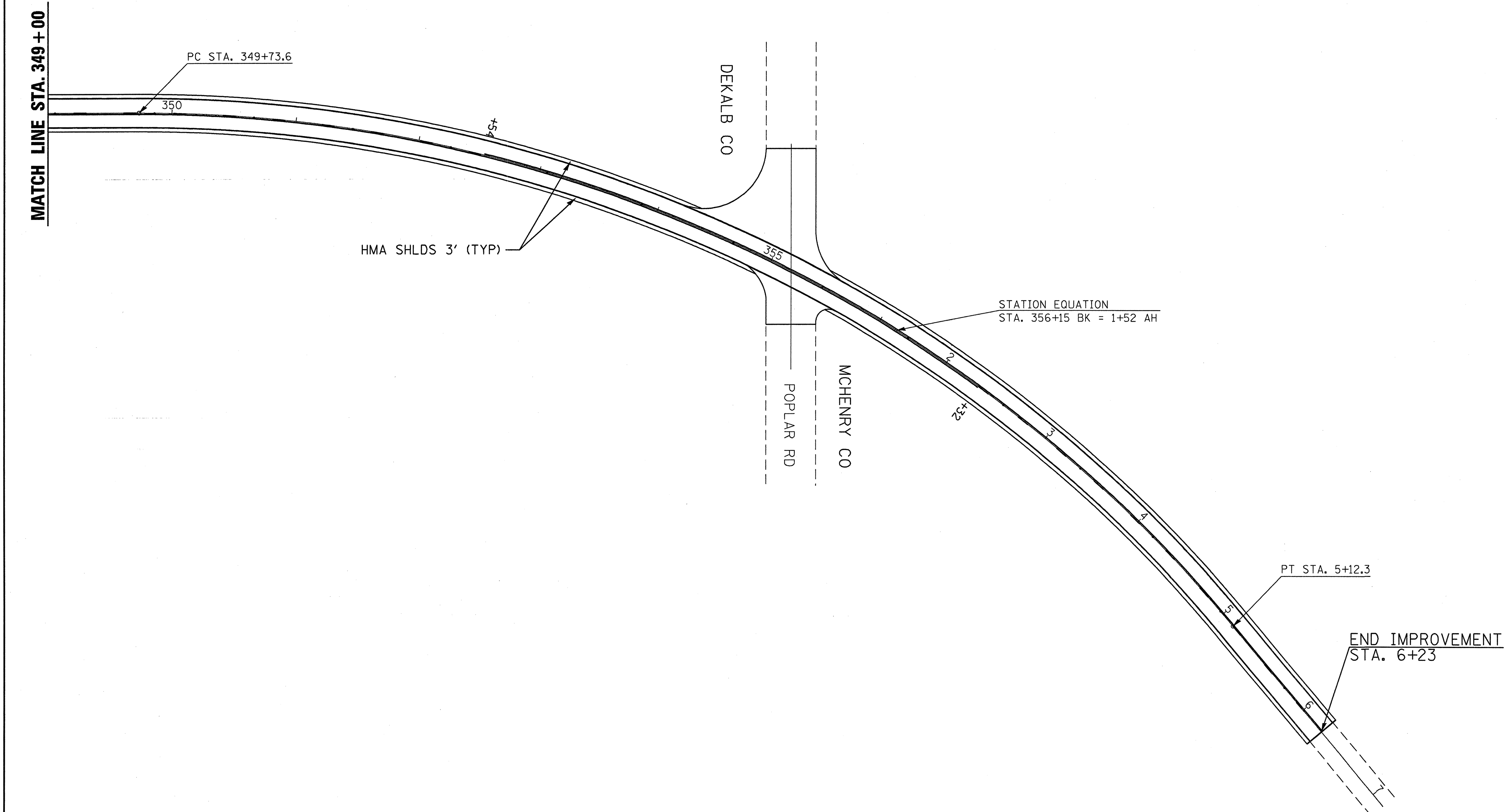

FILE NAME =	USER NAME = duncanbd	DESIGNED -	REVISED -
ct:\pw\work\FWIDOT\DUNCANBD\0129029\d366951-shit-cover.dgn		DRAWN -	REVISED -
PLOT SCALE = 50.0000' / IN.		CHECKED -	REVISED -
PLOT DATE = Jan 19, 2010 - 10:40:55 AM		DATE -	REVISED -

**STATE OF ILLINOIS  
DEPARTMENT OF TRANSPORTATION**

**PLAN VIEW**

SCALE: 1:50    SHEET NO. 8 OF 8 SHEETS    STA. 349+00 TO STA. 7+00

F.A.P. RTE.	SECTION	COUNTY	TOTAL SHEETS	SHEET NO.
324	(25)RS-4	DEKALB	17	15
CONTRACT NO. 66951			ILLINOIS FED. AID PROJECT	

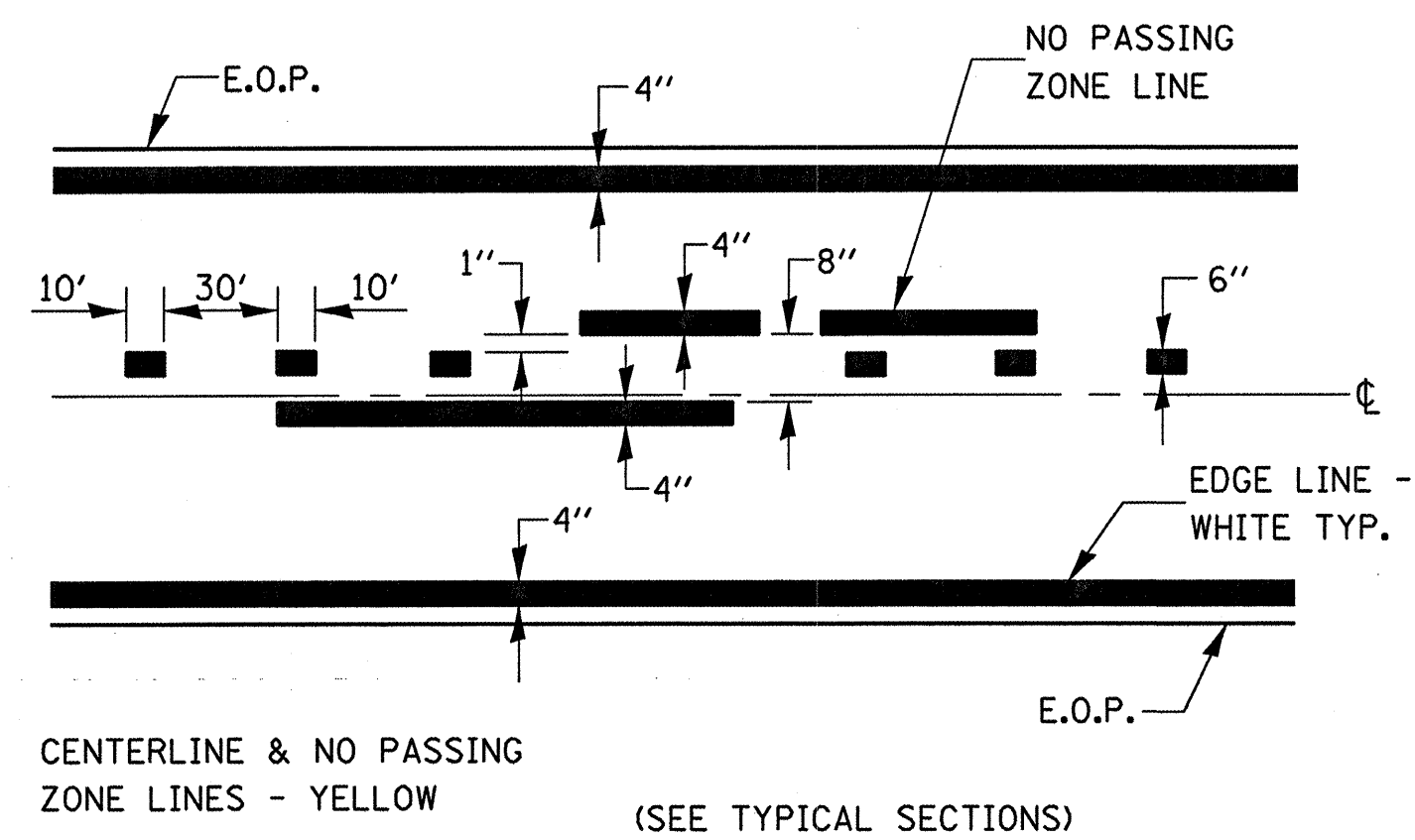

**PAVEMENT MARKING**

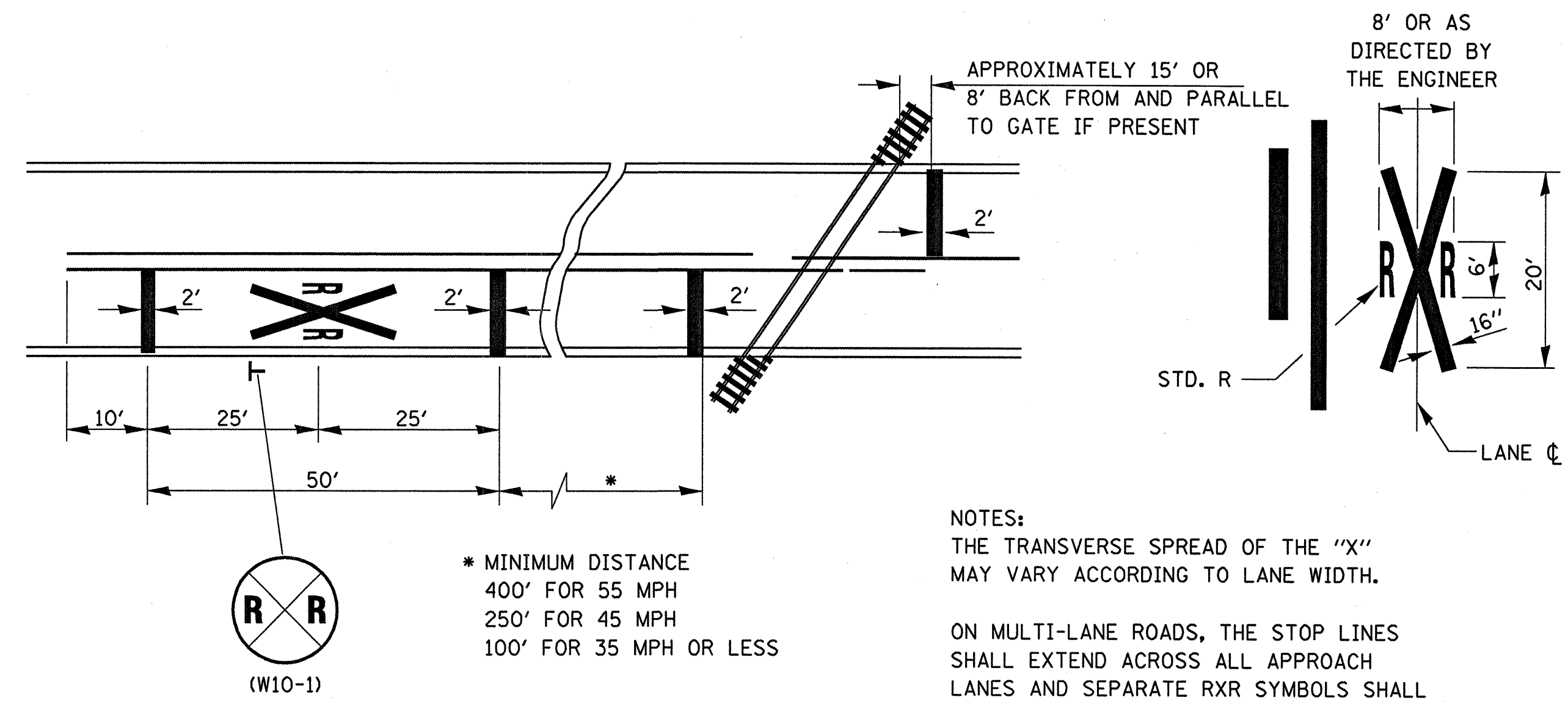

**PAVEMENT MARKINGS AT RAILROAD-HIGHWAY GRADE CROSSING**

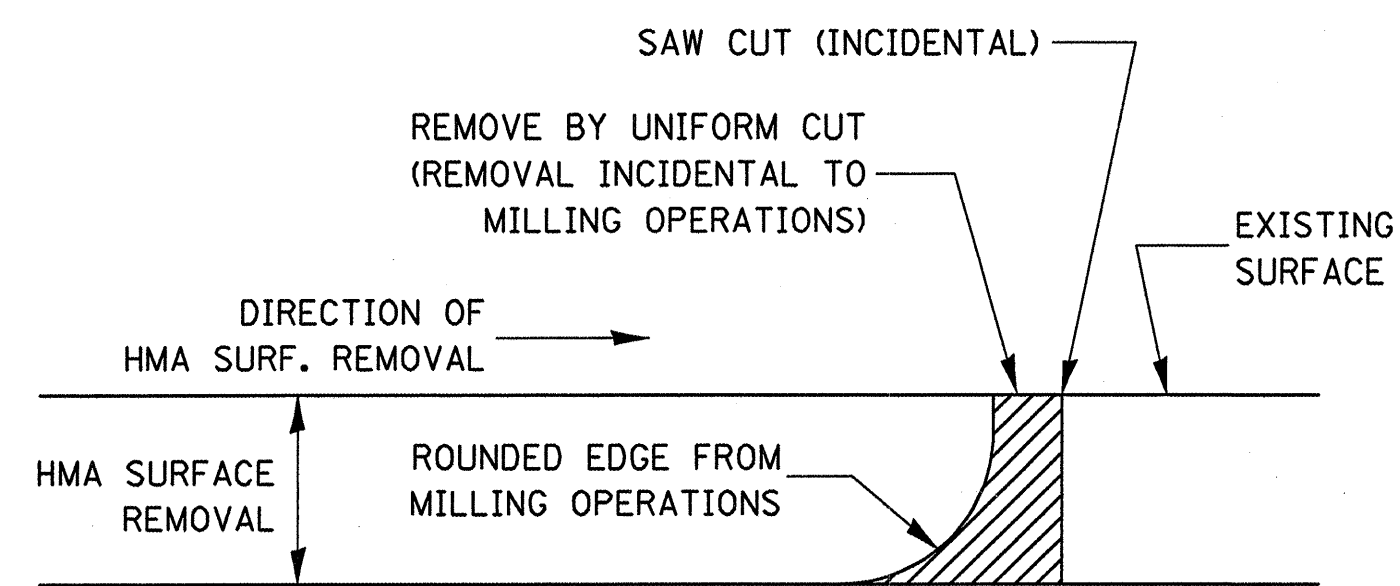

NOTE:  
WHEN MILLING OPERATIONS PRODUCE A ROUNDED EDGE, THEN A SAW CUT SHALL BE USED TO MANUFACTURE A PERPENDICULAR EDGE AS SHOWN IN THE DETAIL. THE ENGINEER SHALL BE THE SOLE JUDGE CONCERNING THE USE OF THIS DETAIL

**HMA DETAIL AT BUTT JOINTS**

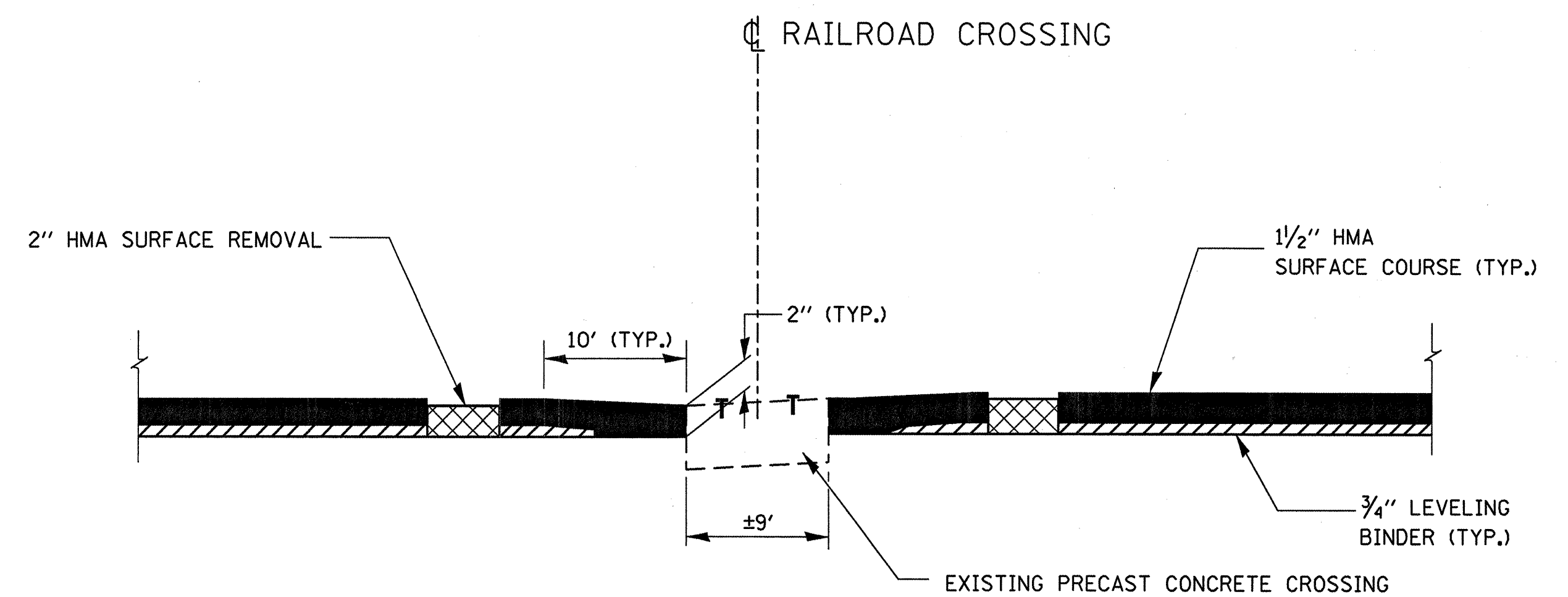

**PROPOSED RESURFACING DETAIL AT DM & E RAILROAD GRADE CROSSING**

(DOT/AAR NO. 372 279 L)

FILE NAME =	USER NAME = duncanbd	DESIGNED -	REVISED -	<b>STATE OF ILLINOIS DEPARTMENT OF TRANSPORTATION</b>	<b>DETAILS</b>			F.A.P. RTE. 324	SECTION (25)RS-4	COUNTY DEKALB	TOTAL SHEETS 17	SHEET NO. 16
es\pw_work\PWIDOT\DUNCANBD\d0129029\d366951-sht-cover.dgn		DRAWN -	REVISED -		SCALE:	SHEET NO. OF SHEETS	STA.	TO STA.	ILLINOIS FED. AID PROJECT			
		CHECKED -	REVISED -									
		DATE -	REVISED -									



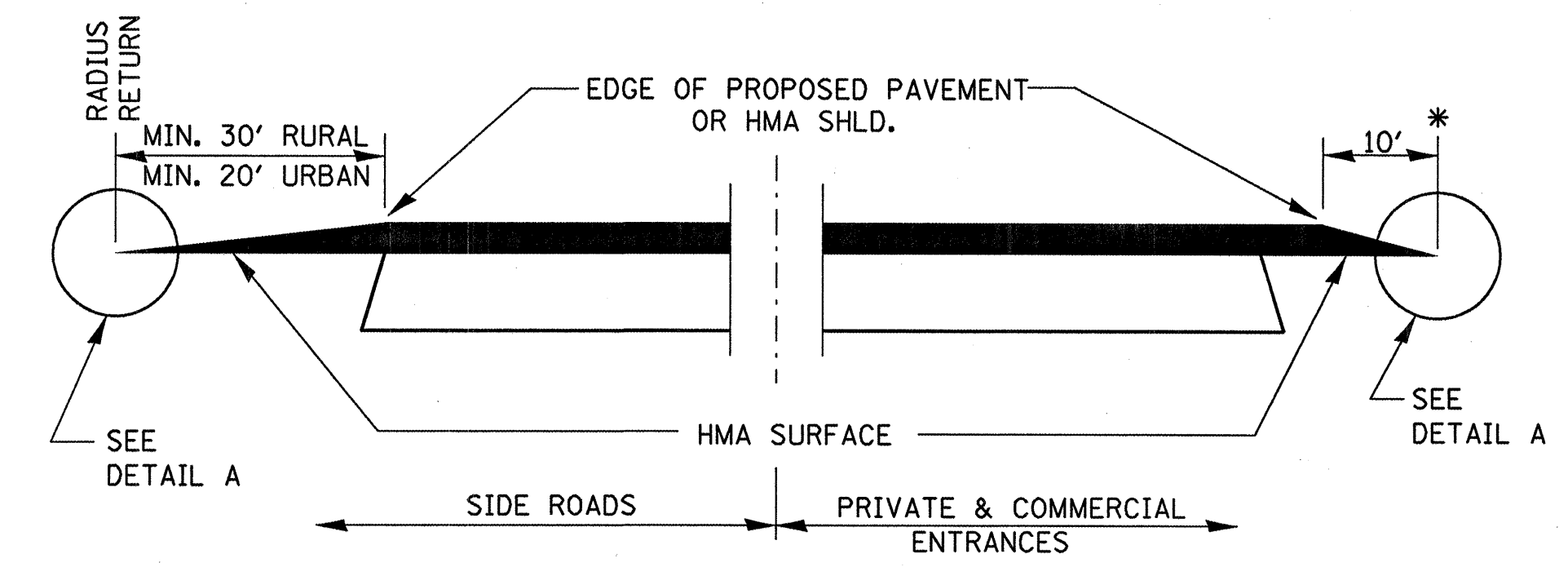
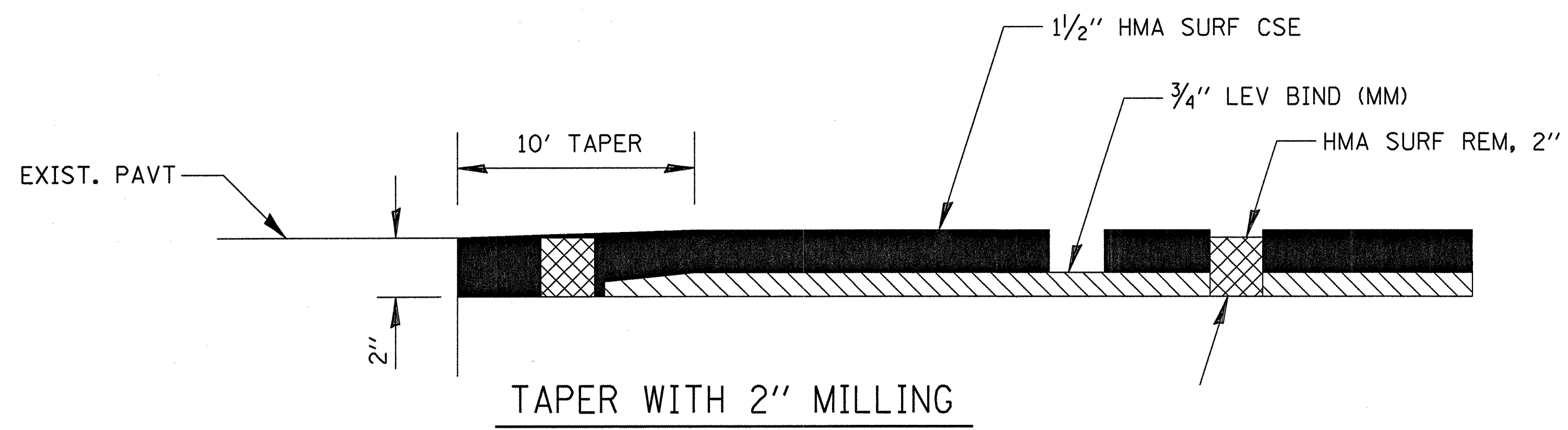

**SECTION A-A**  
**DETAILS AT ENTRANCES & SIDE ROADS**

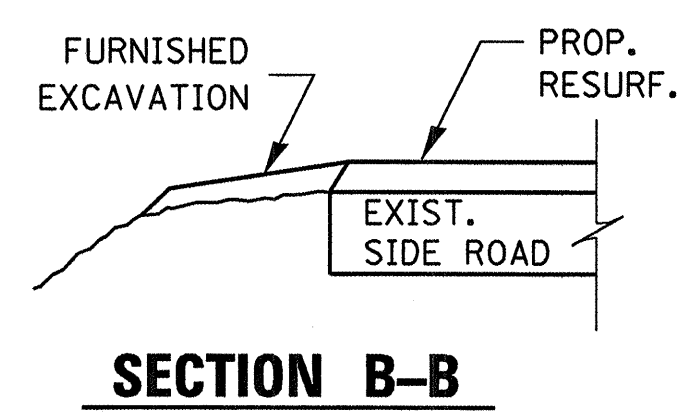

THE COST OF REMOVAL AT EXISTING HMA OR P.C.C. LOCATIONS SHALL BE PAID FOR PER SQ. YD. BY THE APPROPRIATE PAY ITEM. REMOVAL AT THE EXISTING AGG. LOCATIONS SHALL BE INCIDENTAL TO THE HMA. A-3 LOCATIONS SHALL BE FEATHER TAPERED.

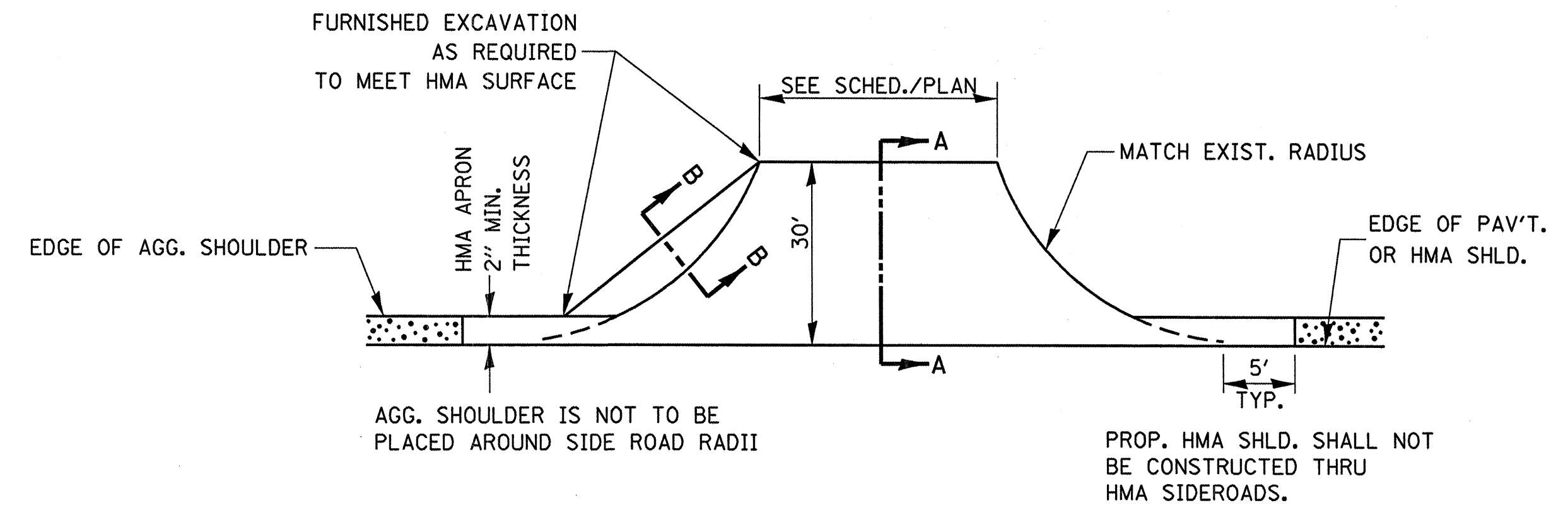
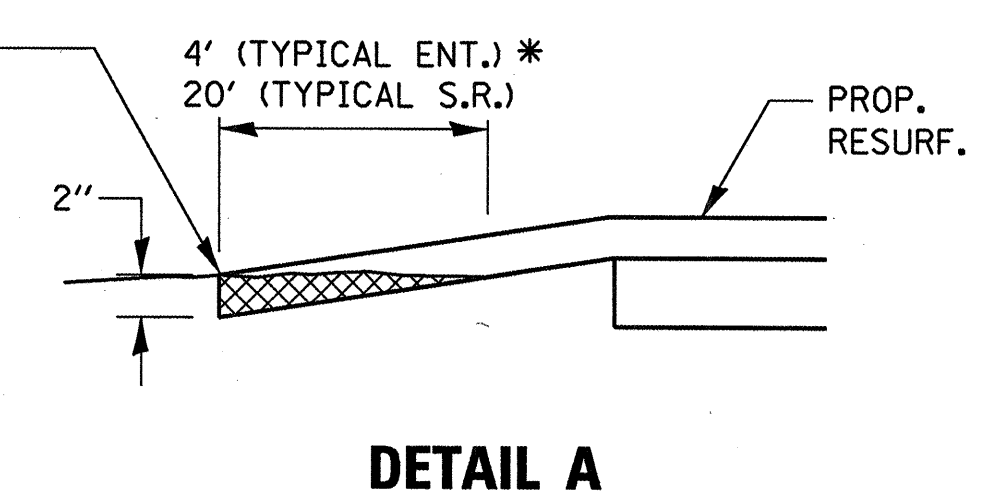

**PLAN AT SIDE ROADS**

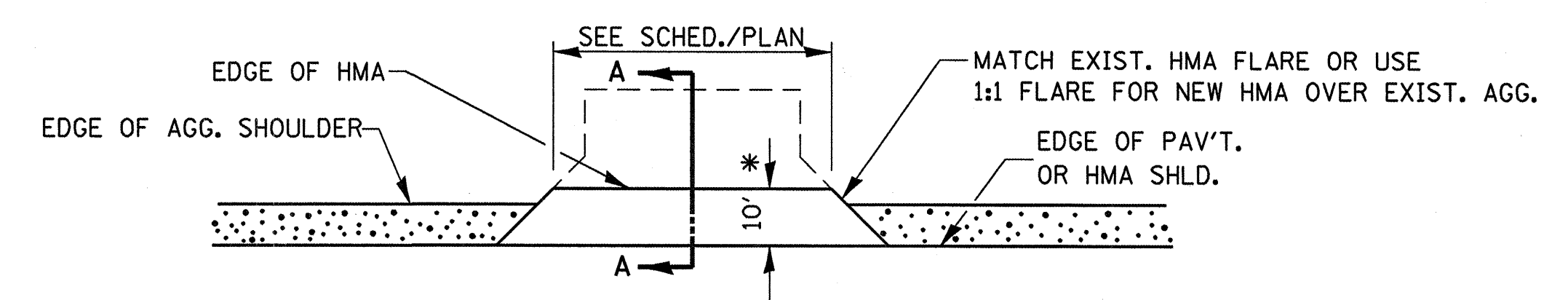

**PLAN AT PRIVATE & COMMERCIAL ENTRANCES**

(DO NOT RESURFACE FIELD ENTRANCES)

\* PROPOSED HMA RESURFACING AT PUBLIC EDUCATIONAL FACILITY ENTRANCES SHALL BE EXTENDED TO THE RIGHT-OF-WAY LIMITS.

FILE NAME =	USER NAME = duncanbd	DESIGNED -	REVISED -
ci\pw_work\PWIDOT\DUNCANBD\0129029\0366951-shd-cover.dgn		DRAWN -	REVISED -
PLOT SCALE = 50.0000' / IN.		CHECKED -	REVISED -
PLOT DATE = Jan 19, 2010 - 10:41:13 AM		DATE -	REVISED -

**STATE OF ILLINOIS**  
**DEPARTMENT OF TRANSPORTATION**

DETAILS				F.A.P. RTE.	SECTION	COUNTY	TOTAL SHEETS	SHEET NO.
SCALE:	SHEET NO.	OF SHEETS	STA.	324	(25)RS-4	DEKALB	17	17
							CONTRACT NO. 66951	
[ILLINOIS] FED. AID PROJECT								