

F.A.I. RTE.	SECTION	COUNTY	TOTAL SHEETS	SHEET NO.
72	*	PIATT	251	108
STA. 918+00		TO STA. 948+00		
FED. ROAD DIST. NO.	ILLINOIS	FED. AID PROJECT		

*(58,74-66)&(74-67&68)RS-1

RAMP TRAFFIC CONTROL DETAIL

STAGE II
IL 48
SOUTHBOUND LANE CLOSED
SN 074-0055

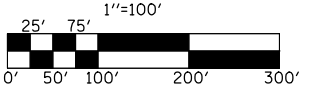
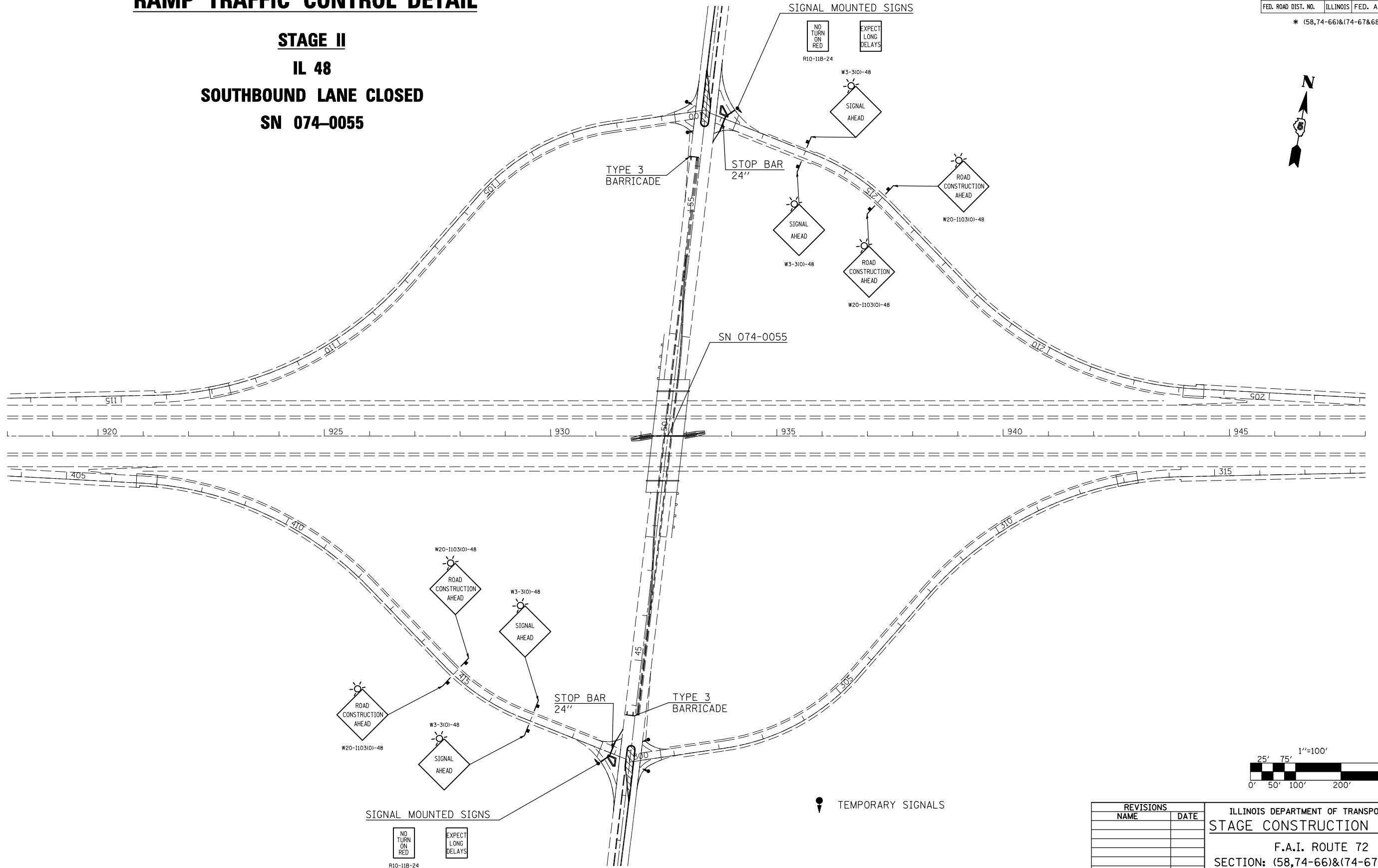

REVISIONS	
NAME	DATE

ILLINOIS DEPARTMENT OF TRANSPORTATION
STAGE CONSTRUCTION SIGNING
 F.A.I. ROUTE 72
 SECTION: (58,74-66)&(74-67&68)RS-1
 PIATT COUNTY
 SCALE: 1" = 100'
 DATE: 10/18/05
 DRAWN BY: CADD
 CHECKED BY:

PLOT DATE = 2/8/2010
 FILE NAME = g:\pwr\work\PIATT\CEARLOCK\ID\0109678\0570022-sht-staging-IL48.dgn
 PLOT SCALE = 211.7647 / IN.
 USER NAME = cearlockjd