

F.A.I. RTE.	SECTION	COUNTY	TOTAL SHEETS	SHEET NO.
72	*	PIATT	251	113
STA. 975+00		TO STA. 1005+00		
FED. ROAD DIST. NO.	ILLINOIS	FED. AID PROJECT		

* (58,74-66)&(74-67&68)RS-1

EXIST. CURVE 15 (FAI 72)
 PI STA. = 1008+28.98
 $\Delta = 5^\circ 23' 42''$ (LT)
 $D = 0^\circ 30' 00''$
 $R = 11,460.66'$
 $T = 539.97'$
 $L = 1,079.14'$
 $E = 12.71'$
 $e = \text{---}$
 $T.R. = \text{---}$
 $S.E. RUN = \text{---}$
 $P.C. STA. = 1002+89.01$
 $P.T. STA. = 1013+68.15$

- 1 SEE STRUCTURE PLANS, S.N. 074-0058.
- 2 PLAN NOTE: UPON COMPLETION OF THE PROJECT, THE VERTICLE CLEARANCES OF ALL AFFECTED OVERHEAD STRUCTURE SHALL BE VERIFIED AND REPORTED TO THE BUREAU OF OPERATIONS BY THE RESIDENT ENGINEER.
- 3 SEE DETAIL FOR CRASHWALL EXTENSIONS AT S.N. 074-0058.
- 4 SEE DETAIL FOR IMPACT ATTENUATORS (NON-DIRECTIVE) TEST LEVEL 3.

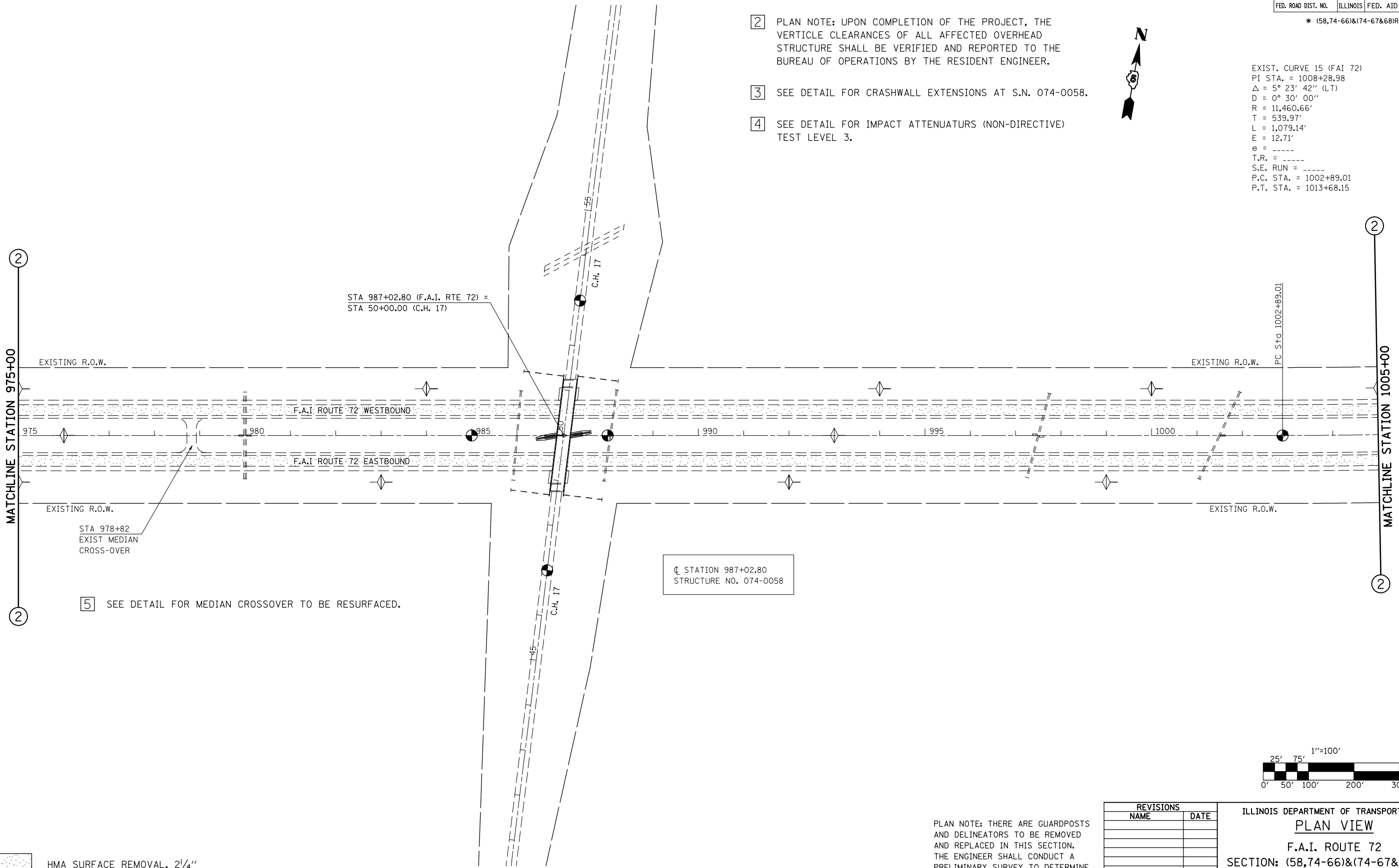

5 SEE DETAIL FOR MEDIAN CROSSOVER TO BE RESURFACED.

STATION 987+02.80
 STRUCTURE NO. 074-0058

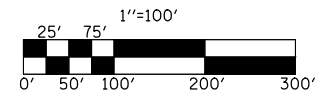

REVISIONS	
NAME	DATE

ILLINOIS DEPARTMENT OF TRANSPORTATION
PLAN VIEW
 F.A.I. ROUTE 72
 SECTION: (58,74-66)&(74-67&68)RS-1
 PIATT COUNTY

PLAN NOTE: THERE ARE GUARDPOSTS AND DELINEATORS TO BE REMOVED AND REPLACED IN THIS SECTION. THE ENGINEER SHALL CONDUCT A PRELIMINARY SURVEY TO DETERMINE QUANTITY OF EACH ITEM PRIOR TO CONSTRUCTION.

SCALE: 1" = 100'
 DATE: 10/18/05
 DRAWN BY: CADD
 CHECKED BY:

PLOT DATE = 2/8/2010
 FILE NAME = G:\pwork\PMIDOT\BUCKLESJJ\d0109678\100pland.dgn
 PLOT SCALE = 211.7647 / IN.
 USER NAME = bucklesjj

HMA SURFACE REMOVAL, 2 1/4"