

F.A.I. RTE.	SECTION	COUNTY	TOTAL SHEETS	SHEET NO.
72	*	PIATT	251	125
STA. 1320+00		TO STA. 1345+00		
FED. ROAD DIST. NO.	ILLINOIS	FED. AID PROJECT		

* (58,74-66)&(74-67&68)RS-1

EXIST. CURVE 17 (FAI 72)
 PI STA. = 1332+18.93
 $\Delta = 37^\circ 15' 37''$ (LT)
 D = $1^\circ 30' 00''$
 R = 3,819.71'
 T = 1,287.71'
 L = 2,484.01'
 E = 211.22'
 e = -----
 T.R. = -----
 S.E. RUN = -----
 P.C. STA. = 1319+31.22
 P.T. STA. = 1344+15.23

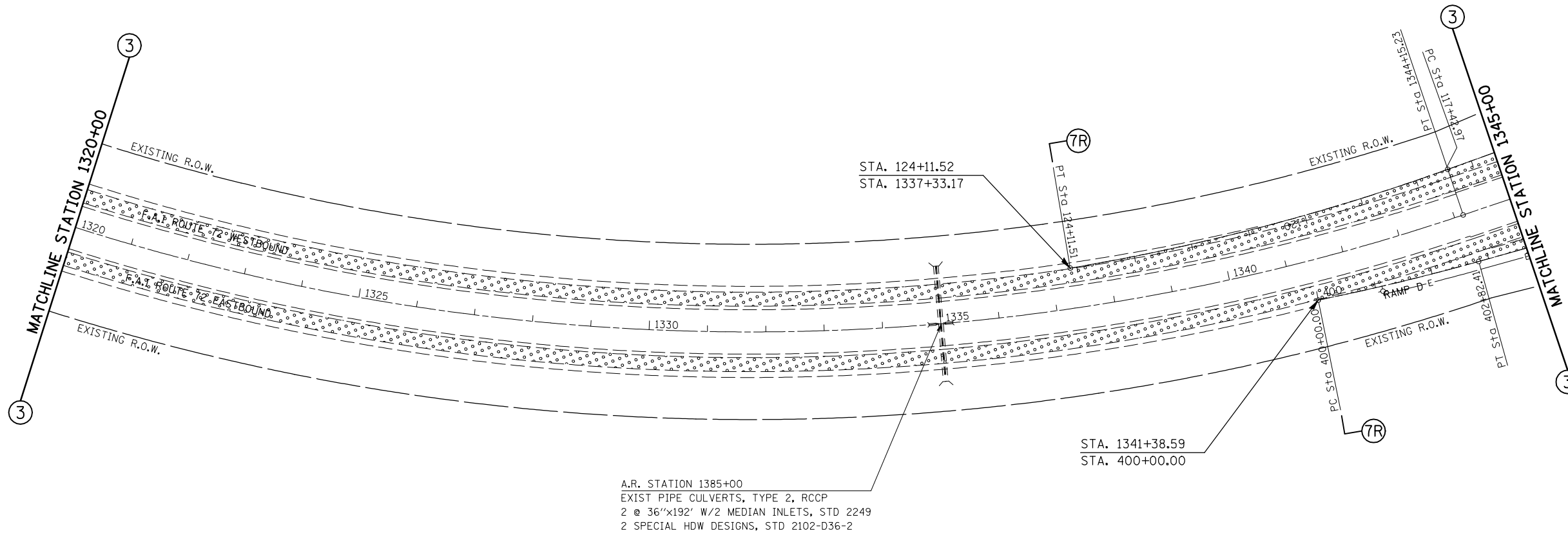

A.R. STATION 1385+00
 EXIST PIPE CULVERTS, TYPE 2, RCCP
 2 @ 36"x192' W/2 MEDIAN INLETS, STD 2249
 2 SPECIAL HDW DESIGNS, STD 2102-D36-2

 HMA SURFACE REMOVAL, 3 1/4"

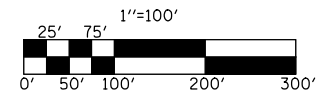

PLAN NOTE: THERE ARE GUARDPOSTS AND DELINEATORS TO BE REMOVED AND REPLACED IN THIS SECTION. THE ENGINEER SHALL CONDUCT A PRELIMINARY SURVEY TO DETERMINE QUANTITY OF EACH ITEM PRIOR TO CONSTRUCTION.

REVISIONS	
NAME	DATE

ILLINOIS DEPARTMENT OF TRANSPORTATION
PLAN VIEW
 F.A.I. ROUTE 72
 SECTION: (58,74-66)&(74-67&68)RS-1
 PIATT COUNTY
 SCALE: 1" = 100'
 DATE: 10/18/05
 DRAWN BY: CADD
 CHECKED BY: