

F.A.I. RTE.	SECTION	COUNTY	TOTAL SHEETS	SHEET NO.
72	*	PIATT	251	133
STA. 1213+00		TO STA. 1243+00		
FED. ROAD DIST. NO.		ILLINOIS FED. AID PROJECT		
* (58,74-66)&(74-67&68)RS-1				

**63200310 GUARDRAIL REMOVAL**

STATION	TO STATION	LENGTH(FT)
1222+74.15	1225+55.94	EB RT 281.79
1225+63.00	1228+44.82	WB LT 281.82

**63100169 TRAFFIC BARRIER TERMINAL TYPE 1 (SP) TANGENT**

STATION	TO STATION	EACH
1222+22.96	1222+72.96	EB RT 1.0
1228+45.89	1228+95.89	WB LT 1.0

**63000001 STEEL PLATE BEAM GUARDRAIL TYPE A. 6 FOOT POSTS**

STATION	TO STATION	LENGTH(FT)
1222+72.96	1225+10.46	EB RT 237.50
1228+08.39	1228+45.89	WB LT 237.50

**78201000 TERMINAL MARKER - DIRECT APPLIED**

STATION	EACH
1222+22.96	EB RT 1.0
1228+95.89	WB LT 1.0

**63100217 TRAFFIC BARRIER TERMINAL TYPE 6B (SPECIAL)**

STATION	TO STATION	EACH
1225+10.46	1225+62.36	EB RT 1.0
1225+56.49	1228+08.39	WB LT 1.0

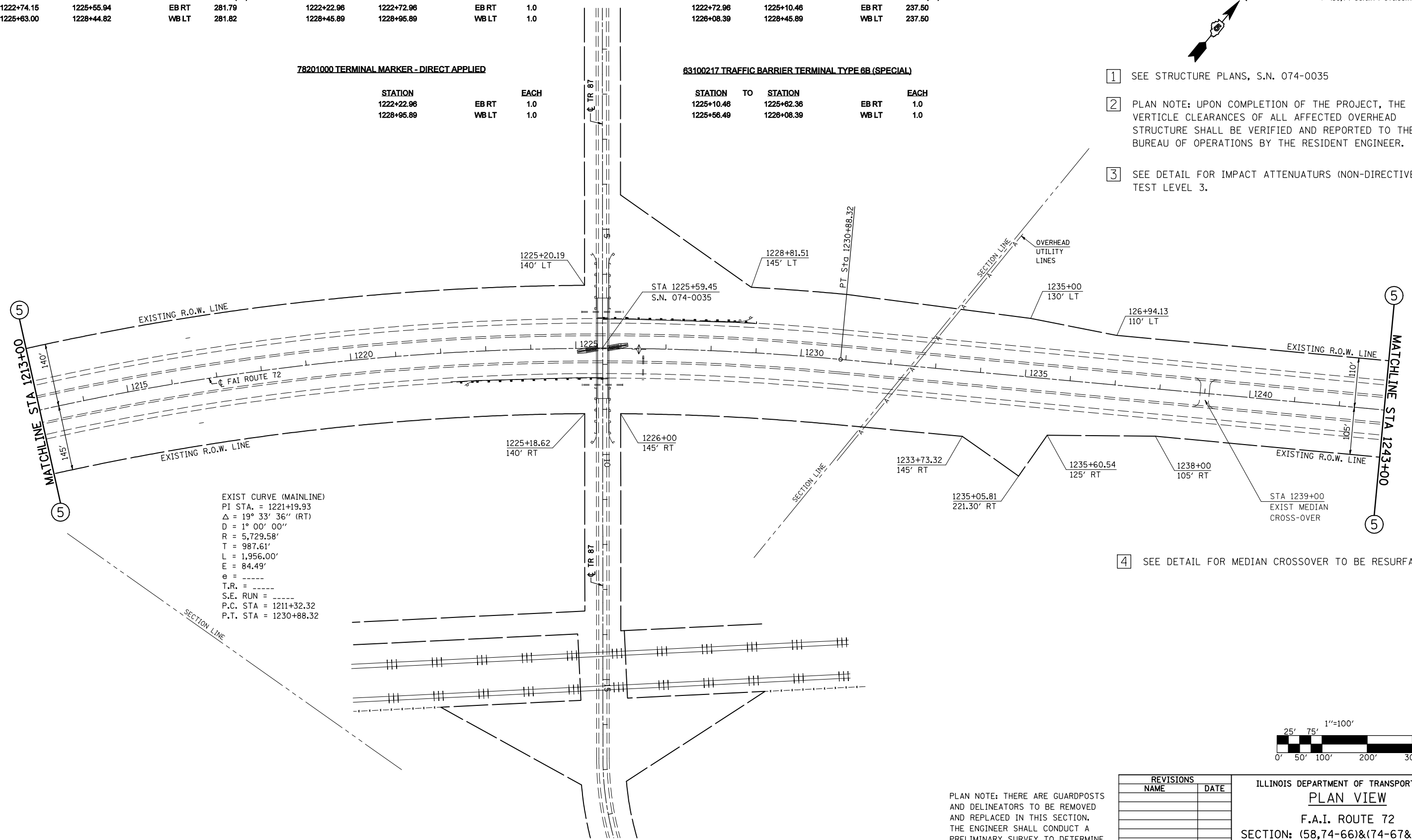

- 1 SEE STRUCTURE PLANS, S.N. 074-0035
- 2 PLAN NOTE: UPON COMPLETION OF THE PROJECT, THE VERTICLE CLEARANCES OF ALL AFFECTED OVERHEAD STRUCTURE SHALL BE VERIFIED AND REPORTED TO THE BUREAU OF OPERATIONS BY THE RESIDENT ENGINEER.
- 3 SEE DETAIL FOR IMPACT ATTENUATORS (NON-DIRECTIVE) TEST LEVEL 3.

4 SEE DETAIL FOR MEDIAN CROSSOVER TO BE RESURFACED.

EXIST CURVE (MAINLINE)  
 PI STA. = 1221+19.93  
 $\Delta = 19^\circ 33' 36''$  (RT)  
 $D = 1^\circ 00' 00''$   
 $R = 5,729.58'$   
 $T = 987.61'$   
 $L = 1,956.00'$   
 $E = 84.49'$   
 $e = \text{-----}$   
 $T.R. = \text{-----}$   
 $S.E. RUN = \text{-----}$   
 $P.C. STA = 1211+32.32$   
 $P.T. STA = 1230+88.32$

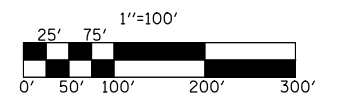

REVISIONS	
NAME	DATE

ILLINOIS DEPARTMENT OF TRANSPORTATION  
**PLAN VIEW**  
 F.A.I. ROUTE 72  
 SECTION: (58,74-66)&(74-67&68)RS-1  
 PIATT COUNTY

PLAN NOTE: THERE ARE GUARDPOSTS AND DELINEATORS TO BE REMOVED AND REPLACED IN THIS SECTION. THE ENGINEER SHALL CONDUCT A PRELIMINARY SURVEY TO DETERMINE QUANTITY OF EACH ITEM PRIOR TO CONSTRUCTION.

SCALE: 1" = 100'  
 DATE: 10/18/05  
 DRAWN BY: CADD  
 CHECKED BY: