

CONTRACT NO. 70022				
F.A.I. RTE.	SECTION	COUNTY	TOTAL SHEETS	SHEET NO.
72	*	PIATT	251	134
STA. 1243+00		TO STA. 1270+00		
FED. ROAD DIST. NO.	ILLINOIS	FED. AID PROJECT		
* (58,74-66)&(74-67&68)RS-1				

EXIST CURVE (MAINLINE)  
PI STA. = 1255+31.67  
 $\Delta = 26^\circ 50' 00''$  (LT)  
D = 1° 16' 00''  
R = 4,523.33'  
T = 1,079.00'  
L = 2,118.41'  
E = 126.91'  
 $\theta = \text{-----}$   
T.R. =  $\text{-----}$   
S.E. RUN =  $\text{-----}$   
P.C. STA = 1244+52.67  
P.T. STA = 1265+71.08

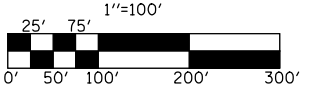
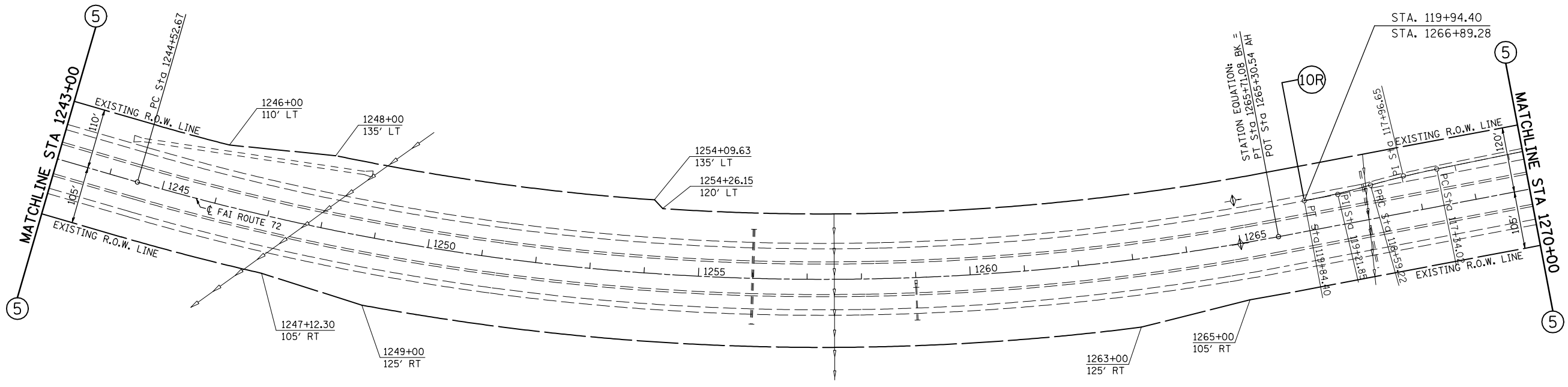
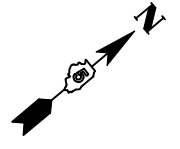

REVISIONS	
NAME	DATE

ILLINOIS DEPARTMENT OF TRANSPORTATION  
**PLAN VIEW**  
F.A.I. ROUTE 72  
SECTION: (58,74-66)&(74-67&68)RS-1  
PIATT COUNTY  
SCALE: 1" = 100'  
DATE: 10/18/05  
DRAWN BY: CADD  
CHECKED BY:

PLAN NOTE: THERE ARE GUARDPOSTS AND DELINEATORS TO BE REMOVED AND REPLACED IN THIS SECTION. THE ENGINEER SHALL CONDUCT A PRELIMINARY SURVEY TO DETERMINE QUANTITY OF EACH ITEM PRIOR TO CONSTRUCTION.

PLOT DATE = 2/8/2010  
FILE NAME = g:\pwork\PIATT\BUCKLESJJ\d0109678\100pland.dgn  
PLOT SCALE = 211.7647 / IN.  
USER NAME = bucklesjj