

**ELEVATION**

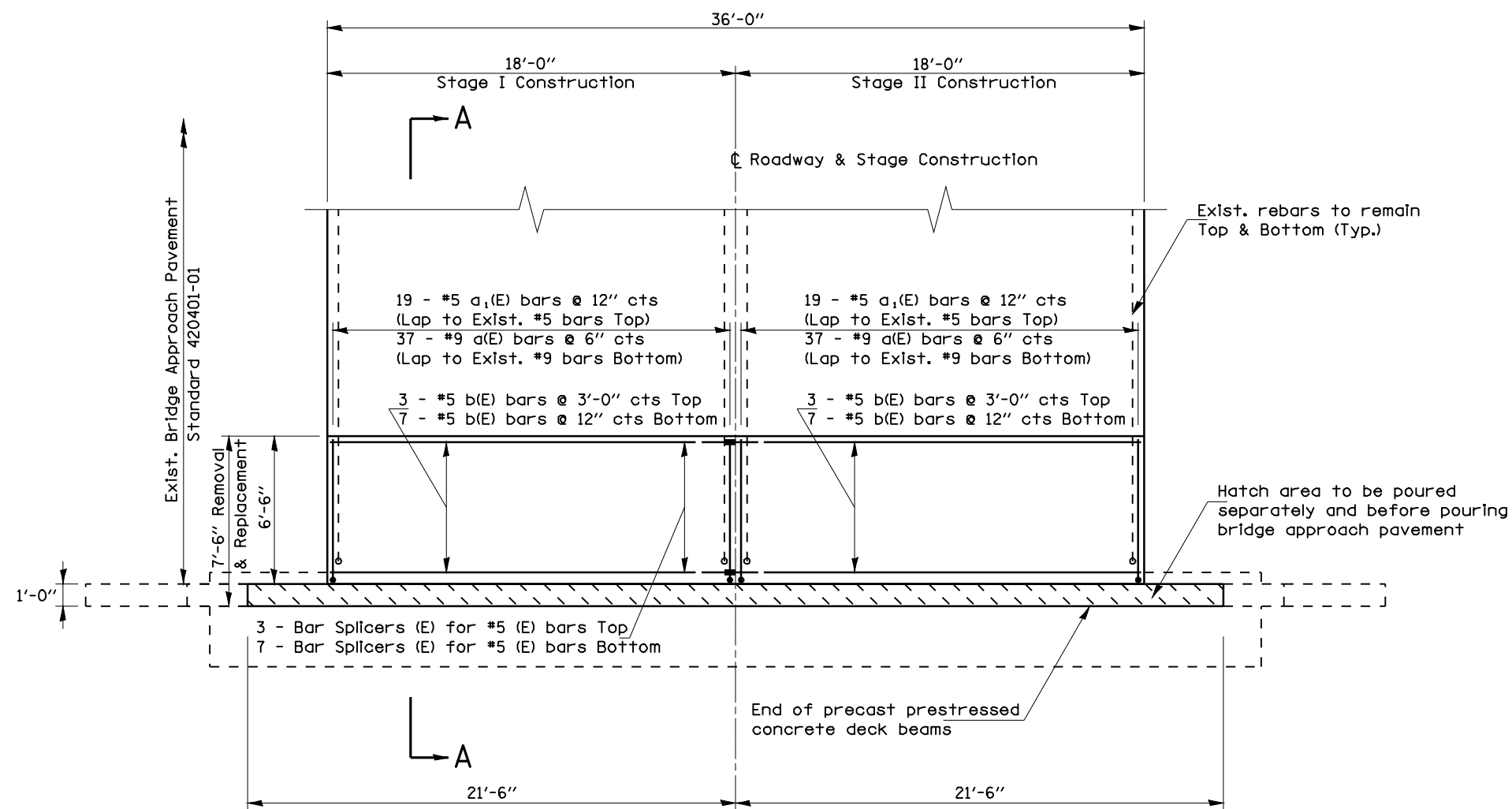

**PLAN**

SN 011-0019 EAST BRIDGE APPROACH PAVEMENT  
 SN 011-0020 WEST BRIDGE APPROACH PAVEMENT  
 SN 011-0021 EAST BRIDGE APPROACH PAVEMENT  
 SN 011-0022 EAST & WEST BRIDGE APPROACH PAVEMENT

**TOTAL BILL OF MATERIALS FOR  
 APPROACH PAVEMENT AND  
 ABUTMENT REPAIRS**

BAR	NO.	SIZE	LENGTH	SHAPE
a(E)	370	#9	7'-3"	—
a <sub>1</sub> (E)	190	#5	6'-3"	—
b(E)	100	#5	17'-8"	—
h(E)	60	#6	21'-2"	—
Bridge Deck Grooving			Sq Yd	160
Protective Coat			Sq Yd	864
Concrete Removal			Cu Yd	73
Reinforcement Superstructure			Cu Yd	73
Reinforcement Bars (Epoxy Coated)			Pound	14110
Bar Splicers			Each	80

Quantities listed in Total Bill of Materials are for all four structures