

As approved by the Engineer, the Contractor may elect to reduce the width of pour by use of the Optional Longitudinal Construction Joint shown. Joints shall be located at the edge of a traffic lane.

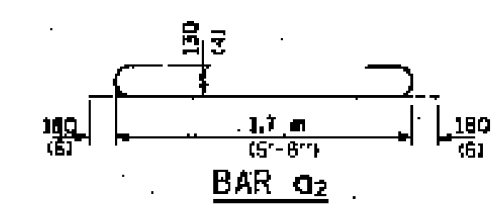
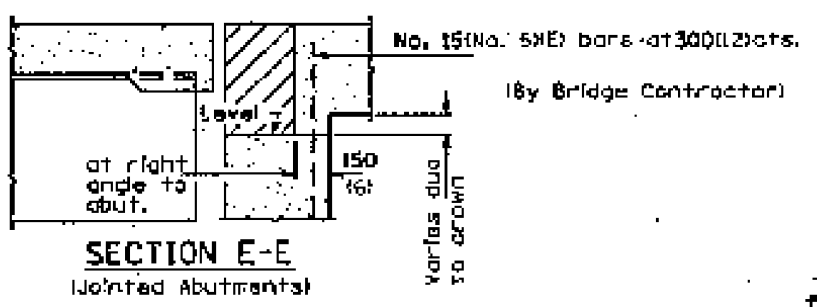
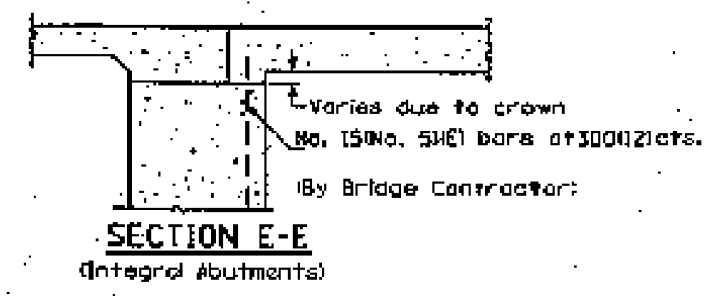
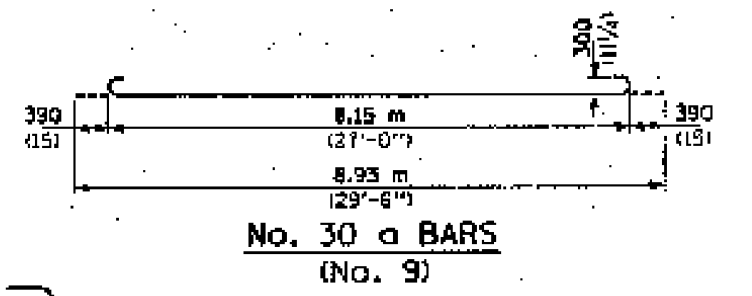

DESIGN STRESSES

$f_y = 400 \text{ MPa (60,000 p.s.i.)}$

$f'_c = 24 \text{ MPa (3,500 p.s.i.)}$

$n = 8.5$

All dimensions are in millimeters (inches) unless otherwise shown.

**BRIDGE APPROACH PAVEMENT**

(Sheet 3 of 3)

**STANDARD 420401-01**

\* FOR INFORMATION ONLY

FILE NAME =	USER NAME = laughlinr1	DESIGNED -	REVISED -	<b>STATE OF ILLINOIS DEPARTMENT OF TRANSPORTATION</b>	<b>BRIDGE APPROACH PAVEMENT</b>			F.A.P. RTE.	SECTION	COUNTY	TOTAL SHEETS	SHEET NO.
en:\pwork\pwid001\LAUGHLINRL\ydn25619\0672813-ShdDetail.dgn		DRAWN -	REVISED -		753	141RS-6&142RS-6		62	62			
PLOT SCALE = 48.0000 / IN.		CHECKED -	REVISED -		SCALE: SHEET NO. OF SHEETS STA. TO STA.			CONTRACT NO. 72813				
PLOT DATE = Feb-05-2010 11:49:04AM		DATE -	REVISED -		ILLINOIS FED. AID PROJECT			SANGAMON, CHRISTIAN				