

STA. 253+98.13 ( IL. 123 ) =  
 STA. 6+78 ( IL. RTE. 97 SOUTH ) =  
 STA. 251+23.81 ( IL. RTE. 97 NORTH ) =

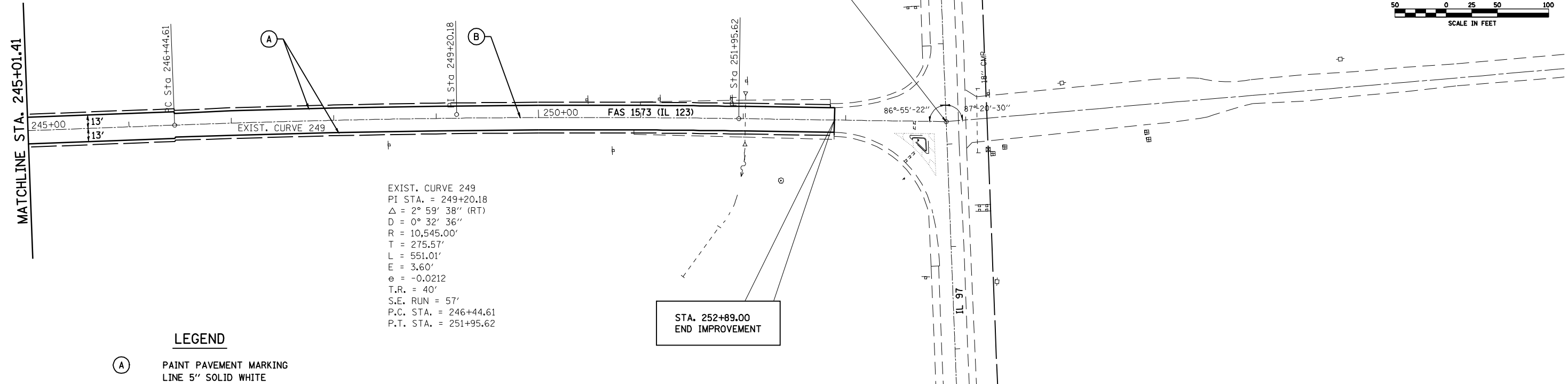

EXIST. CURVE 249  
 P.I. STA. = 249+20.18  
 $\Delta$  = 2° 59' 38" (RT)  
 D = 0° 32' 36"  
 R = 10,545.00'  
 T = 275.57'  
 L = 551.01'  
 E = 3.60'  
 e = -0.0212  
 T.R. = 40'  
 S.E. RUN = 57'  
 P.C. STA. = 246+44.61  
 P.T. STA. = 251+95.62

**LEGEND**

- (A) PAINT PAVEMENT MARKING  
LINE 5" SOLID WHITE
- (B) PAINT PAVEMENT MARKING  
5" SKIP-DASH YELLOW ON CL  
SEE PAVEMENT MARKING SCHEDULE  
FOR LOCATIONS OF NO PASSING  
ZONES.

• SANGAMON & MENARD

FILE NAME =	USER NAME = coxte	DESIGNED -	REVISED -
er\pwork\PWIDOT\COXTE\d0132883\0672088-SHT-plan1.dgn		DRAWN -	REVISED -
PLOT SCALE = 100.0000' / IN.		CHECKED -	REVISED -
PLOT DATE = Mar-26-2010 04:28:01PM		DATE -	REVISED -

**STATE OF ILLINOIS  
 DEPARTMENT OF TRANSPORTATION**

**PLAN SHEET  
 SECTION 101**

SCALE: SHEET NO. OF SHEETS STA. 245+01.41 TO STA. 252+89

F.A.S. RTE.	SECTION	COUNTY	TOTAL SHEETS	SHEET NO.
1573	101 RS-5, 102 RS-4	•	26	24
CONTRACT NO. 72C58			ILLINOIS FED. AID PROJECT	