

STATE OF ILLINOIS
DEPARTMENT OF TRANSPORTATION
DIVISION OF HIGHWAYS

**PROPOSED
HIGHWAY PLANS**

FAS ROUTE 2780 (SLANT RD.)
SECTION 128 RS-2
IL 161 to IL 127
RESURFACING OF SLANT RD.
CLINTON COUNTY

C-98-063-10

F.A.S. RTE.	SECTION	COUNTY	TOTAL SHEETS	SHEET NO.
2780	128 RS-2	CLINTON	14	1
ILLINOIS			76D82	

FOR INDEX OF SHEETS, SEE SHEET NO. 2

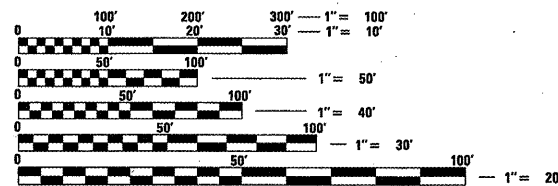
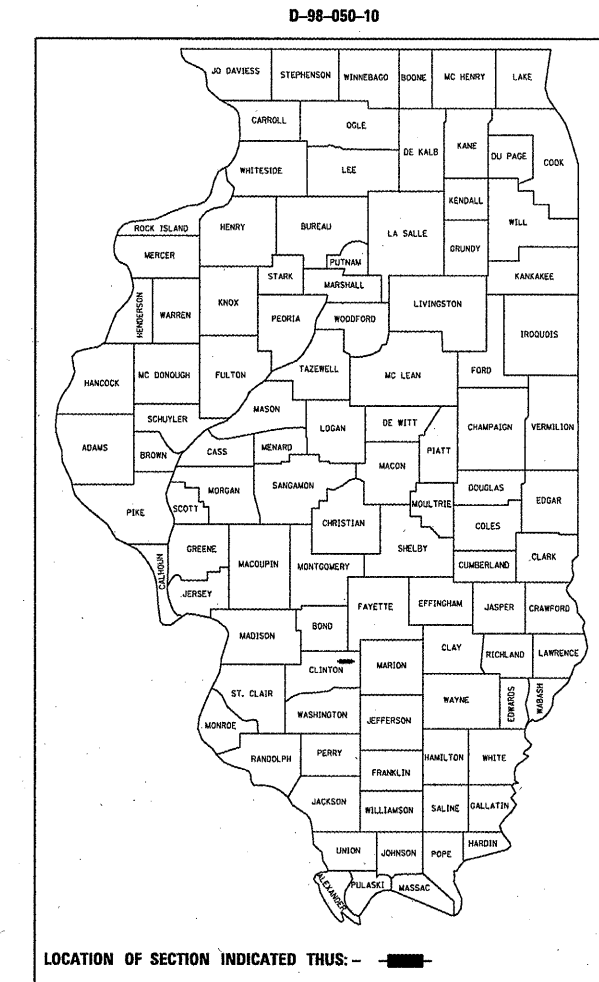

FULL SIZE PLANS HAVE BEEN PREPARED USING STANDARD ENGINEERING SCALES. REDUCED SIZED PLANS WILL NOT CONFORM TO STANDARD SCALES. IN MAKING MEASUREMENTS ON REDUCED PLANS, THE ABOVE SCALES MAY BE USED.

J.U.L.I.E.
JOINT UTILITY LOCATION INFORMATION FOR EXCAVATION
1-800-892-0123
OR 811

PROJECT ENGINEER TIM PADGETT (618) 346-3325
PROJECT MANAGER TOM BORSCH (618) 346-3352

CONTRACT NO. 76D82

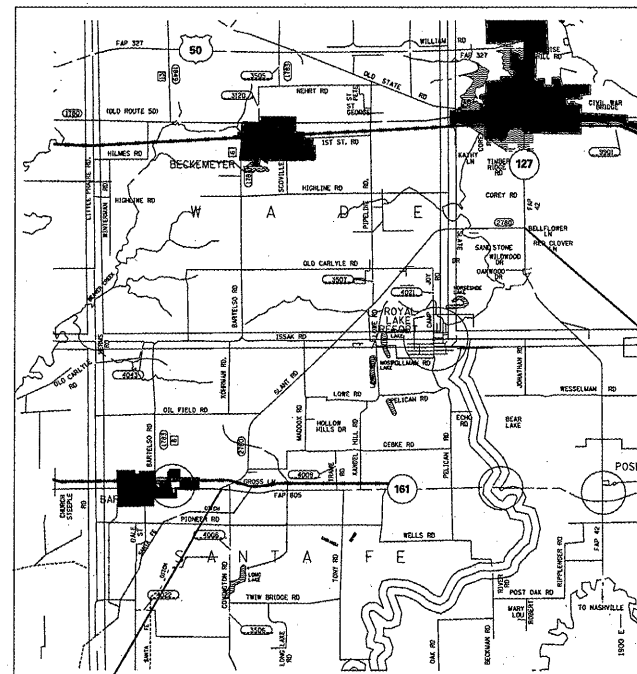

END PROJECT
STA. 311+07

LAT: 38.5880277
LONG: -89.3730282

BEGIN PROJECT
STA. 0+00
LAT: 38.53631655677857
LONG: -89.44763660430908

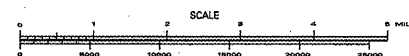

GROSS LENGTH = 31107 FT. = 5.89 MILE
NET LENGTH = 31107 FT. = 5.89 MILE

STATE OF ILLINOIS
DEPARTMENT OF TRANSPORTATION
DIVISION OF HIGHWAYS

SUBMITTED *March 16 20 10*
Scott E. Stipp
DEPUTY DIRECTOR OF HIGHWAYS, REGION ENGINEER

April 9 20 10
Scott E. Stipp
ACTING ENGINEER OF DESIGN AND ENVIRONMENT

April 9 20 10
Christine M. Reeder
DIRECTOR OF HIGHWAYS, CHIEF ENGINEER

PRINTED BY THE AUTHORITY
OF THE STATE OF ILLINOIS