

LEGEND

- ① PROP. THERMOPLASTIC PAVEMENT MARKING LINE 4", YELLOW DASH (DASH 10', SKIP 30')
- ② PROP. THERMOPLASTIC PAVEMENT MARKING LINE, DOUBLE YELLOW SOLID 4"
- ③ PROP. THERMOPLASTIC PAVEMENT MARKING LINE, 6" WHITE
- ④ PROP. THERMOPLASTIC PAVEMENT MARKING LINE, 24" STOP BAR
- ⑤ PROP. THERMOPLASTIC PAVEMENT MARKING LETTERS & SYMBOL

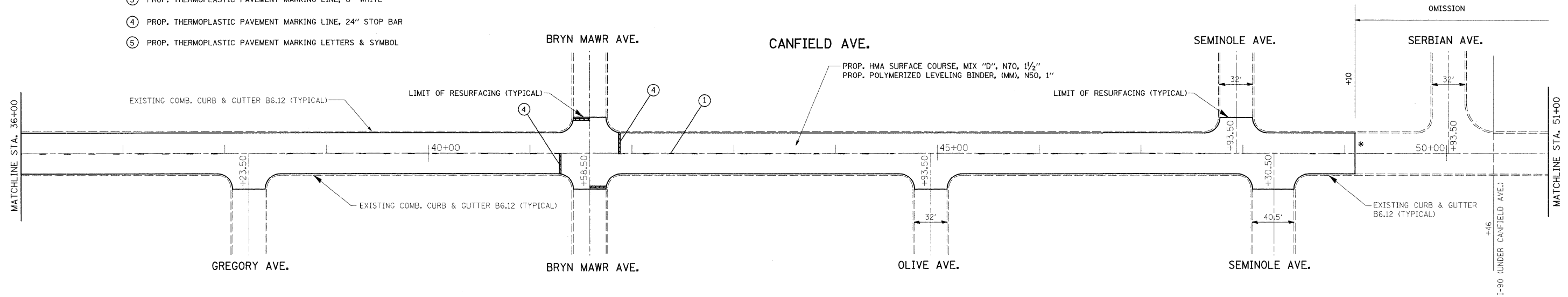

\* BUTT JOINT AND TAPER AS PER IDOT DIST. 1 DETAILS BD-32 ATTACHED.

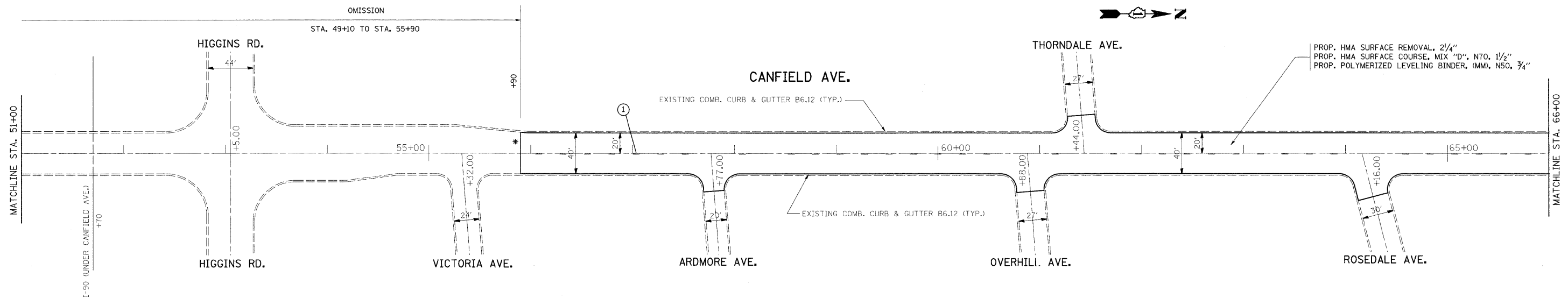

FILE NAME =	USER NAME = drivakosgn	DESIGNED -	REVISED -	<b>STATE OF ILLINOIS DEPARTMENT OF TRANSPORTATION</b>	<b>ROADWAY AND PAVEMENT MARKING PLAN CANFIELD AVE. (FOSTER - DEVON)</b>	F.A.U. RTE.	SECTION	COUNTY	TOTAL SHEETS	SHEET NO.
c:\pwwork\pwwork\drivakosgn\d0136803\0136803-1\plan.dgn	DRAWN -	REVISED -	2761			0102 RS-6	COOK	28	7	
PLOT SCALE = 50,000' / IN.	CHECKED -	REVISED -	CONTRACT NO. 60663							
PLOT DATE = 4/14/2009	DATE -	REVISED -	ILLINOIS FED. AID PROJECT							
					SCALE: 1"=50'	SHEET NO. OF SHEETS STA. TO STA.				