

QUANTITY  
 4 (100) LINE = 64.1 ft. (19.7 m)  
 21.1 sq. ft. (1.97 sq. m)

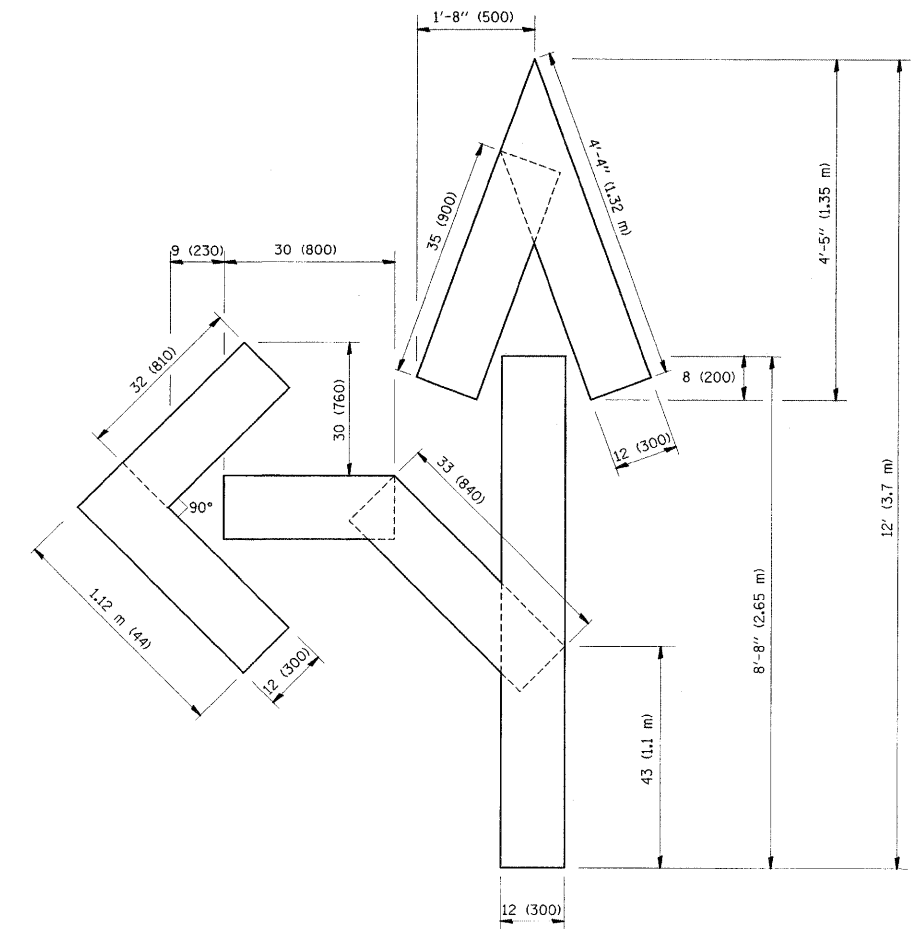

QUANTITY  
 4 (100) LINE = 82.5 ft. (25.3 m)  
 27.5 sq. ft. (2.53 sq. m)

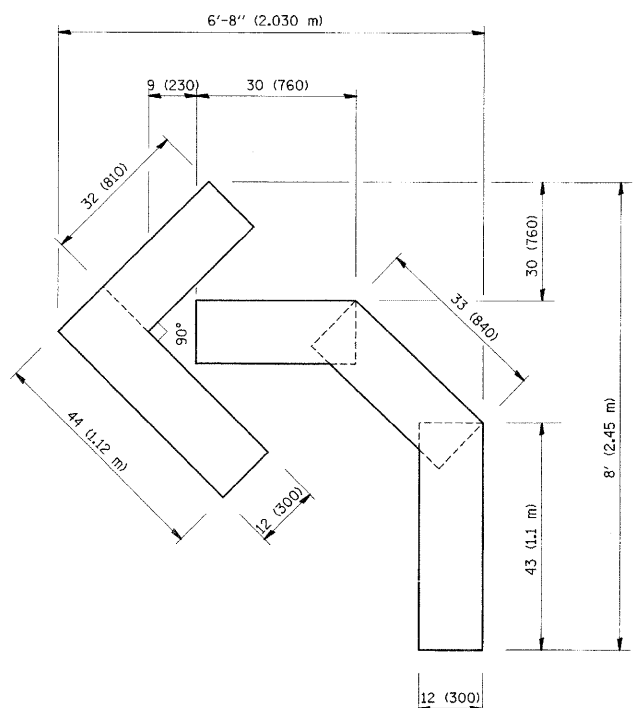

QUANTITY  
 4 (100) LINE = 45.5 ft. (13.9 m)  
 15.2 sq. ft. (1.39 sq. m)

All dimensions are in inches (millimeters) unless otherwise shown.

|                                               |                             |                 |                                |
|-----------------------------------------------|-----------------------------|-----------------|--------------------------------|
| FILE NAME =                                   | USER NAME = drivakosgn      | DESIGNED -      | REVISED -T. RAMMACHER 06-05-96 |
| at:\pwork\pwork\drivakosgn\d0136803\01std.dgn |                             | DRAWN -         | REVISED -T. RAMMACHER 11-04-97 |
|                                               | PLOT SCALE = 50,0000' / IN. | CHECKED -       | REVISED -T. RAMMACHER 03-02-98 |
|                                               | PLOT DATE = 4/11/2009       | DATE - 09-18-94 | REVISED -E. GOMEZ 08-28-00     |

**STATE OF ILLINOIS  
 DEPARTMENT OF TRANSPORTATION**

**PAVEMENT MARKING LETTERS AND SYMBOLS  
 FOR TRAFFIC STAGING**

SCALE: NONE SHEET NO. 1 OF 1 SHEETS STA. TO STA.

|                                                 |           |        |                    |           |
|-------------------------------------------------|-----------|--------|--------------------|-----------|
| F.A.U. RTE.                                     | SECTION   | COUNTY | TOTAL SHEETS       | SHEET NO. |
| 2761                                            | 0102 RS-6 | COOK   | 28                 | 24        |
| TC-16                                           |           |        | CONTRACT NO. 60663 |           |
| FED. ROAD DIST. NO. 1 ILLINOIS FED. AID PROJECT |           |        |                    |           |