

QUANTITY  
 4 (100) LINE = 64.1 ft. (19.7 m)  
 21.1 sq. ft. (1.97 sq. m)

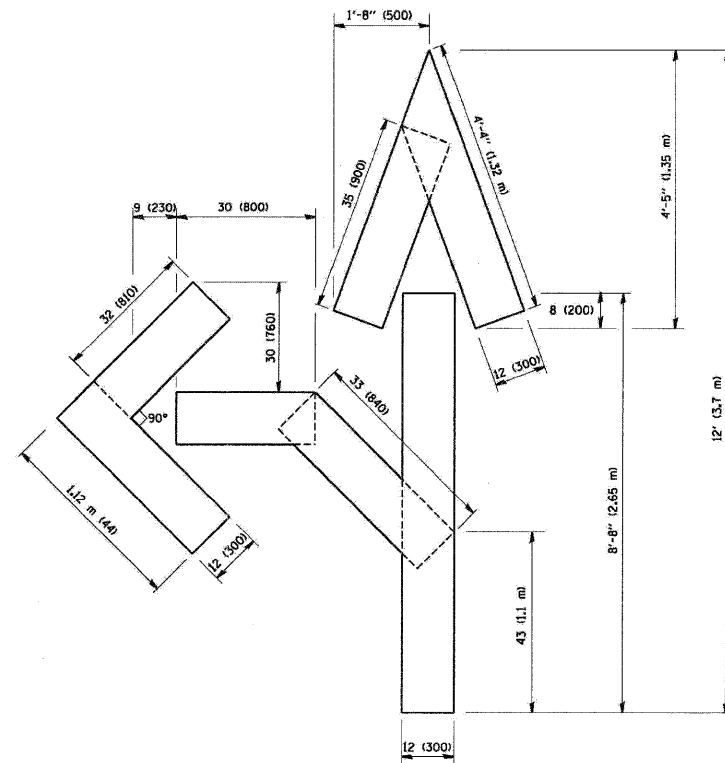

QUANTITY  
 4 (100) LINE = 82.5 ft. (25.3 m)  
 27.5 sq. ft. (2.53 sq. m)

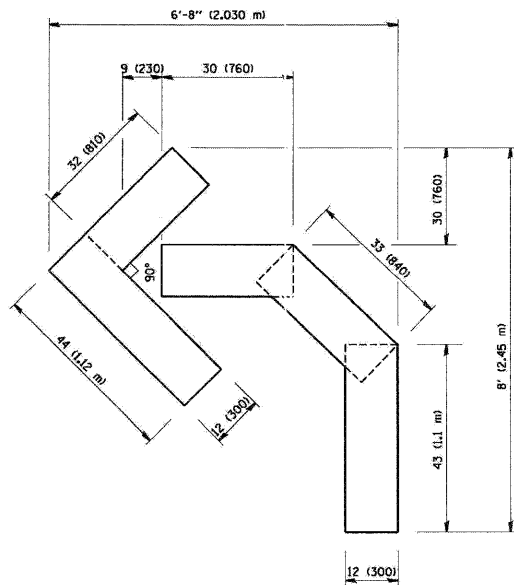

QUANTITY  
 4 (100) LINE = 45.5 ft. (13.9 m)  
 15.2 sq. ft. (1.39 sq. m)

All dimensions are in inches (millimeters) unless otherwise shown.

FILE NAME = W:\disto\22x34\16.dgn	USER NAME = gaglianob	DESIGNED - -	REVISED - -T. RAMMACHER 06-05-96
		DRAWN - -	REVISED - -T. RAMMACHER 11-04-97
		CHECKED - -	REVISED - -T. RAMMACHER 03-02-98
		DATE - 09-18-94	REVISED - -E. GOMEZ 08-28-00

**STATE OF ILLINOIS  
 DEPARTMENT OF TRANSPORTATION**

**PAVEMENT MARKING LETTERS AND SYMBOLS  
 FOR TRAFFIC STAGING**

SCALE: NONE	SHEET NO. 1	OF 1	SHEETS	STA.	TO STA.	F.A.U. RTE.	SECTION	COUNTY	TOTAL SHEETS	SHEET NO.
						TC-16				
						CONTRACT NO.				
						FED. ROAD DIST. NO. 1 ILLINOIS FED. AID PROJECT				

FILE NAME = ...p\12105_Dist1.Det10.dgn	USER NAME = apihely	DESIGNED - AJP	REVISED - -
		DRAWN - IS	REVISED - -
		CHECKED - JR	REVISED - -
		DATE - 4/21/2009	REVISED - -

**STATE OF ILLINOIS  
 DEPARTMENT OF TRANSPORTATION**

**PAVEMENT MARKING LETTERS AND SYMBOLS  
 FOR TRAFFIC STAGING**

SCALE:	SHEET NO.	OF	SHEETS	STA.	TO STA.	F.A.U. RTE.	SECTION	COUNTY	TOTAL SHEETS	SHEET NO.
						3537	3264 RS-5	COOK	21	18
						CONTRACT NO. 60A89				
						FED. ROAD DIST. NO. ILLINOIS FED. AID PROJECT				