

TRAFFIC SIGNAL LEGEND

PROPOSED	EXISTING	
		CONTROLLER
		SERVICE INSTALLATION
		SIGNAL HEAD
		SIGNAL HEAD WITH BACKPLATE
		SIGNAL HEAD, PEDESTRIAN
		SIGNAL POST
		MAST ARM ASSEMBLY AND POLE, STEEL
		MAST ARM ASSEMBLY AND POLE, ALUMINUM
		COMMON TRENCH
		UNIT DUCT
		HANDHOLE
		HEAVY DUTY HANDHOLE
		DOUBLE HANDHOLE
		G.S. CONDUIT IN GROUND
		PEDESTRIAN PUSHBUTTON DETECTOR
		DETECTOR LOOP
		CAST IRON JUNCTION BOX

TRAFFIC SIGNAL LEGEND (continued)

PROPOSED	EXISTING	
		EMERGENCY VEHICLE SYSTEM DETECTOR (FUTURE)
		CONFIRMATION BEACON (FUTURE)
		SIGNAL HEAD OPTICALLY PROGRAMMED
		CONDUIT SPLICE
		WOOD POLE
		RACEWAY FOR MAGNETIC DETECTOR, TYPE I OR TYPE II
		VEHICLE DETECTOR, NON-COMPENSATED MAGNETIC TYPE
		RAILROAD CONTROL CABINET

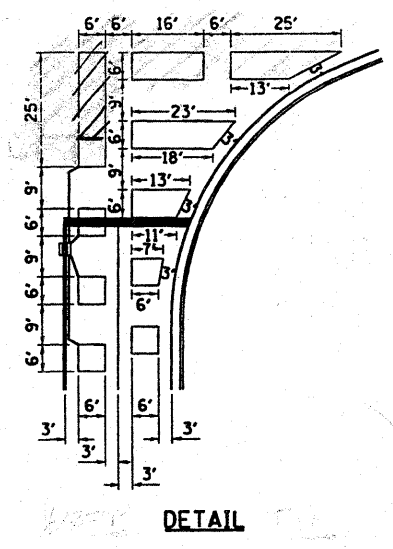
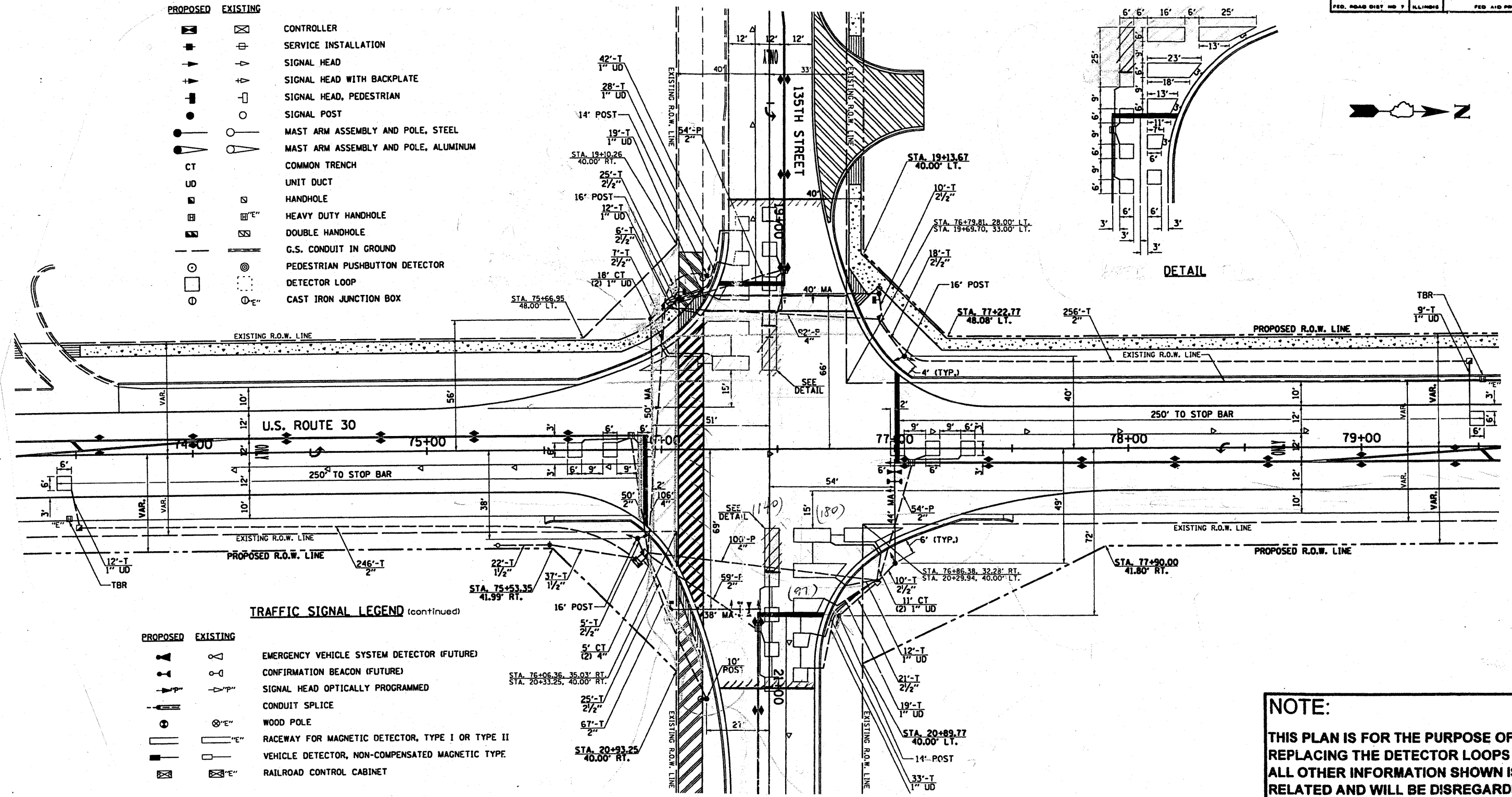

REPLACE ALL DETECTOR LOOPS AS SHOWN
(WITHIN THE RESURFACING LIMITS)

CODE NO.	QUANTITY	UNIT	ITEM
82500600	1,108	Foot	Detector Loop Replacement

NOTE:
THIS PLAN IS FOR THE PURPOSE OF REPLACING THE DETECTOR LOOPS ONLY. ALL OTHER INFORMATION SHOWN IS NOT RELATED AND WILL BE DISREGARDED.

REVISIONS	
NAME	DATE

ILLINOIS DEPARTMENT OF TRANSPORTATION
DETECTOR LOOP REPLACEMENT
U.S. ROUTE 30 @ 135TH STREET

SCALE: NONE
DATE: MAR. 2009

DRAWN BY: JHE
DESIGNED BY: JHE
CHECKED BY: DAD