

F.A.U. RTE.	SECTION	COUNTY	TOTAL SHEETS	SHEET NO.
0361	95(1&2) RS-1	COOK & WILL	29	1
		ILLINOIS	CONTRACT NO. 60F47	

STATE OF ILLINOIS
DEPARTMENT OF TRANSPORTATION
DIVISION OF HIGHWAYS

PROPOSED HIGHWAY PLANS

F.A.U. ROUTE 0361 (NEW AVE.)
ARCHER AVE. TO LOCKPORT ST.
SECTION: 95(1&2) RS-1
RESURFACING (3P)
PROJECT:
COOK AND WILL COUNTIES
C-91-078-09

FOR INDEX OF SHEETS, SEE SHEET NO. 2

IMPROVEMENT LOCATED IN THE VILLAGES OF
LOCKPORT, ROMEOVILLE AND LEMONT

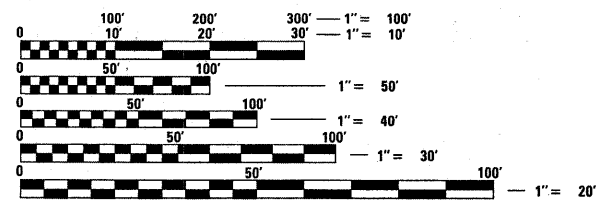

FULL SIZE PLANS HAVE BEEN PREPARED USING STANDARD ENGINEERING SCALES. REDUCED SIZED PLANS WILL NOT CONFORM TO STANDARD SCALES. IN MAKING MEASUREMENTS ON REDUCED PLANS, THE ABOVE SCALES MAY BE USED.

J.U.L.I.E.
JOINT UTILITY LOCATION INFORMATION FOR EXCAVATION
1-800-892-0123
OR 811

PROJECT ENGINEER: JENPAI CHANG (847) 705-4432
PROJECT MANAGER: KEN ENG

CONTRACT NO. 60F47

TRAFFIC DATA:
2004 ADT - 9,800
SPEED LIMIT - 45-50 MPH

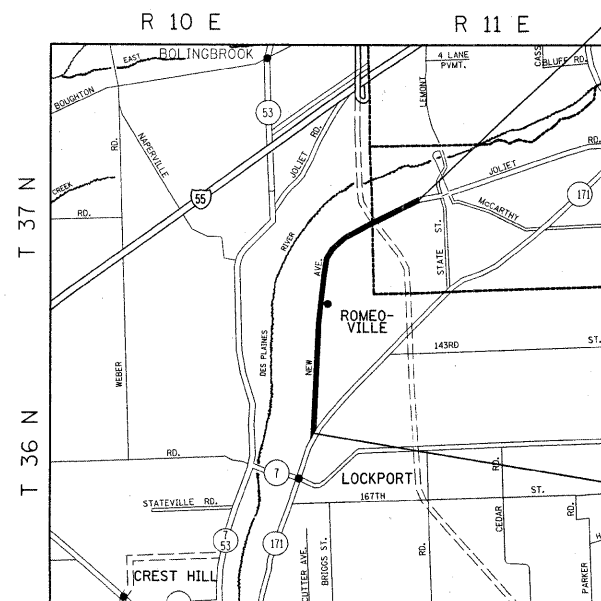

LOCKPORT, DUPAGE AND LEMONT TOWNSHIPS

GROSS LENGTH = 33,489 FT. = 6.34 MILES
NET LENGTH = 33,250 FT. = 6.30 MILES

IMPROVEMENT ENDS
STA. 335+19

OMISSIONS:
STA. 25+37 TO
STA. 25+67
STA. 89+14 TO
STA. 89+98
STA. 92+02 TO
STA. 93+27

IMPROVEMENT BEGINS
STA. 0+30

D-91-078-09

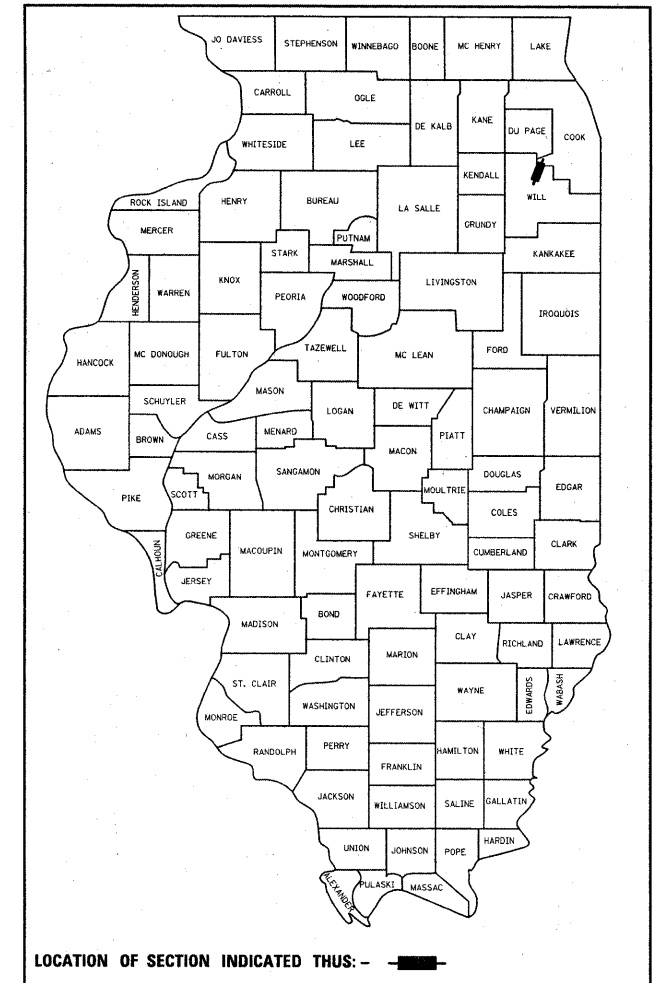

LOCATION OF SECTION INDICATED THUS: -

STATE OF ILLINOIS
DEPARTMENT OF TRANSPORTATION
DIVISION OF HIGHWAYS

SUBMITTED APRIL 2, 2009

Diana M. O'Keefe
DEPUTY DIRECTOR OF HIGHWAYS, REGION ENGINEER

May 1, 2009
Charles J. Ingersoll
ENGINEER OF DESIGN AND ENVIRONMENT

May 1, 2009
Christine M. Reed
DIRECTOR OF HIGHWAYS, CHIEF ENGINEER

PRINTED BY THE AUTHORITY
OF THE STATE OF ILLINOIS