

NOTES:

LIMIT OF RESURFACING ON SIDE-STREETS SHALL BE AS SHOWN ON THE PLANS OR AS DIRECTED BY THE ENGINEER.

ALL FINAL PAVEMENT MARKINGS SHALL BE THERMOPLASTIC (OF THE EXTRUDED TYPE) AND SHOULD BE PLACED IN ACCORDANCE WITH "DISTRICT ONE TYPICAL PAVEMENT MARKINGS" DETAIL, (TC-13).

ALL RAISED REFLECTIVE PAVEMENT MARKERS SHALL BE PLACED IN ACCORDANCE WITH THE DISTRICT ONE "TYPICAL APPLICATIONS RAISED REFLECTIVE PAVEMENT MARKER DETAIL", (TC-11).

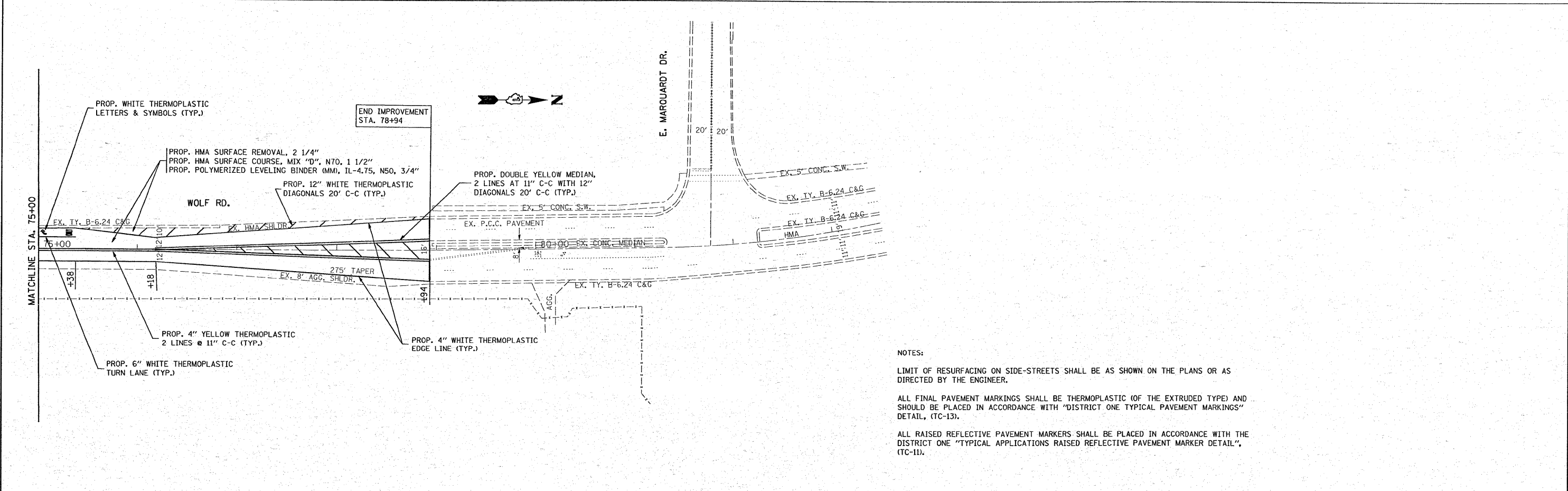

NOTES:

LIMIT OF RESURFACING ON SIDE-STREETS SHALL BE AS SHOWN ON THE PLANS OR AS DIRECTED BY THE ENGINEER.

ALL FINAL PAVEMENT MARKINGS SHALL BE THERMOPLASTIC (OF THE EXTRUDED TYPE) AND SHOULD BE PLACED IN ACCORDANCE WITH "DISTRICT ONE TYPICAL PAVEMENT MARKINGS" DETAIL, (TC-13).

ALL RAISED REFLECTIVE PAVEMENT MARKERS SHALL BE PLACED IN ACCORDANCE WITH THE DISTRICT ONE "TYPICAL APPLICATIONS RAISED REFLECTIVE PAVEMENT MARKER DETAIL", (TC-11).

FILE NAME =	USER NAME = kellers	DESIGNED -	REVISED -	STATE OF ILLINOIS DEPARTMENT OF TRANSPORTATION	WOLF RD. (CAMP McDONALD RD. TO MARQUARDT DR.)				F.A.U. RTE.	SECTION	COUNTY	TOTAL SHEETS	SHEET NO.
09-shr-plan.dgn	09-shr-plan.dgn	DRAWN -	REVISED -		2692	2008-065 RS	COOK	26	10				
PLOT SCALE = 50.0000' / IN.		CHECKED -	REVISED -		SCALE: 1"=50'				SHEET NO. OF SHEETS STA. 60+00 TO STA. 83+49.19				
PLOT DATE = 3/23/2009		DATE -	REVISED -		CONTRACT NO. 60F50				ILLINOIS FED. AID PROJECT				