

TRAFFIC SIGNAL LEGEND

	PROPOSED	EXISTING
DETECTOR LOOP		
SIGNAL HEAD		
G.S. CONDUIT IN TRENCH OR PUSHED		
SIGNAL HEAD WITH BACKPLATE		
RACEWAY FOR MAGNETIC DETECTOR, TYPE I OR II		
VEHICLE DETECTOR, NON-COMPENSATED MAGNETIC TYPE		

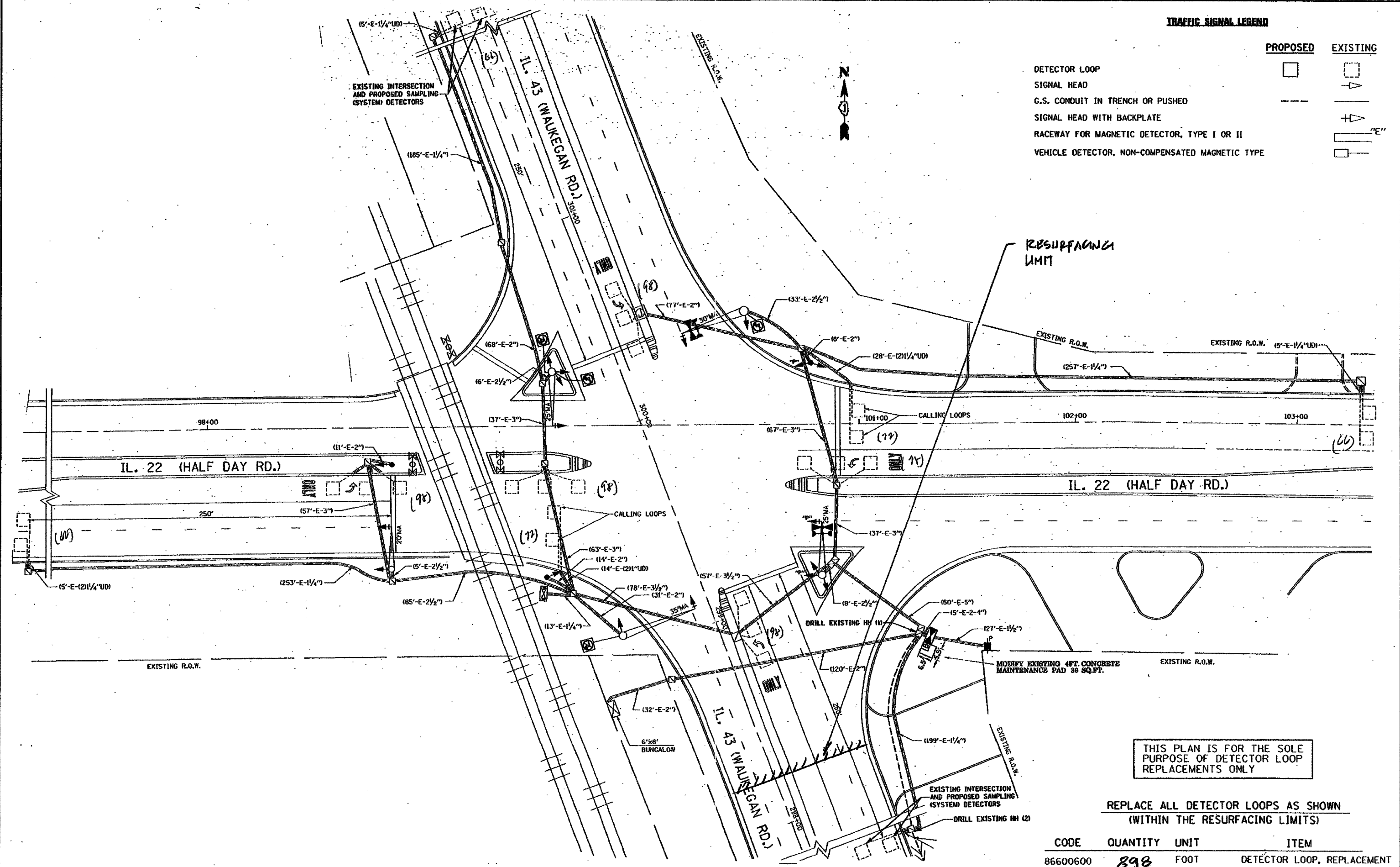

THIS PLAN IS FOR THE SOLE PURPOSE OF DETECTOR LOOP REPLACEMENTS ONLY

REPLACE ALL DETECTOR LOOPS AS SHOWN (WITHIN THE RESURFACING LIMITS)

CODE	QUANTITY	UNIT	ITEM
86600600	898	FOOT	DETECTOR LOOP, REPLACEMENT

FILE NAME =
 c:\p\work\PI\DOT\KANTHAPHILAYBC\d81126

USER NAME = konthaphilaybc
 \traffico.legend.v7.dgn
 PLOT SCALE = 3/4" = 1' IN.
 PLOT DATE = 4/3/2009

DESIGNED - BCK
 DRAWN - BCK
 CHECKED - DAO
 DATE

REVISED -
 REVISED -
 REVISED -
 REVISED -

STATE OF ILLINOIS
 DEPARTMENT OF TRANSPORTATION

DISTRICT ONE - DETECTOR LOOP REPLACEMENT
 IL. RTE. 43 @ IL. RTE. 22
 SCALE: NONE SHEET NO. OF SHEETS STA. TO STA.

F.A.I. RTE.	SECTION	COUNTY	TOTAL SHEETS	SHEET NO.
2700	BY-RS-2	LAKE	37	19

CONTRACT NO. 60670
 ILLINOIS FED. AID PROJECT