

**TRAFFIC SIGNAL LEGEND**

	PROPOSED	EXISTING
DETECTOR LOOP		
SIGNAL HEAD		
G.S. CONDUIT IN TRENCH OR PUSHED		
SIGNAL HEAD WITH BACKPLATE		
RACEWAY FOR MAGNETIC DETECTOR, TYPE I OR II		
VEHICLE DETECTOR, NON-COMPENSATED MAGNETIC TYPE		

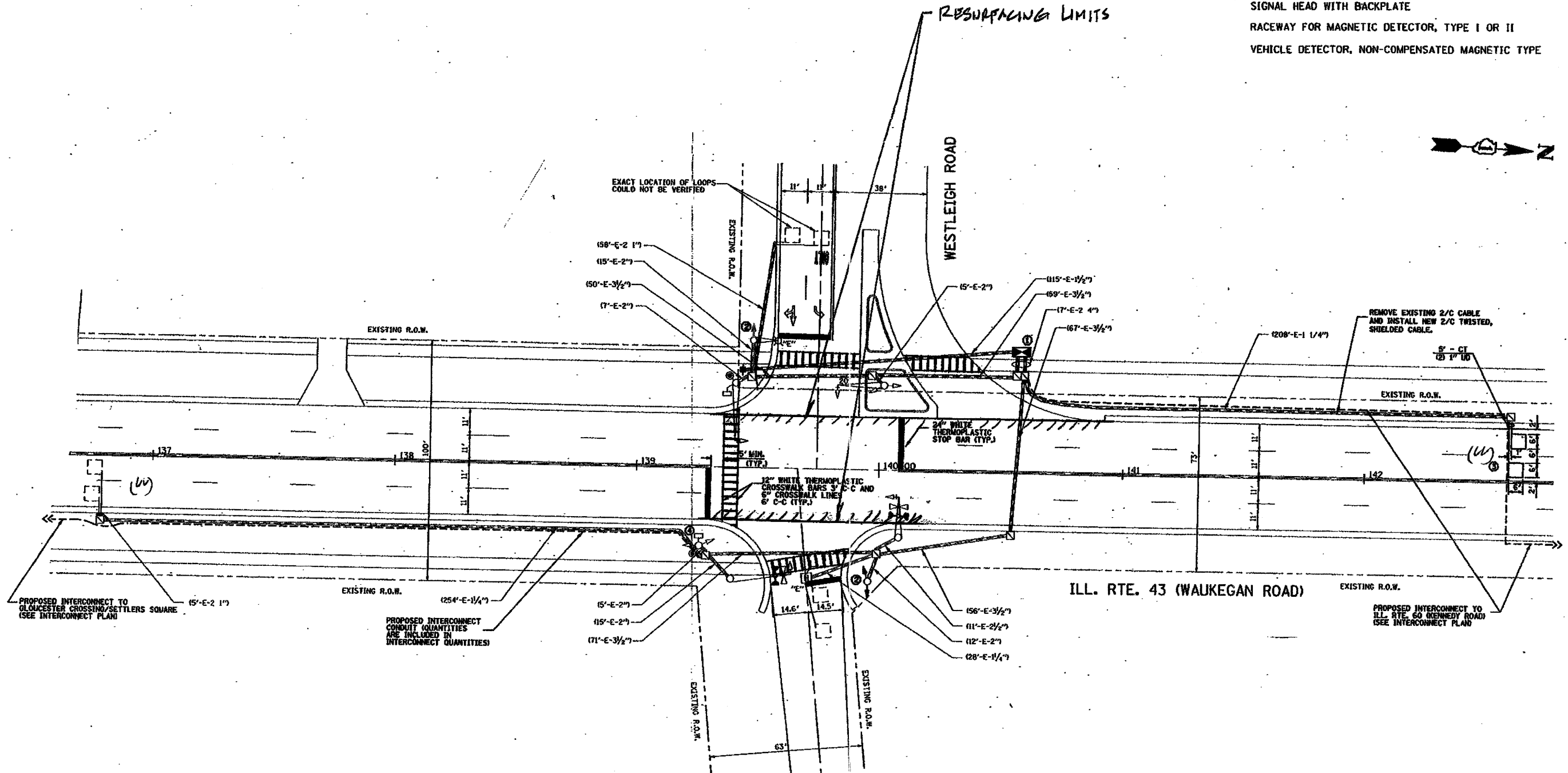

THIS PLAN IS FOR THE SOLE PURPOSE OF DETECTOR LOOP REPLACEMENTS ONLY

REPLACE ALL DETECTOR LOOPS AS SHOWN (WITHIN THE RESURFACING LIMITS)

CODE	QUANTITY	UNIT	ITEM
86600600	132	FOOT	DETECTOR LOOP, REPLACEMENT

FILE NAME =	USER NAME = kanthaphsragbo	DESIGNED - BCK	REVISED -	<b>STATE OF ILLINOIS DEPARTMENT OF TRANSPORTATION</b>	<b>DISTRICT ONE - DETECTOR LOOP REPLACEMENT ILL. ROUTE 43 @ WESTLEIGH ROAD</b>	F.A.H. RTE.	SECTION	COUNTY	TOTAL SHEETS	SHEET NO.
o:\pwork\PH1007\KANTHAPHXATBC\081126	4\trafficsignlegend.v7.dgn	DRAWN - BCK	REVISED -			2760	BY-RS-2	LAKE	37	22
	PLOT SCALE = 3/4" = 1' IN.	CHECKED - DAD	REVISED -			60670				
	PLOT DATE = 4/3/2009	DATE	REVISED -							