

F.A.U. RTE.	SECTION	COUNTY	TOTAL SHEETS	SHEET NO.
0388	99-2AC-3RS-3	WILL	12	1
		ILLINOIS	CONTRACT NO. 60G97	

STATE OF ILLINOIS
DEPARTMENT OF TRANSPORTATION
DIVISION OF HIGHWAYS

**PROPOSED
HIGHWAY PLANS**

F.A.U. ROUTE 0388 /I-55 FRONTAGE ROADS
(BLUFF RD. TO FRONT ST. & BLUFF RD. TO DEAD END)

SECTION: 99-2AC-3RS-3
RESURFACING (3P)
WILL COUNTY

C-91-553-09

FOR INDEX OF SHEETS, SEE SHEET NO. 2

IMPROVEMENT IS LOCATED IN THE VILLAGE OF CHANNAHON

D-91-553-09

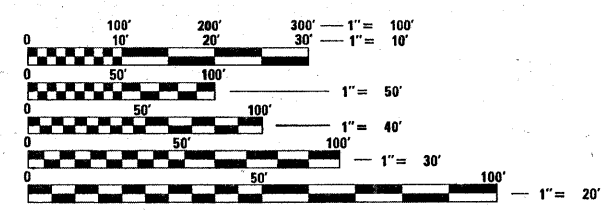
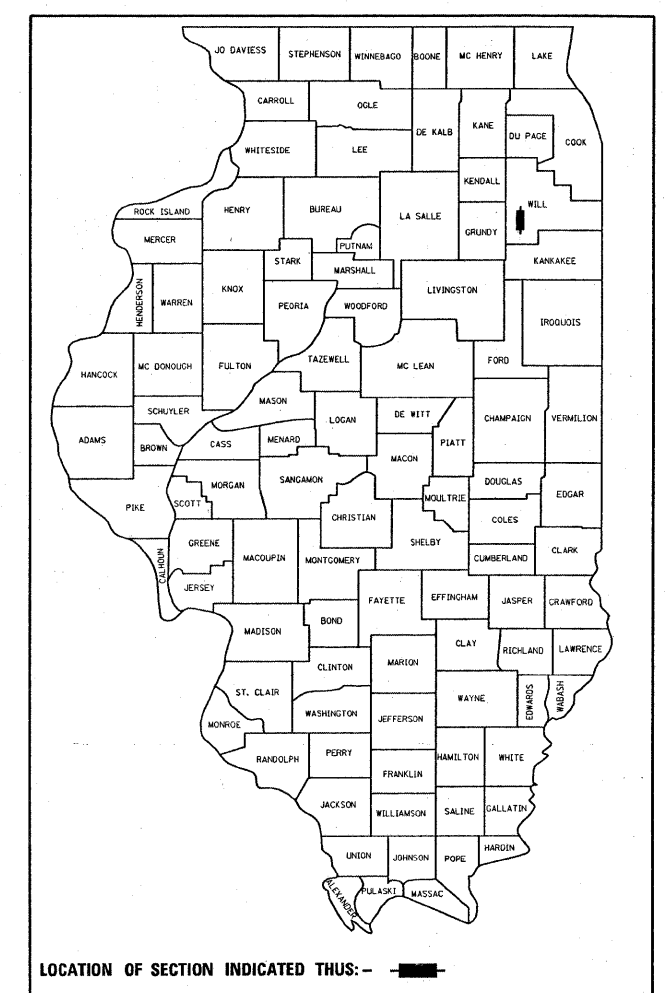

FULL SIZE PLANS HAVE BEEN PREPARED USING STANDARD ENGINEERING SCALES. REDUCED SIZED PLANS WILL NOT CONFORM TO STANDARD SCALES. IN MAKING MEASUREMENTS ON REDUCED PLANS, THE ABOVE SCALES MAY BE USED.

J.U.L.I.E.
JOINT UTILITY LOCATION INFORMATION FOR EXCAVATION
1-800-892-0123
OR 811

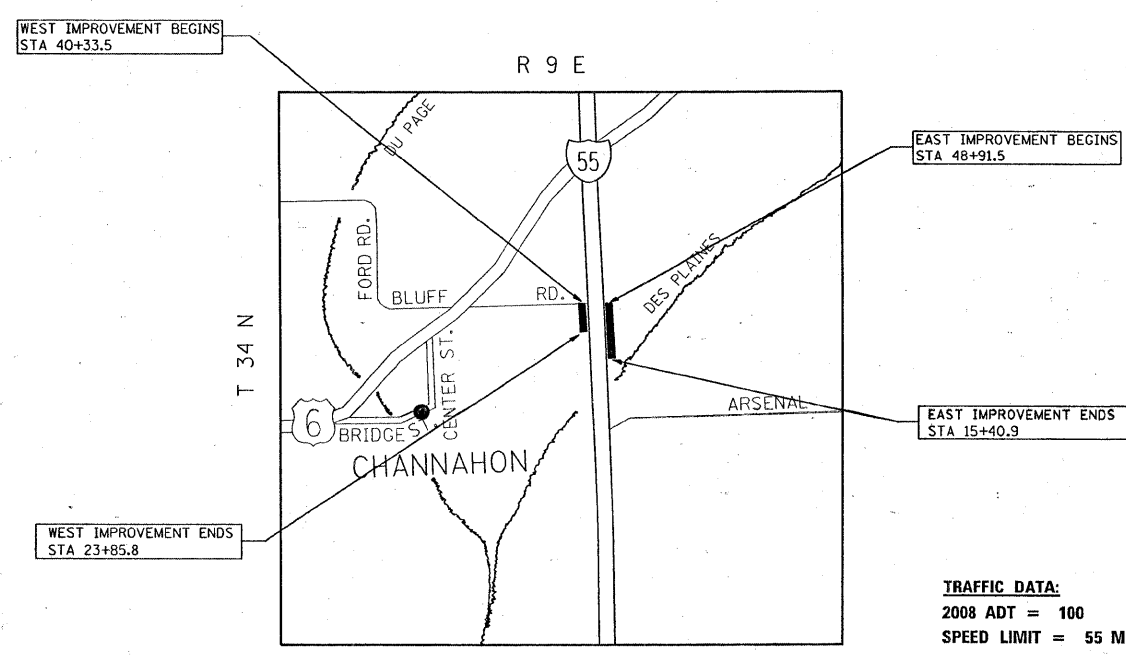

TRAFFIC DATA:
2008 ADT = 100
SPEED LIMIT = 55 MPH

PROJECT ENGINEER: J.P. CHANG (847) 705-4432
PROJECT MANAGER: KEN ENG
CONTRACT NO. 60G97

GROSS AND NET LENGTH OF IMPROVEMENT = 5,040 FT. = 0.96 MILE

STATE OF ILLINOIS
DEPARTMENT OF TRANSPORTATION
DIVISION OF HIGHWAYS

SUBMITTED APRIL 16, 2009

Don M. O'Keefe
DEPUTY DIRECTOR OF HIGHWAYS, REGION ENGINEER

May 1, 2009
Charles G. Ingersoll
ENGINEER OF DESIGN AND ENVIRONMENT

May 1, 2009
Christine M. Reed
DIRECTOR OF HIGHWAYS, CHIEF ENGINEER

PRINTED BY THE AUTHORITY
OF THE STATE OF ILLINOIS

INDEX OF SHEETS

- 1. COVER SHEET
- 2. INDEX OF SHEETS, STATE STANDARDS & GENERAL NOTES
- 3. SUMMARY OF QUANTITIES
- 4. TYPICAL SECTIONS
- 5-7. ROADWAY AND PAVEMENT MARKING PLANS
- 8-12. DISTRICT ONE DETAILS

STATE STANDARDS

- 000001-00 STANDARD SYMBOLS, ABBREVIATIONS AND PATTERNS
- 701201-03 LANE CLOSURE, 2L, 2W, DAY ONLY FOR SPEEDS \geq 45 MPH
- 701301-03 LANE CLOSURE, 2L, 2W, SHORT TIME OPERATIONS
- 701306-02 LANE CLOSURE, 2L, 2W, SLOW MOVING OPERATIONS DAY ONLY, FOR SPEEDS \geq 45 MPH
- 701901-01 TRAFFIC CONTROL DEVICES
- 780001-02 TYPICAL PAVEMENT MARKINGS
- 781001-03 TYPICAL APPLICATIONS RAISED REFLECTIVE PAVEMENT MARKERS

GENERAL NOTES

BEFORE STARTING ANY EXCAVATION, THE CONTRACTOR SHALL CALL "JULIE" AT 1-800-892-0123 FOR FIELD LOCATIONS OF BURIED ELECTRIC, TELEPHONE AND GAS FACILITIES. (48 HOUR NOTIFICATION IS REQUIRED)

THE CONTRACTOR SHALL COORDINATE CONSTRUCTION ACTIVITIES WITH UTILITY COMPANIES AND THE VILLAGE OF CHANNAHON.

CONTRACTOR WILL NOT BE ALLOWED TO SET UP A YARD OR FIELD OFFICE ON STATE PROPERTY WITHOUT WRITTEN PERMISSION FROM THE DEPARTMENT.

WHEN MILLED PAVEMENT IS OPEN TO TRAFFIC, THE MAXIMUM GRADE DIFFERENTIAL BETWEEN PASSES OF THE MILLING MACHINE SHALL NOT EXCEED 1/2" (40 MM) WHERE THE SPEED LIMIT IS 45 MPH (80KM/H) OR LESS AND 1" (25 MM) WHERE THE SPEED LIMIT IS GREATER THAN 45 MPH (80 KM/H). WITH WRITTEN APPROVAL FROM THE ENGINEER, A MAXIMUM GRADE DIFFERENTIAL OF 3" (75MM) MAY BE ALLOWED IF THE EDGE OF THE MILLING IS SLOPED AT A MINIMUM 1:3 (V:H).

HOT-MIX ASPHALT TAPERS SHALL BE INSTALLED AT THE ENDS OF PULVERIZATION (WHERE THE RESURFACING MEETS EXISTING PAVEMENT) IN ACCORDANCE WITH THE "BUTT JOINT AND HMA TAPER DETAILS" SHEET INCLUDED IN THE PLANS UNLESS OTHERWISE NOTED.

BUTT JOINTS WILL BE INSTALLED AT THE ENDS OF ALL RESURFACING (WHERE RESURFACING MEETS EXISTING PAVEMENT) IN ACCORDANCE WITH THE "BUTT JOINT AND HMA TAPER DETAILS" SHEET, WHICH IS INCLUDED IN THE PLANS, UNLESS OTHERWISE SPECIFIED.

THE RESIDENT ENGINEER SHOULD CONTACT CORA MATHIS, AREA TRAFFIC FIELD ENGINEER, AT (815) 485-6475 PRIOR TO INSTALLING ANY PERMANENT PAVEMENT MARKING.

THE RESIDENT ENGINEER SHALL CONTACT THE TRAFFIC CONTROL SUPERVISOR AT (847) 705-4470 A MINIMUM OF 72 HOURS PRIOR TO THE PLACEMENT OF ANY TEMPORARY TRAFFIC CONTROL DEVICES.

FILE NAME =	USER NAME = mossse	DESIGNED -	REVISED -	STATE OF ILLINOIS DEPARTMENT OF TRANSPORTATION	INDEX OF SHEETS, STATE STANDARDS, AND GENERAL NOTES	F.A.U. RTE.	SECTION	COUNTY	TOTAL SHEETS	SHEET NO.
ca:\pwwork\pwwork\mossse\8136450\0155329-shh-plan.dgn	DRAWN -	REVISED -	0388			99-2AC-3RS-3	WILL	12	2	
PLOT SCALE = 50.0000' / IN.	CHECKED -	REVISED -	CONTRACT NO. 60697							
PLOT DATE = 4/16/2009	DATE -	REVISED -	FED. ROAD DIST. NO. ILLINOIS FED. AID PROJECT							
					SCALE:	SHEET NO. OF SHEETS STA.		TO STA.		

SUMMARY OF QUANTITIES			URBAN 100% STATE	CONSTRUCTION TYPE CODE					SUMMARY OF QUANTITIES			CONSTRUCTION TYPE CODE								
CODE NO	ITEM	UNIT		TOTAL QUANTITIES	WEST 1000	EAST 1000					CODE NO	ITEM	UNIT	TOTAL QUANTITIES						
40600200	BITUMINOUS MATERIALS (PRIME COAT)	TON	11	4	7															
40600300	AGGREGATE (PRIME COAT)	TON	46	15	31															
40600895	CONSTRUCTING TEST STRIP	EACH	4	2	2															
40600982	HOT-MIX ASPHALT SURFACE REMOVAL - BUTT JOINT	SO YD	50	25	25															
40603080	HOT-MIX ASPHALT BINDER COURSE, IL-19.0, N50	TON	2880	950	1930															
40603340	HOT-MIX ASPHALT SURFACE COURSE, MIX "D", N70	TON	960	317	643															
48102100	AGGREGATE WEDGE SHOULDER, TYPE B	TON	207	69	138															
67000400	ENGINEER'S FIELD OFFICE, TYPE A	CAL MO	6	2	4															
67100100	MOBILIZATION	L SUM	1	0.3	0.7															
70100450	TRAFFIC CONTROL AND PROTECTION, STANDARD 701201	L SUM	1	0.3	0.7															
70100460	TRAFFIC CONTROL AND PROTECTION, STANDARD 701306	L SUM	1	0.3	0.7															
70300100	SHORT-TERM PAVEMENT MARKING	FOOT	32994	10998	21996															
70300220	TEMPORARY PAVEMENT MARKING - LINE 4"	FOOT	10539	3513	7026															
70301000	WORK ZONE PAVEMENT MARKING REMOVAL	SO FT	11302	3970	7332															
* 78000200	THERMOPLASTIC PAVEMENT MARKING - LINE 4"	FOOT	10539	3513	7026															
* 78100100	RAISED REFLECTIVE PAVEMENT MARKER	EACH	170	65	105															
X0321374	GRADING AND SHAPING SHOULDERS	FOOT	10080	3360	6720															
X0322256	TEMPORARY INFORMATION SIGNING	SO FT	104	52	52															
XX003535	AGGREGATE BASE COURSE, TYPE B, 2"	SO YD	11105	3665	7440															
XX006047	PULVERIZATION	SO YD	11105	3665	7440															
* SPECIALTY ITEMS																				

FILE NAME =
 USER NAME = mo5559
 PLOT SCALE = 50,000 "/ IN.
 PLOT DATE = 4/16/2009

DESIGNED -
 DRAWN -
 CHECKED -
 DATE -

REVISED -
 REVISED -
 REVISED -
 REVISED -

STATE OF ILLINOIS
 DEPARTMENT OF TRANSPORTATION

SUMMARY OF QUANTITIES
 SCALE: SHEET NO. OF SHEETS STA. TO STA.

F.A.U. RTE. 0388	SECTION 99-2AC-3RS-3	COUNTY WILL	TOTAL SHEETS 12	SHEET NO. 3
FED. ROAD DIST. NO. 1 ILLINOIS FED. AID PROJECT			CONTRACT NO. 60G97	

LEGEND

- ① EXISTING HOT-MIX ASPHALT SURFACE COURSE (± 2 1/2")
- ② EXISTING COMPACTED GRAVEL/CRUSHED STONE BASE COURSE, TYPE A (± 7")
- ③ EXISTING SUB-BASE GRANULAR MATERIAL, TYPE B (± 8")
- ④ EXISTING AGGREGATE SHOULDERS
- ⑤ PROPOSED PULVERIZATION (9 1/2")
- ⑥ PROPOSED PULVERIZED MATERIAL (9 1/2")
- ⑦ PROPOSED HMA SURFACE COURSE, MIX "D", N70, (1 1/2")
- ⑧ PROPOSED HMA BINDER COURSE, IL-19.0, N50 (4 1/2")
- ⑨ PROPOSED AGGREGATE BASE COURSE, 2"
- ⑩ PROPOSED AGGREGATE WEDGE SHOULDERS, TYPE B
- ⑪ PROPOSED GRADING & SHAPING SHOULDERS

EXISTING TYPICAL CROSS SECTION

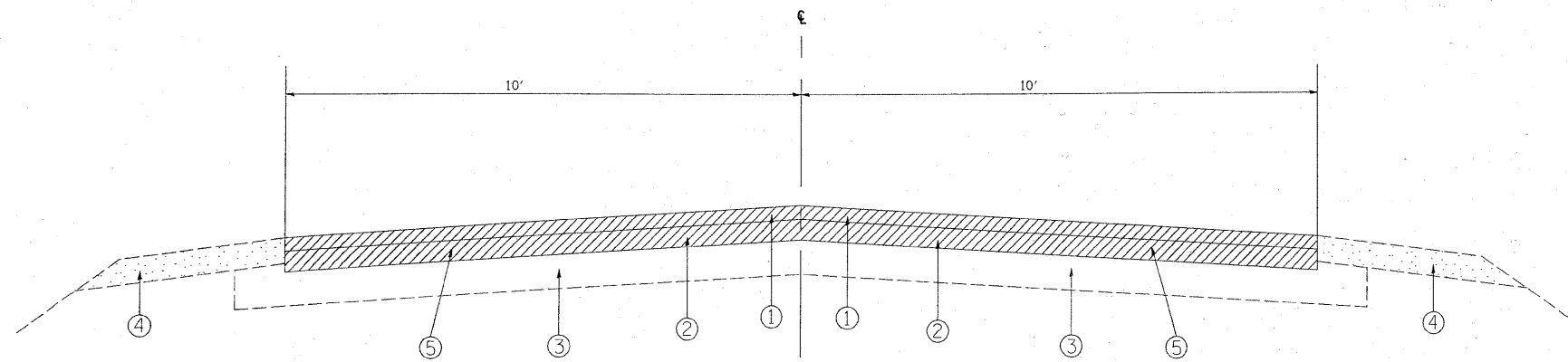

MIXTURE REQUIREMENTS		
MIXTURE USES	AC / PG	DESIGN AIR VOIDS
HMA SURFACE COURSE, MIX "D", N70 (IL-9.5mm)	PG 64-22	4% AT 70 GYRATIONS
HMA BINDER COURSE, IL-19.0 N50	PG 64-22*	4% AT 50 GYRATIONS

THE UNIT WEIGHT USED TO CALCULATE ALL SURFACE MIXTURE QUANTITIES IS 112 LBS/SY/IN.

* WHEN RAP EXCEEDS 20%, THE NEW ASPHALT BINDER IN THE MIX SHALL BE PG-58-22

NOTE: THIS PROJECT WILL UTILIZE PULVERIZATION

PROPOSED TYPICAL CROSS SECTION

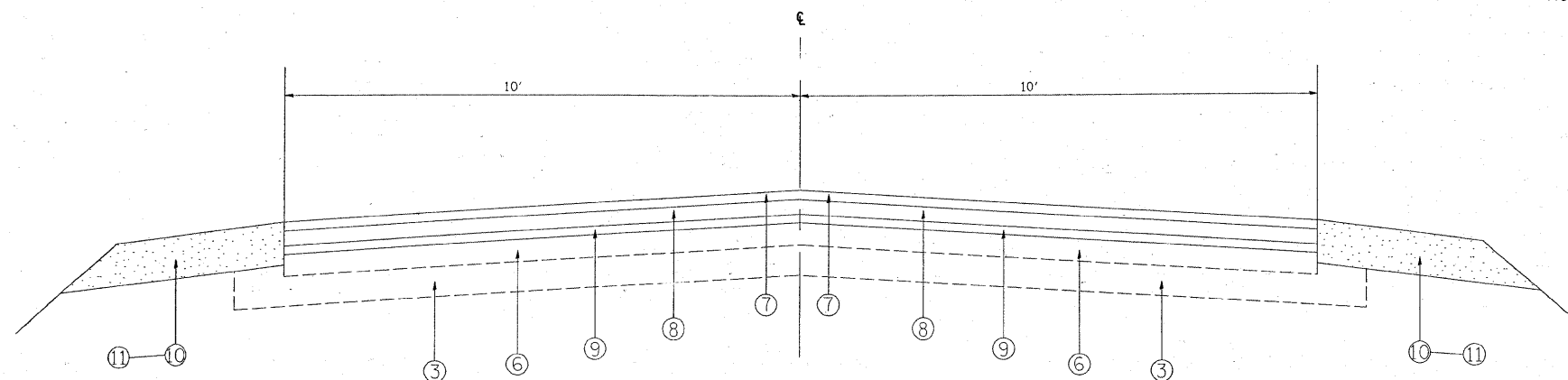

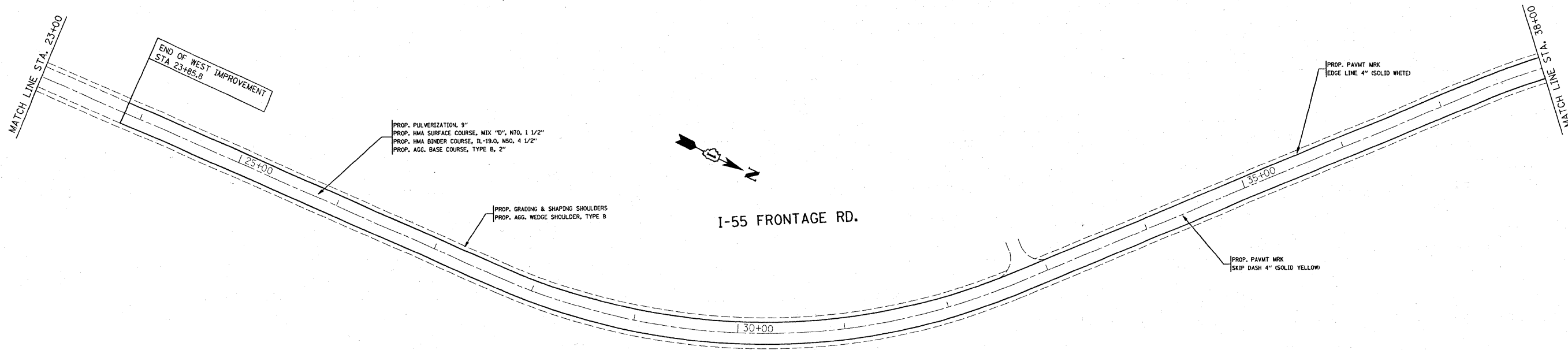

PROP. PULVERIZATION, 9"
 PROP. HMA SURFACE COURSE, MIX "D", N70, 1 1/2"
 PROP. HMA BINDER COURSE, IL-19.0, N50, 4 1/2"
 PROP. AGG. BASE COURSE, TYPE B, 2"

PROP. GRADING & SHAPING SHOULDERS
 PROP. AGG. WEDGE SHOULDER, TYPE B

PROP. PAVMT MKK
 EDGE LINE 4" SOLID WHITE

PROP. PAVMT MKK
 SKIP DASH 4" SOLID YELLOW

I-55 FRONTAGE RD.

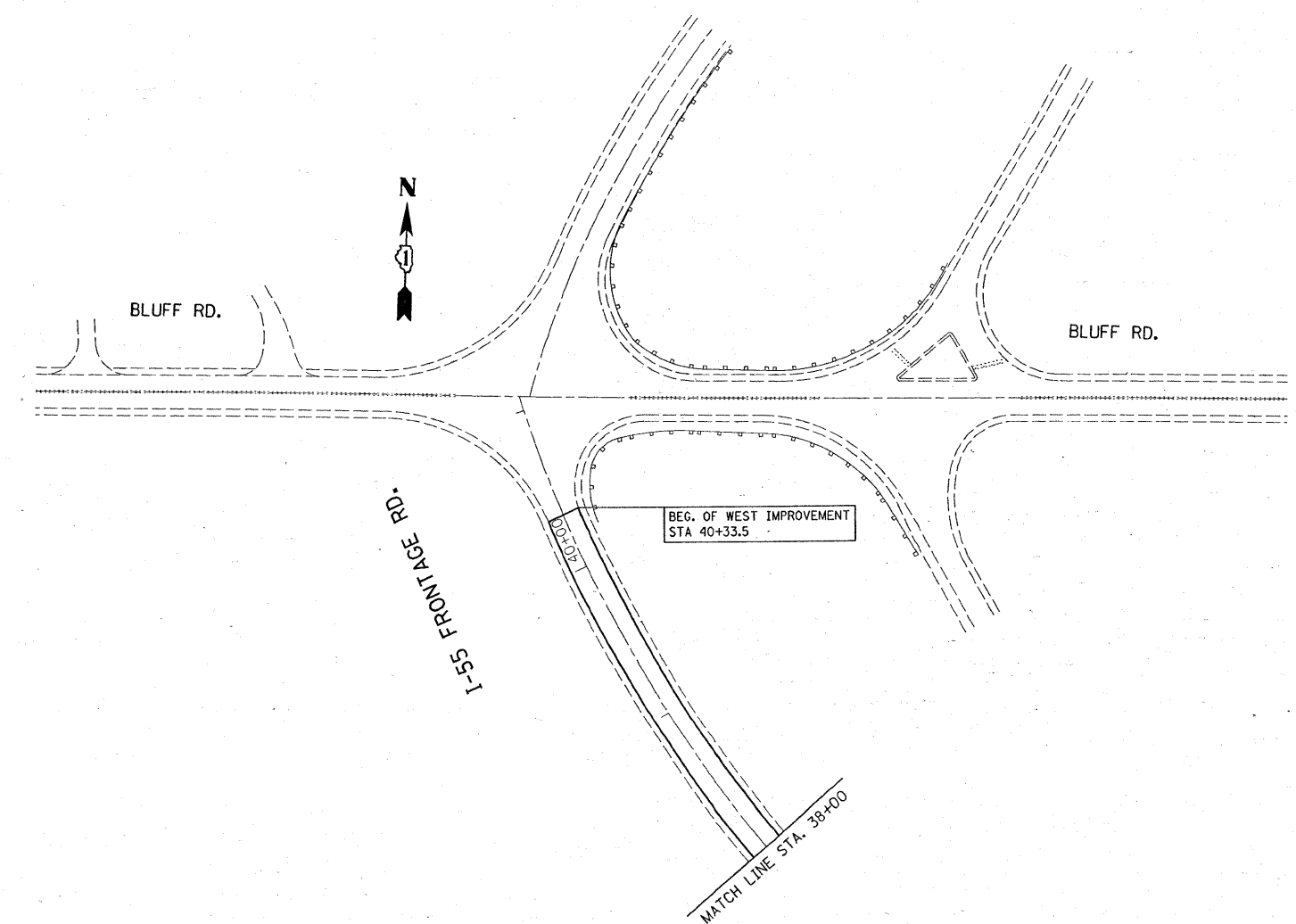

BEG. OF WEST IMPROVEMENT
 STA 40+33.5

BLUFF RD.

BLUFF RD.

I-55 FRONTAGE RD.

MATCH LINE STA. 38+00

FILE NAME = c:\pw_work\PWIDOT\MOSSSE\0136450\0155309-sht-plan.dgn	USER NAME = mosse	DESIGNED -	REVISED -	STATE OF ILLINOIS DEPARTMENT OF TRANSPORTATION	I-55 FRONTAGE RD. (W. FRONTAGE RD.) BLUF RD. TO DEAD END		F.A.U. RTE. 0388	SECTION 99-2AC-3RS-3	COUNTY WILL	TOTAL SHEETS 12	SHEET NO. 5
	PLOT SCALE = 50.0000' / IN.	DRAWN -	REVISED -		SCALE:	SHEET NO.	OF SHEETS	STA.	TO STA.	CONTRACT NO. 60697 ILLINOIS FED. AID PROJECT	
PLOT DATE = 4/16/2009	CHECKED -	REVISD -	REVISD -								

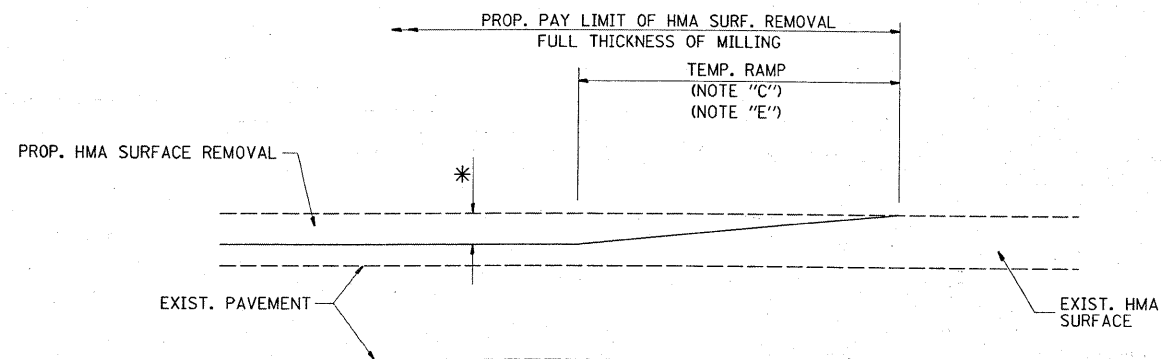

MILLED TEMPORARY RAMP
(FOR BUTT JOINT AND HMA TAPER SEE DETAIL BELOW)

OPTION 1

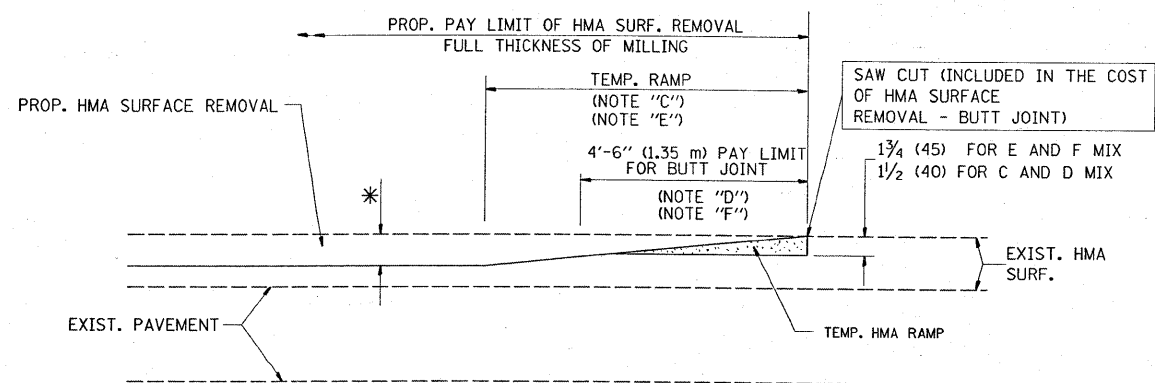

HMA CONSTRUCTED TEMPORARY RAMP
(FOR BUTT JOINT AND HMA TAPER SEE DETAIL BELOW)

OPTION 2

TYPICAL TEMPORARY RAMP

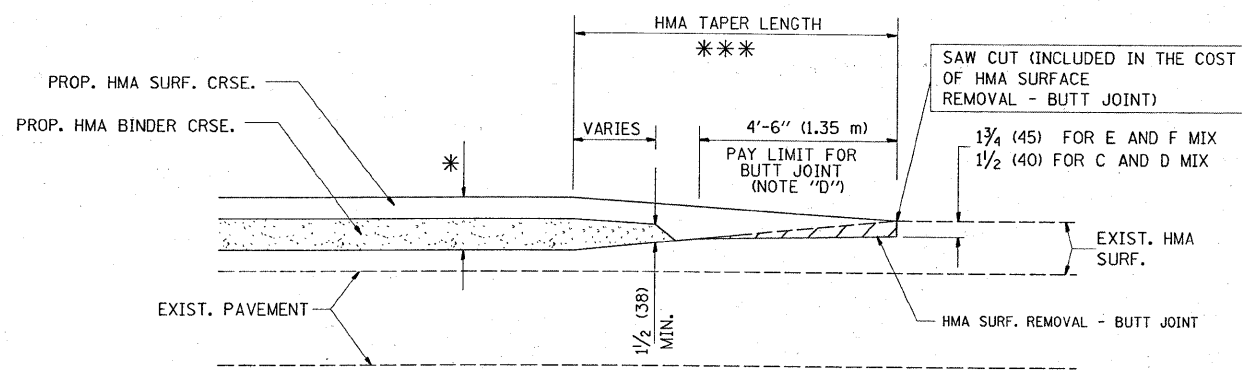

BUTT JOINT AND
HMA TAPER

TYPICAL BUTT JOINT AND HMA TAPER
FOR MILLING AND RESURFACING

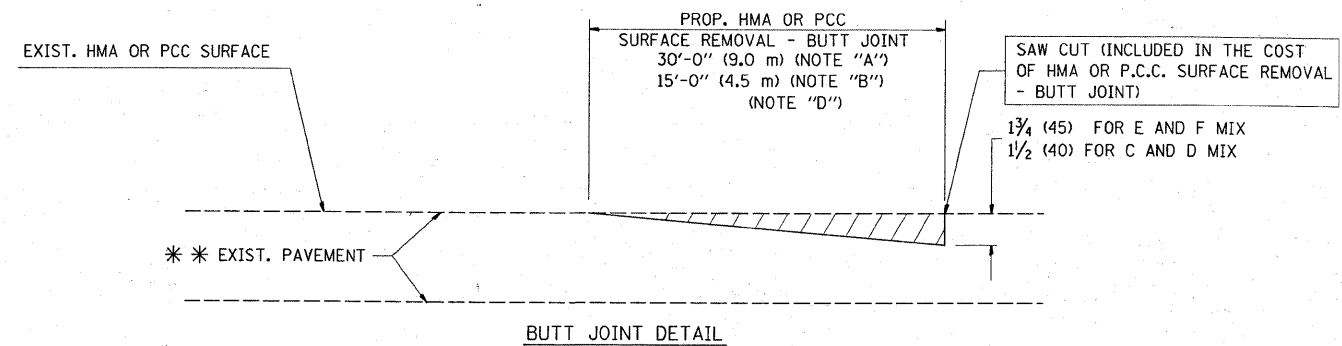

BUTT JOINT DETAIL

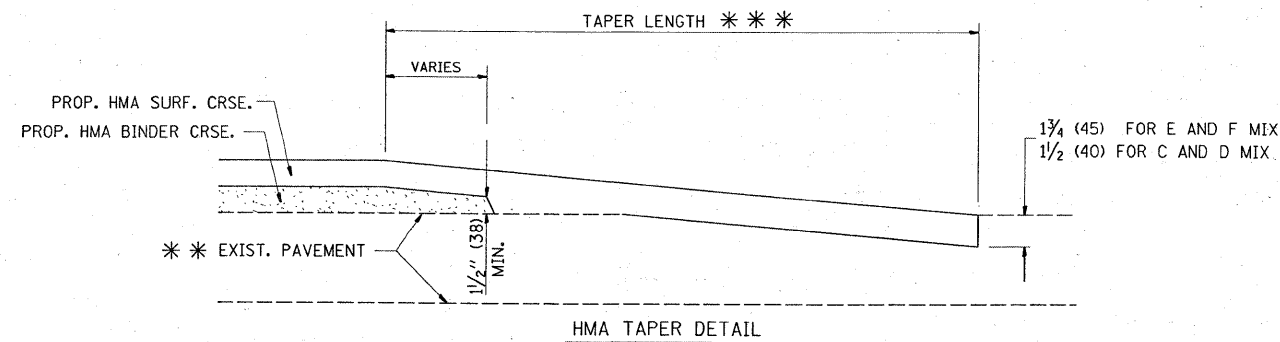

HMA TAPER DETAIL

TYPICAL BUTT JOINT AND HMA TAPER
FOR RESURFACING ONLY

*** PC CONCRETE, HMA OR HMA RESURFACED PAVEMENT.

NOTES

- A: MAINLINE ROADWAYS AND MAJOR SIDE ROADS.
 - B: MINOR SIDE ROADS.
 - C: THE TEMP. RAMP SHALL BE CONSTRUCTED IMMEDIATELY UPON REMOVAL OF THE EXISTING HMA SURFACE.
 - D: THE BUTT JOINT SHALL BE CONSTRUCTED IMMEDIATELY PRIOR TO PLACING THE PROPOSED HMA COURSES.
 - E: TAPER THE TEMP. RAMP AT A RATE OF 3'-0" (900 mm) PER 1 INCH (25 mm) OF MILLING THICKNESS.
 - F: INSTALLATION AND REMOVAL OF THE 4'-6" (1.35 m) TEMP. RAMP IS INCLUDED IN COST OF HMA SURFACE REMOVAL - BUTT JOINT
 - G: SEE ARTICLE 406.08 AND 406.14 OF THE STANDARD SPECIFICATIONS FOR "HMA AND/OR PCC SURFACE REMOVAL, BUTT JOINT".
- * SEE TYPICAL SECTIONS FOR MILLING THICKNESS.
- *** 20'-0" (6.1 m) PER 1 (25) RESURFACING (NOTE "A")
10'-0" (3.0 m) PER 1 (25) RESURFACING (NOTE "B")

BASIS OF PAYMENT:

THE BUTT JOINT WILL BE PAID FOR AT THE CONTRACT UNIT PRICE PER SQUARE YARD (SQUARE METER) FOR "HOT-MIX ASPHALT SURFACE REMOVAL - BUTT JOINT" OR FOR "PORTLAND CEMENT CONCRETE SURFACE REMOVAL - BUTT JOINT".

ALL DIMENSIONS ARE IN INCHES (MILLIMETERS) UNLESS OTHERWISE SHOWN.

FILE NAME =	USER NAME = mosso	DESIGNED - M. DE YONG	REVISED - R. SHAH 10-25-94
ci:\pw\work\PIWIDOT\MOSSE\10136450\Dist5\del.dgn		DRAWN -	REVISED - A. ABBAS 03-21-97
PLOT SCALE = 50.0000 "/ IN.		CHECKED -	REVISED - M. GOMEZ 04-06-01
PLOT DATE = 4/16/2009		DATE - 06-13-90	REVISED - R. BORO 01-01-07

STATE OF ILLINOIS
DEPARTMENT OF TRANSPORTATION

BUTT JOINT AND
HMA TAPER DETAILS

SCALE: NONE SHEET NO. 1 OF 1 SHEETS STA. TO STA.

F.A.U. RTE.	SECTION	COUNTY	TOTAL SHEETS	SHEET NO.
0388	99-2AC-3RS-3	WILL	12	8
BD400-05 BD32		CONTRACT NO. 60697		
FED. ROAD DIST. NO. 1 ILLINOIS FED. AID PROJECT				

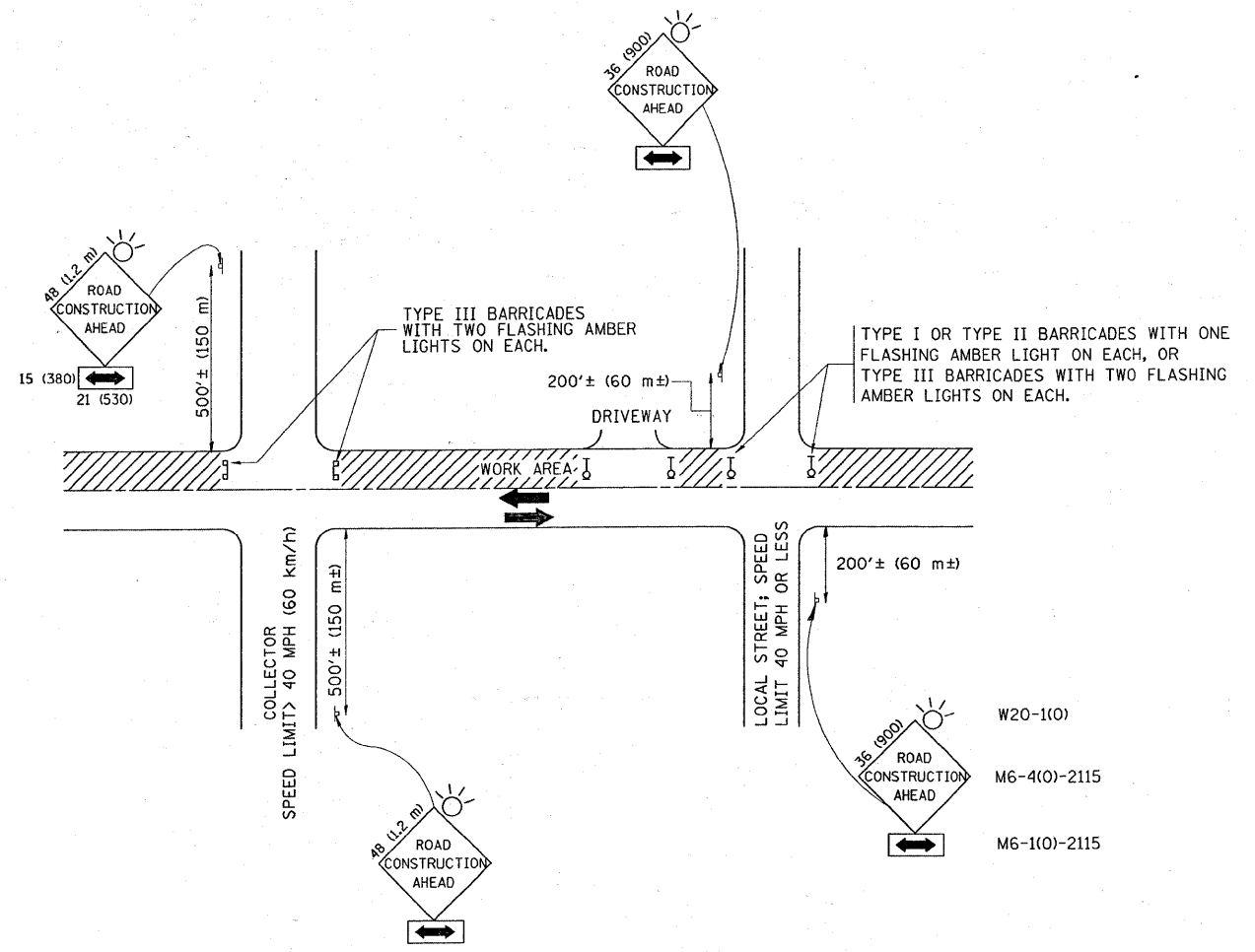

TRAFFIC CONTROL AND PROTECTION FOR SIDE ROADS, INTERSECTIONS, AND DRIVEWAYS

NOTES:

- A. FOR NO LANE RESTRICTION ON THE SIDE ROAD OR DRIVEWAYS
- SIDE ROAD WITH A SPEED LIMIT OF 40 MPH (60 km/h) OR LESS AS SHOWN ON THE DRAWING AND AS DIRECTED BY THE ENGINEER:
 - ONE ROAD CONSTRUCTION AHEAD SIGN 36 x 36 (900x900) WITH A FLASHER AND FLAG MOUNTED ON IT APPROXIMATELY 200' (60 m) IN ADVANCE OF THE MAIN ROUTE.
 - THE CLOSED PORTION OF THE MAIN ROUTE SHALL BE PROTECTED BY BLOCKING WITH TYPE I, TYPE II OR TYPE III BARRICADES, 1/3 OF THE CROSS SECTION OF THE CLOSED PORTION.
 - SIDE ROAD WITH A SPEED LIMIT GREATER THAN 40 MPH (60 km/h) AS SHOWN ON THE DRAWING AND AS DIRECTED BY THE ENGINEER:
 - ONE ROAD CONSTRUCTION AHEAD SIGN 48 x 48 (1.2 m x 1.2 m) WITH A FLASHER MOUNTED ON IT APPROXIMATELY 500' (150 m) IN ADVANCE OF THE MAIN ROUTE.
 - THE CLOSED PORTION OF THE MAIN ROUTE SHALL BE PROTECTED BY BLOCKING WITH TYPE III BARRICADES, 1/2 OF THE CROSS SECTION OF THE CLOSED PORTION.
 - WHEN THE SIDE ROAD LIES BETWEEN THE BEGINNING OF THE MAINLINE SIGNING AND THE WORK ZONE, A SINGLE HEADED ARROW (M6-1) SHALL BE USED IN LIEU OF THE DOUBLE HEADED ARROW (M6-4).
- B. FOR A LANE CLOSURE ON A SIDE ROAD OR DRIVEWAY:
- USE APPLICABLE PORTIONS OF THE TYPICAL APPLICATION OF TRAFFIC CONTROL DEVICES (STD. 701501, STD. 701606 OR THE APPROPRIATE STANDARD). THE SPACING OF SIGNS AND BARRICADES SHALL BE ADJUSTED FOR FIELD CONDITIONS AS DIRECTED BY THE ENGINEER. THE DIRECTIONAL ARROW SHALL BE COVERED OR REMOVED WHEN NO LONGER CONSISTENT WITH THE SIDE ROAD LANE CLOSURE.
- C. ADVANCE WARNING SIGNS ARE TO BE OMITTED ON DRIVEWAY UNLESS OTHERWISE NOTED.
- D. THE TRAFFIC CONTROL AND PROTECTION FOR SIDE ROADS, INTERSECTIONS, AND DRIVEWAYS SHALL BE INCIDENTAL TO THE COST OF SPECIFIED TRAFFIC CONTROL STANDARDS OR ITEMS.

All dimensions are in millimeters (inches) unless otherwise shown.

FILE NAME =	USER NAME = moosse	DESIGNED - LHA	REVISED - J. OBERLE 10-18-95	STATE OF ILLINOIS DEPARTMENT OF TRANSPORTATION	TRAFFIC CONTROL AND PROTECTION FOR SIDE ROADS, INTERSECTIONS, AND DRIVEWAYS			F.A.I. RTE.	SECTION	COUNTY	TOTAL SHEETS	SHEET NO.
c:\pw_work\PW1001\MOSSSE\d8136450\01.st5	skd.dgn	DRAWN -	REVISED - A. HOUSEH 03-06-96		0388	99-2AC-3RS-3	WILL	12	9			
	PLOT SCALE = 50.0000" / IN.	CHECKED -	REVISED - A. HOUSEH 10-15-96		TC-10			CONTRACT NO. 60G97				
	PLOT DATE = 4/16/2009	DATE - 06-89	REVISED - T. RAMMACHER 01-06-00		SCALE: NONE	SHEET NO. 1 OF 1 SHEETS	STA. TO STA.	FED. ROAD DIST. NO. 1 ILLINOIS FED. AID PROJECT				

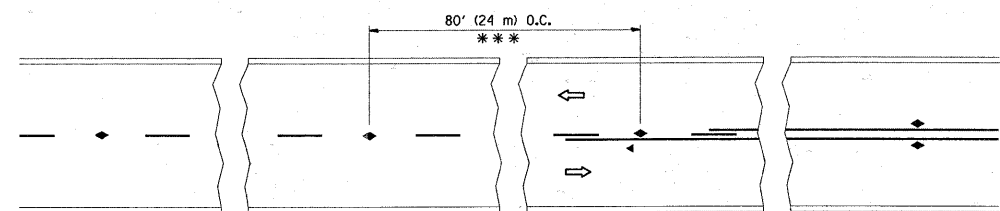

*** REDUCE TO 40' (12 m) O.C. ON CURVES WITH POSTED OR ADVISORY SPEED 45 M.P.H. (70 km/h) OR LESS.

TWO-LANE/TWO-WAY

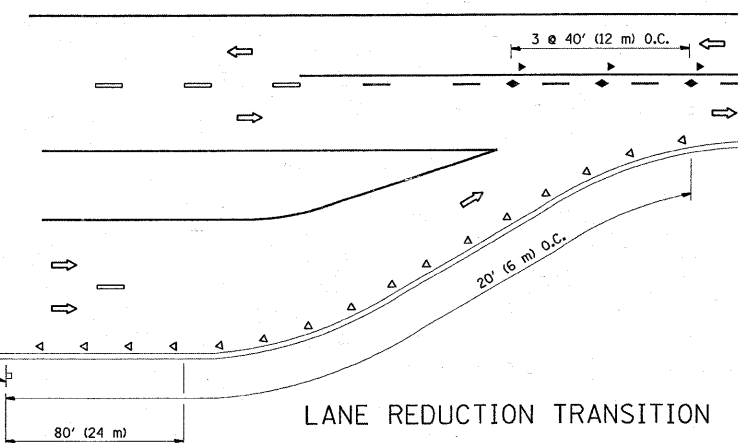

LANE REDUCTION TRANSITION

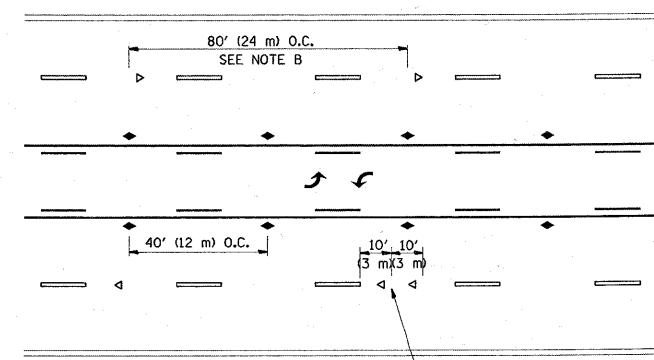

TWO-WAY LEFT TURN

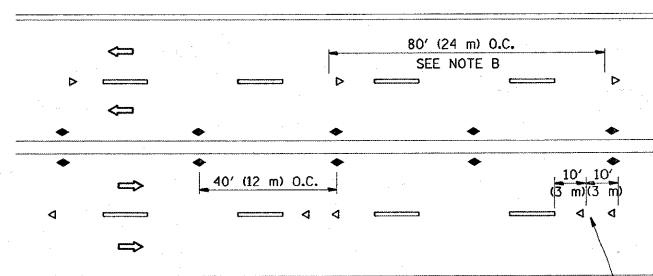

MULTI-LANE/UNDIVIDED

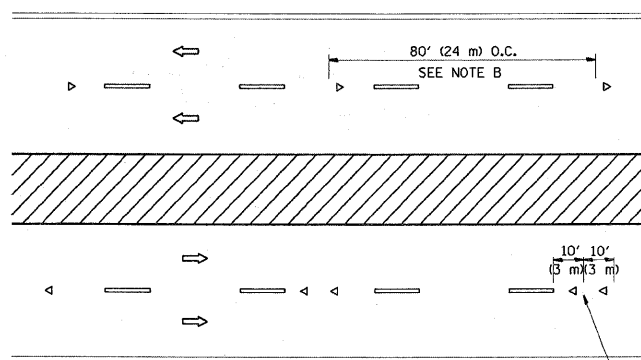

MULTI-LANE/DIVIDED

GENERAL NOTES

1. MARKERS USED WITH DASHED LINES SHALL BE CENTERED IN THE GAP BETWEEN SEGMENTS.
2. MARKERS USED ADJACENT TO SOLID LINES SHALL BE OFFSET 2 TO 3 (50 TO 75) TOWARD TRAFFIC AS SHOWN.
3. MARKERS THROUGH TANGENTS LESS THAN 500' (150 m) IN LENGTH BETWEEN CURVES SHALL BE INSTALLED AT THE LESSER OF THE TWO CURVE SPACINGS.

SYMBOLS

- YELLOW STRIPE
- WHITE STRIPE
- ◀ ONE-WAY AMBER MARKER
- ◁ ONE-WAY CRYSTAL MARKER (W/O)
- ◆ TWO-WAY AMBER MARKER

LANE MARKER NOTES

- B. REDUCE TO 40' (12 m) O.C. ON CURVES WHERE ADVISORY SPEEDS ARE 10 M.P.H (20 km/h) LOWER THAN POSTED SPEEDS.
- A. USE DOUBLE LANE LINE MARKERS SPACED AS SHOWN.

DESIGN NOTES

1. DOUBLE LANE LINE MARKERS SHALL BE USED UNLESS SPECIFIED OTHERWISE.
2. EXCEPT AS SHOWN ON THE LANE REDUCTION TRANSITION AND FREEWAY EXIT RAMP DETAIL, MARKERS ARE NOT TO BE SPECIFIED ON RIGHT EDGE LINES.
3. THE EXACT MARKER LIMITS, SPACING, AND COLOR SHOULD BE INCLUDED IN THE PLANS.
4. MARKERS SHOULD NOT BE USED ALONGSIDE CURBS EXCEPT FOR EXTREMELY SHORT SECTIONS OF CURBS WHERE NOT MORE THAN TWO MARKERS WOULD BE INVOLVED.

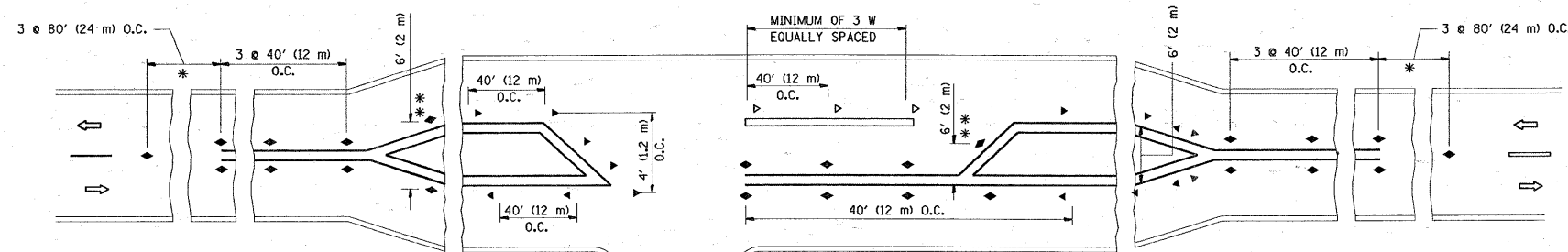

LEFT TURN

* SEE TWO-LANE/TWO-WAY WHERE MARKERS CONTINUE
 ** WHERE THE MEDIAN WIDTH IS 6' (2 m) OR LESS USE TWO-WAY MARKERS.

All dimensions are in inches (millimeters) unless otherwise shown.

FILE NAME =	USER NAME = mossse	DESIGNED -	REVISED - T. RAMMACHER 09-19-94
		DRAWN -	REVISED - T. RAMMACHER 03-12-99
	PLOT SCALE = 50,0000' / IN.	CHECKED -	REVISED - T. RAMMACHER 01-06-00
	PLOT DATE = 4/16/2009	DATE -	REVISED -

STATE OF ILLINOIS
 DEPARTMENT OF TRANSPORTATION

TYPICAL APPLICATIONS		F.A.U. RTE.	SECTION	COUNTY	TOTAL SHEETS	SHEET NO.
RAISED REFLECTIVE PAVEMENT MARKERS (SNOW-PLOW RESISTANT)		0388	99-2AC-3RS-3	WILL	12	10
SCALE: NONE		SHEET NO. 1 OF 1 SHEETS		TO STA.		CONTRACT NO. 60G97
FED. ROAD DIST. NO. 1 ILLINOIS FED. AID PROJECT						

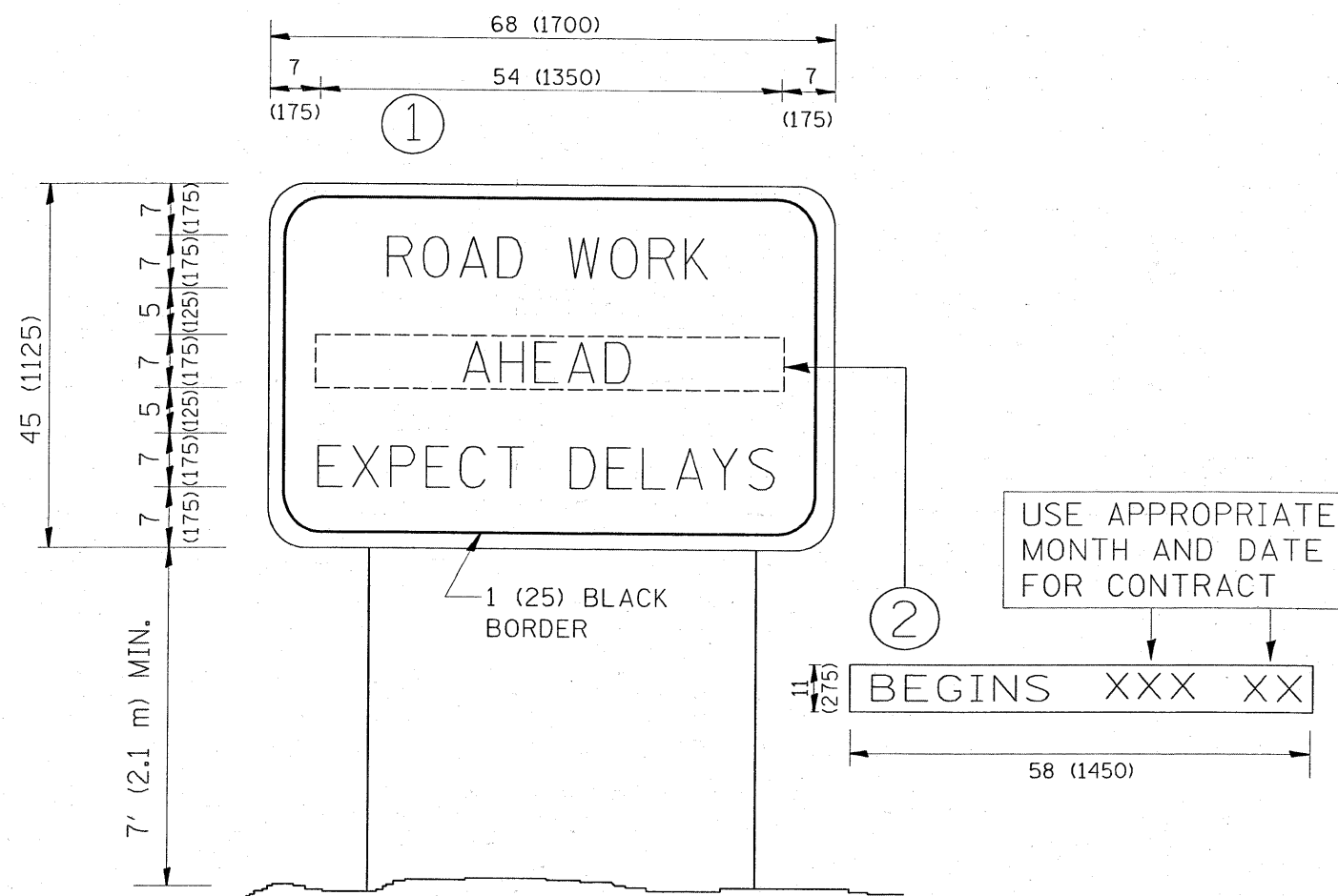

NOTES:

1. USE BLACK LETTERING ON ORANGE BACKGROUND.
2. ERECT SIGNS IN ADVANCE OF THE LOCATION FOR THE "ROAD CONSTRUCTION AHEAD" SIGN AT LOCATIONS AS DIRECTED BY THE ENGINEER.
3. ERECT SIGN ① WITH INSTALLED PANEL ② ONE WEEK PRIOR TO THE START OF CONSTRUCTION.
4. REMOVE PANEL ② SOON AFTER THE START OF CONSTRUCTION.
5. SEE SPECIAL PROVISION FOR "TEMPORARY INFORMATION SIGNING" FOR ADDITIONAL INFORMATION.
6. ONE SIGN ASSEMBLY EQUALS 25.70 SQ. FT. (2.3 SQ. M.)
7. SHALL BE PAID FOR AS TEMPORARY INFORMATION SIGNING.

ALL DIMENSIONS ARE IN INCHES (MILLIMETERS) UNLESS OTHERWISE SHOWN.

FILE NAME =	USER NAME = mosso	DESIGNED -	REVISED - R. MIRS 09-15-97	STATE OF ILLINOIS DEPARTMENT OF TRANSPORTATION	ARTERIAL ROAD INFORMATION SIGN		F.A.U. RTE.	SECTION	COUNTY	TOTAL SHEETS	SHEET NO.	
os:\pwork\PMIDOT\MOSSE\0136450\101st.dgn		DRAWN -	REVISED - R. MIRS 12-11-97		SCALE: NONE	SHEET NO. 1 OF 1 SHEETS	STA.	TO STA.	0388	99-2AC-3RS-3	WILL	12 12
PLOT SCALE = 50.0000 "/ IN.		CHECKED -	REVISED - T. RAMMACHER 02-02-99						TC-22		CONTRACT NO. 60G97	
PLOT DATE = 4/16/2009		DATE -	REVISED - C. JUCIUS 01-31-07						FED. ROAD DIST. NO. 1 ILLINOIS FED. AID PROJECT			