

F.A.U. RTE.	SECTION	COUNTY	TOTAL SHEETS	SHEET NO.
2744	(113 & 113W) RS-10	LAKE	18	1
FED. ROAD DIST. NO. 1	ILLINOIS	CONTRACT NO. 60H08		

D-91-564-09

STATE OF ILLINOIS
DEPARTMENT OF TRANSPORTATION

DIVISION OF HIGHWAYS
**PROPOSED
HIGHWAY PLANS**

F.A.U. 2744 (SHERIDAN ROAD)
BLODGETT AVENUE TO ILLINOIS ROUTE 137 (BUCKLEY ROAD)
SECTION (113 & 113W) RS-10
RESURFACING (3P)
LAKE COUNTY
C-91-564-09

FOR INDEX OF SHEETS, SEE SHEET NO. 2

IMPROVEMENT LOCATED WITHIN THE CITY OF LAKE FOREST,
VILLAGE OF LAKE BLUFF AND CITY OF NORTH CHICAGO



TRAFFIC DATA
SHERIDAN ROAD
2007 ADT = 5,000
SPEED LIMIT = 40 MPH (NB)
SPEED LIMIT = 50 to 40 MPH (SB)

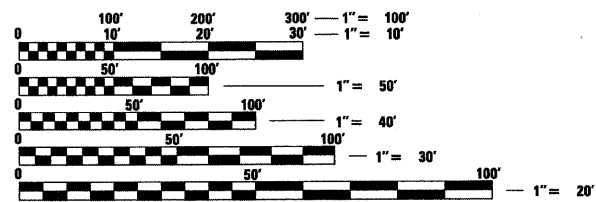

FULL SIZE PLANS HAVE BEEN PREPARED USING STANDARD
ENGINEERING SCALES. REDUCED SIZED PLANS WILL NOT
CONFORM TO STANDARD SCALES. IN MAKING MEASUREMENTS
ON REDUCED PLANS, THE ABOVE SCALES MAY BE USED.

J.U.L.I.E.
JOINT UTILITY LOCATION INFORMATION FOR EXCAVATION
1-800-892-0123
OR 811

DISTRICT ONE -
PROJECT MANAGER: LONG TRAN (847) 705-4232
PROJECT ENGINEER: MICHELLE AQUINO (847) 705-4606

CONTRACT NO. 60H08

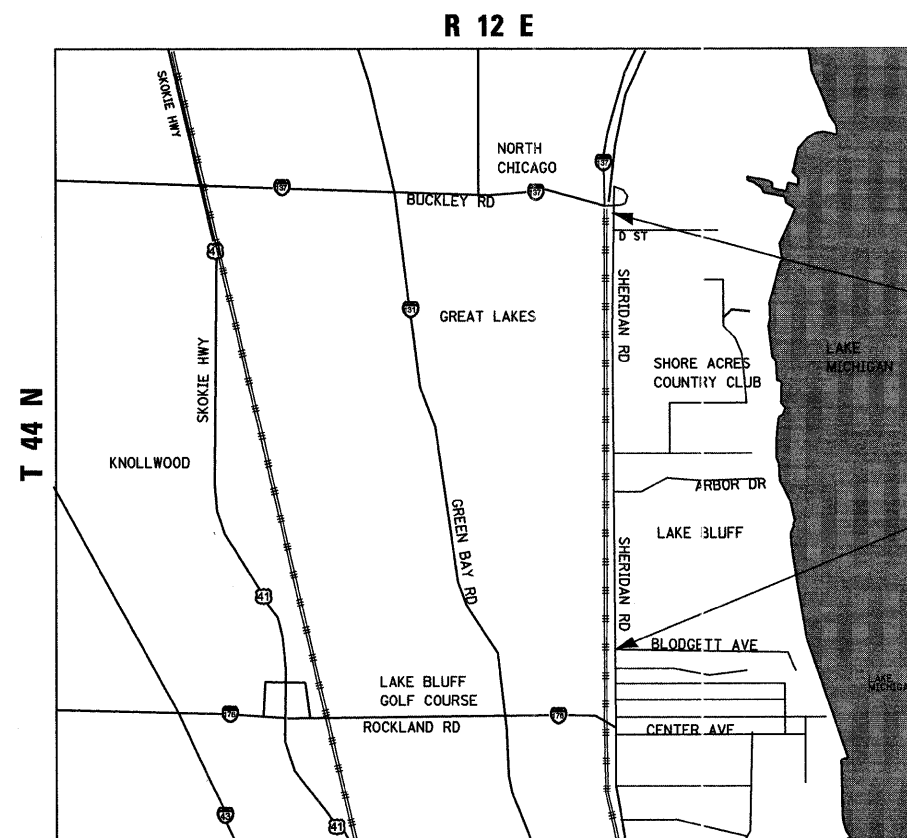

IMPROVEMENT ENDS
STA. 97 + 47

IMPROVEMENT BEGINS
STA. 10 + 27

SCALE: NTS

SHIELDS TOWNSHIP
GROSS & NET LENGTH OF PROJECT = 8720 FT = 1.65 MILES

MILLENNIA PROFESSIONAL SERVICES
THOMAS V. NGO, P.E.
* 062-058379

DATE: 04/16/09
SIGNATURE AND SEAL APPLIES TO DRWG.
NOS. 1-17

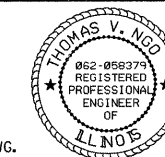

STATE OF ILLINOIS
DEPARTMENT OF TRANSPORTATION
DIVISION OF HIGHWAYS

SUBMITTED APRIL 14, 2009

Deane M. O'Keefe DE
DEPUTY DIRECTOR OF HIGHWAYS, REGION ENGINEER
May 1, 2009

Charles G. Ingersoll PE
ENGINEER OF DESIGN AND ENVIRONMENT

May 1, 2009

Christine M. Reed TD
DIRECTOR OF HIGHWAYS, CHIEF ENGINEER

MILLENNIA PROFESSIONAL SERVICES
200 22ND Street, Suite 216, Lombard, IL 60148
630.705.0110 voice, 630.839.2566 fax
www.mps-il.com

PRINTED BY THE AUTHORITY
OF THE STATE OF ILLINOIS

GENERAL NOTES

- BEFORE STARTING ANY EXCAVATION, THE CONTRACTOR SHALL CALL "J.U.L.I.E." AT 800-892-0123 FOR FIELD LOCATIONS OF BURIED ELECTRIC, TELEPHONE, AND GAS FACILITIES. 48 HOUR NOTIFICATION IS REQUIRED.
- THE CONTRACTOR SHALL COORDINATE CONSTRUCTION ACTIVITIES WITH THE UTILITY COMPANIES, CITY OF LAKE FOREST, CITY OF NORTH CHICAGO AND VILLAGE OF LAKE BLUFF.
- THE CONTRACTOR WILL NOT BE ALLOWED TO SET UP A YARD OR FIELD OFFICE ON STATE PROPERTY WITHOUT WRITTEN PERMISSION FROM THE DEPARTMENT.
- ANY PAVEMENT MARKINGS AND RAISED REFLECTIVE PAVEMENT MARKERS OBLITERATED BY MILLING AND RESURFACING OPERATIONS ON SIDE STREETS AND ENTRANCES SHALL BE REPLACED AND PAID FOR IN KIND.
- ALL DAMAGE TO EXISTING PAVEMENT MARKING OR RAISED REFLECTIVE PAVEMENT MARKERS OUTSIDE THE REMOVAL LINE SHOWN ON THE PLANS SHALL BE REPLACED AT THE CONTRACTORS EXPENSE. NO ADDITIONAL COST TO THE DEPARTMENT.
- BEFORE BEGINNING ANY WORK, THE CONTRACTOR SHALL RETAIN AND RECORD FOR FUTURE REFERENCES, ALL EXISTING PAVEMENT MARKING LINES AND RAISED REFLECTIVE PAVEMENT MARKERS IN ORDER THAT THESE LOCATIONS CAN BE RE-ESTABLISHED FOR STRIPING. EXACT LOCATIONS OF ALL STRIPING SHALL BE AS DIRECTED BY THE ENGINEER.
- ALL PAVEMENT PATCHING LOCATIONS WILL BE DETERMINED IN THE FIELD BY THE ENGINEER.
- LOCATIONS OF COMBINATION CONCRETE CURB AND GUTTER REMOVAL AND REPLACEMENT, WILL BE DETERMINED IN THE FIELD BY THE ENGINEER.
- THE CONTRACTOR SHALL BE RESPONSIBLE FOR VERIFYING ALL DIMENSIONS AND CONDITIONS EXISTING IN THE FIELD PRIOR TO CONSTRUCTION AND ORDERING MATERIALS.
- THE CONTRACTOR SHALL CONTACT THE DISTRICT ONE TRAFFIC CONTROL SUPERVISOR AT (847) 705-4470 A MINIMUM OF 72 HOURS IN ADVANCE OF BEGINNING WORK.
- THE ENGINEER SHALL CONTACT DEBBIE HANLON, THE TRAFFIC FIELD TECHNICIAN AT (847) 438-2300 A MINIMUM OF TWO (2) WEEKS PRIOR TO START OF THIS PROJECT SO THAT EXACT STATIONING OF NO PASSING ZONES AND OTHER PERMANENT PAVEMENT MARKINGS MAY BE ESTABLISHED.
- THE CONTRACTOR SHALL BE REQUIRED TO PROVIDE ACCESS TO ABUTTING PROPERTY AT ALL TIMES DURING THE CONSTRUCTION OF THIS PROJECT.
- WHEN CONSTRUCTION OPERATIONS ON TWO-LANE ROADS OPEN TO TRAFFIC RESULT IN THE REMOVAL OR COVERING OF ANY PAVEMENT STRIPING INDICATING PASSING RESTRICTIONS, "NO PASSING ZONES NOT STRIPED NEXT.....MILES" SIGNS SHALL BE USED. THE CONTRACTOR SHALL PLACE THE SIGNS AT THE BEGINNING OF THE UNSTRIPED AREA, JUST BEYOND EACH MAJOR INTERSECTION WITHIN THE UNSTRIPED, AND AT SUCH OTHER LOCATIONS AS THE ENGINEER MAY DIRECT TO ENSURE A MINIMUM SPACING OF FIVE MILES.
- DO NOT SCALE PLANS FOR CONSTRUCTION DIMENSIONS.
- DOUBLE LANE MARKERS ARE TO BE USED AS SHOWN ON THE DISTRICT ONE DETAIL "TYPICAL APPLICATIONS - RAISED REFLECTIVE PAVEMENT MARKERS (SNOW-PLOW RESISTANT)" SHOWN ON THE PLANS.
- WHEN MILLED PAVEMENT IS OPEN TO TRAFFIC THE MAXIMUM GRADE DIFFERENTIAL BETWEEN PASSES OF THE MILLING MACHINE SHALL NOT EXCEED 1 1/2 INCHES WHERE THE SPEED LIMIT IS 45 MPH OR LESS AND 1 INCH WHERE THE SPEED LIMIT IS GREATER THAN 45 MPH. WITH WRITTEN APPROVAL FROM THE ENGINEER, A MAXIMUM GRADE DIFFERENTIAL OF 3 INCHES MAY BE ALLOWED IF THE EDGE OF THE MILLING IS SLOPED A MINIMUM 1:3 (V:H).
- BUTT JOINTS WILL BE INSTALLED AT THE ENDS OF ALL RESURFACING (WHERE RESURFACING MEETS EXISTING PAVEMENT), IN ACCORDANCE WITH THE "BUTT JOINT AND HOT-MIX ASPHALT TAPER DETAILS" SHEET INCLUDED IN THE PLANS UNLESS OTHERWISE SPECIFIED.
- PAVEMENT MARKING TAPE, TYPE III SHALL BE USED FOR SHORT TERM PAVEMENT MARKINGS ON ALL FINAL SURFACES. THE COST OF THE PAVEMENT MARKING TAPE, TYPE III AND IT'S REMOVAL SHALL BE INCLUDED IN THE COST OF SHORT TERM PAVEMENT MARKING.
- THE CONTRACTOR SHALL PLACE PROPOSED PAVEMENT MARKINGS IN ACCORDANCE WITH DISTRICT 1 TYPICAL PAVEMENT MARKINGS DETAIL (TC-13).

LIST OF ILLINOIS DOT HIGHWAY STANDARDS

000001-05	STANDARD SYMBOLS, ABBREVIATIONS, AND PATTERNS
442201-03	CLASS C AND D PATCHES
482011-03	HMA SHLD. STRIPS/SHLDS. WITH RESURFACING OR WIDENING AND RESURFACING PROJECTS
606001-04	CONCRETE CURB TYPE B AND COMBINATION CONCRETE CLRB AND GUTTER
701201-03	LANE CLOSURE, 2L, 2W, DAY ONLY, FOR SPEEDS > OR = 45 MPH
701301-03	LANE CLOSURE, 2L, 2W, SHORT TIME OPERATIONS
701306-02	LANE CLOSURE, 2L, 2W, SLOW MOVING OPERATIONS DAY ONLY FOR SPEEDS > OR = 45 MPH
701311-03	LANE CLOSURE, 2L, 2W, MOVING OPERATIONS-DAY ONLY
701701-06	URBAN LANE CLOSURE, MULTILANE INTERSECTION
701901-01	TRAFFIC CONTROL DEVICES

INDEX OF SHEETS

1	COVER SHEET
2	INDEX OF SHEETS, HIGHWAY STANDARDS, GENERAL NOTES, AND COMMITMENTS
3	SUMMARY OF QUANTITIES
4	TYPICAL SECTIONS
5-8	ROADWAY AND PAVEMENT MARKING PLAN
9	DETECTOR LOOPS PLAN
10	PAVEMENT PATCHING FOR HMA SURFACED PAVEMENT (BD22)
11	CURB OR CURB AND GUTTER REMOVAL AND REPLACE (BD24)
12	BUTT JOINTS AND HMA TAPER (BD32)
13	TRAFFIC CONTROL AND PROTECTION FOR SIDE ROADS, INTERSECTIONS AND DRIVEWAYS (TC10)
14	RAISED REFLECTIVE PAVEMENT MARKERS, SNOW PLOW RESISTANT (TC11)
15	DISTRICT ONE TYPICAL PAVEMENT MARKINGS (TC13)
16	PAVEMENT MARKING LETTERS AND SYMBOLS FOR TRAFFIC STAGING (TC-16)
17	ARTERIAL ROAD INFORMATION SIGN (TC22)
18	DETECTOR LOOP INSTALLATION DETAILS FOR ROADWAY RESURFACE (TS07)

HIGHWAY STANDARDS

COMMITMENTS

NO COMMITMENTS FOR THIS PROJECT

FILE NAME : F:\2007\ME07080_Ver-Var-Phil\Cadd\015_SheridanRd\Sta\020\DOT\East-Sheridan.dgn
 USER NAME : Millennium Engineering



200 22ND Street, Suite 216, Lombard, IL 60148
 630.705.8110 voice, 630.839.2566 fax
 WWW.MPS-IL.COM

MILLENNIA PROFESSIONAL SERVICES

DESIGNED	-	TVN	REVISED	-
DRAWN	-	TVN	REVISED	-
CHECKED	-	RPD	REVISED	-
DATE	-	4/16/2009	REVISED	-

STATE OF ILLINOIS
 DEPARTMENT OF TRANSPORTATION

SHERIDAN ROAD
 BLODGETT AVE TO IL RTE 137 (BUCKLEY RD)

INDEX OF SHEETS, LIST OF IDOT
 HIGHWAY STANDARD, GENERAL NOTES,
 AND COMMITMENTS

F.A.J. RTE.	SECTION	COUNTY	TOTAL SHEETS	SHEET NO.
2744	(113 & 113 W) RS-10	LAKE	18	2
CONTRACT NO.			60H08	
FED. ROAD DIST. NO. 1 ILLINOIS FED. AID PROJECT				

SCALE: N/A SHEET NO. OF SHEETS STA. TO STA.

F:\2007\ME07080_Ver-Var-Phil\Cadd\015_SheridanRd\Sta\020\DOT\East-Sheridan.dgn

URBAN

SUMMARY OF QUANTITIES			TOTAL QUANTITY	CONSTRUCTION TYPE CODE
CODE NO.	ITEM DESCRIPTION	UNIT	100% STATE	1000 QUANTITY
20201006	GRADING AND SHAPING SHOULDERS	UNIT	132	132
40600200	BITUMINOUS MATERIALS (PRIME COAT)	TON	113	113
40600300	AGGREGATE (PRIME COAT)	TON	60	60
40600400	MIXTURE FOR CRACKS, JOINTS, AND FLANGEWAYS	TON	10	10
40600895	CONSTRUCTING TEST STRIP	EACH	2	2
40600982	HOT-MIX ASPHALT SURFACE REMOVAL - BUTT JOINT	SQ YD	190	190
40601005	HOT-MIX ASPHALT REPLACEMENT OVER PATCHES	TON	237	237
40603340	HOT-MIX ASPHALT SURFACE COURSE, MIX "D", N70	TON	2530	2530
44000158	HOT-MIX ASPHALT SURFACE REMOVAL, 2 1/4"	SQ YD	30100	30100
44001700	COMBINATION CONCRETE CURB AND GUTTER REMOVAL AND REPLACEMENT	FOOT	50	50
44002216	HOT-MIX ASPHALT REMOVAL OVER PATCHES, 4"	SQ YD	1057	1057
44201761	CLASS D PATCHES, TYPE I, 10 INCH	SQ YD	84	84
44201765	CLASS D PATCHES, TYPE II, 10 INCH	SQ YD	393	393
44201769	CLASS D PATCHES, TYPE III, 10 INCH	SQ YD	280	280
44201771	CLASS D PATCHES, TYPE IV, 10 INCH	SQ YD	133	133
48102100	AGGREGATE WEDGE SHOULDER, TYPE B	TON	530	530
55039700	STORM SEWERS TO BE CLEANED	FOOT	200	200
67000400	ENGINEER'S FIELD OFFICE, TYPE A	CAL MO	6	6
67100100	MOBILIZATION	L SUM	1	1
70100450	TRAFFIC CONTROL AND PROTECTION, STANDARD 701201	L SUM	1	1
70100460	TRAFFIC CONTROL AND PROTECTION, STANDARD 701306	L SUM	1	1
70102635	TRAFFIC CONTROL AND PROTECTION, STANDARD 701701	L SUM	1	1
70300100	SHORT-TERM PAVEMENT MARKING	FOOT	4790	4790
70300210	TEMPORARY PAVEMENT MARKING - LETTERS AND SYMBOLS	SQ FT	110	110
70300220	TEMPORARY PAVEMENT MARKING - LINE 4"	FOOT	29900	29900
70300240	TEMPORARY PAVEMENT MARKING - LINE 6"	FOOT	650	650
70300260	TEMPORARY PAVEMENT MARKING - LINE 12"	FOOT	790	790
70300280	TEMPORARY PAVEMENT MARKING - LINE 24"	FOOT	36	36
70301000	WORK ZONE PAVEMENT MARKING REMOVAL	SQ FT	799	799
* 78000100	THERMOPLASTIC PAVEMENT MARKING - LETTERS AND SYMBOLS	SQ FT	110	110

URBAN

SUMMARY OF QUANTITIES			TOTAL QUANTITY	CONSTRUCTION TYPE CODE
CODE NO.	ITEM DESCRIPTION	UNIT	100% STATE	1000 QUANTITY
* 78000200	THERMOPLASTIC PAVEMENT MARKING - LINE 4"	FOOT	29900	29900
* 78000400	THERMOPLASTIC PAVEMENT MARKING - LINE 6"	FOOT	650	650
* 78000600	THERMOPLASTIC PAVEMENT MARKING - LINE 12"	FOOT	790	790
* 78000650	THERMOPLASTIC PAVEMENT MARKING - LINE 24"	FOOT	36	36
* 78100100	RAISED REFLECTIVE PAVEMENT MARKER	EACH	369	369
* 78300200	RAISED REFLECTIVE PAVEMENT MARKER REMOVAL	EACH	369	369
* 88600600	DETECTOR LOOP REPLACEMENT	FOOT	575	575
X0322256	TEMPORARY INFORMATION SIGNING	SQ FT	52	52
X4067107	POLYMERIZED LEVELING BINDER (MACHINE METHOD), IL-4.75, N50	TON	1270	1270
Z0018500	DRAINAGE STRUCTURES TO BE CLEANED	EACH	15	15

* SPECIALTY ITEM

FILE NAME = P:\2007\ME07080_Ver-Var-Phil\Cadd\MOIS_SheridanRd\Shts\0350Dsh-Sheridan.dgn
 USER = M. J. MILLER
 USER NAME = Millennium Engineering



200 22ND Street, Suite 216, Lombard, IL 60148
 630.705.8110 voice, 630.839.2566 fax
 WWW.MPS-IL.COM
MILLENNIA PROFESSIONAL SERVICES

DESIGNED - IVN	REVISED - ---
DRAWN - IVN	REVISED - ---
CHECKED - BPD	REVISED - ---
DATE - 4/16/2009	REVISED - ---

STATE OF ILLINOIS
DEPARTMENT OF TRANSPORTATION

SHERIDAN ROAD
BLODGETT AVE TO IL RTE 137 (BUCKLEY RD)

SUMMARY OF QUANTITIES

F.A.J. RTE.	SECTION	COUNTY	TOTAL SHEETS	SHEET NO.
2744	(113 & 113 W) RS-10	LAKE	18	3
CONTRACT NO. 60H08			FED. ROAD DIST. NO. 1 ILLINOIS FED. AID PROJECT	

SCALE: _____ SHEET NO. ___ OF ___ SHEETS STA. _____ TO STA. _____

P:\2007\ME07080_Ver-Var-Phil\Cadd\MOIS_SheridanRd\Shts\0350Dsh-Sheridan.dgn

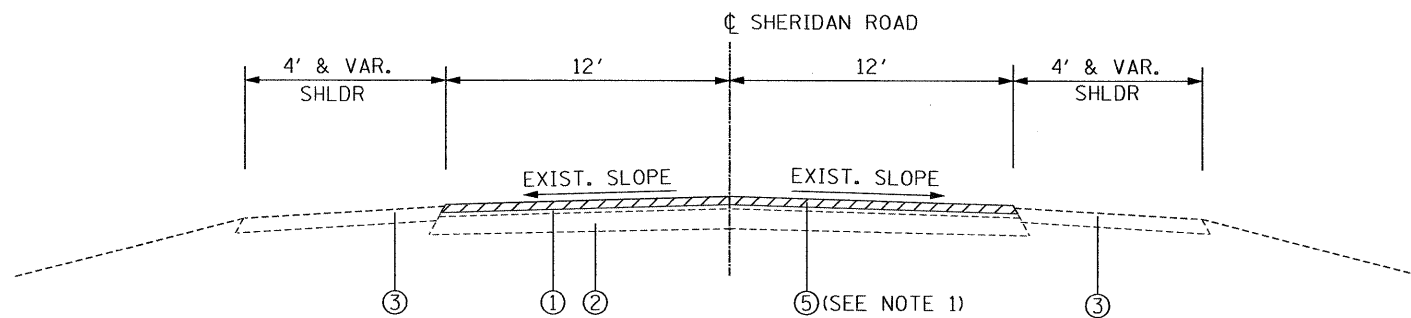

EXISTING TYPICAL SECTION

SHERIDAN ROAD
STA. 10+27 TO STA. 76+79

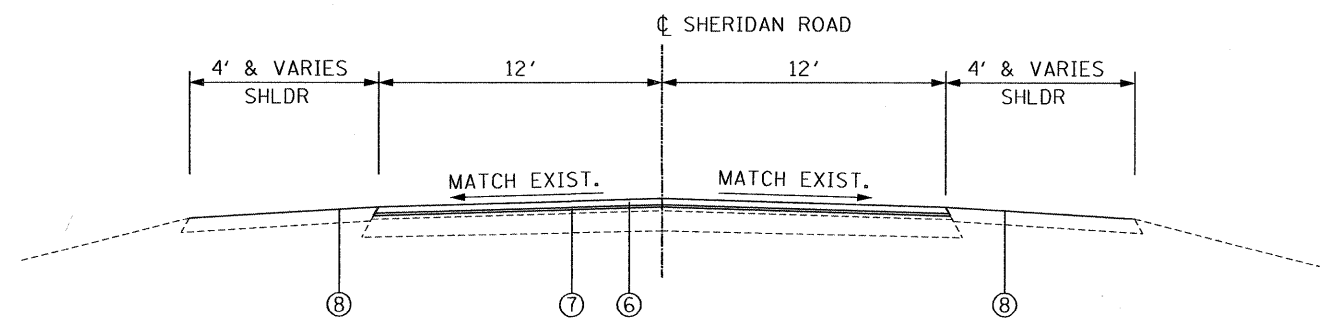

PROPOSED TYPICAL SECTION

SHERIDAN ROAD
STA. 10+27 TO STA. 76+79

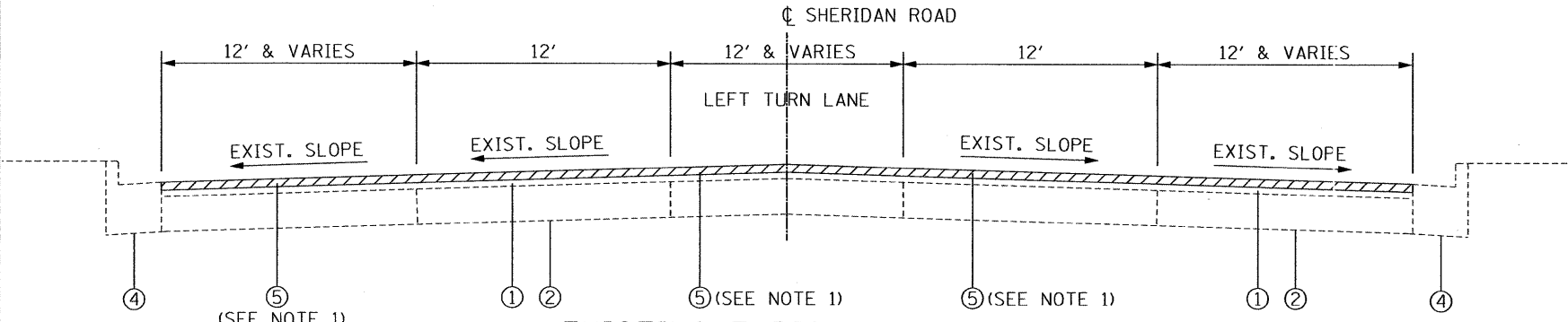

EXISTING TYPICAL SECTION

SHERIDAN ROAD
STA. 76+79 TO STA. 97+47

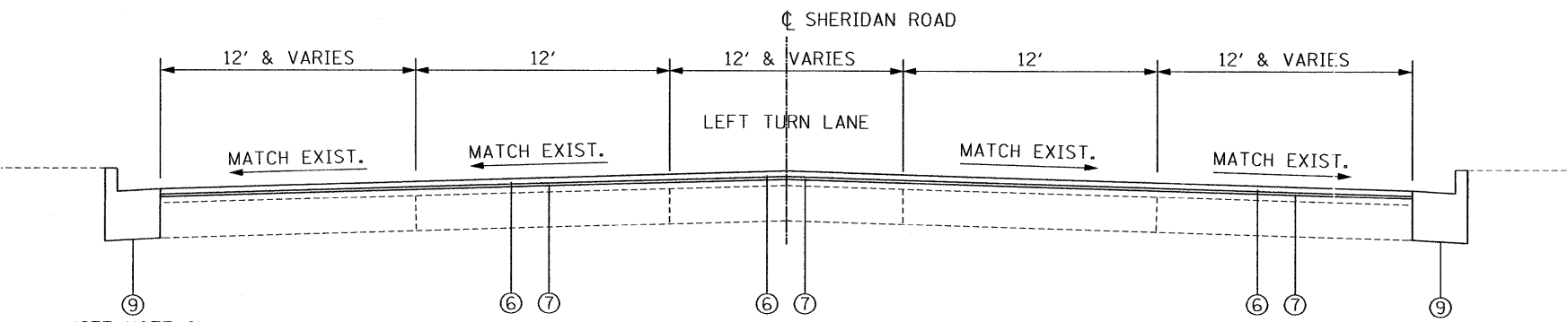

PROPOSED TYPICAL SECTION

SHERIDAN ROAD
STA. 76+79 TO STA. 97+47

LEGEND

- ① EXISTING +/-4" HMA SURFACE
- ② EXISTING +/-10" P.C.C. BASE
- ③ EXISTING AGGREGATE SHOULDER +/- 6"
- ④ EXISTING B-6.24 CURB AND GUTTER
- ⑤ HMA SURFACE REMOVAL - 2 1/4" (SEE NOTE 1)
- ⑥ HOT-MIX ASPHALT SURFACE COURSE, MIX "D", N70 (IL-9.5MM) -1 1/2"
- ⑦ POLYMERIZED LEVELING BINDER (MACHINE METHOD), IL-4.75, N50 -3/4"
- ⑧ GRADING AND SHAPING SHOULDERS & AGGREGATE WEDGE SHOULDER, TYPE B
- ⑨ PROPOSED B-6.24 CURB AND GUTTER (SEE NOTE 2)

NOTES

1. THE CONTRACTOR SHALL PERFORM THE PAVEMENT PATCHING OPERATIONS PRIOR TO THE HMA SURFACE REMOVAL OPERATION. SEE IDOT DISTRICT 1 DETAIL PAVEMENT PATCHING FOR HMA SURFACED PAVEMENT BD-400-04 (BD-22) FOR ADDITIONAL INFORMATION.
2. LOCATIONS OF COMBINATION CONCRETE CURB AND GUTTER REMOVAL AND REPLACEMENT, WILL BE DETERMINED IN THE FIELD BY THE ENGINEER.

HMA MIXTURES REQUIREMENT		
MIXTURE USES	AC TYPE	VOIDS
HOT-MIX ASPHALT SURFACE COURSE, MIX "D", N70 (IL-9.5mm)	PG 64-22	4% @ 70 GYR.
POLYMERIZED LEVELING BINDER (MACHINE METHOD), IL-4.75, N50	SBS/SBR PG 76-28/-22	4% @ 50 GYR.
CLASS D PATCHES (HMA BINDER IL-19 MM)	PG 64-22 (SEE NOTE 2)	4% @ 70 GYR.
HMA REPLACEMENT OVER PATCHES (HMA BINDER IL-19MM)	PG 64-22 (SEE NOTE 2)	4% @ 70 GYR.

- MIXTURE NOTES:
1. THE UNIT WEIGHT USED TO CALCULATE ALL HOT-MIX ASPHALT SURFACE MIXTURES IS 112 LBS/SQ YD/IN
 2. WHEN RAP EXCEEDS 20%, THE NEW ASPHALT BINDER IN THE MIX SHALL BE PG 58-22.

FILE NAME: P:\2007\ME070802_Ver_Var_Phil\Cadd\015_SheridanRd\Shsta\04TYP-shr-Sheridan.dgn
 SCALE: 1/4" = 1'-0"
 USER: JIN
 PLS: JIN
 DATE: 4/16/2009

200 22ND Street, Suite 216, Lombard, IL 60148
 630.785.0110 voice, 630.839.2566 fax
 WWW.MPS-IL.COM
MILLENNIA PROFESSIONAL SERVICES

DESIGNED - TVN	REVISED -
DRAWN - TVN	REVISED -
CHECKED - RPD	REVISED -
DATE - 4/16/2009	REVISED -

**STATE OF ILLINOIS
DEPARTMENT OF TRANSPORTATION**

**SHERIDAN ROAD
BLODGETT AVE TO IL RTE 137 (BUCKLEY RD)**

SCALE: SHEET NO. OF SHEETS STA. TO STA.

F.A.U. RTE.	SECTION	COUNTY	TOTAL SHEETS	SHEET NO.
2744	(113 & 113 W) RS-10	LAKE	4	4
FED. ROAD DIST. NO. 1 ILLINOIS FED. AID PROJECT			CONTRACT NO. 60H08	

NOTES:

1. THE CONTRACTOR SHALL CONDUCT THE PAVEMENT PATCHING OPERATION PRIOR TO THE BITUMINOUS SURFACE REMOVAL OPERATION. ALL PAVEMENT PATCHING LOCATION WILL BE DETERMINED BY THE RESIDENT ENGINEER.
2. REFER TO DISTRICT 1 TYPICAL PAVEMENT MARKINGS (TC-13) FOR ADDITIONAL INFORMATION.
3. REFER TO DISTRICT 1 RAISED REFLECTIVE PAVEMENT MARKERS (TC-11) FOR ADDITIONAL INFORMATION.
4. THE ENGINEER SHALL CONTACT: DEBBIE HANLON FIELD TECHNICIAN, AT (847) 438-2300 A MINIMUM OF TWO (2) WEEKS PRIOR TO START OF PROJECT FOR PLACEMENT OF PERMANENT PAVEMENT MARKINGS.

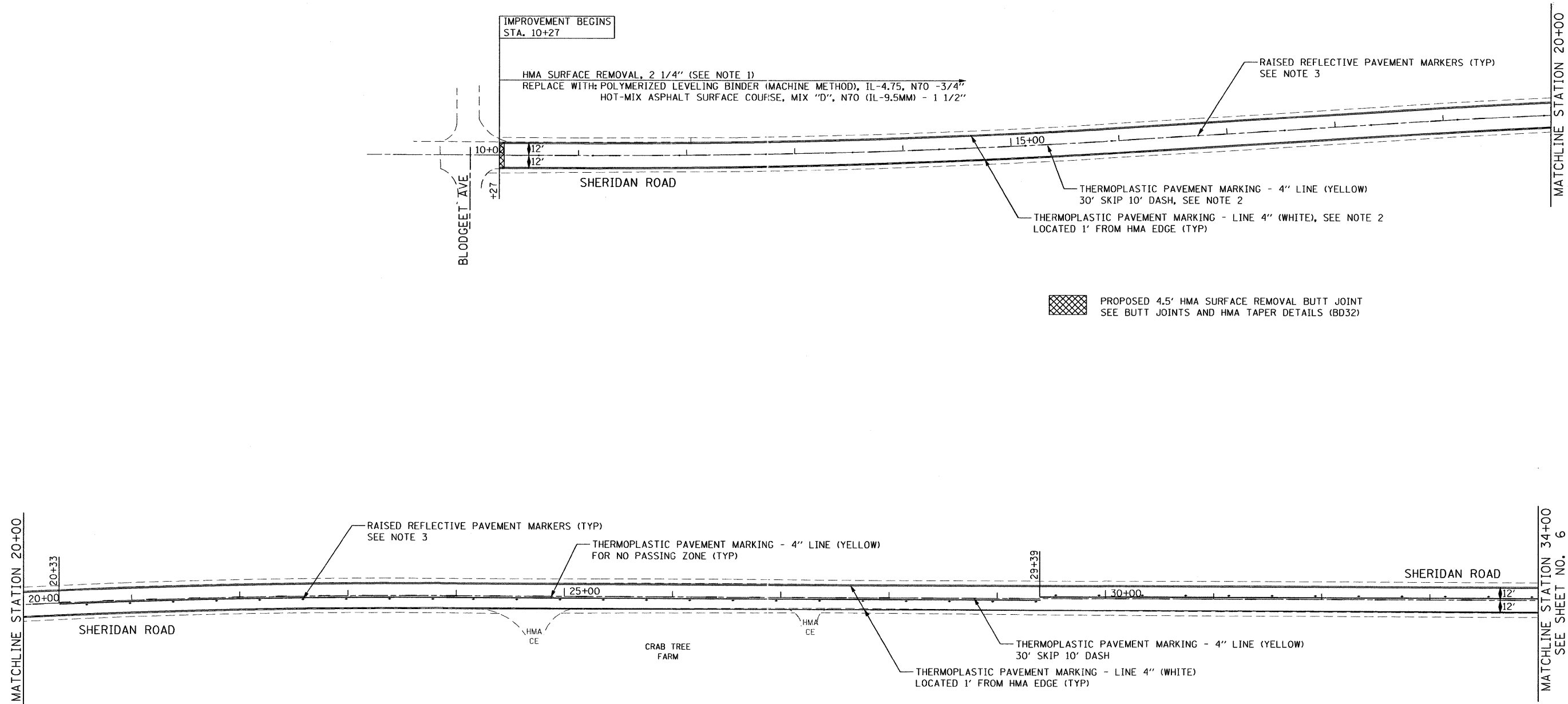

PROPOSED 4.5' HMA SURFACE REMOVAL BUTT JOINT
SEE BUTT JOINTS AND HMA TAPER DETAILS (BD32)

FILE NAME : P:\2007\ME070802_Ver\er_Phil\Cadd\W015_SheridanRd\Shsta\Plan\sh-tsheridan-01.dgn
 USER NAME : Millennium Engineering



300 22ND Street, Suite 216, Lombard, IL 60148
 630.785.8110 voice, 630.839.2566 fax
 WWW.MPS-IL.COM
MILLENNIA PROFESSIONAL SERVICES

DESIGNED - TVN	REVISED -
DRAWN - TVN	REVISED -
CHECKED - RPD	REVISED -
DATE - 4/16/2009	REVISED -

STATE OF ILLINOIS
DEPARTMENT OF TRANSPORTATION

SHERIDAN ROAD
BLODGETT AVE TO IL RTE 137 (BUCKLEY RD)

ROADWAY &
PAVEMENT MARKING PLAN

F.A.U. RTE.	SECTION	COUNTY	TOTAL SHEETS	SHEET NO.
2744	(113 & 113 W) RS-10	LAKE	18	5
CONTRACT NO. 60H08				

PLN-01

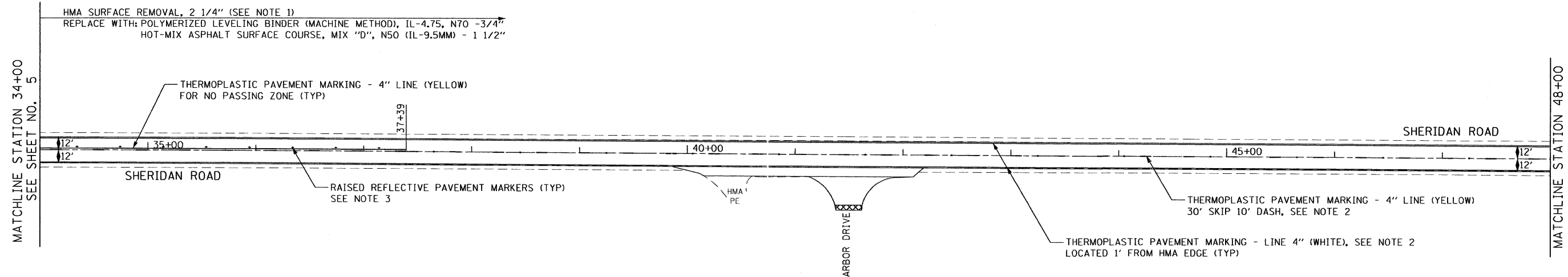

NOTES:

1. THE CONTRACTOR SHALL CONDUCT THE PAVEMENT PATCHING OPERATION PRIOR TO THE BITUMINOUS SURFACE REMOVAL OPERATION. ALL PAVEMENT PATCHING LOCATION WILL BE DETERMINED BY THE RESIDENT ENGINEER.
2. REFER TO DISTRICT 1 TYPICAL PAVEMENT MARKINGS (TC-13) FOR ADDITIONAL INFORMATION.
3. REFER TO DISTRICT 1 RAISED REFLECTIVE PAVEMENT MARKERS (TC-11) FOR ADDITIONAL INFORMATION.
4. THE ENGINEER SHALL CONTACT: DEBBIE HANLON FIELD TECHNICIAN, AT (847) 438-2300 A MINIMUM OF TWO (2) WEEKS PRIOR TO START OF PROJECT FOR PLACEMENT OF PERMANENT PAVEMENT MARKINGS.

PROPOSED 4.5' HMA SURFACE REMOVAL BUTT JOINT
SEE BUTT JOINTS AND HMA TAPER DETAILS (BD32)

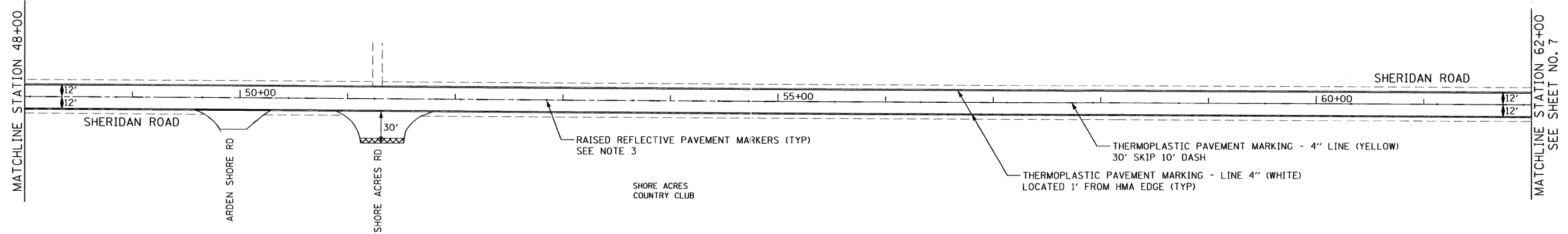

FILE NAME = P:\2007\ME070808_Var_Var_Phil\Cadd\W015_SheridanRd\Shots\Plan-sht-sheridan-02.dgn
 PLOT SCALE = 1" = 50'
 USER NAME = Millennium Engineering

MILLENNIA PROFESSIONAL SERVICES
 200 22ND Street, Suite 216, Lombard, IL 60148
 630.785.0110 voice, 630.839.2566 fax
 WWW.MPS-IL.COM

DESIGNED - TVN	REVISED -
DRAWN - TVN	REVISED -
CHECKED - RPD	REVISED -
DATE - 4/16/2009	REVISED -

STATE OF ILLINOIS
DEPARTMENT OF TRANSPORTATION

SHERIDAN ROAD
BLODGETT AVE TO IL RTE 137 (BUCKLEY RD)
ROADWAY & PAVEMENT MARKING PLAN

SCALE: 1"=50' SHEET NO. OF SHEETS STA. TO STA.

F.A.U. RTE.	SECTION	COUNTY	TOTAL SHEETS	SHEET NO.
2744	(113 & 113 W) RS-10	LAKE	18	6
FED. ROAD DIST. NO. 1 ILLINOIS FED. AID PROJECT			CONTRACT NO. 60H08	

PLN-02

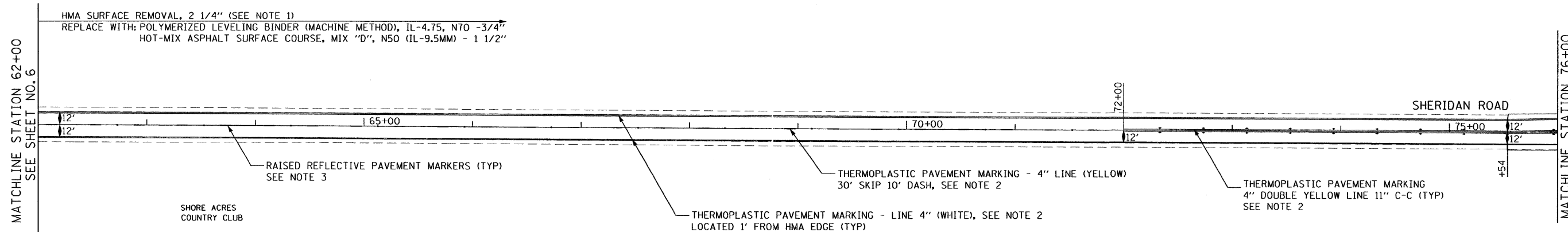

NOTES:

1. THE CONTRACTOR SHALL CONDUCT THE PAVEMENT PATCHING OPERATION PRIOR TO THE BITUMINOUS SURFACE REMOVAL OPERATION. ALL PAVEMENT PATCHING LOCATION WILL BE DETERMINED BY THE RESIDENT ENGINEER.
2. REFER TO DISTRICT 1 TYPICAL PAVEMENT MARKINGS (TC-13) FOR ADDITIONAL INFORMATION.
3. REFER TO DISTRICT 1 RAISED REFLECTIVE PAVEMENT MARKERS (TC-11) FOR ADDITIONAL INFORMATION.
4. THE ENGINEER SHALL CONTACT: DEBBIE HANLON FIELD TECHNICIAN, AT (847) 438-2300 A MINIMUM OF TWO (2) WEEKS PRIOR TO START OF PROJECT FOR PLACEMENT OF PERMANENT PAVEMENT MARKINGS.

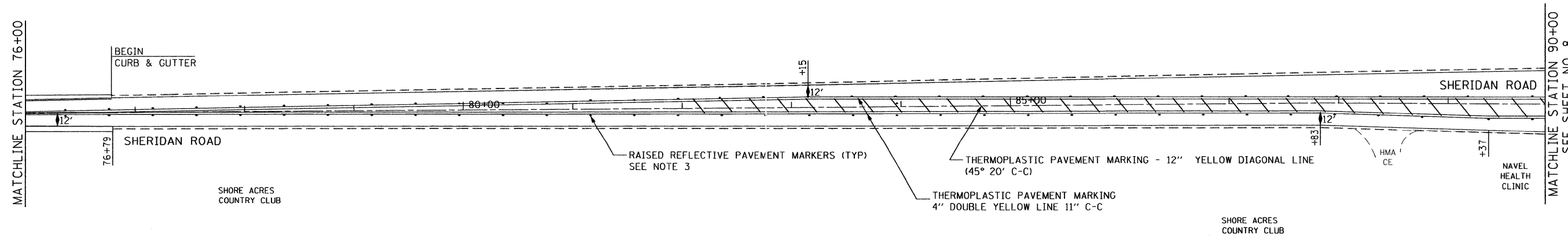

FILE NAME : P:\2007\ME070800_Ver_Ver_Plan\Cadd\W015_SheridanRd\Shsta\Plan-sht-sheridan-03.dgn
 USER NAME : Millennium Engineering



200 22ND Street, Suite 316, Lombard, IL 60148
 630.705.8110 voice, 630.839.2566 fax
 WWW.MPS-IL.COM
MILLENNIA PROFESSIONAL SERVICES

DESIGNED - TVN	REVISED -
DRAWN - TVN	REVISED -
CHECKED - RPD	REVISED -
DATE - 4/16/2009	REVISED -

**STATE OF ILLINOIS
 DEPARTMENT OF TRANSPORTATION**

**SHERIDAN ROAD
 BLODGETT AVE TO IL RTE 137 (BUCKLEY RD)**

**ROADWAY &
 PAVEMENT MARKING PLAN**

F.A.U. RTE. 2744	SECTION (113 & 113 W) RS-10	COUNTY LAKE	TOTAL SHEETS 18	SHEET NO. 7
CONTRACT NO. 60H08				

PLN-03

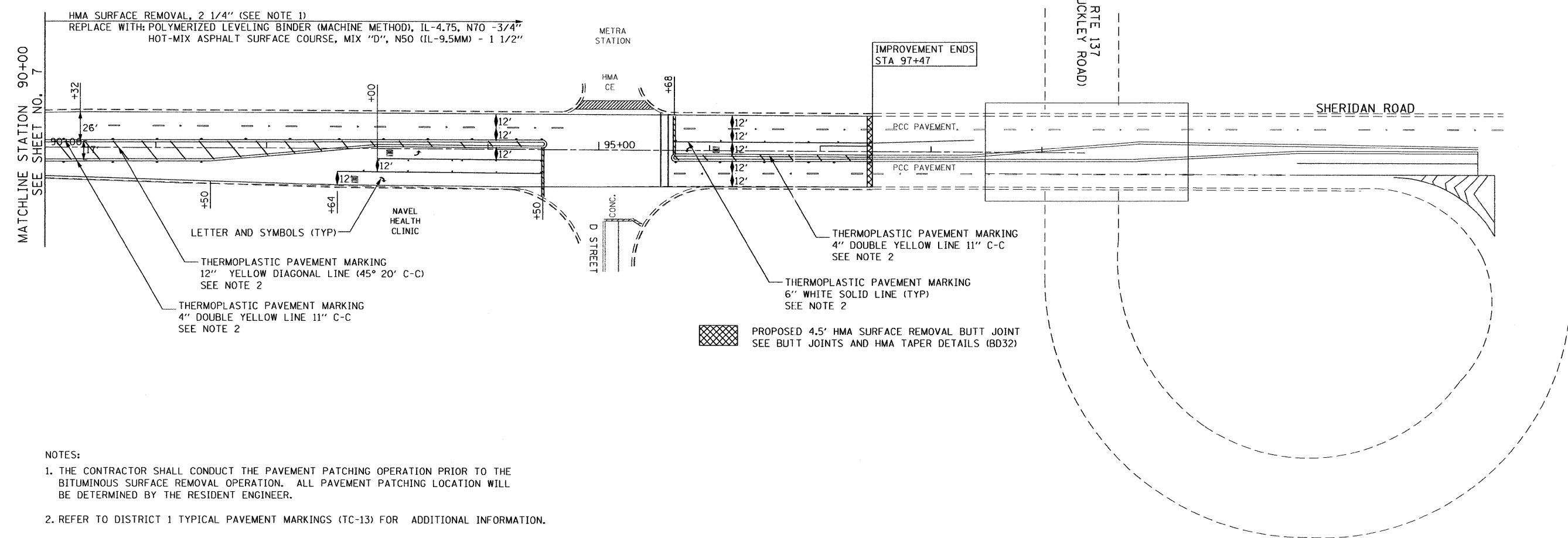
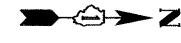

- NOTES:
1. THE CONTRACTOR SHALL CONDUCT THE PAVEMENT PATCHING OPERATION PRIOR TO THE BITUMINOUS SURFACE REMOVAL OPERATION. ALL PAVEMENT PATCHING LOCATION WILL BE DETERMINED BY THE RESIDENT ENGINEER.
 2. REFER TO DISTRICT 1 TYPICAL PAVEMENT MARKINGS (TC-13) FOR ADDITIONAL INFORMATION.
 3. REFER TO DISTRICT 1 RAISED REFLECTIVE PAVEMENT MARKERS (TC-11) FOR ADDITIONAL INFORMATION.
 4. THE ENGINEER SHALL CONTACT: DEBBIE HANLON FIELD TECHNICIAN, AT (847) 438-2300 A MINIMUM OF TWO (2) WEEKS PRIOR TO START OF PROJECT FOR PLACEMENT OF PERMANENT PAVEMENT MARKINGS.

P:\2007\ME07080_Ver-Yar-Phl\Cadd\W015_SheridanRd\Shsta\Plan-sht-sheridan-04.dgn
 User: Millenna_Engineering



200 22ND Street, Suite 216, Lombard, IL 60148
 630.705.0110 voice, 630.839.2566 fax
 WWW.MPS-IL.COM
MILLENNIA PROFESSIONAL SERVICES

DESIGNED - TVN	REVISED -
DRAWN - TVN	REVISED -
CHECKED - RPD	REVISED -
DATE - 4/16/2009	REVISED -

STATE OF ILLINOIS
DEPARTMENT OF TRANSPORTATION

SHERIDAN ROAD		ROADWAY & PAVEMENT MARKING PLAN	
BLODGETT AVE TO IL RTE 137 (BUCKLEY RD)			
SCALE:	SHEET NO. OF SHEETS	STA. TO STA.	

F.A.U. RTE. 2744	SECTION (113 & 113 W) RS-10	COUNTY LAKE	TOTAL SHEETS 18	SHEET NO. 8
FED. ROAD DIST. NO. 1 ILLINOIS FED. AID PROJECT			CONTRACT NO. 60H08	

PLN-04

P:\2007\ME07080_Ver-Yar-Phl\Cadd\W015_SheridanRd\Shsta\Plan-sht-sheridan-04.dgn

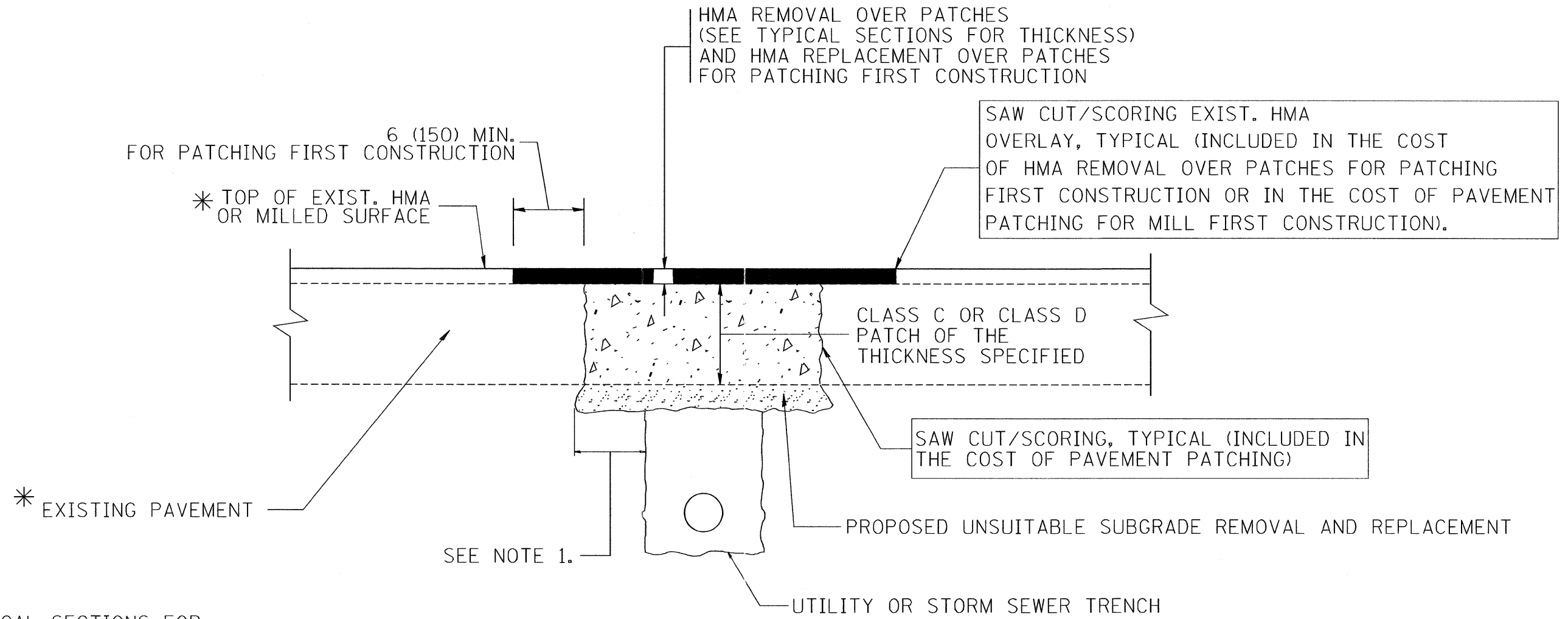

* SEE TYPICAL SECTIONS FOR THICKNESS AND MATERIALS

NOTES:

1. THE WIDTH OF THE FULL DEPTH PATCH OVER A TRENCH SHALL BE 12 (300) WIDER ON EACH SIDE OF THE TRENCH.
2. FOR METHOD OF MEASUREMENT AND BASIS OF PAYMENT, SEE RECURRING SPECIAL PROVISION "PATCHING WITH HOT-MIX ASPHALT OVERLAY REMOVAL".

SEQUENCE OF CONSTRUCTION (PATCHING FIRST)

1. REMOVE THE EXISTING HMA MATERIAL OVER THE AREA TO BE PATCHED.
2. REMOVE AND REPLACE WITH CLASS C OR D PATCH.
3. REPLACE HMA MATERIAL OVER THE AREA TO BE PATCHED.

SEQUENCE OF CONSTRUCTION (MILLING FIRST)

1. MILL HMA FIRST IF THERE IS AT LEAST 4 1/2 INCHES OR MORE OF HMA MATERIAL ON TOP OF THE EXISTING PAVEMENT OR IF THE PAVEMENT IS FULL DEPTH HMA. A MINIMUM OF 2 INCHES OF HMA MATERIAL SHALL BE IN PLACE AFTER MILLING.
2. REMOVE AND REPLACE WITH FULL DEPTH CLASS D PATCHES TO TOP OF MILLED SURFACE.

ALL DIMENSIONS ARE IN INCHES (MILLIMETERS) UNLESS OTHERWISE SHOWN.

FILE NAME = c:\projects\diststd22x34\bd22.dgn	USER NAME = bauerdl	DESIGNED - R. SHAH	REVISED - A. ABBAS 04-27-98	STATE OF ILLINOIS DEPARTMENT OF TRANSPORTATION	PAVEMENT PATCHING FOR HMA SURFACED PAVEMENT			F.A. RTE. =	SECTION	COUNTY	TOTAL SHEETS	SHEET NO.
	PLOT SCALE = 50,000' / IN.	DRAWN -	REVISED - R. BORO 01-01-07					2744	(113 & 113 W) RS-10	LAKE	18	10
	PLOT DATE = 10/27/2008	DATE - 10-25-94	REVISED - R. BORO 09-04-07					BD400-04 (BD-22)		CONTRACT NO. 60H08		
		REVISED - K. ENG 10-27-08		SCALE: NONE	SHEET NO. 1 OF 1 SHEETS	STA. TO STA.	FED. ROAD DIST. NO. 1 ILLINOIS FED. AID PROJECT					

VARIABLE - TO MEET EXISTING DIMENSIONS AND FIELD CONDITIONS (SEE NOTE ②)

PROP. CONC. CURB OR CURB AND GUTTER REPLACEMENT IN ACCORDANCE WITH STATE STANDARD 606001. (SEE NOTE ②)

SAW CUT FULL DEPTH - INCLUDED IN THE COST OF SIDEWALK, DRIVEWAY OR MEDIAN SURFACE REMOVAL PAY ITEM.

SEE STATE STANDARD 606001
EXISTING OR PROPOSED HMA SURFACE (IF APPLICABLE)

18" (450) MAX.

1/4" (5) **

EXISTING SIDEWALK, DRIVEWAY, MEDIAN SURFACE OR GROUND.

PROPOSED SIDEWALK, DRIVEWAY PAVEMENT, MEDIAN SURFACE OR SALT TOLERANT SOD AND TOP SOIL, 4" (100) SOD RESTORATION (SEE NOTE ①).

EXISTING CONCRETE PAVEMENT, CONCRETE BASE COURSE OR FLEXIBLE PAVEMENT

SUITABLE BACKFILL MATERIAL (INCLUDED IN THE COST OF CURB OR CURB AND GUTTER REMOVAL AND REPLACEMENT)

3" (75) MIN.

PROPOSED 3/4" (20) PREFORMED EXPANSION JOINT AT CONCRETE SIDEWALKS, DRIVEWAYS, AND MEDIANS. (INCLUDED IN THE COST OF CURB OR CURB AND GUTTER REMOVAL AND REPLACEMENT.)

* 3" (75) MINIMUM FROM TOP AND BOTTOM OF THE CONCRETE PAVEMENT OR BASE COURSE.

** IF THE FINAL SURFACE OF THE PAVEMENT IS CONCRETE, THE GUTTER IS TO BE FLUSH WITH THE PAVEMENT.

NOTE: ① SIDEWALK, DRIVEWAY PAVEMENT OR MEDIAN SURFACE SHALL BE SIMILAR TO THE MATERIAL BEING REMOVED AND WILL BE PAID FOR SEPARATELY.

SALT TOLERANT SOD AND TOP SOIL, 4" (100) RESTORATION WILL NOT BE PAID FOR SEPARATELY, BUT SHALL BE INCLUDED IN THE COST OF CURB OR CURB AND GUTTER REMOVAL AND REPLACEMENT.

② CURB OR CURB AND GUTTER REPLACEMENT SHALL MATCH THE SHAPE OF THE EXISTING CURB OR CURB AND GUTTER UNLESS OTHERWISE SPECIFIED.

③ FOR CURB OR CURB AND GUTTER REMOVAL AND REPLACEMENT ADJACENT TO FLEXIBLE PAVEMENT DELETE EPOXY COATED TIE BARS.

④ LONGITUDINAL BARS, IF ENCOUNTERED IN THE EXISTING CURB OR CURB AND GUTTER, ARE NOT TO BE REPLACED. CUTTING AND REMOVING LONGITUDINAL BARS SHALL BE INCLUDED IN THE COST OF CURB OR CURB AND GUTTER REMOVAL AND REPLACEMENT.

⑤ THE COST OF HMA SURFACE REMOVAL IN THE EXISTING GUTTER FLAG SHALL BE INCLUDED IN THE COST OF THE CURB AND GUTTER REMOVAL AND REPLACEMENT.

⑥ THE REMOVAL AND REPLACEMENT OF THE EXISTING CURB OR CURB AND GUTTER SHALL BE DONE IN ACCORDANCE WITH THE APPLICABLE PORTIONS OF SECTION 440 AND 606 OF THE STANDARD SPECIFICATIONS.

⑦ THE LOCATIONS OF REMOVAL AND REPLACEMENT OF EXISTING CURB OR CURB AND GUTTER SHALL BE DETERMINED BY THE RESIDENT ENGINEER AT THE TIME OF CONSTRUCTION.

UNSUITABLE SUB-BASE MATERIAL TO BE REMOVED, IF DIRECTED BY THE ENGINEER, SHALL BE REPLACED WITH EITHER SUB-BASE GRANULAR MATERIAL, TYPE B OR ADDITIONAL THICKNESS OF CONCRETE.

REMOVAL AND REPLACEMENT 4" (100) OR LESS IS INCLUDED IN THE COST OF CURB OR CURB AND GUTTER REMOVAL AND REPLACEMENT.

REMOVAL AND REPLACEMENT IN EXCESS OF 4" (100) WILL BE PAID FOR IN ACCORDANCE WITH ARTICLE 109.04 OF THE STANDARD SPECIFICATIONS.

PROPOSED #6 (20) EPOXY COATED TIE BARS 24" (600) LONG AT 24" (600) CENTERS WILL NOT BE PAID FOR SEPARATELY. DELETE EPOXY COATED TIE BARS IF EXISTING TIE BARS ARE USUABLE AS DETERMINED BY THE ENGINEER. (SEE NOTE ③).

BASIS OF PAYMENT:

THIS WORK WILL BE PAID FOR AT THE CONTRACT UNIT PRICE PER FOOT (METER) FOR "CURB REMOVAL AND REPLACEMENT" OR "COMBINATION CONCRETE CURB AND GUTTER REMOVAL AND REPLACEMENT".

CURB OR CURB AND GUTTER REMOVAL AND REPLACEMENT

ALL DIMENSIONS ARE IN INCHES (MILLIMETERS) UNLESS OTHERWISE SHOWN.

FILE NAME = W:\diststd\22x34\bd24.dgn	USER NAME = gag11enobt	DESIGNED - A. HOUSEH	REVISED - R. SHAH 10-03-96	STATE OF ILLINOIS DEPARTMENT OF TRANSPORTATION	CURB OR CURB AND GUTTER REMOVAL AND REPLACEMENT			F.A. RTE. 2744	SECTION (113 & 113 W) RS-10	COUNTY LAKE	TOTAL SHEETS 18	SHEET NO. 11
	PLOT SCALE = 50,000' / IN.	DRAWN -	REVISED - A. ABBAS 03-21-97		SCALE: NONE	SHEET NO. 1 OF 1 SHEETS	STA.	TO STA.	BD600-06 (BD-24)		CONTRACT NO. 60H08	
	PLOT DATE = 1/4/2008	CHECKED -	REVISED - M. GOMEZ 01-22-01		FED. ROAD DIST. NO. 1 ILLINOIS FED. AID PROJECT							
		DATE - 03-11-94	REVISED - R. BORO 01-01-07									

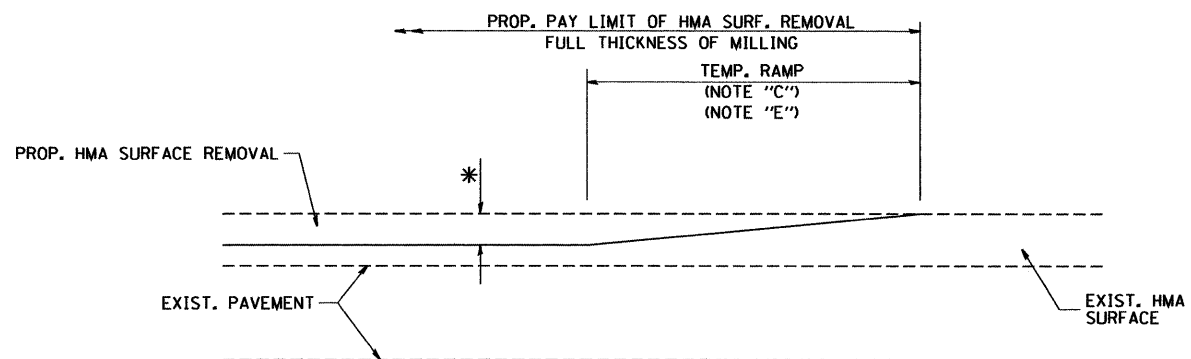

MILLED TEMPORARY RAMP
(FOR BUTT JOINT AND HMA TAPER SEE DETAIL BELOW)

OPTION 1

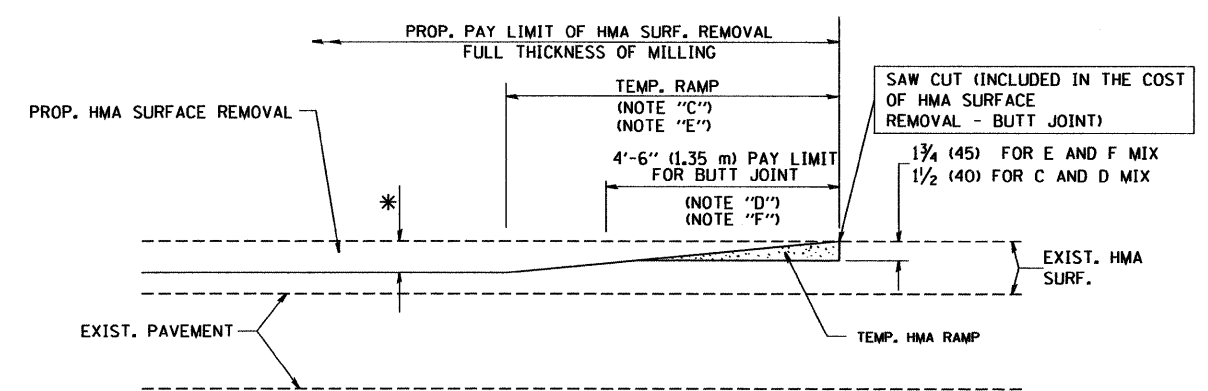

HMA CONSTRUCTED TEMPORARY RAMP
(FOR BUTT JOINT AND HMA TAPER SEE DETAIL BELOW)

OPTION 2

TYPICAL TEMPORARY RAMP

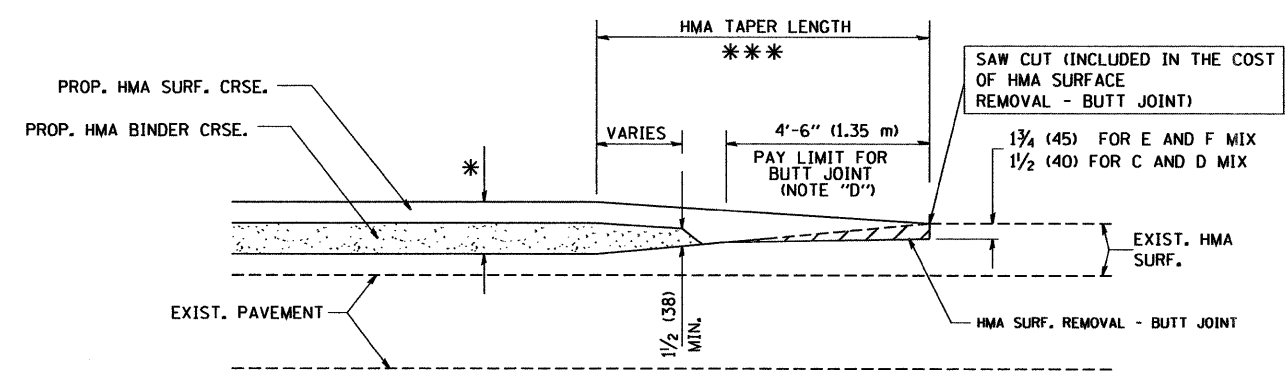

BUTT JOINT AND
HMA TAPER

**TYPICAL BUTT JOINT AND HMA TAPER
FOR MILLING AND RESURFACING**

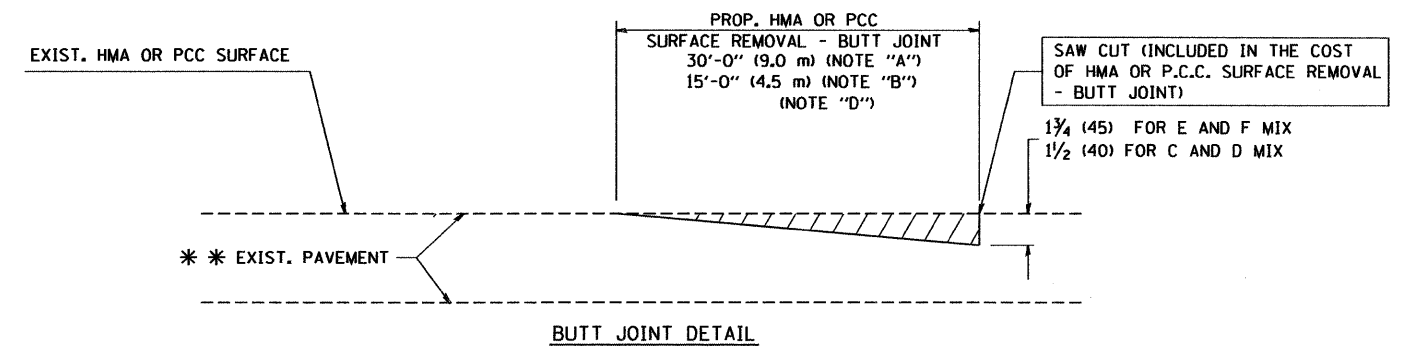

BUTT JOINT DETAIL

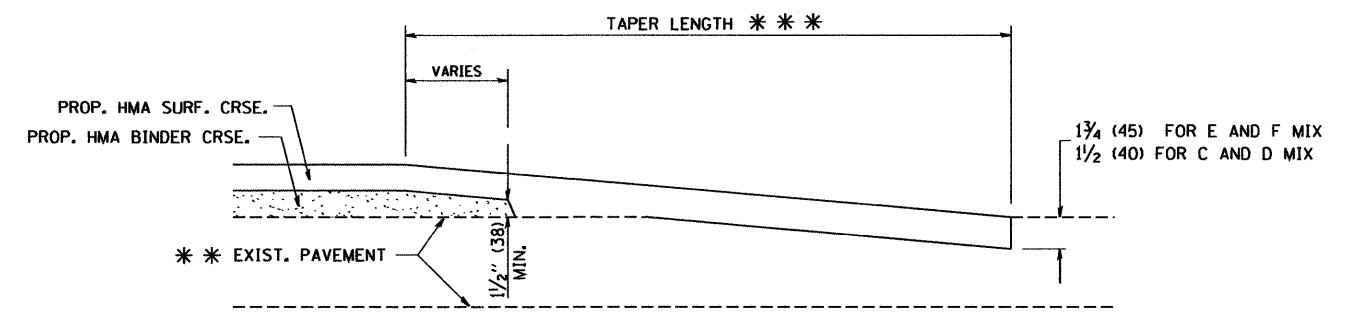

HMA TAPER DETAIL

**TYPICAL BUTT JOINT AND HMA TAPER
FOR RESURFACING ONLY**

*** PC CONCRETE, HMA OR HMA RESURFACED PAVEMENT.

NOTES

- A: MAINLINE ROADWAYS AND MAJOR SIDE ROADS.
 - B: MINOR SIDE ROADS.
 - C: THE TEMP. RAMP SHALL BE CONSTRUCTED IMMEDIATELY UPON REMOVAL OF THE EXISTING HMA SURFACE.
 - D: THE BUTT JOINT SHALL BE CONSTRUCTED IMMEDIATELY PRIOR TO PLACING THE PROPOSED HMA COURSES.
 - E: TAPER THE TEMP. RAMP AT A RATE OF 3'-0" (900 mm) PER 1 INCH (25 mm) OF MILLING THICKNESS.
 - F: INSTALLATION AND REMOVAL OF THE 4'-6" (1.35 m) TEMP. RAMP IS INCLUDED IN COST OF HMA SURFACE REMOVAL - BUTT JOINT
 - G: SEE ARTICLE 406.08 AND 406.14 OF THE STANDARD SPECIFICATIONS FOR "HMA AND/OR PCC SURFACE REMOVAL, BUTT JOINT".
- * SEE TYPICAL SECTIONS FOR MILLING THICKNESS.
- *** 20'-0" (6.1 m) PER 1 (25) RESURFACING (NOTE "A")
10'-0" (3.0 m) PER 1 (25) RESURFACING (NOTE "B")

BASIS OF PAYMENT:

THE BUTT JOINT WILL BE PAID FOR AT THE CONTRACT UNIT PRICE PER SQUARE YARD (SQUARE METER) FOR "HOT-MIX ASPHALT SURFACE REMOVAL - BUTT JOINT" OR FOR "PORTLAND CEMENT CONCRETE SURFACE REMOVAL - BUTT JOINT".

ALL DIMENSIONS ARE IN INCHES (MILLIMETERS) UNLESS OTHERWISE SHOWN.

FILE NAME = W:\distsd\22x34\bd32.dgn	USER NAME = gaglianobt	DESIGNED - M. DE YONG	REVISED - R. SHAH 10-25-94
		DRAWN -	REVISED - A. ABBAS 03-21-97
PLOT SCALE = 50.0000' / IN.		CHECKED -	REVISED - M. GOMEZ 04-06-01
PLOT DATE = 1/4/2008		DATE - 06-13-90	REVISED - R. BORO 01-01-07

**STATE OF ILLINOIS
DEPARTMENT OF TRANSPORTATION**

**BUTT JOINT AND
HMA TAPER DETAILS**

SCALE: NONE SHEET NO. 1 OF 1 SHEETS STA. TO STA.

F.A. RTE. 2744	SECTION (113 & 113 W) RS-10	COUNTY LAKE	TOTAL SHEETS 18	SHEET NO. 12
BD400-05 BD32			CONTRACT NO. 60H08	
FED. ROAD DIST. NO. 1 ILLINOIS FED. AID PROJECT				

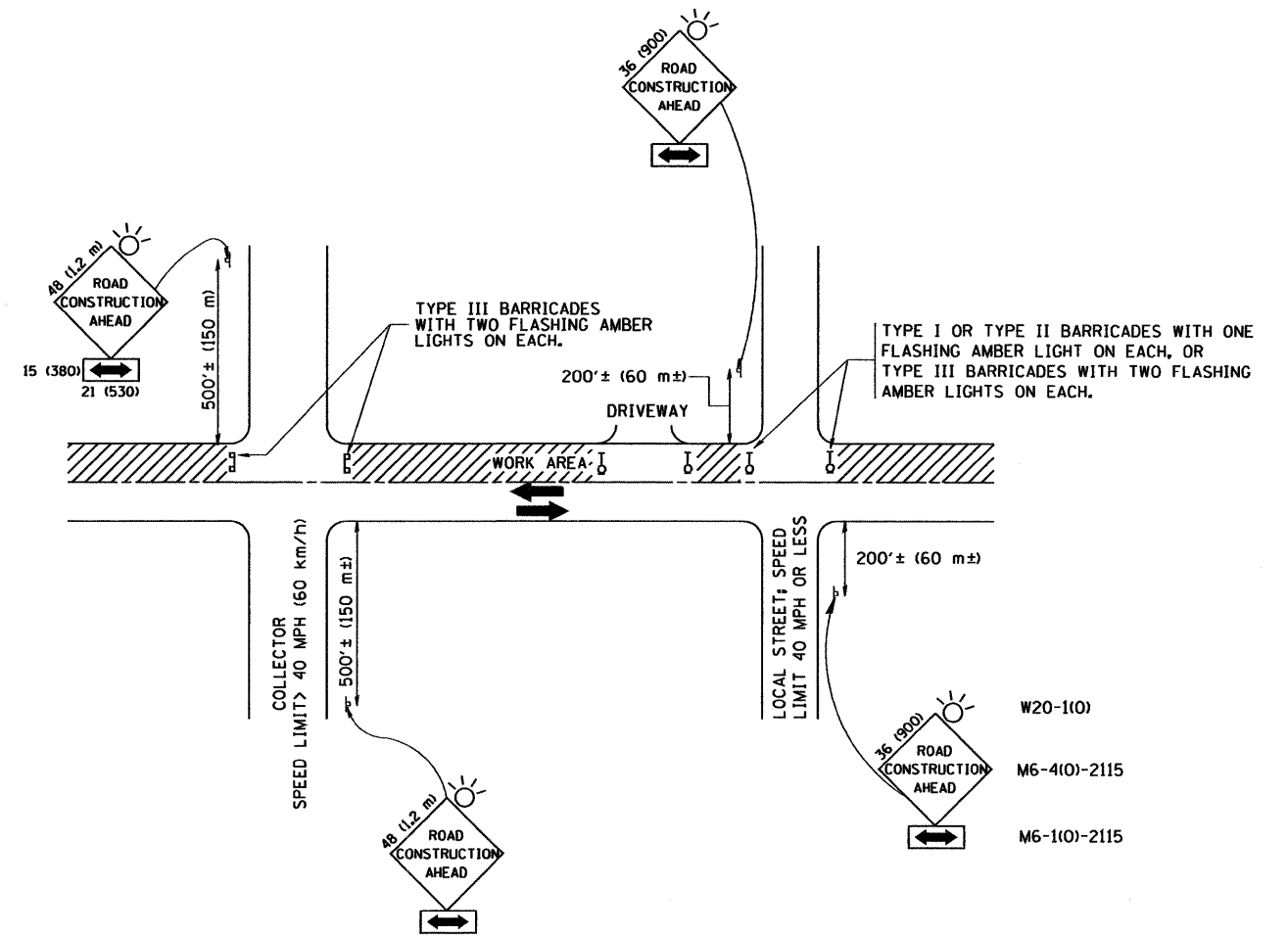

TRAFFIC CONTROL AND PROTECTION FOR SIDE ROADS, INTERSECTIONS, AND DRIVEWAYS

NOTES:

- A. FOR NO LANE RESTRICTION ON THE SIDE ROAD OR DRIVEWAYS
 1. SIDE ROAD WITH A SPEED LIMIT OF 40 MPH (60 km/h) OR LESS AS SHOWN ON THE DRAWING AND AS DIRECTED BY THE ENGINEER:
 - a) ONE ROAD CONSTRUCTION AHEAD SIGN 36 x 36 (900x900) WITH A FLASHER AND FLAG MOUNTED ON IT APPROXIMATELY 200' (60 m) IN ADVANCE OF THE MAIN ROUTE.
 - b) THE CLOSED PORTION OF THE MAIN ROUTE SHALL BE PROTECTED BY BLOCKING WITH TYPE I, TYPE II OR TYPE III BARRICADES, 1/3 OF THE CROSS SECTION OF THE CLOSED PORTION.
 2. SIDE ROAD WITH A SPEED LIMIT GREATER THAN 40 MPH (60 km/h) AS SHOWN ON THE DRAWING AND AS DIRECTED BY THE ENGINEER:
 - a) ONE ROAD CONSTRUCTION AHEAD SIGN 48 x 48 (1.2 m x 1.2 m) WITH A FLASHER MOUNTED ON IT APPROXIMATELY 500' (150 m) IN ADVANCE OF THE MAIN ROUTE.
 - b) THE CLOSED PORTION OF THE MAIN ROUTE SHALL BE PROTECTED BY BLOCKING WITH TYPE III BARRICADES, 1/2 OF THE CROSS SECTION OF THE CLOSED PORTION.
 3. WHEN THE SIDE ROAD LIES BETWEEN THE BEGINNING OF THE MAINLINE SIGNING AND THE WORK ZONE, A SINGLE HEADED ARROW (M6-1) SHALL BE USED IN LIEU OF THE DOUBLE HEADED ARROW (M6-4).
- B. FOR A LANE CLOSURE ON A SIDE ROAD OR DRIVEWAY:

USE APPLICABLE PORTIONS OF THE TYPICAL APPLICATION OF TRAFFIC CONTROL DEVICES (STD. 701501, STD. 701606 OR THE APPROPRIATE STANDARD). THE SPACING OF SIGNS AND BARRICADES SHALL BE ADJUSTED FOR FIELD CONDITIONS AS DIRECTED BY THE ENGINEER. THE DIRECTIONAL ARROW SHALL BE COVERED OR REMOVED WHEN NO LONGER CONSISTENT WITH THE SIDE ROAD LANE CLOSURE.
- C. ADVANCE WARNING SIGNS ARE TO BE OMITTED ON DRIVEWAY UNLESS OTHERWISE NOTED.
- D. THE TRAFFIC CONTROL AND PROTECTION FOR SIDE ROADS, INTERSECTIONS, AND DRIVEWAYS SHALL BE INCIDENTAL TO THE COST OF SPECIFIED TRAFFIC CONTROL STANDARDS OR ITEMS.

All dimensions are in millimeters (inches) unless otherwise shown.

FILE NAME =	USER NAME = goglianobt	DESIGNED - LHA	REVISED - J. OBERLE 10-18-95
W:\diststd\22x34\to18.dgn		DRAWN -	REVISED - A. HOUSEH 03-06-96
	PLOT SCALE = 50,000 / IN.	CHECKED -	REVISED - A. HOUSEH 10-15-96
	PLOT DATE = 1/4/2008	DATE - 06-89	REVISED - T. RAMMACHER 01-06-00

STATE OF ILLINOIS
DEPARTMENT OF TRANSPORTATION

TRAFFIC CONTROL AND PROTECTION FOR
SIDE ROADS, INTERSECTIONS, AND DRIVEWAYS

F.A. RTE.	SECTION	COUNTY	TOTAL SHEETS	SHEET NO.
2744	(113 & 113 W) RS-10	LAKE	18	13
TC-10			CONTRACT NO. 60H08	
FED. ROAD DIST. NO. 1 ILLINOIS FED. AID PROJECT				

SCALE: NONE SHEET NO. 1 OF 1 SHEETS STA. TO STA.

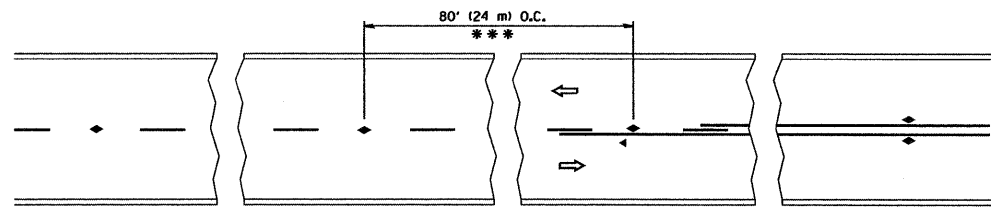

*** REDUCE TO 40' (12 m) O.C. ON CURVES WITH POSTED OR ADVISORY SPEED 45 M.P.H. (70 km/h) OR LESS.

TWO-LANE/TWO-WAY

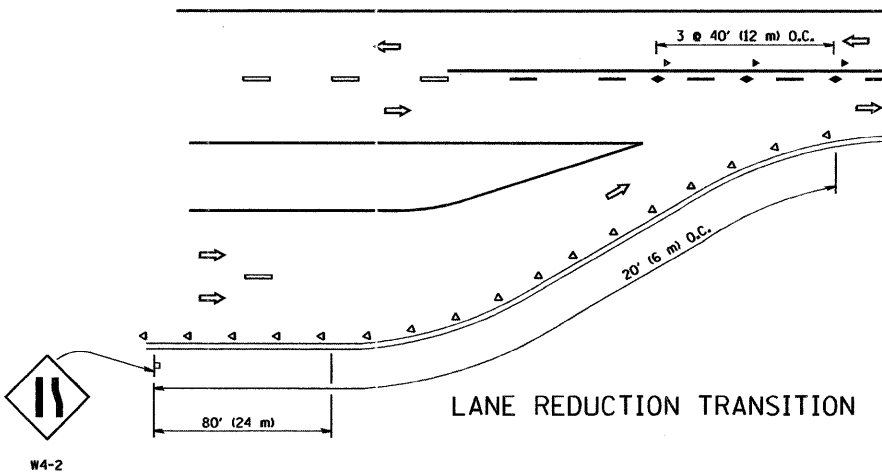

LANE REDUCTION TRANSITION

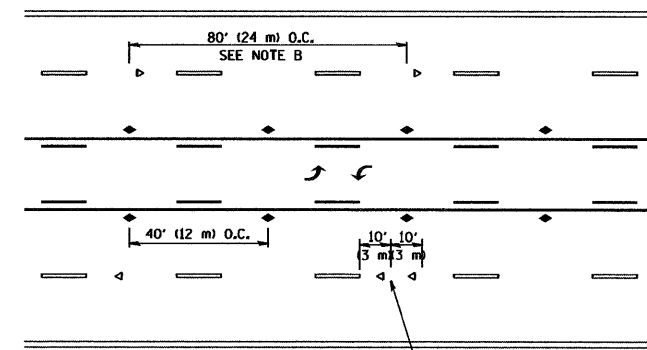

TWO-WAY LEFT TURN

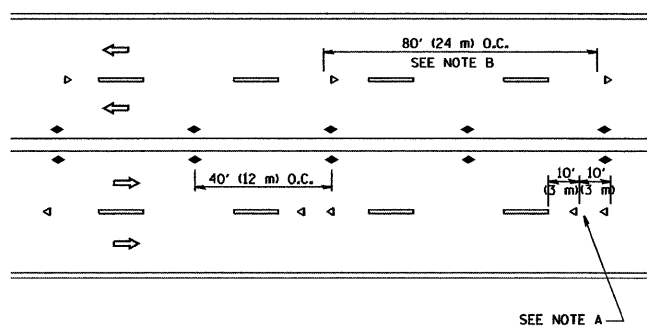

MULTI-LANE/UNDIVIDED

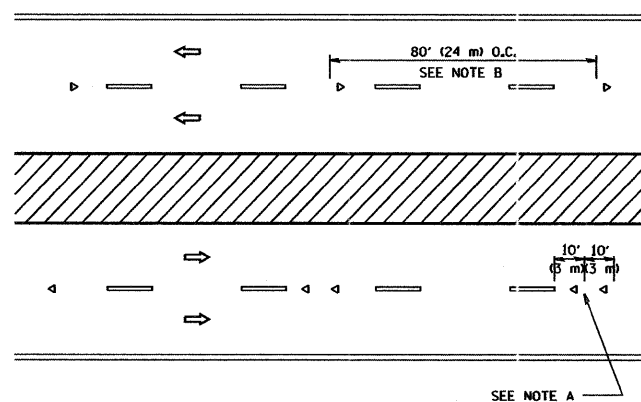

MULTI-LANE/DIVIDED

GENERAL NOTES

1. MARKERS USED WITH DASHED LINES SHALL BE CENTERED IN THE GAP BETWEEN SEGMENTS.
2. MARKERS USED ADJACENT TO SOLID LINES SHALL BE OFFSET 2 TO 3 (50 TO 75) TOWARD TRAFFIC AS SHOWN.
3. MARKERS THROUGH TANGENTS LESS THAN 500' (150 m) IN LENGTH BETWEEN CURVES SHALL BE INSTALLED AT THE LESSER OF THE TWO CURVE SPACINGS.

SYMBOLS

- YELLOW STRIPE
- WHITE STRIPE
- ◀ ONE-WAY AMBER MARKER
- ◁ ONE-WAY CRYSTAL MARKER (W/O)
- ◆ TWO-WAY AMBER MARKER

LANE MARKER NOTES

- B. REDUCE TO 40' (12 m) O.C. ON CURVES WHERE ADVISORY SPEEDS ARE 10 M.P.H. (20 km/h) LOWER THAN POSTED SPEEDS.
- A. USE DOUBLE LANE LINE MARKERS SPACED AS SHOWN.

DESIGN NOTES

1. DOUBLE LANE LINE MARKERS SHALL BE USED UNLESS SPECIFIED OTHERWISE.
2. EXCEPT AS SHOWN ON THE LANE REDUCTION TRANSITION AND FREEWAY EXIT RAMP DETAIL, MARKERS ARE NOT TO BE SPECIFIED ON RIGHT EDGE LINES.
3. THE EXACT MARKER LIMITS, SPACING, AND COLOR SHOULD BE INCLUDED IN THE PLANS.
4. MARKERS SHOULD NOT BE USED ALONGSIDE CURBS EXCEPT FOR EXTREMELY SHORT SECTIONS OF CURBS WHERE NOT MORE THAN TWO MARKERS WOULD BE INVOLVED.

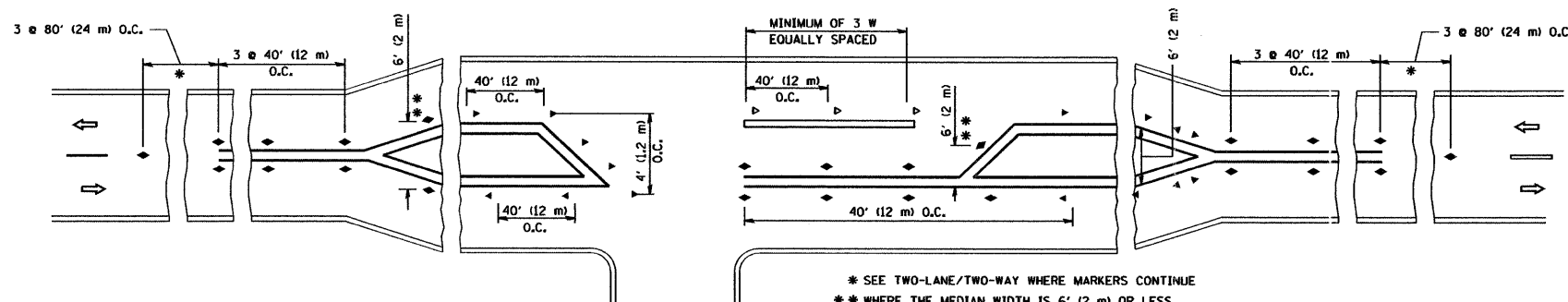

LEFT TURN

* SEE TWO-LANE/TWO-WAY WHERE MARKERS CONTINUE
 ** WHERE THE MEDIAN WIDTH IS 6' (2 m) OR LESS USE TWO-WAY MARKERS.

All dimensions are in Inches (millimeters) unless otherwise shown.

FILE NAME = W:\diststd\22x34\vtel1.dgn	USER NAME = geglionobt	DESIGNED -	REVISED - T. RAMMACHER 09-19-94	STATE OF ILLINOIS DEPARTMENT OF TRANSPORTATION	TYPICAL APPLICATIONS			F.A. -	SECTION	COUNTY	TOTAL SHEETS	SHEET NO.
	PLOT SCALE = 50,000 ' / IN.	DRAWN -	REVISED - T. RAMMACHER 03-12-99		RAISED REFLECTIVE PAVEMENT MARKERS (SNOW-PLOW RESISTANT)			2744	(113 & 113 W) RS-10	LAKE	18	14
	PLOT DATE = 1/4/2008	DATE -	REVISED - T. RAMMACHER 01-06-00		SCALE: NONE	SHEET NO. 1 OF 1 SHEETS	STA.	TO STA.	TC-11		CONTRACT NO. 60H08	
								FED. ROAD DIST. NO. 1 ILLINOIS FED. AID PROJECT				

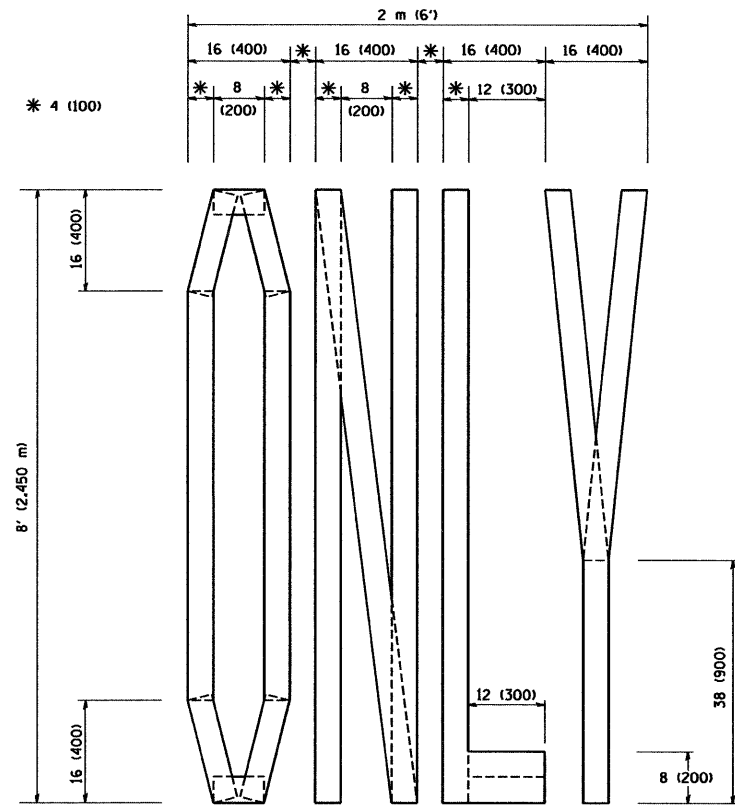

QUANTITY
 4 (100) LINE = 64.1 ft. (19.7 m)
 21.1 sq. ft. (1.97 sq. m)

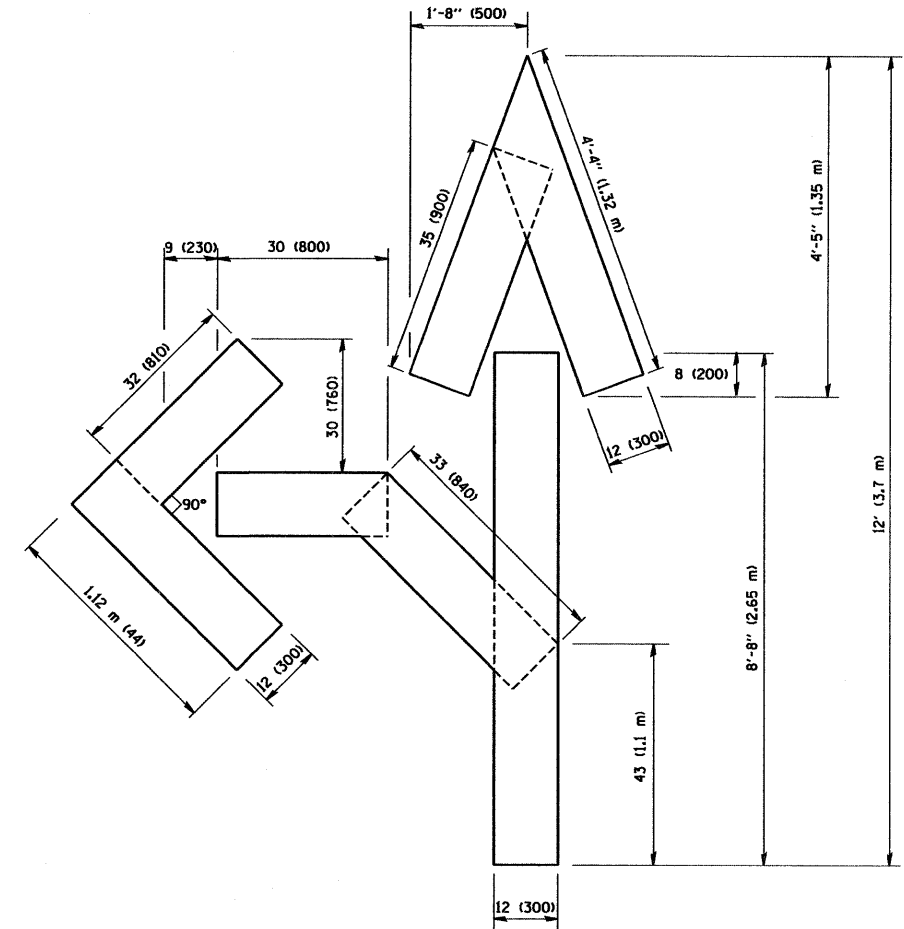

QUANTITY
 4 (100) LINE = 82.5 ft. (25.3 m)
 27.5 sq. ft. (2.53 sq. m)

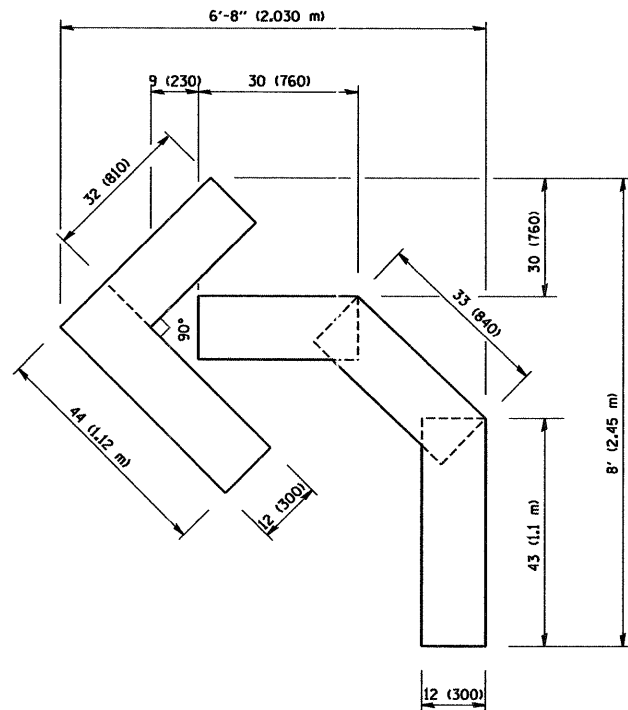

QUANTITY
 4 (100) LINE = 45.5 ft. (13.9 m)
 15.2 sq. ft. (1.39 sq. m)

All dimensions are in inches (millimeters) unless otherwise shown.

FILE NAME = W:\diststd\22x34\tbl6.dgn	USER NAME = gajlanobt	DESIGNED - DRAWN -	REVISED -T. RAMMACHER 06-05-96 REVISED -T. RAMMACHER 11-04-97
PLOT SCALE = 50.0000' / IN.	CHECKED -	REVISED -T. RAMMACHER 03-02-98	REVISED -E. GOMEZ 08-28-00
PLOT DATE = 1/4/2008	DATE = 09-18-94		

STATE OF ILLINOIS
 DEPARTMENT OF TRANSPORTATION

PAVEMENT MARKING LETTERS AND SYMBOLS
 FOR TRAFFIC STAGING

SCALE: NONE SHEET NO. 1 OF 1 SHEETS STA. TO STA.

F.A. RTE. 2744	SECTION (113 & 113 W) RS-10	COUNTY LAKE	TOTAL SHEETS 18	SHEET NO. 16
TC-16			CONTRACT NO. 60H08	
FED. ROAD DIST. NO. 1 ILLINOIS FED. AID PROJECT				

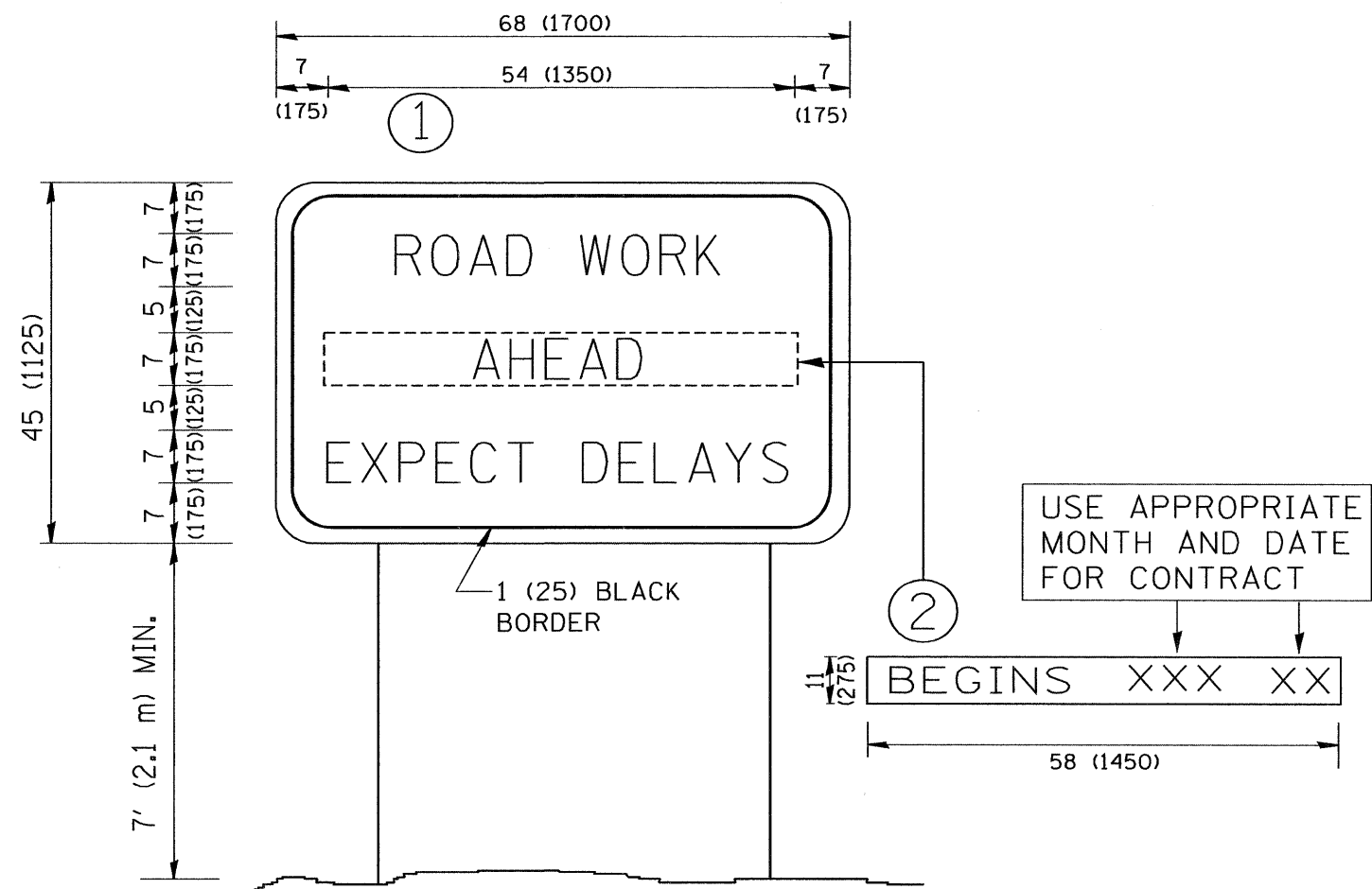

NOTES:

1. USE BLACK LETTERING ON ORANGE BACKGROUND.
2. ERECT SIGNS IN ADVANCE OF THE LOCATION FOR THE "ROAD CONSTRUCTION AHEAD" SIGN AT LOCATIONS AS DIRECTED BY THE ENGINEER.
3. ERECT SIGN ① WITH INSTALLED PANEL ② ONE WEEK PRIOR TO THE START OF CONSTRUCTION.
4. REMOVE PANEL ② SOON AFTER THE START OF CONSTRUCTION.
5. SEE SPECIAL PROVISION FOR "TEMPORARY INFORMATION SIGNING" FOR ADDITIONAL INFORMATION.
6. ONE SIGN ASSEMBLY EQUALS 25.70 SQ. FT. (2.3 SQ. M.)
7. SHALL BE PAID FOR AS TEMPORARY INFORMATION SIGNING.

ALL DIMENSIONS ARE IN INCHES (MILLIMETERS) UNLESS OTHERWISE SHOWN.

FILE NAME = W:\diststd\22x34\to22.dgn	USER NAME = gaglianobt	DESIGNED -	REVISED - R. MIRS 09-15-97	STATE OF ILLINOIS DEPARTMENT OF TRANSPORTATION	ARTERIAL ROAD INFORMATION SIGN			F.A. RTE. 2744	SECTION (113 & 113 W) RS-10	COUNTY LAKE	TOTAL SHEETS 18	SHEET NO. 17
	PLOT SCALE = 50,000 / IN.	DRAWN -	REVISED - R. MIRS 12-11-97		SCALE: NONE	SHEET NO. 1 OF 1 SHEETS	STA.	TO STA.	TC-22		CONTRACT NO. 60H08	
	PLOT DATE = 1/4/2000	CHECKED -	REVISED - T. RAMMACHER 02-02-99		FED. ROAD DIST. NO. 1 ILLINOIS FED. AID PROJECT							
		DATE -	REVISED - C. JUCIUS 01-31-07									

