

STATE OF ILLINOIS
 DEPARTMENT OF TRANSPORTATION
 DIVISION OF HIGHWAYS
**PROPOSED
 HIGHWAY PLANS**

FOR INDEX OF SHEETS, SEE SHEET NO. 2

**IMPROVEMENT IS LOCATED IN
 THE CITY OF ELGIN**

FAP ROUTE 345: WELD RD.
 RANDALL RD. TO MCLEAN BLVD
 SECTION 8R-1AC-RS
 RESURFACING
 KANE COUNTY
 C-91-568-09

TRAFFIC DATA:
 ADT = NOT COUNTED
 POSTED SPEED LIMIT = 45 MPH

IMPROVEMENT BEGINS
 STA. 1+36

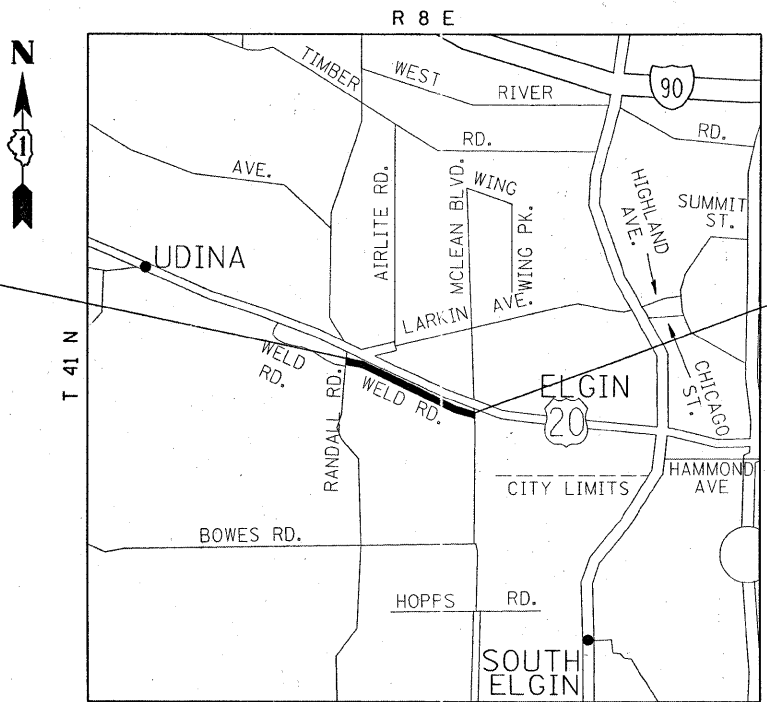

IMPROVEMENT ENDS
 STA. 76+57

ELGIN TOWNSHIP

FULL SIZE PLANS HAVE BEEN PREPARED USING STANDARD
 ENGINEERING SCALES. REDUCED SIZED PLANS WILL NOT
 CONFORM TO STANDARD SCALES. IN MAKING MEASUREMENTS
 ON REDUCED PLANS, THE ABOVE SCALES MAY BE USED.

J.U.L.I.E.
 JOINT UTILITY LOCATION INFORMATION FOR EXCAVATION
 1-800-892-0123
 OR 811

PROJECT ENGINEER ROBERT BORO (847) 705-4178
 PROJECT MANAGER KEN ENG

CONTRACT NO. 60H12

GROSS LENGTH AND NET LENGTH OF IMPROVEMENT = 7521 FT. = 1.43 MILE

F.A.P. RTE.	SECTION	COUNTY	TOTAL SHEETS	SHEET NO.
345	8R-1AC-RS	KANE	17	1
		ILLINOIS	CONTRACT NO. 60H12	



STATE OF ILLINOIS
 DEPARTMENT OF TRANSPORTATION
 DIVISION OF HIGHWAYS

SUBMITTED April 20 2009
Dave Oll
 DEPUTY DIRECTOR OF HIGHWAYS, REGION ENGINEER

May 1, 20 09
Charles J. Ingersoll
 ENGINEER OF DESIGN AND ENVIRONMENT

May 1, 20 09
Christine M. Reed
 DIRECTOR OF HIGHWAYS, CHIEF ENGINEER

**PRINTED BY THE AUTHORITY
 OF THE STATE OF ILLINOIS**