

**TRAFFIC SIGNAL LEGEND**

	PROPOSED	EXISTING
DETECTOR LOOP	□	□
SIGNAL HEAD	—	△
G.S. CONDUIT IN TRENCH OR PUSHED	---	---
SIGNAL HEAD WITH BACKPLATE	—	△
RACEWAY FOR MAGNETIC DETECTOR, TYPE I OR II	—	— "E"
VEHICLE DETECTOR, NON-COMPENSATED MAGNETIC TYPE	□	□

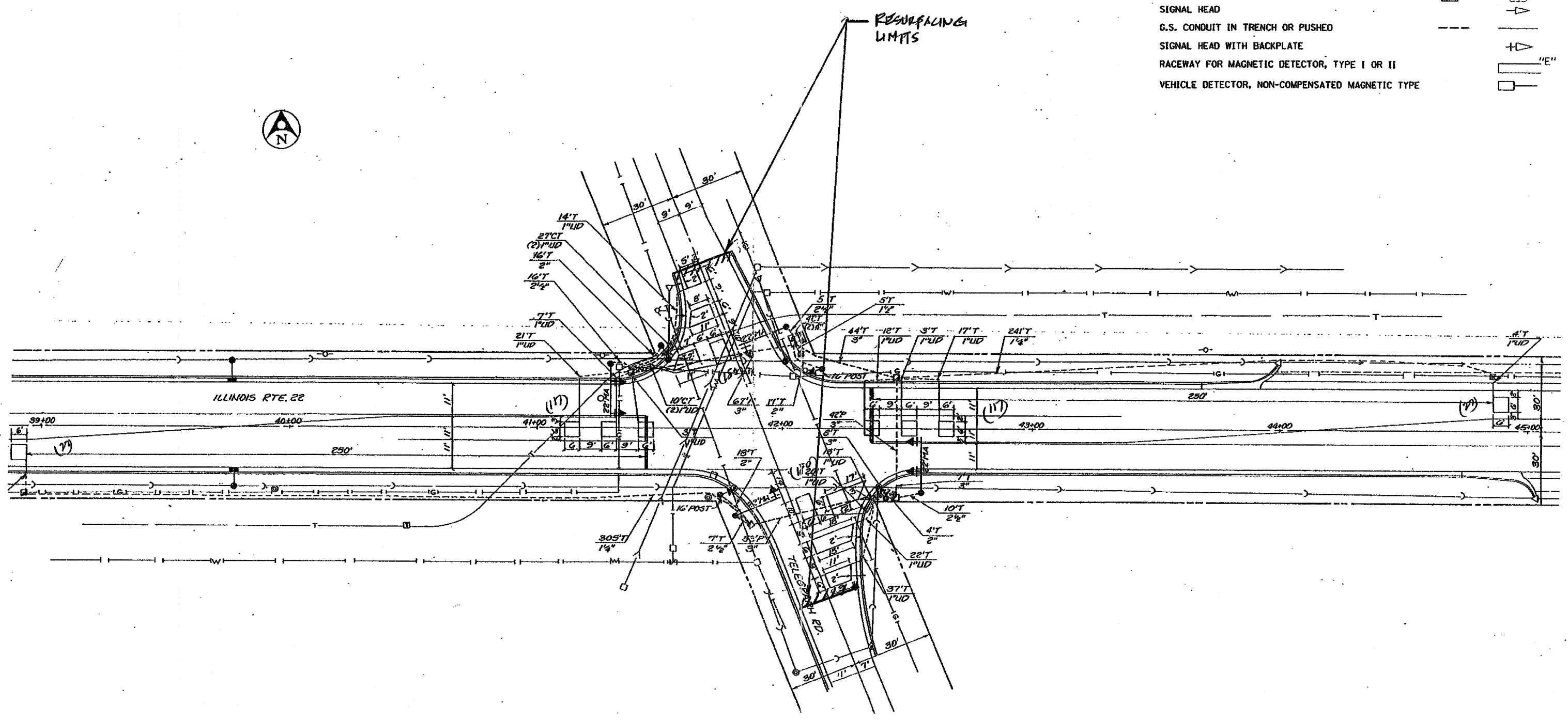

THIS PLAN IS FOR THE SOLE PURPOSE OF DETECTOR LOOP REPLACEMENTS ONLY

REPLACE ALL DETECTOR LOOPS AS SHOWN (WITHIN THE RESURFACING LIMITS)

CODE	QUANTITY	UNIT	ITEM
86600600	620	FOOT	DETECTOR LOOP, REPLACEMENT

FILE NAME =	USER NAME = kcanthopixoybo	DESIGNED - BCK	REVISED -
cr:\pwork\PHIDOT\KANTHAPHIXAYBC\d91126	tr:\office\legend_v7.dgn	DRAWN - BCK	REVISED -
	PLOT SCALE = 3/4" = 1' IN.	CHECKED - DAD	REVISED -
	PLOT DATE = 4/3/2009	DATE	REVISED -

**STATE OF ILLINOIS**  
**DEPARTMENT OF TRANSPORTATION**

**DISTRICT ONE - DETECTOR LOOP REPLACEMENT**  
**ILL. ROUTE 22 @ TELEGRAPH RD.**

F.A.P. RTE.	SECTION	COUNTY	TOTAL SHEETS	SHEET NO.
337	20RS-9	LAKE	22	11
CONTRACT NO.			60428	
FED. ROAD DIST. NO. ILLINOIS FED. AID PROJECT				

SCALE: NONE SHEET NO. OF SHEETS STA. TO STA.