

TRAFFIC SIGNAL LEGEND

	PROPOSED	EXISTING
DETECTOR LOOP		
SIGNAL HEAD		
G.S. CONDUIT IN TRENCH OR PUSHED		
SIGNAL HEAD WITH BACKPLATE		
RACEWAY FOR MAGNETIC DETECTOR, TYPE I OR II		
VEHICLE DETECTOR, NON-COMPENSATED MAGNETIC TYPE		

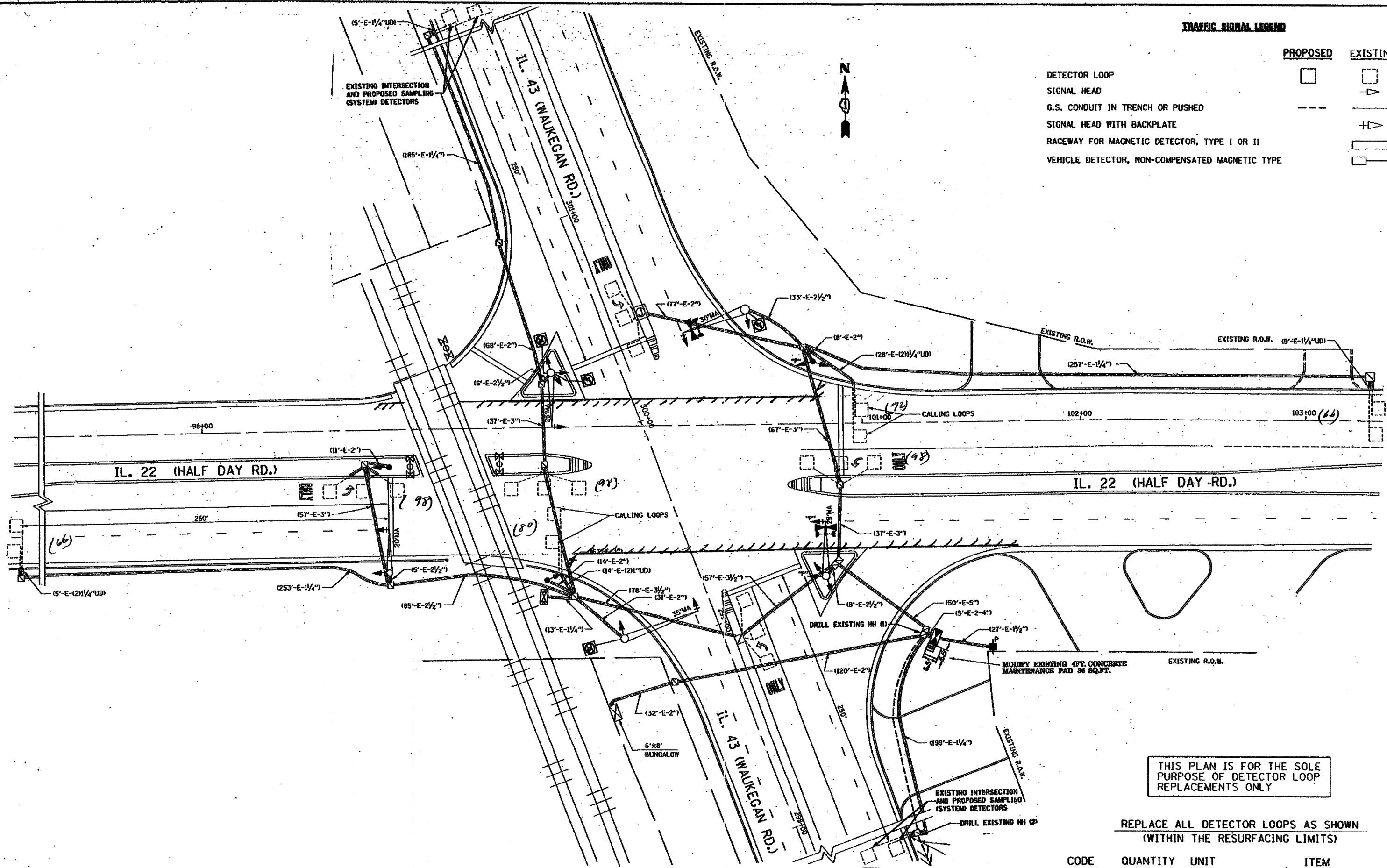

THIS PLAN IS FOR THE SOLE PURPOSE OF DETECTOR LOOP REPLACEMENTS ONLY

REPLACE ALL DETECTOR LOOPS AS SHOWN (WITHIN THE RESURFACING LIMITS)

CODE	QUANTITY	UNIT	ITEM
86600600	582	FOOT	DETECTOR LOOP, REPLACEMENT

FILE NAME =	USER NAME = konthphiaybc	DESIGNED - BCK	REVISED -
or\pwork\PM1001\KANTHPHIAYBC\081126	\\vraoffice\legend.v7.dgn	DRAWN - BCK	REVISED -
	PLOT SCALE = 3/4" = 1'	CHECKED - OAD	REVISED -
	PLOT DATE = 1/3/2007	DATE -	REVISED -

STATE OF ILLINOIS
DEPARTMENT OF TRANSPORTATION

DISTRICT ONE - DETECTOR LOOP REPLACEMENT
ILL. ROUTE 22 @ ILL. ROUTE 43

SCALE: NONE SHEET NO. OF SHEETS STA. TO STA.

F.A.P. RTE.	SECTION	COUNTY	TOTAL SHEETS	SHEET NO.
337	20 RS-9	LAKE	22	12
FED. ROAD DIST. NO.		ILLINOIS FED. AID PROJECT		
60H2B		CONTRACT NO.		