

PROP. HMA SURFACE COURSE, MIX "D", N 70, 1 1/2"
 PROP. POLY. LEVELING BINDER (MACHINE METHOD), IL-4.75, N 50, 3/4" TO 1"
 PROP. HMA SURFACE REMOVAL, 2 1/2"

LEGEND

- ① 2-(4") YELLOW @ 11" C-C
- ② (4") YELLOW EDGE LINE
- ③ (4") YELLOW LANE LINE 10' DASH 30' SKIP
- ④ (6") WHITE TURN LANE
- ⑤ (24") STOP LINES
- ⑥ (12") YELLOW DIAGONALS
- ⑦ (4") WHITE LINE
- ⑧ LETTERS AND SYMBOLS

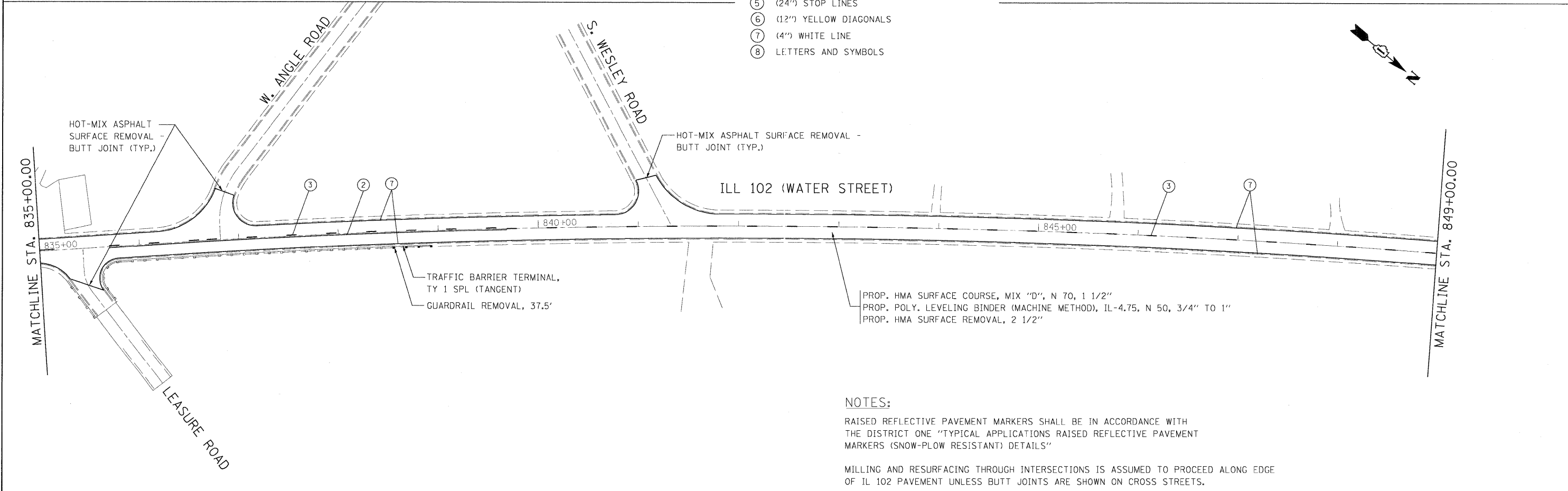

PROP. HMA SURFACE COURSE, MIX "D", N 70, 1 1/2"
 PROP. POLY. LEVELING BINDER (MACHINE METHOD), IL-4.75, N 50, 3/4" TO 1"
 PROP. HMA SURFACE REMOVAL, 2 1/2"

NOTES:

RAISED REFLECTIVE PAVEMENT MARKERS SHALL BE IN ACCORDANCE WITH THE DISTRICT ONE "TYPICAL APPLICATIONS RAISED REFLECTIVE PAVEMENT MARKERS (SNOW-PLOW RESISTANT) DETAILS"

MILLING AND RESURFACING THROUGH INTERSECTIONS IS ASSUMED TO PROCEED ALONG EDGE OF IL 102 PAVEMENT UNLESS BUTT JOINTS ARE SHOWN ON CROSS STREETS.

FILE NAME =
 ...Plans\p1n62789pp&mrk5.dgn

USER NAME = mcoleman
 PLOT SCALE = 1" = 50'
 PLOT DATE = 4/21/2009

DESIGNED - MAC
 DRAWN - IS
 CHECKED - JJT
 DATE - 4/20/09

REVISED -
 REVISED -
 REVISED -
 REVISED -

STATE OF ILLINOIS
 DEPARTMENT OF TRANSPORTATION

ROADWAY & PAVEMENT MARKING PLANS
 ILL 102 (WATER STREET) - RYAN STREET TO TO OLD CHICAGO ROAD

SCALE: 1" = 50' SHEET NO. OF 30 SHEETS STA. 821+00 TO STA. 849+00

F.A.P. RTE.	SECTION	COUNTY	TOTAL SHEETS	SHEET NO.
631	111 N-RS-1	WILL	30	9
FED. ROAD DIST. NO. 1 ILLINOIS FED. AID PROJECT				

CONTRACT NO. 60H37