

PROPOSED HOT-MIX ASPHALT SURFACE REMOVAL, 2 1/4"
 PROPOSED HOT-MIX ASPHALT SURFACE COURSE, MIX "D", N70, 1 1/2"
 PROPOSED POLYMERIZED LEVELING BINDER (MACHINE METHOD), IL-4.75, N50, 3/4"

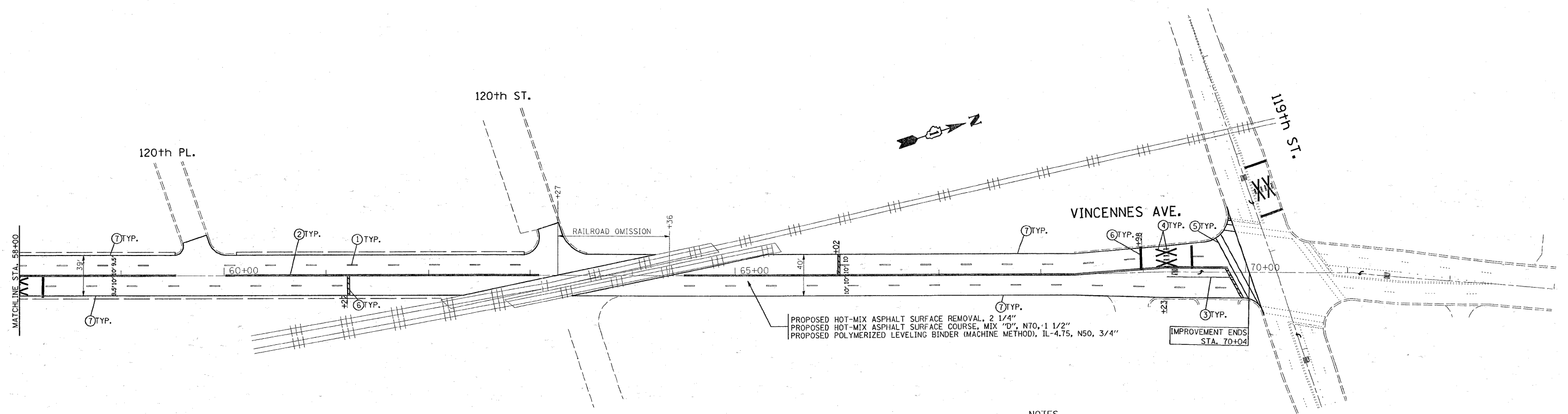

PROPOSED HOT-MIX ASPHALT SURFACE REMOVAL, 2 1/4"
 PROPOSED HOT-MIX ASPHALT SURFACE COURSE, MIX "D", N70, 1 1/2"
 PROPOSED POLYMERIZED LEVELING BINDER (MACHINE METHOD), IL-4.75, N50, 3/4"

IMPROVEMENT ENDS STA. 70+04

PAVEMENT MARKING LEGEND

- ① 4" SKIP DASH LANE LINE- WHITE
- ② 4" DOUBLE YELLOW
- ③ 6" TURN LANE-WHITE
- ④ LETTERS & SYMBOLS-WHITE
- ⑤ 12" DIAGONALS-YELLOW @ 45°
- ⑥ 24" STOP BAR-WHITE
- ⑦ 4" EDGE LINE-WHITE

NOTES

LIMIT OF RESURFACING ON SIDE-STREETS THROUGH OUT THE IMPROVEMENT SHALL BE TO THE RADIUS OF RETURN OR AS DIRECTED BY THE ENGINEER.

ALL FINAL PAVEMENT MARKINGS SHALL BE THERMOPLASTIC (OF THE EXTRUDED TYPE) AND SHOULD BE PLACED IN ACCORDANCE WITH "DISTRICT ONE TYPICAL PAVEMENT MARKINGS" DETAIL, (TC-13).

ALL RAISED REFLECTIVE PAVEMENT MARKERS SHALL BE PLACED IN ACCORDANCE WITH THE DISTRICT ONE "TYPICAL APPLICATIONS RAISED REFLECTIVE PAVEMENT MARKER DETAIL." (TC-11).

FILE NAME =	USER NAME = abreuah	DESIGNED -	REVISED -	STATE OF ILLINOIS DEPARTMENT OF TRANSPORTATION	ROADWAY AND PAVEMENT MARKING PLAN VINCENNES AVE. (119th ST. - 127th ST.)	F.A.U. RTE.	SECTION	COUNTY	TOTAL SHEETS	SHEET NO.	
c:\pwork\pwork\abreuah\0138737\0148900.sht.plandgn		DRAWN -	REVISED -			2846	1818RS-2	COOK	15	6	
PLOT SCALE = 50.0000' / IN.		CHECKED -	REVISED -			CONTRACT NO. 62060					
PLOT DATE = 4/14/2009		DATE -	REVISED -			ILLINOIS FED. AID PROJECT					