

F.A.P. RTE.	SECTION	COUNTY	TOTAL SHEETS	SHEET NO.
531	2004-044 RS	WILL	76	1
		ILLINOIS	CONTRACT NO. 62659	

STATE OF ILLINOIS  
DEPARTMENT OF TRANSPORTATION  
DIVISION OF HIGHWAYS

**PROPOSED  
HIGHWAY PLANS**

F.A.P. ROUTE 531: MANHATTAN-MONEE RD  
CEDAR RD TO SCHOOL HOUSE RD  
SECTION: 2004-044RS  
RESURFACING  
WILL COUNTY  
C-91-020-04

FOR INDEX OF SHEETS, SEE SHEET NO. 2

IMPROVEMENT LOCATED IN UNINCORPORATED MANHATTAN TOWNSHIP

D-91-020-04

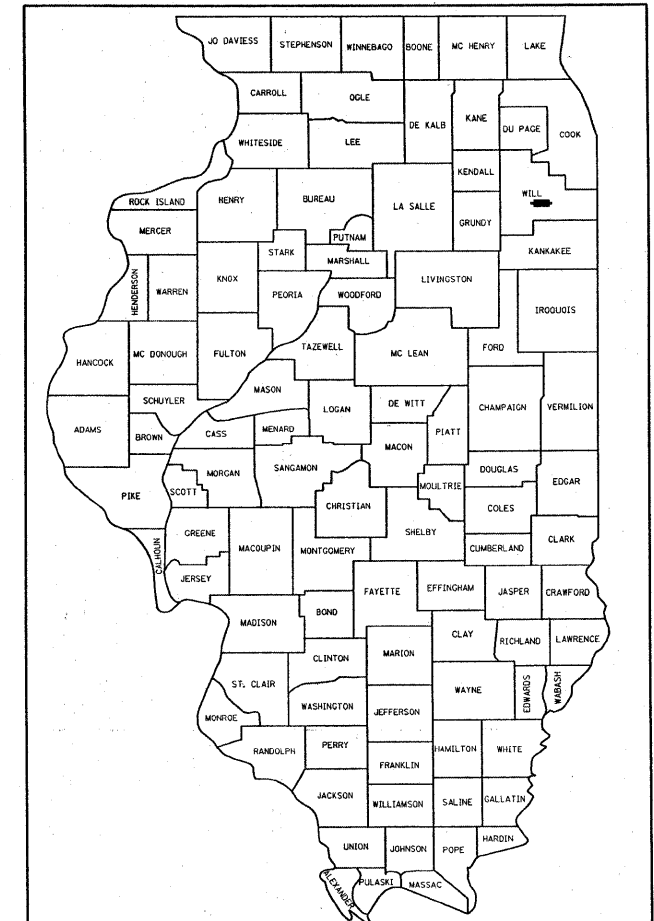

LOCATION OF SECTION INDICATED THUS: - ■ -

**STRUCTURE DATA:**  
MANHATTAN-MONEE ROAD OVER  
PRAIRIE CREEK TRIBUTARY  
STRUCTURE NO. 099-0194

**IMPROVEMENT BEGINS:**  
STATION 68 + 03.76

**IMPROVEMENT ENDS:**  
STATION 178 + 32.00

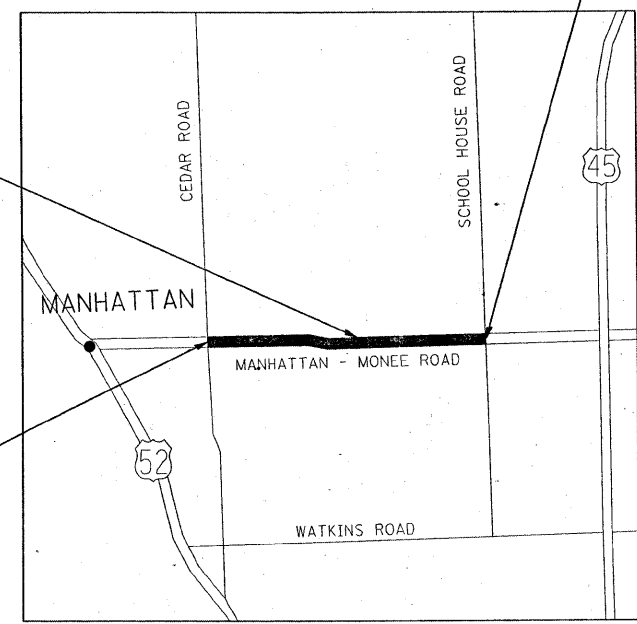

**TRAFFIC DATA**

2008 ADT = 7,000  
POSTED SPEED LIMIT: 45 MPH

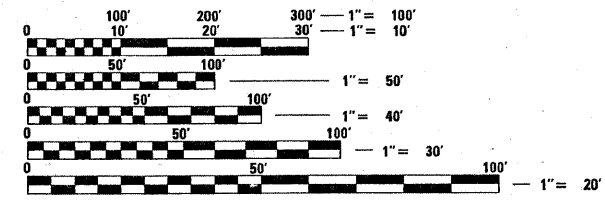

FULL SIZE PLANS HAVE BEEN PREPARED USING STANDARD ENGINEERING SCALES. REDUCED SIZED PLANS WILL NOT CONFORM TO STANDARD SCALES. IN MAKING MEASUREMENTS ON REDUCED PLANS, THE ABOVE SCALES MAY BE USED.

J.U.L.I.E.  
JOINT UTILITY LOCATION INFORMATION FOR EXCAVATION  
1-800-892-0123  
OR 811

STATE OF ILLINOIS  
DEPARTMENT OF TRANSPORTATION  
DIVISION OF HIGHWAYS

SUBMITTED APRIL 14, 2009

*Diana M. O'Keefe* DEPUTY DIRECTOR OF HIGHWAYS, REGION ENGINEER  
May 1, 2009

*Charles S. Ingersoll* ENGINEER OF DESIGN AND ENVIRONMENT  
May 1, 2009

*Christine M. Reed* DIRECTOR OF HIGHWAYS, CHIEF ENGINEER

PROJECT ENGINEER: JENPAI CHANG - (847) 705-4432  
PROJECT MANAGER: KEN ENG - (847) 705-4247

GROSS & NET LENGTH OF IMPROVEMENT = 11,029 FEET = 2.09 MILES

**PRINTED BY THE AUTHORITY  
OF THE STATE OF ILLINOIS**

CONTRACT NO. 62659

**INDEX OF SHEETS:**

SHEET:	DESCRIPTION:
1	TITLE SHEET
2	INDEX OF SHEETS, STATE STANDARDS AND GENERAL NOTES
3	SUMMARY OF QUANTITIES
4	TYPICAL ROADWAY CROSS-SECTIONS
5	TYPICAL BRIDGE CROSS-SECTIONS, S.N. 099-0194
6 - 10	ROADWAY & PAVEMENT MARKING PLAN
11	PAVEMENT PATCHING FOR HMA SURFACED PAVEMENT
12	BUTT JOINT AND HMA TAPER DETAILS
13	TRAFFIC CONTROL AND PROTECTION FOR SIDE ROADS, INTERSECTIONS AND DRIVEWAYS
14	RAISED REFLECTIVE PAVEMENT MARKERS (SNOW PLOW RESISTANT)
15	DISTRICT ONE TYPICAL PAVEMENT MARKINGS
16	TEMPORARY INFORMATION SIGNING

**STATE STANDARDS:**

000001-05	STANDARD SYMBOLS, ABBREVIATIONS, AND PATTERNS
442201-03	CLASS C AND D PATCHES
630301-05	SHOULDER WIDENING FOR TYPE 1 (SPECIAL) GUARDRAIL TERMINALS
635006-03	REFLECTOR AND TERMINAL MARKER PLACEMENT
701301-03	LANE CLOSURE, 2-L, 2-W, SHORT TIME OPERATIONS, FOR SPEEDS > 45MPH
701311-03	LANE CLOSURE, 2-L, 2-W, MOVING OPERATIONS - DAY ONLY, FOR SPEEDS > 45MPH
701501-05	URBAN LANE CLOSURE, 2-L, 2-W, UNDIVIDED
701901-01	TRAFFIC CONTROL DEVICES

**GENERAL NOTES:**

BEFORE STARTING ANY EXCAVATION, THE CONTRACTOR SHALL CALL "JULIE" AT 800-892-0123 FOR FIELD LOCATIONS OF BURIED ELECTRIC, TELEPHONE AND GAS FACILITIES. (48 HOUR NOTIFICATION IS REQUIRED).

THE CONTRACTOR SHALL COORDINATE CONSTRUCTION ACTIVITIES WITH UTILITY COMPANIES ALONG WITH MANHATTAN TOWNSHIP

THE CONTRACTOR WILL NOT BE ALLOWED TO SET UP A YARD OR FIELD OFFICE ON STATE PROPERTY WITHOUT WRITTEN PERMISSION FROM THE DEPARTMENT.

BUTT JOINTS WILL BE INSTALLED AT THE ENDS OF ALL RESURFACING (WHERE RESURFACING MEETS EXISTING PAVEMENT), IN ACCORDANCE WITH THE "BUTT JOINT AND HMA TAPER DETAILS" SHEET INCLUDED IN THE PLANS, UNLESS OTHERWISE SPECIFIED.

THE CONTRACTOR SHALL CONTACT THE AREA TRAFFIC FIELD ENGINEER AT (815) 485-6475 A MINIMUM OF TWO (2) WEEKS PRIOR TO PLACEMENT OF PERMANENT PAVEMENT MARKINGS.

THE CONTRACTOR SHALL VERIFY THE LOCATIONS OF ALL EXISTING PAVEMENT MARKINGS PRIOR TO MILLING OR RESURFACING.

THE RESIDENT ENGINEER SHALL CONTACT THE TRAFFIC CONTROL SUPERVISOR AT (847) 705-4470 A MINIMUM OF 72 HOURS PRIOR TO THE INSTALLATION OF ANY TEMPORARY TRAFFIC CONTROL DEVICES.

LOCATIONS OF CLASS D PATCHING TO BE DETERMINED IN THE FIELD BY THE RESIDENT ENGINEER.

FILE NAME =	USER NAME = smthkl	DESIGNED -	REVISED -	<b>STATE OF ILLINOIS DEPARTMENT OF TRANSPORTATION</b>	<b>MANHATTAN-MONEE ROAD</b>			F.A.P. RTE.	SECTION	COUNTY	TOTAL SHEETS	SHEET NO.
es:\pwork\PW1001\SMITHKL\d0137269\1022004-shr-plan.dgn		DRAWN -	REVISED -		<b>INDEX OF SHEETS, STATE STANDARDS, AND GENERAL NOTES</b>			531	2004-044RS	WILL	16	2
PLOT SCALE = 50.0000' / IN.		CHECKED -	REVISED -		SCALE: 1"= 50'	SHEET NO.	OF SHEETS	STA.	TO STA.	<b>CONTRACT NO. 62659</b>		
PLOT DATE = 4/15/2009		DATE -	REVISED -		ILLINOIS FED. AID PROJECT							

SUMMARY OF QUANTITIES				URBAN 100% STATE					CONSTRUCTION TYPE CODE					SUMMARY OF QUANTITIES				CONSTRUCTION TYPE CODE							
CODE NO	ITEM	UNIT	TOTAL QUANTITIES									CODE NO	ITEM	UNIT	TOTAL QUANTITIES										
				1000																					
20201006	GRADING AND SHAPING SHOULDERS	UNIT	239	239																					
40600200	BITUMINOUS MATERIALS (PRIME COAT)	TON	21	21																					
40600300	AGGREGATE (PRIME COAT)	TON	104	104																					
40600400	MIXTURE FOR CRACKS, JOINTS, AND FLANGEWAYS	TON	13	13																					
40600895	CONSTRUCTING TEST STRIP	EACH	1	1																					
40600982	HOT-MIX ASPHALT SURFACE REMOVAL - BUTT JOINT	SO YD	70	70																					
40601005	HOT-MIX ASPHALT REPLACEMENT OVER PATCHES	TON	400	400																					
40603340	HOT-MIX ASPHALT SURFACE COURSE, MIX "D", N70	TON	2185	2185																					
44000158	HOT-MIX ASPHALT SURFACE REMOVAL, 2 1/4"	SO YD	25995	25995																					
44002216	HOT-MIX ASPHALT REMOVAL OVER PATCHES, 4"	SO YD	2360	2360																					
44201753	CLASS D PATCHES, TYPE II, 9 INCH	SO YD	795	795																					
44201757	CLASS D PATCHES, TYPE III, 9 INCH	SO YD	596	596																					
44201759	CLASS D PATCHES, TYPE IV, 9 INCH	SO YD	596	596																					
48102100	AGGREGATE WEDGE SHOULDER, TYPE B	TON	445	445																					
63100167	TRAFFIC BARRIER TERMINAL, TYPE 1 (SPECIAL) TANGENT	EACH	3	3																					
63200310	GUARDRAIL REMOVAL	FOOT	113	113																					
67000400	ENGINEER'S FIELD OFFICE, TYPE A	CAL MO	3	3																					
67100100	MOBILIZATION	L SUM	1	1																					
70102620	TRAFFIC CONTROL AND PROTECTION, STANDARD 701501	L SUM	1	1																					
70300100	SHORT-TERM PAVEMENT MARKING	FOOT	3010	3010																					
70300220	TEMPORARY PAVEMENT MARKING - LINE 4"	FOOT	29784	29784																					
70300280	TEMPORARY PAVEMENT MARKING - LINE 24"	FOOT	11	11																					
70301000	WORK ZONE PAVEMENT MARKING REMOVAL	SO FT	9950	9950																					
* 78000200	THERMOPLASTIC PAVEMENT MARKING - LINE 4"	FOOT	29784	29784																					
* 78000650	THERMOPLASTIC PAVEMENT MARKING - LINE 24"	FOOT	11	11																					
* 78100100	RAISED REFLECTIVE PAVEMENT MARKER	EACH	230	230																					
78201000	TERMINAL MARKER - DIRECT APPLIED	EACH	3	3																					
78300200	RAISED REFLECTIVE PAVEMENT MARKER REMOVAL	EACH	154	154																					
X0322256	TEMPORARY INFORMATION SIGNING	SO FT	51.4	51.4																					
X4067107	POLYMERIZED LEVELING BINDER (MACHINE METHOD), IL-4.75, N50	TON	1025	1025																					

FILE NAME =  
c:\work\p\pl\pl\am\the\00137267\002004-sh-pln.dwg

USER NAME = amtkk  
PLOT SCALE = 50.0000' / 1" IN.  
PLOT DATE = 4/14/2009

DESIGNED -  
DRAWN -  
CHECKED -  
DATE -

REVISED -  
REVISED -  
REVISED -  
REVISED -

**STATE OF ILLINOIS  
DEPARTMENT OF TRANSPORTATION**

**SUMMARY OF QUANTITIES**

SCALE: SHEET NO. OF SHEETS STA. TO STA.

F.A.P. RTE. 531	SECTION 2004-044RS	COUNTY WILL	TOTAL SHEETS 16	SHEET NO. 3
FED. ROAD DIST. NO. 1   ILLINOIS FED. AID PROJECT				
CONTRACT NO. 62659				

\* SPECIALTY ITEMS

LEGEND

- ① EXISTING 9"- 7"- 9" P.C.C. PAVEMENT
- ② EXISTING HOT-MIX ASPHALT WIDENING, 9"
- ③ EXISTING HOT-MIX ASPHALT SURFACE, ±4"
- ④ EXISTING AGGREGATE WEDGE SHOULDER, TYPE B
- ⑤ PROPOSED HOT-MIX ASPHALT SURFACE REMOVAL, 2 1/4 "
- ⑥ PROPOSED HOT-MIX ASPHALT SURFACE COURSE, MIX "D" N70, 1 1/2"
- ⑦ PROPOSED POLYMERIZED LEVELING BINDER (MACHINE METHOD), IL-4.75, N50, 3/4 "
- ⑧ PROPOSED GRADING & SHAPING SHOULDERS

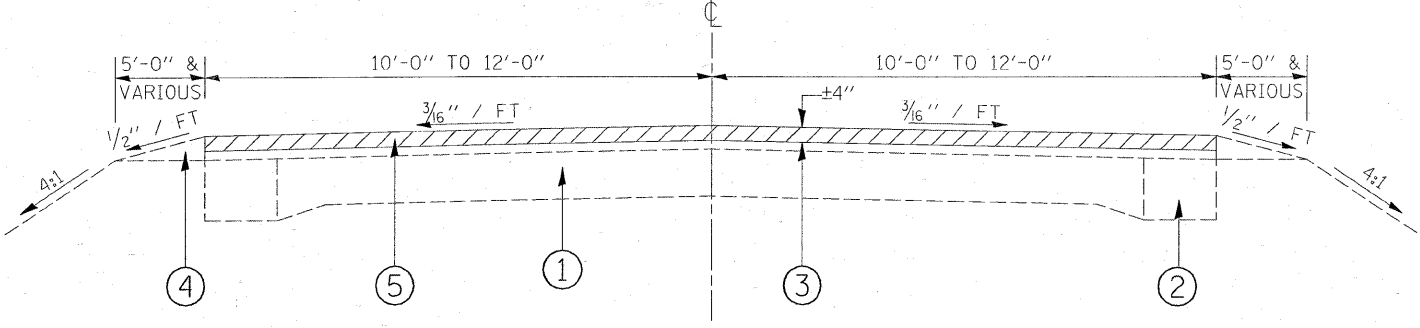

**MANHATTAN-MONEE ROAD  
EXISTING TYPICAL SECTION**  
STA. 68+33.00 TO STA. 135+71.44  
AND  
STA. 136+08.56 TO STA. 178+32.00

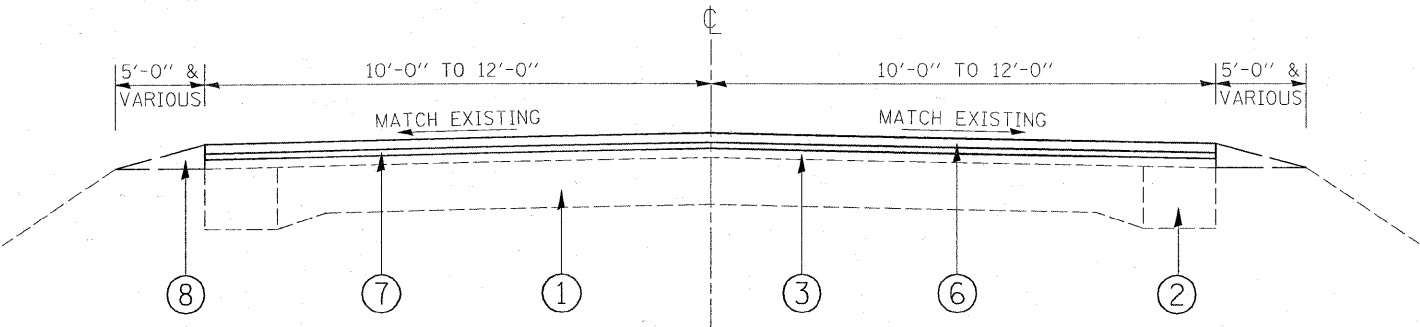

**MANHATTAN-MONEE ROAD  
PROPOSED TYPICAL SECTION**  
STA. 68+33.00 TO STA. 135+71.44  
AND  
STA. 136+08.56 TO STA. 178+32.00

**HOT-MIX ASPHALT MIXTURE REQUIREMENTS**

	MIXTURE USE	AC TYPE	AIR VOIDS (%)
ROADWAY	HOT-MIX ASPHALT SURFACE COURSE, MIX "D", N70 (IL 9.5 MM), 1 1/2 "	PG 64-22	4% @ 70 GYR
	POLYMERIZED LEVELING BINDER, (MM) IL-4.75, N50, 3/4"	SBS/SBR PG 76-28/-22	4% @ 50 GYR
PATCHES	CLASS D PATCHES, (BINDER IL-19.0 MM), 9"	PG 64-22 *	4% @ 70 GYR
	HOT-MIX ASPHALT REPLACEMENT OVER PATCHES, (BINDER IL-19.0 MM)	PG 64-22 *	4% @ 70 GYR

THE UNIT WEIGHT USED TO CALCULATE ALL HOT-MIX ASPHALT SURFACE MIXTURE QUANTITIES IS 112 LBS/SY/IN.

\* WHEN RAP EXCEEDS 20%, THE NEW ASPHALT BINDER IN THE MIX SHALL BE PG 58-22

NOTE:  
PAVEMENT PATCHING SHALL BE DONE PRIOR TO ROADWAY MILLING.  
SEE DISTRICT DETAIL BD-22.

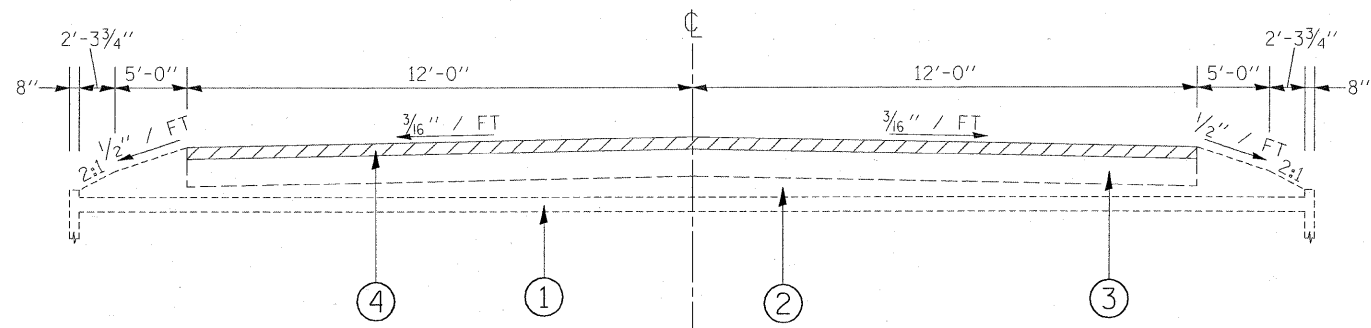

MANHATTAN-MONEE ROAD  
EXISTING TYPICAL SECTION  
S.N. 099-0194

STA. 135+71.44 TO STA. 136+08.56

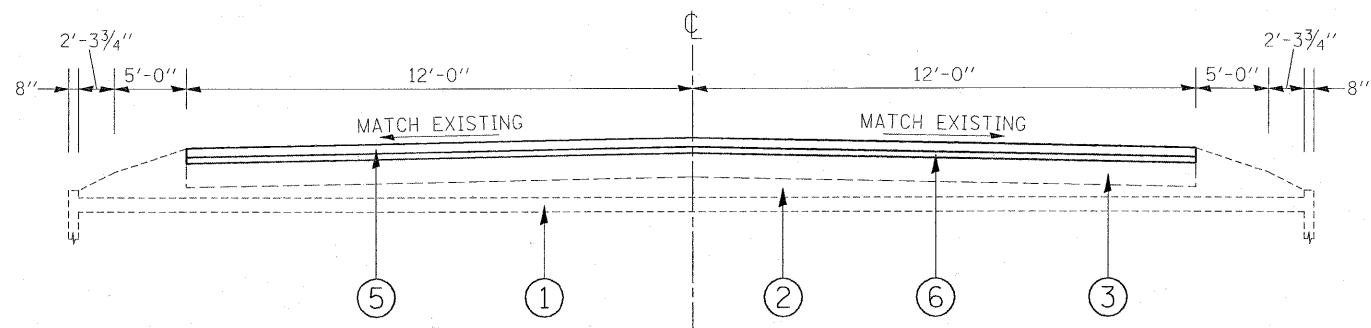

MANHATTAN-MONEE ROAD  
PROPOSED TYPICAL SECTION  
S.N. 099-0194

STA. 135+71.44 TO STA. 136+08.56

LEGEND

- ① EXISTING CONCRETE BOX CULVERT
- ② EXISTING AGGREGATE FILL, VARIOUS DEPTH
- ③ EXISTING HOT-MIX ASPHALT, 9 1/4 "
- ④ PROPOSED HOT-MIX ASPHALT SURFACE REMOVAL, 2 1/4 "
- ⑤ PROPOSED HOT-MIX ASPHALT SURFACE COURSE, MIX "D" N70, 1 1/2"
- ⑥ PROPOSED POLYMERIZED LEVELING BINDER (MACHINE METHOD), IL-4.75, N50, 3/4 "

FILE NAME =	USER NAME = smthkl	DESIGNED -	REVISED -	<b>STATE OF ILLINOIS DEPARTMENT OF TRANSPORTATION</b>	<b>MANHATTAN-MONEE ROAD TYPICAL BRIDGE CROSS-SECTIONS S.N. 099-0194</b>			F.A.P. RTE. 531	SECTION 2004-044RS	COUNTY WILL	TOTAL SHEETS 16	SHEET NO. 5
ca:\pw\work\p10dot\smthkl\j0137269\010204-sht-plan.dgn	PLOT SCALE = 50.0000 ' / IN.	DRAWN -	REVISED -		SCALE: 1"= 50'	SHEET NO.	OF	SHEETS	STA.	TO STA.	ILLINOIS FED. AID PROJECT CONTRACT NO. 62659	
	PLOT DATE = 4/14/2009	CHECKED -	REVISED -									
		DATE -	REVISED -									

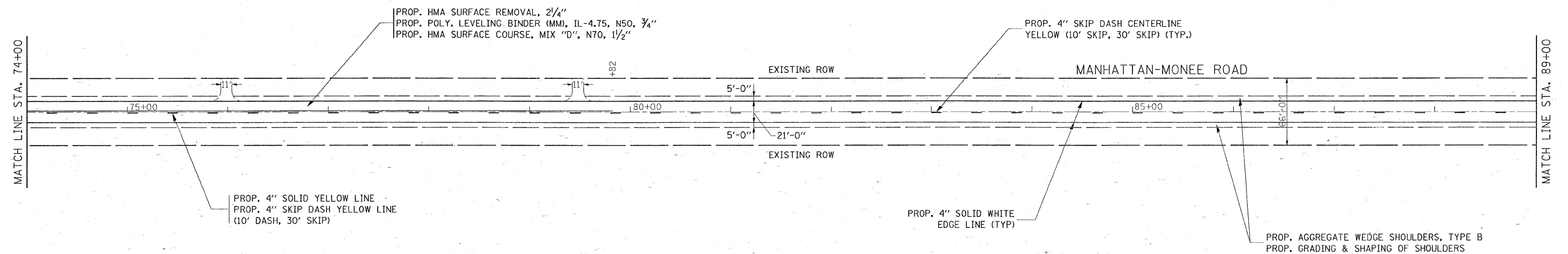
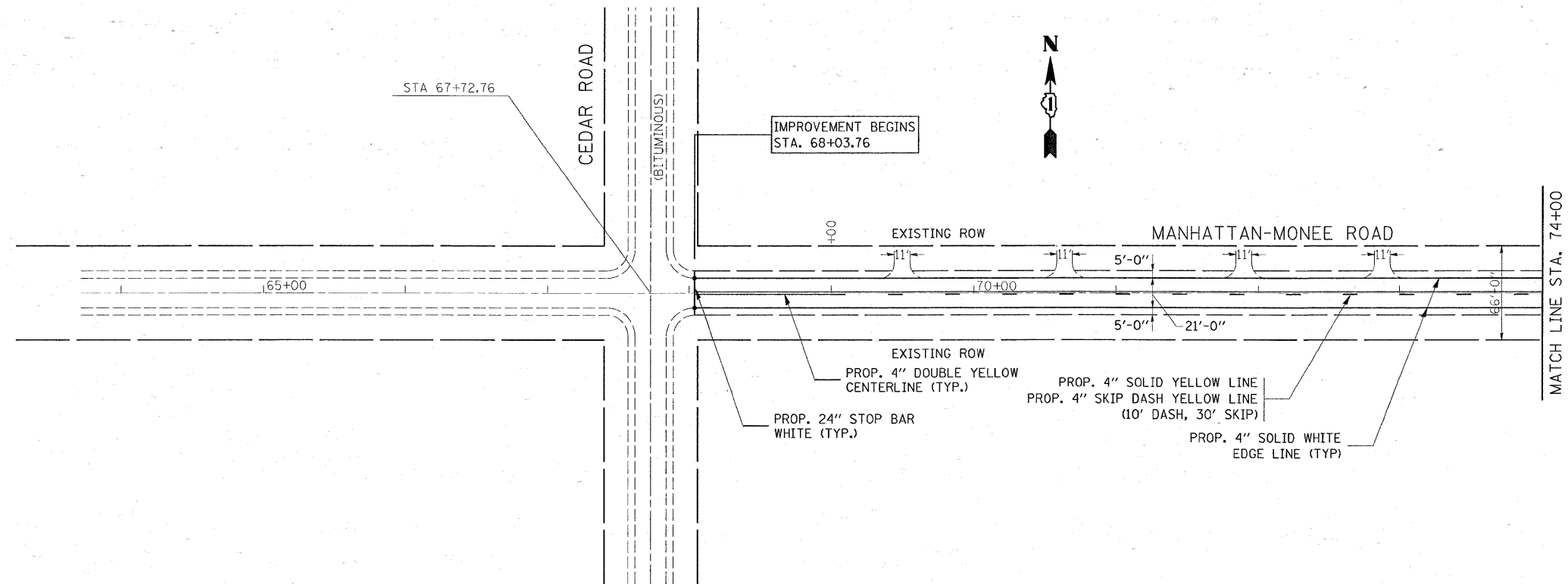

FILE NAME =	USER NAME = smthkl	DESIGNED -	REVISED -	<b>STATE OF ILLINOIS DEPARTMENT OF TRANSPORTATION</b>	<b>MANHATTAN-MONEE ROAD ROADWAY &amp; PAVEMENT MARKING PLANS</b>			F.A.P. RTE.	SECTION	COUNTY	TOTAL SHEETS	SHEET NO.			
et\pwork\PWID01\SMITH\KL\d0137269\0102004-sh1-plan.dgn		DRAWN -	REVISED -		SCALE: 1"= 50'	SHEET NO.	OF	SHEETS	STA.	TO STA.	531	2004-044RS	WILL	16	6
		PLOT SCALE = 50.0000' / IN.	CHECKED -		REVISED -										
		PLOT DATE = 4/15/2009	DATE -		REVISED -										
											CONTRACT NO. 62659			ILLINOIS FED. AID PROJECT	

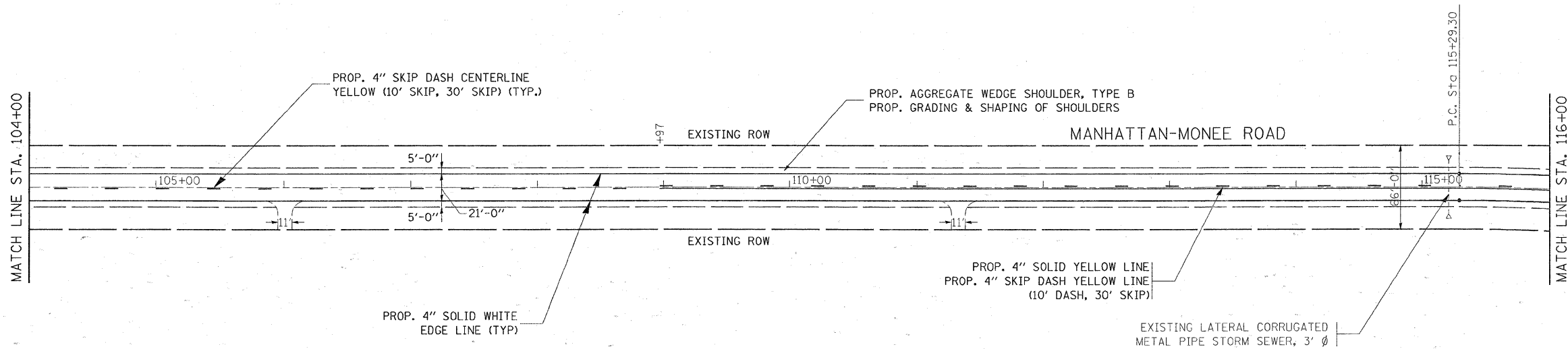
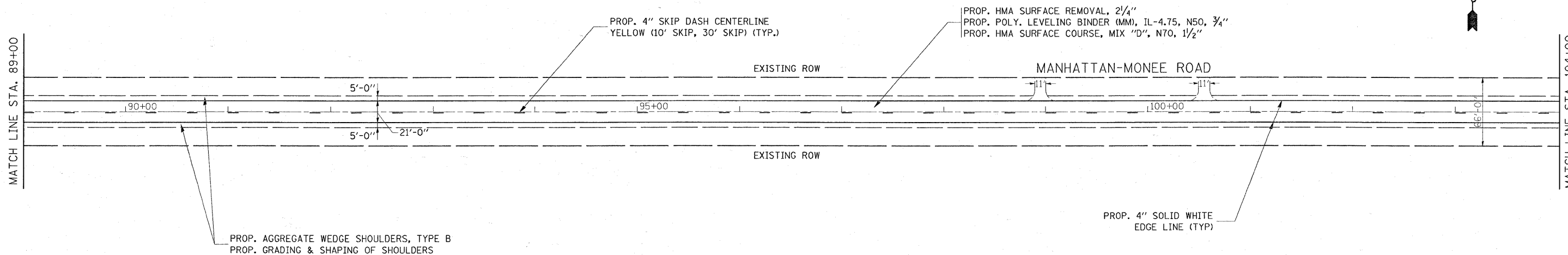

FILE NAME =	USER NAME = smthkl	DESIGNED -	REVISED -	<b>STATE OF ILLINOIS DEPARTMENT OF TRANSPORTATION</b>	<b>MANHATTAN-MONEE ROAD ROADWAY &amp; PAVEMENT MARKING PLANS</b>			F.A.P. RTE.	SECTION	COUNTY	TOTAL SHEETS	SHEET NO.
ca:\pwwork\pwwid01\SMITHKL\0137269\0102004-shit-plan.dgn		DRAWN -	REVISED -		531	2004-044RS	WILL	16	7			
	PLOT SCALE = 50,0000' / IN.	CHECKED -	REVISED -		SCALE: 1" = 50'			SHEET NO. OF SHEETS STA. TO STA.		CONTRACT NO. 62659		
	PLOT DATE = 4/15/2009	DATE -	REVISED -		ILLINOIS FED. AID PROJECT							

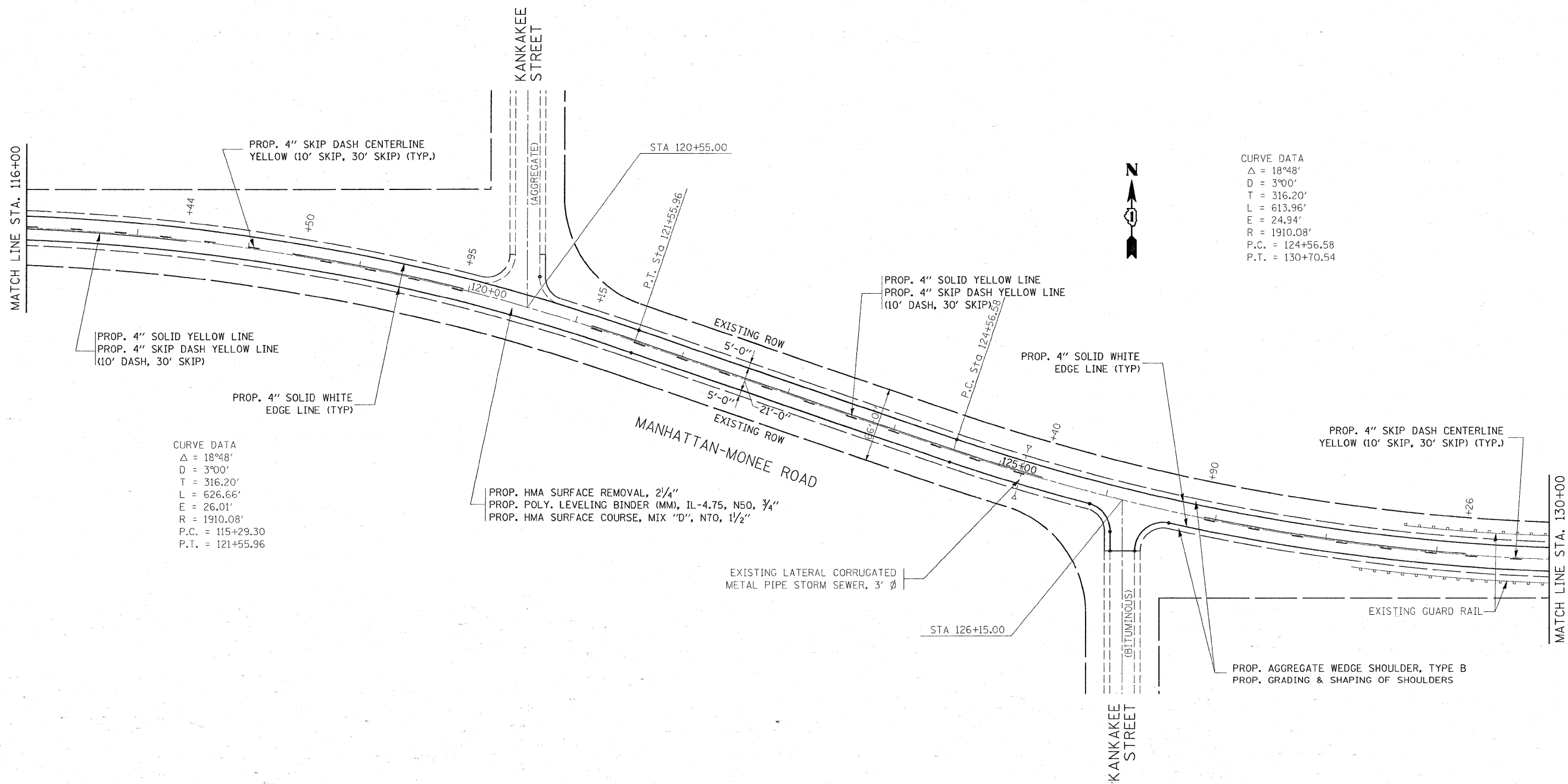

FILE NAME =	USER NAME = smthkl	DESIGNED -	REVISED -	<b>STATE OF ILLINOIS DEPARTMENT OF TRANSPORTATION</b>	<b>MANHATTAN-MONEE ROAD ROADWAY &amp; PAVEMENT MARKING PLANS</b>			F.A.P. RTE.	SECTION	COUNTY	TOTAL SHEETS	SHEET NO.
et:\pw\work\p\WID01\SMITHKL\00137269\0102	04-shr-plan.dgn	DRAWN -	REVISED -		531	2004-044RS	WILL	16	8			
	PLOT SCALE = 50.0000' / IN.	CHECKED -	REVISED -		SCALE: 1" = 50'			SHEET NO. OF SHEETS STA. TO STA.			CONTRACT NO. 62659	
	PLOT DATE = 4/15/2009	DATE -	REVISED -		ILLINOIS FED. AID PROJECT							





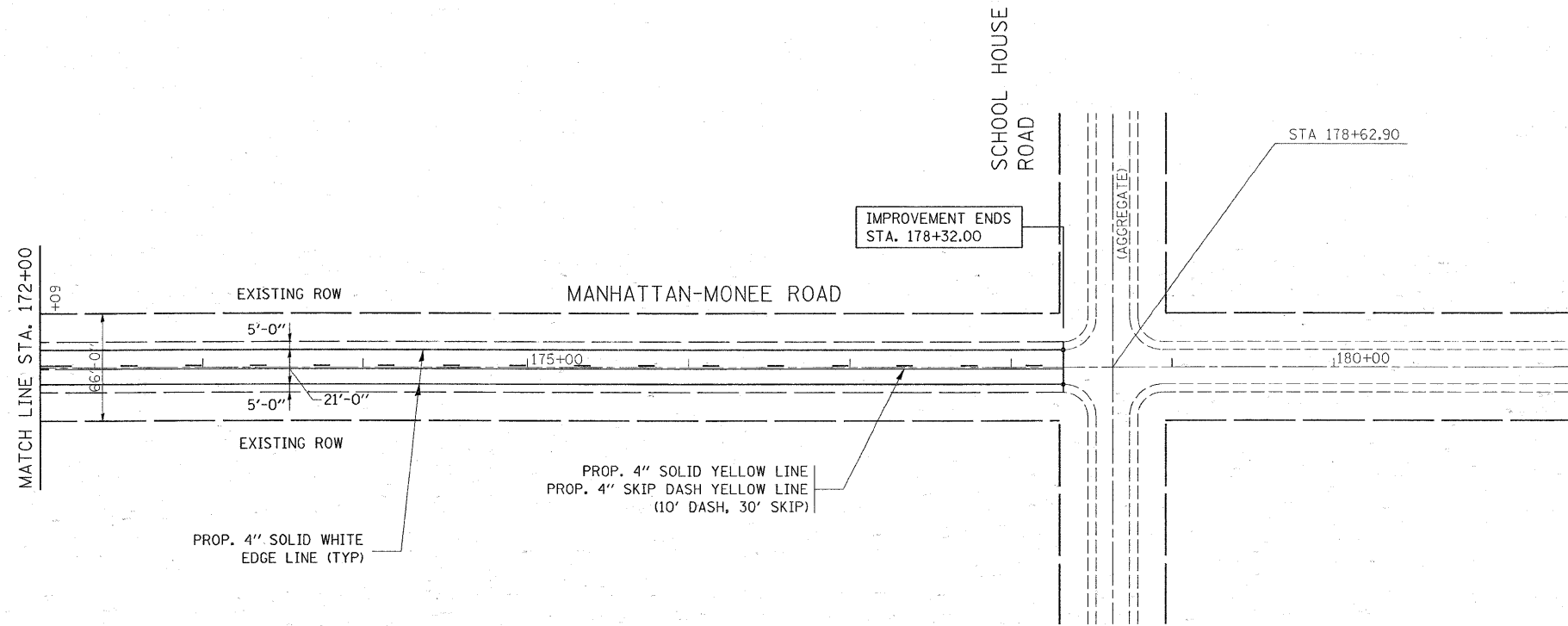
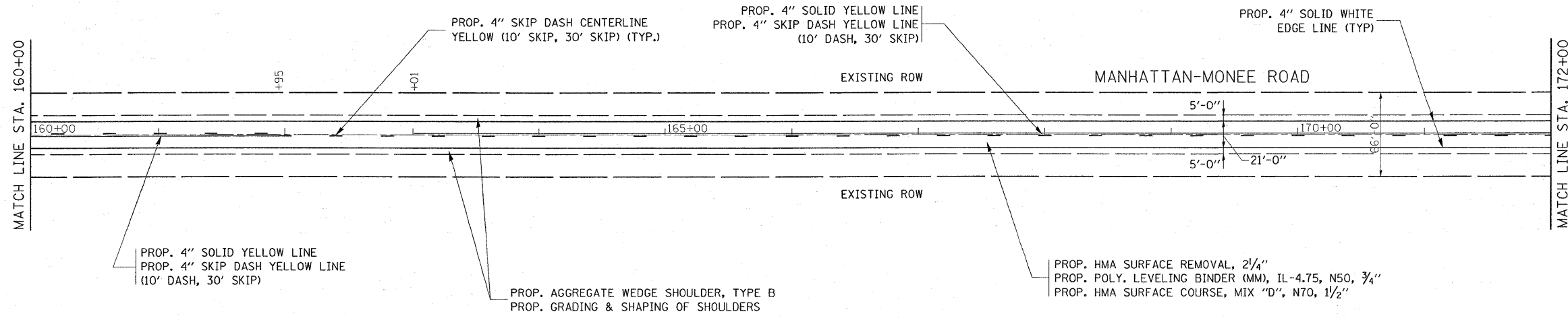

FILE NAME =  
 c:\pwork\pwork\SMITHKL\0137269\0102

USER NAME = smthkl  
 04-shr-plan.dgn  
 PLOT SCALE = 50.0000' / IN.  
 PLOT DATE = 4/15/2009

DESIGNED -  
 DRAWN -  
 CHECKED -  
 DATE -

REVISED -  
 REVISED -  
 REVISED -  
 REVISED -

**STATE OF ILLINOIS  
 DEPARTMENT OF TRANSPORTATION**

**MANHATTAN-MONEE ROAD  
 ROADWAY & PAVEMENT MARKING PLANS**

SCALE: 1" = 50' SHEET NO. OF SHEETS STA. TO STA.

F.A.P. RTE. 531	SECTION 2004-044RS	COUNTY WILL	TOTAL SHEETS 16	SHEET NO. 10
CONTRACT NO. 62659				
ILLINOIS FED. AID PROJECT				

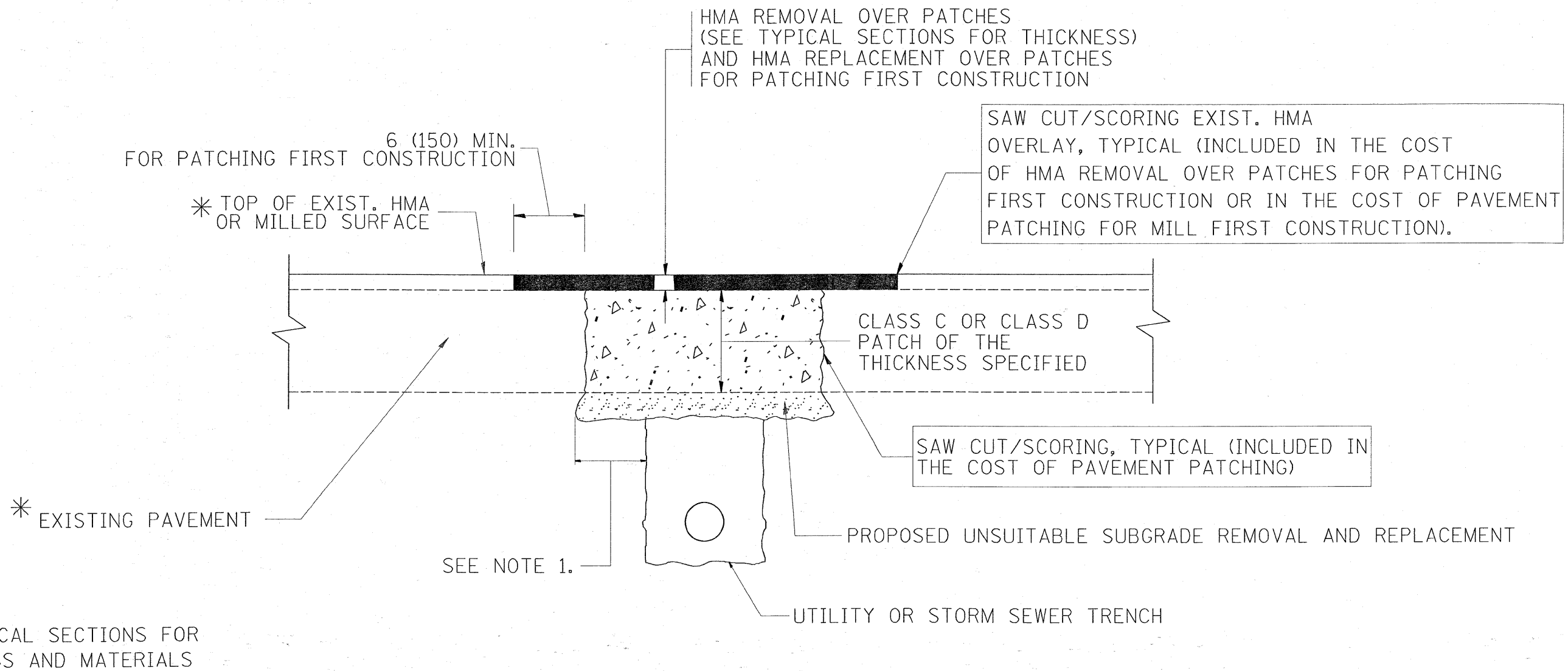

\* SEE TYPICAL SECTIONS FOR THICKNESS AND MATERIALS

**NOTES:**

1. THE WIDTH OF THE FULL DEPTH PATCH OVER A TRENCH SHALL BE 12 (300) WIDER ON EACH SIDE OF THE TRENCH.
2. FOR METHOD OF MEASUREMENT AND BASIS OF PAYMENT, SEE RECURRING SPECIAL PROVISION "PATCHING WITH HOT-MIX ASPHALT OVERLAY REMOVAL".

**SEQUENCE OF CONSTRUCTION (PATCHING FIRST)**

1. REMOVE THE EXISTING HMA MATERIAL OVER THE AREA TO BE PATCHED.
2. REMOVE AND REPLACE WITH CLASS C OR D PATCH.
3. REPLACE HMA MATERIAL OVER THE AREA TO BE PATCHED.

**SEQUENCE OF CONSTRUCTION (MILLING FIRST)**

1. MILL HMA FIRST IF THERE IS AT LEAST 4 1/2 INCHES OR MORE OF HMA MATERIAL ON TOP OF THE EXISTING PAVEMENT OR IF THE PAVEMENT IS FULL DEPTH HMA. A MINIMUM OF 2 INCHES OF HMA MATERIAL SHALL BE IN PLACE AFTER MILLING.
2. REMOVE AND REPLACE WITH FULL DEPTH CLASS D PATCHES TO TOP OF MILLED SURFACE.

ALL DIMENSIONS ARE IN INCHES (MILLIMETERS) UNLESS OTHERWISE SHOWN.

FILE NAME =	USER NAME = smsthkl	DESIGNED - R. SHAH	REVISED - A. ABBAS 04-27-98	<b>STATE OF ILLINOIS DEPARTMENT OF TRANSPORTATION</b>	<b>PAVEMENT PATCHING FOR HMA SURFACED PAVEMENT</b>	F.A.P. RTE.	SECTION	COUNTY	TOTAL SHEETS	SHEET NO.
ct\pw_work\PWIDOT\SMITHKL\0137269\Dist\dgn	DRAWN -	REVISED - R. BORO 01-01-07	531			2004-044RS	WILL	16	//	
PLOT SCALE = 50.0000' / IN.	CHECKED -	REVISED - R. BORO 09-04-07	<b>BD400-04 (BD-22)</b>			CONTRACT NO. 62659				
PLOT DATE = 4/15/2009	DATE - 10-25-94	REVISED - K. ENG 10-27-08	SCALE: NONE			SHEET NO. 1 OF 1 SHEETS	STA. TO STA.	FED. ROAD DIST. NO. 1 [ILLINOIS] FED. AID PROJECT		

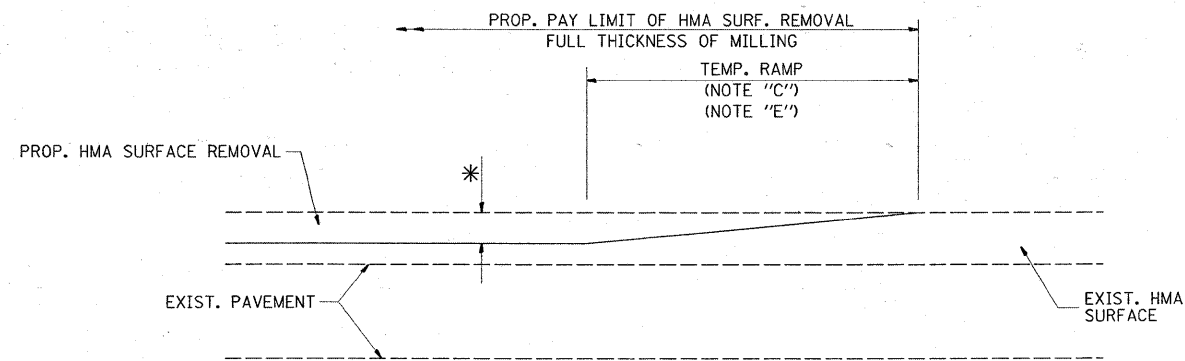

MILLED TEMPORARY RAMP  
(FOR BUTT JOINT AND HMA TAPER SEE DETAIL BELOW)

OPTION 1

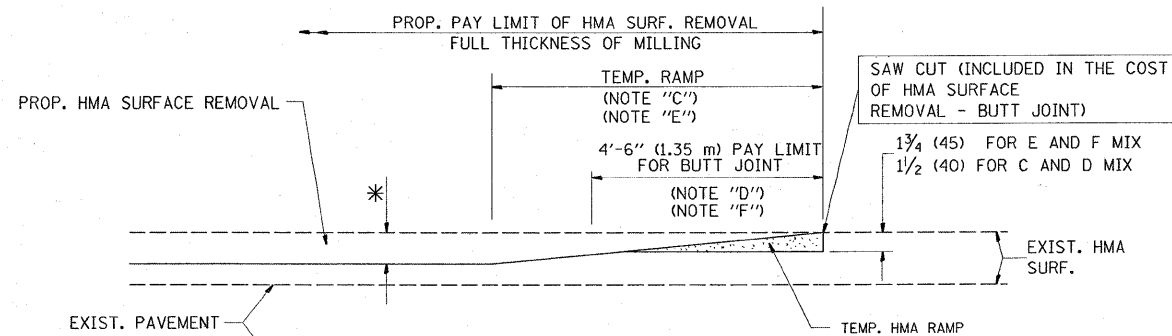

HMA CONSTRUCTED TEMPORARY RAMP  
(FOR BUTT JOINT AND HMA TAPER SEE DETAIL BELOW)

OPTION 2

TYPICAL TEMPORARY RAMP

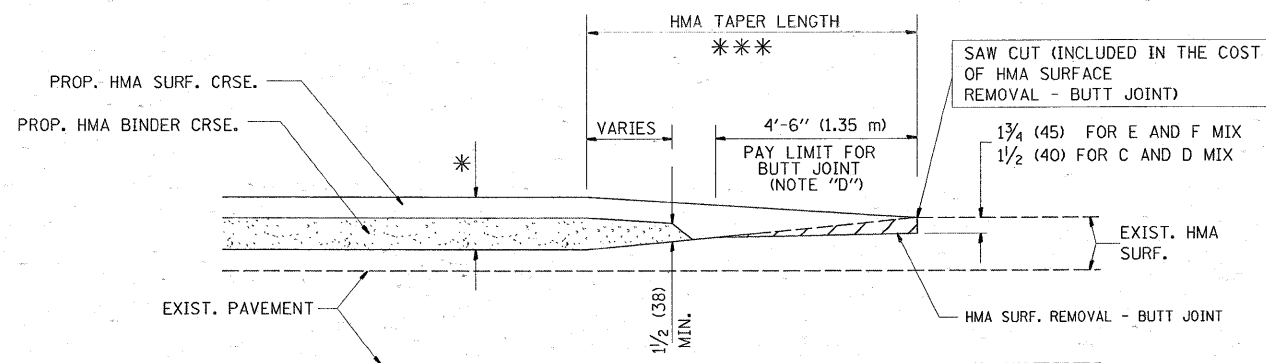

TYPICAL BUTT JOINT AND HMA TAPER  
FOR MILLING AND RESURFACING

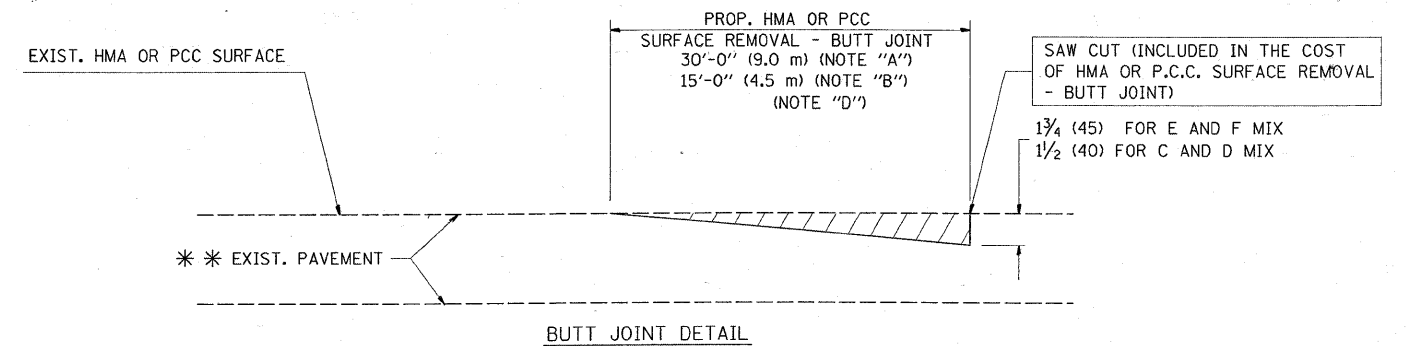

BUTT JOINT DETAIL

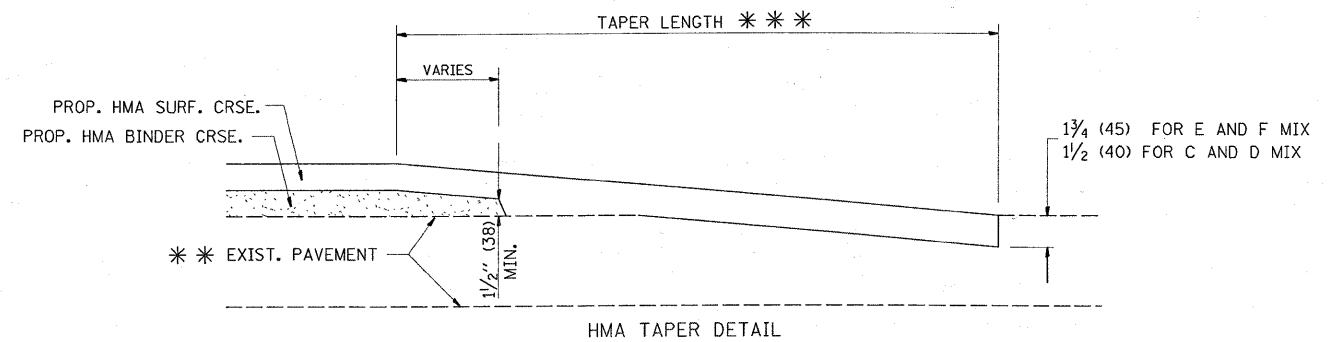

HMA TAPER DETAIL

TYPICAL BUTT JOINT AND HMA TAPER  
FOR RESURFACING ONLY

\*\*\* PC CONCRETE, HMA OR HMA RESURFACED PAVEMENT.

NOTES

- A: MAINLINE ROADWAYS AND MAJOR SIDE ROADS.
  - B: MINOR SIDE ROADS.
  - C: THE TEMP. RAMP SHALL BE CONSTRUCTED IMMEDIATELY UPON REMOVAL OF THE EXISTING HMA SURFACE.
  - D: THE BUTT JOINT SHALL BE CONSTRUCTED IMMEDIATELY PRIOR TO PLACING THE PROPOSED HMA COURSES.
  - E: TAPER THE TEMP. RAMP AT A RATE OF 3'-0" (900 mm) PER 1 INCH (25 mm) OF MILLING THICKNESS.
  - F: INSTALLATION AND REMOVAL OF THE 4'-6" (1.35 m) TEMP. RAMP IS INCLUDED IN COST OF HMA SURFACE REMOVAL - BUTT JOINT
  - G: SEE ARTICLE 406.08 AND 406.14 OF THE STANDARD SPECIFICATIONS FOR "HMA AND/OR PCC SURFACE REMOVAL, BUTT JOINT".
- \* SEE TYPICAL SECTIONS FOR MILLING THICKNESS.
- \*\*\* 20'-0" (6.1 m) PER 1 (25) RESURFACING (NOTE "A")  
10'-0" (3.0 m) PER 1 (25) RESURFACING (NOTE "B")

BASIS OF PAYMENT:

THE BUTT JOINT WILL BE PAID FOR AT THE CONTRACT UNIT PRICE PER SQUARE YARD (SQUARE METER) FOR "HOT-MIX ASPHALT SURFACE REMOVAL - BUTT JOINT" OR FOR "PORTLAND CEMENT CONCRETE SURFACE REMOVAL - BUTT JOINT".

ALL DIMENSIONS ARE IN INCHES (MILLIMETERS) UNLESS OTHERWISE SHOWN.

FILE NAME =	USER NAME = sm1thkl	DESIGNED - M. DE YONG	REVISED - R. SHAH 10-25-94
oz:\pwork\PW100T\SMITHKL\d0137269\Dist\td.dgn		DRAWN -	REVISED - A. ABBAS 03-21-97
	PLOT SCALE = 50,0000 1/ IN.	CHECKED -	REVISED - M. GOMEZ 04-06-01
	PLOT DATE = 4/15/2009	DATE - 06-13-90	REVISED - R. BORO 01-01-07

STATE OF ILLINOIS  
DEPARTMENT OF TRANSPORTATION

BUTT JOINT AND  
HMA TAPER DETAILS

SCALE: NONE SHEET NO. 1 OF 1 SHEETS STA. TO STA.

F.A.P. RTE.	SECTION	COUNTY	TOTAL SHEETS	SHEET NO.
531	2004-044RS	WILL	16	12
BD400-05 BD32		CONTRACT NO. 62659		
FED. ROAD DIST. NO. 1 ILLINOIS FED. AID PROJECT				

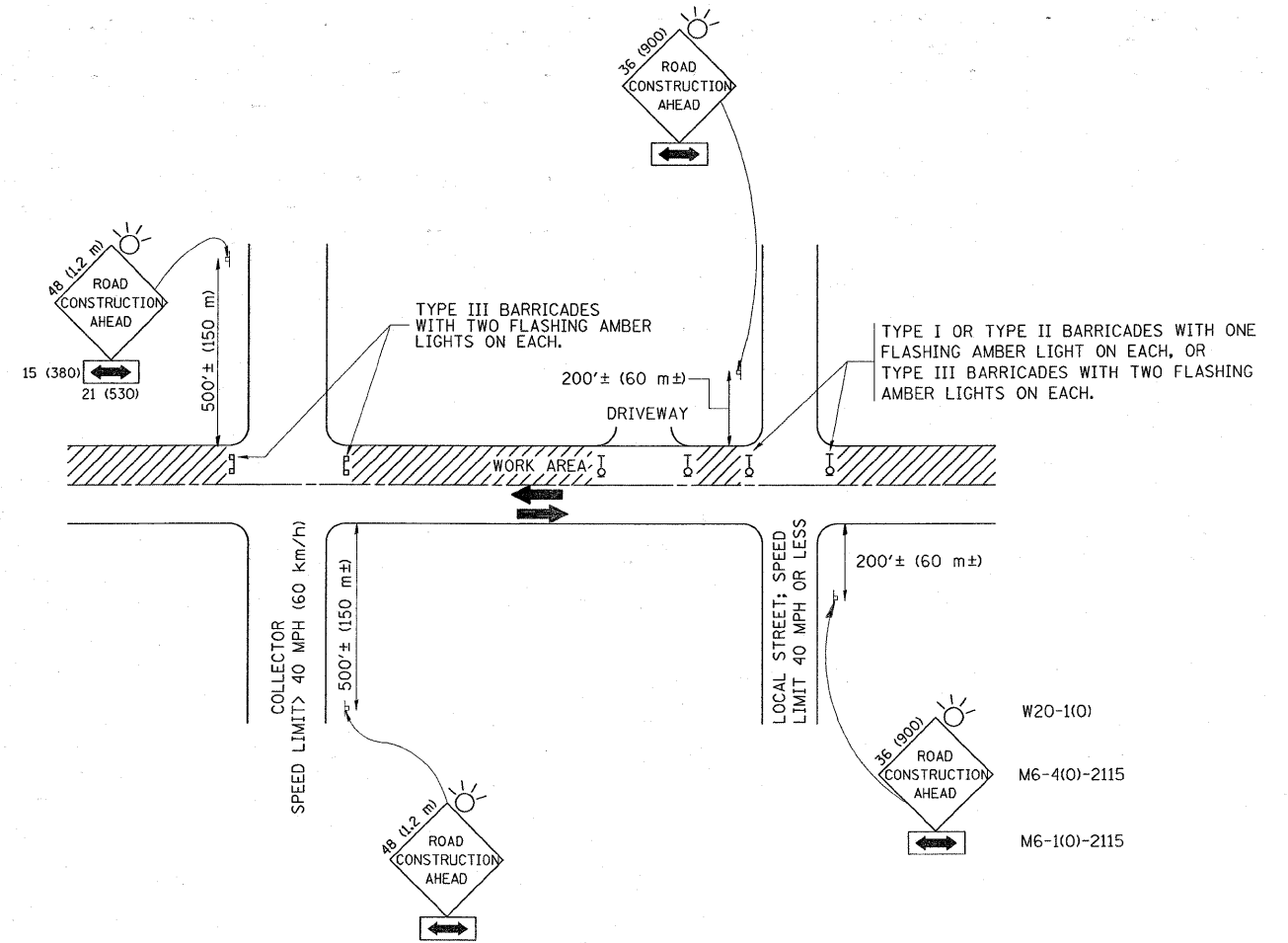

### TRAFFIC CONTROL AND PROTECTION FOR SIDE ROADS, INTERSECTIONS, AND DRIVEWAYS

#### NOTES:

- A. FOR NO LANE RESTRICTION ON THE SIDE ROAD OR DRIVEWAYS
- SIDE ROAD WITH A SPEED LIMIT OF 40 MPH (60 km/h) OR LESS AS SHOWN ON THE DRAWING AND AS DIRECTED BY THE ENGINEER:
    - ONE **ROAD CONSTRUCTION AHEAD** SIGN 36 x 36 (900x900) WITH A FLASHER AND FLAG MOUNTED ON IT APPROXIMATELY 200' (60 m) IN ADVANCE OF THE MAIN ROUTE.
    - THE CLOSED PORTION OF THE MAIN ROUTE SHALL BE PROTECTED BY BLOCKING WITH TYPE I, TYPE II OR TYPE III BARRICADES, 1/3 OF THE CROSS SECTION OF THE CLOSED PORTION.
  - SIDE ROAD WITH A SPEED LIMIT GREATER THAN 40 MPH (60 km/h) AS SHOWN ON THE DRAWING AND AS DIRECTED BY THE ENGINEER:
    - ONE **ROAD CONSTRUCTION AHEAD** SIGN 48 x 48 (1.2 m x 1.2 m) WITH A FLASHER MOUNTED ON IT APPROXIMATELY 500' (150 m) IN ADVANCE OF THE MAIN ROUTE.
    - THE CLOSED PORTION OF THE MAIN ROUTE SHALL BE PROTECTED BY BLOCKING WITH TYPE III BARRICADES, 1/2 OF THE CROSS SECTION OF THE CLOSED PORTION.
3. WHEN THE SIDE ROAD LIES BETWEEN THE BEGINNING OF THE MAINLINE SIGNING AND THE WORK ZONE, A SINGLE HEADED ARROW (M6-1) SHALL BE USED IN LIEU OF THE DOUBLE HEADED ARROW (M6-4).
- B. FOR A LANE CLOSURE ON A SIDE ROAD OR DRIVEWAY:
- USE APPLICABLE PORTIONS OF THE TYPICAL APPLICATION OF TRAFFIC CONTROL DEVICES (STD. 701501, STD. 701606 OR THE APPROPRIATE STANDARD). THE SPACING OF SIGNS AND BARRICADES SHALL BE ADJUSTED FOR FIELD CONDITIONS AS DIRECTED BY THE ENGINEER. THE DIRECTIONAL ARROW SHALL BE COVERED OR REMOVED WHEN NO LONGER CONSISTENT WITH THE SIDE ROAD LANE CLOSURE.
- C. ADVANCE WARNING SIGNS ARE TO BE OMITTED ON DRIVEWAY UNLESS OTHERWISE NOTED.
- D. THE TRAFFIC CONTROL AND PROTECTION FOR SIDE ROADS, INTERSECTIONS, AND DRIVEWAYS SHALL BE INCIDENTAL TO THE COST OF SPECIFIED TRAFFIC CONTROL STANDARDS OR ITEMS.

All dimensions are in millimeters (inches) unless otherwise shown.

FILE NAME =	USER NAME = smthkl	DESIGNED - LHA	REVISED - J. OBERLE 10-18-95
ca:\pwork\pwork\pwork\smthkl\d0137269\d137269.td.dgn		DRAWN -	REVISED - A. HOUSEH 03-06-96
	PLOT SCALE = 50.0000' / IN.	CHECKED -	REVISED - A. HOUSEH 10-15-96
	PLOT DATE = 4/15/2009	DATE - 06-89	REVISED - T. RAMMACHER 01-06-00

STATE OF ILLINOIS  
DEPARTMENT OF TRANSPORTATION

TRAFFIC CONTROL AND PROTECTION FOR  
SIDE ROADS, INTERSECTIONS, AND DRIVEWAYS

SCALE: NONE SHEET NO. 1 OF 1 SHEETS STA. TO STA.

F.A.P. RTE.	SECTION	COUNTY	TOTAL SHEETS	SHEET NO.
531	2004-044RS	WILL	16	13
TC-10			CONTRACT NO. 62659	
FED. ROAD DIST. NO. 1 ILLINOIS FED. AID PROJECT				

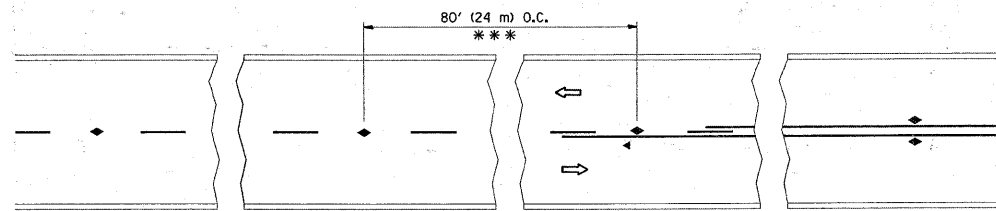

\*\*\* REDUCE TO 40' (12 m) O.C. ON CURVES WITH POSTED OR ADVISORY SPEED 45 M.P.H. (70 km/h) OR LESS.

TWO-LANE/TWO-WAY

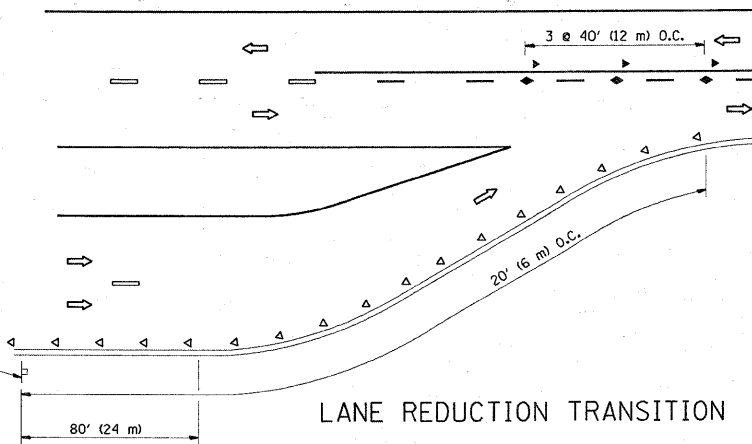

LANE REDUCTION TRANSITION

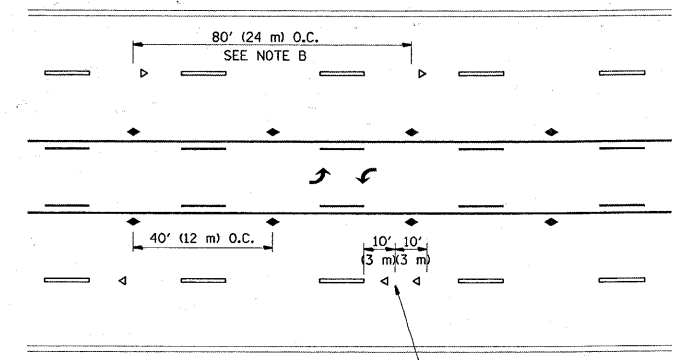

TWO-WAY LEFT TURN

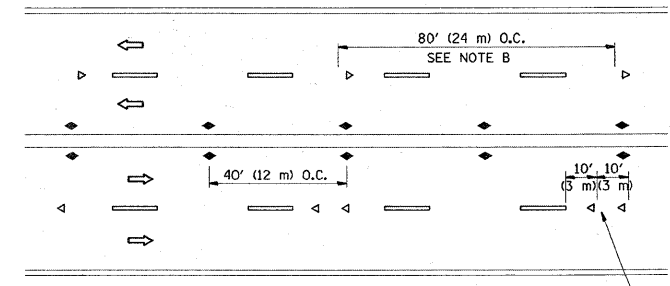

MULTI-LANE/UNDIVIDED

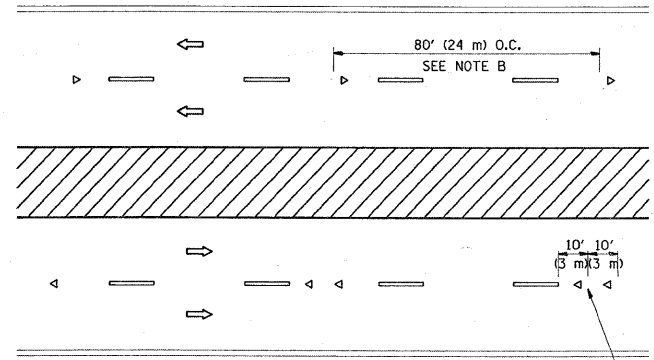

MULTI-LANE/DIVIDED

GENERAL NOTES

1. MARKERS USED WITH DASHED LINES SHALL BE CENTERED IN THE GAP BETWEEN SEGMENTS.
2. MARKERS USED ADJACENT TO SOLID LINES SHALL BE OFFSET 2 TO 3 (50 TO 75) TOWARD TRAFFIC AS SHOWN.
3. MARKERS THROUGH TANGENTS LESS THAN 500' (150 m) IN LENGTH BETWEEN CURVES SHALL BE INSTALLED AT THE LESSER OF THE TWO CURVE SPACINGS.

SYMBOLS

- YELLOW STRIPE
- WHITE STRIPE
- ◀ ONE-WAY AMBER MARKER
- ◀ ONE-WAY CRYSTAL MARKER (W/O)
- ◆ TWO-WAY AMBER MARKER

LANE MARKER NOTES

- B. REDUCE TO 40' (12 m) O.C. ON CURVES WHERE ADVISORY SPEEDS ARE 10 M.P.H. (20 km/h) LOWER THAN POSTED SPEEDS.
- A. USE DOUBLE LANE LINE MARKERS SPACED AS SHOWN.

DESIGN NOTES

1. DOUBLE LANE LINE MARKERS SHALL BE USED UNLESS SPECIFIED OTHERWISE.
2. EXCEPT AS SHOWN ON THE LANE REDUCTION TRANSITION AND FREEWAY EXIT RAMP DETAIL, MARKERS ARE NOT TO BE SPECIFIED ON RIGHT EDGE LINES.
3. THE EXACT MARKER LIMITS, SPACING, AND COLOR SHOULD BE INCLUDED IN THE PLANS.
4. MARKERS SHOULD NOT BE USED ALONGSIDE CURBS EXCEPT FOR EXTREMELY SHORT SECTIONS OF CURBS WHERE NOT MORE THAN TWO MARKERS WOULD BE INVOLVED.

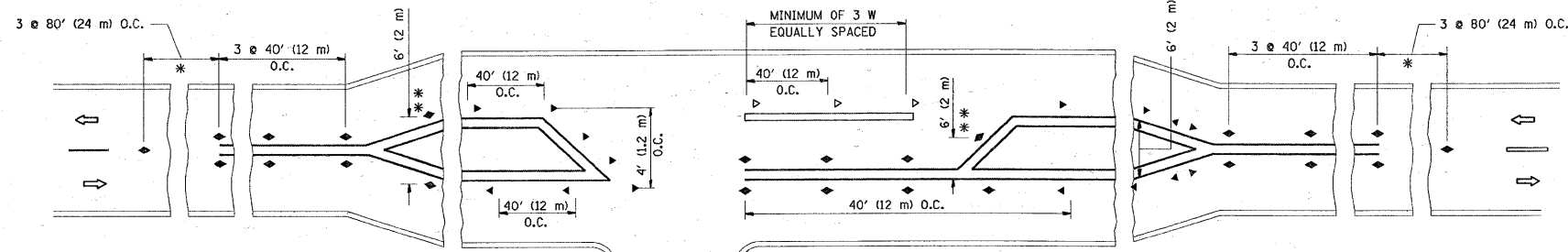

LEFT TURN

\* SEE TWO-LANE/TWO-WAY WHERE MARKERS CONTINUE  
 \*\* WHERE THE MEDIAN WIDTH IS 6' (2 m) OR LESS USE TWO-WAY MARKERS.

All dimensions are in inches (millimeters) unless otherwise shown.

FILE NAME =	USER NAME = smithkl	DESIGNED -	REVISED - T. RAMMACHER 09-19-94	<b>STATE OF ILLINOIS DEPARTMENT OF TRANSPORTATION</b>	<b>TYPICAL APPLICATIONS RAISED REFLECTIVE PAVEMENT MARKERS (SNOW-PLOW RESISTANT)</b>			F.A.P. RTE.	SECTION	COUNTY	TOTAL SHEETS	SHEET NO.
os:\p\work\p\w\DOT\SMITHKL\d0137269\dist\td.dgn		DRAWN -	REVISED - T. RAMMACHER 03-12-99					531	2004-044RS	WILL	16	17
	PLOT SCALE = 50.0000" / IN.	CHECKED -	REVISED - T. RAMMACHER 01-06-00		<b>TC-11</b>			CONTRACT NO. 62659				
	PLOT DATE = 4/15/2009	DATE -	REVISED -		SCALE: NONE	SHEET NO. 1	OF 1	SHEETS	STA.	TO STA.	FED. ROAD DIST. NO. 1   ILLINOIS   FED. AID PROJECT	

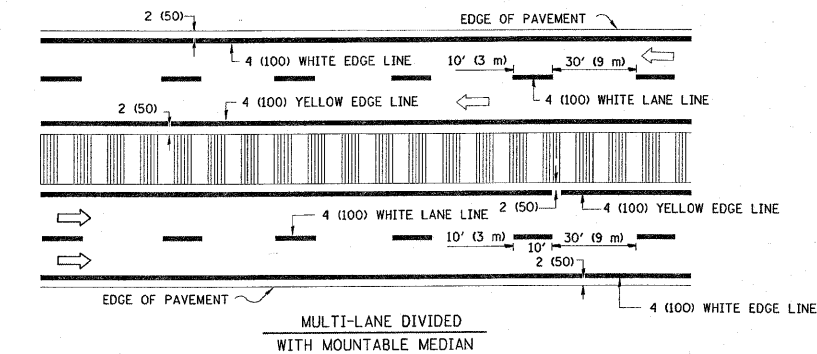
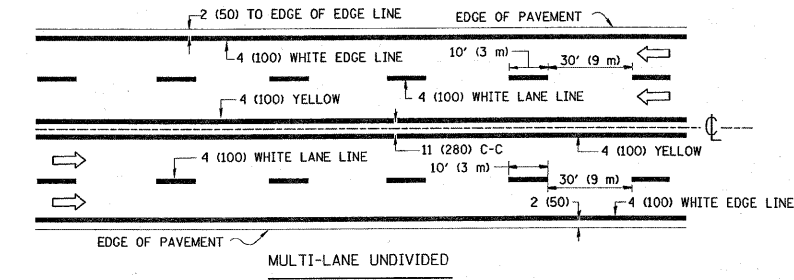
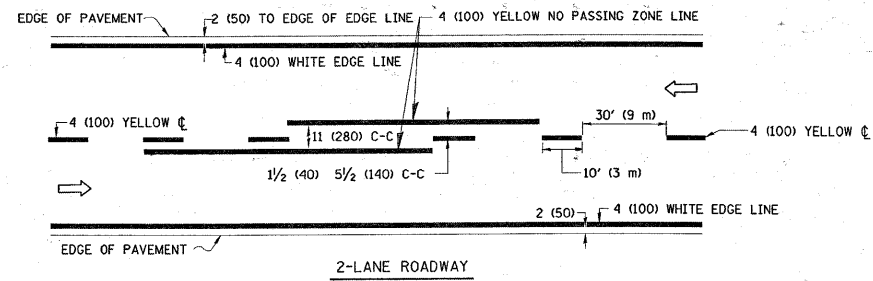

NOTE: MEDIANS WITH BARRIER CURB DO NOT REQUIRE AN EDGE LINE

**TYPICAL LANE AND EDGE LINE MARKING**

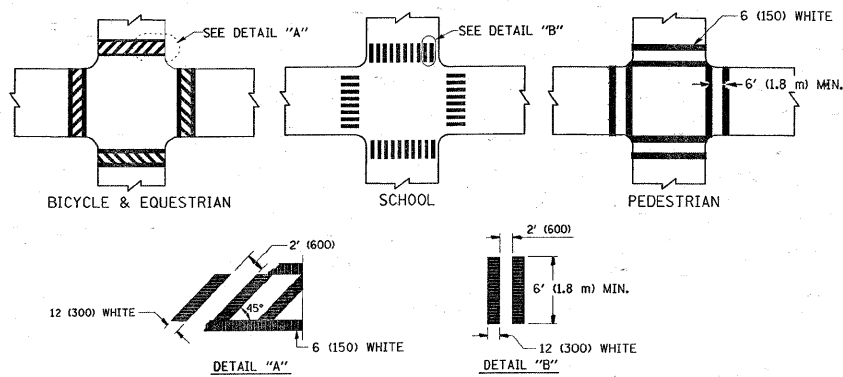

**TYPICAL CROSSWALK MARKING**

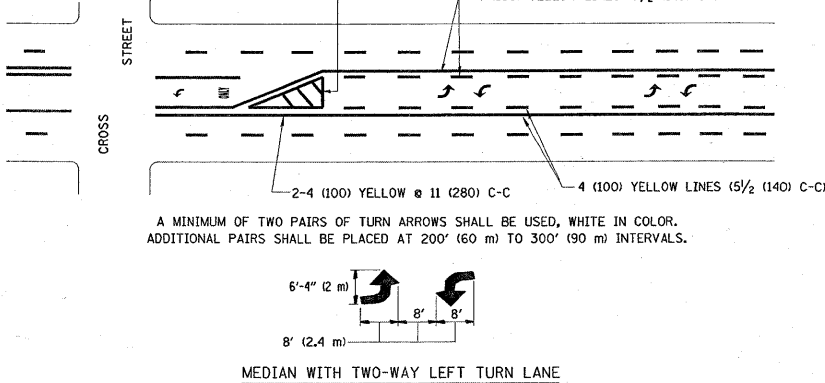
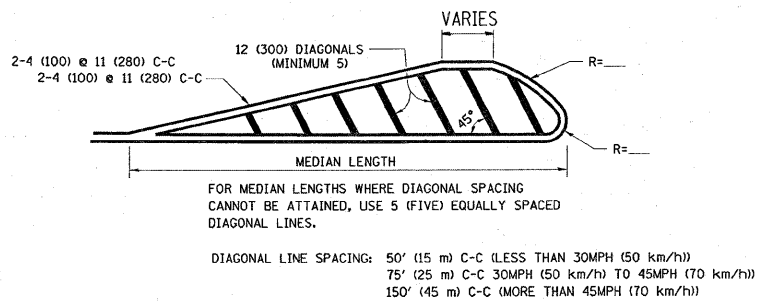
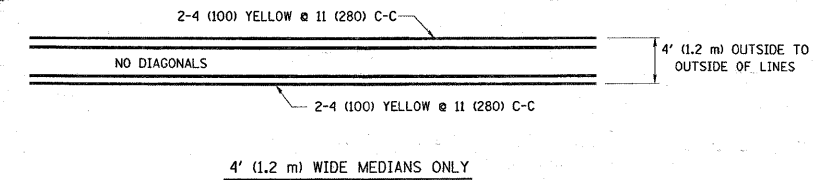

**TYPICAL PAINTED MEDIAN MARKING**

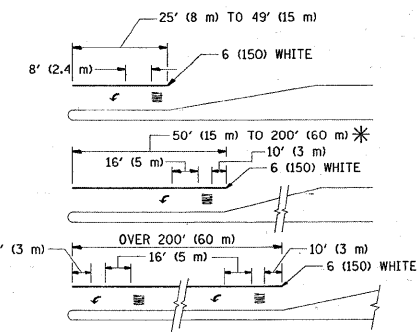

FULL SIZE LETTERS 8' (2.4 m) AND ARROWS SHALL BE USED.  
 AREA = 15.6 SQ. FT. (1.5 m<sup>2</sup>) ONLY AREA = 20.8 SQ. FT. (1.9 m<sup>2</sup>)  
 \* TURN LANES IN EXCESS OF 400' (120 m) IN LENGTH MAY HAVE AN ADDITIONAL SET OF ARROW - "ONLY" INSTALLED MIDWAY BETWEEN THE OTHER TWO SETS OF ARROW - "ONLY".

**TYPICAL LEFT (OR RIGHT) TURN LANE**

**TYPICAL TURN LANE MARKING**

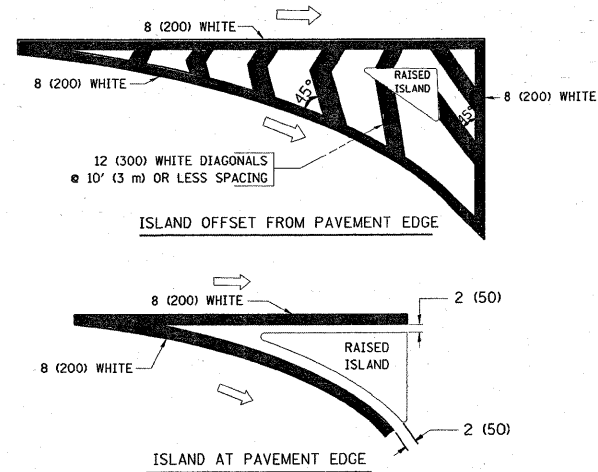

**TYPICAL ISLAND MARKING**

TYPE OF MARKING	WIDTH OF LINE	PATTERN	COLOR	SPACING / REMARKS
CENTERLINE ON 2 LANE PAVEMENT	4 (100)	SKIP-DASH	YELLOW	10' (3 m) LINE WITH 30' (9 m) SPACE
CENTERLINE ON MULTI-LANE UNDIVIDED PAVEMENT	2 @ 4 (100)	SOLID	YELLOW	11 (280) C-C
NO PASSING ZONE LINES: FOR ONE DIRECTION FOR BOTH DIRECTIONS	4 (100) 2 @ 4 (100)	SOLID SOLID	YELLOW YELLOW	5 1/2 (140) C-C FROM SKIP-DASH CENTERLINE 11 (280) C-C OMIT SKIP-DASH CENTERLINE BETWEEN
LANE LINES	4 (100) 5 (125) ON FREEWAYS	SKIP-DASH SKIP-DASH	WHITE WHITE	10' (3 m) LINE WITH 30' (9 m) SPACE
DOTTED LINES (EXTENSIONS OF CENTER, LANE OR TURN LANE MARKINGS)	SAME AS LINE BEING EXTENDED	SKIP-DASH	SAME AS LINE BEING EXTENDED	2' (600) LINE WITH 6' (1.8 m) SPACE
EDGE LINES	4 (100)	SOLID	YELLOW-LEFT WHITE-RIGHT	OUTLINE MOUNTABLE MEDIANS IN YELLOW; EDGE LINES ARE NOT USED NEXT TO BARRIER CURB
TURN LANE MARKINGS	6 (150) LINE; FULL SIZE LETTERS & SYMBOLS (8' (2.4m))	SOLID	WHITE	SEE TYPICAL TURN LANE MARKING DETAIL
TWO WAY LEFT TURN MARKING	2 @ 4 (100) EACH DIRECTION 8' (2.4m) LEFT ARROW	SKIP-DASH AND SOLID IN PAIRS	YELLOW WHITE	10' (3 m) LINE WITH 30' (9 m) SPACE FOR SKIP-DASH; 5 1/2 (140) C-C BETWEEN SOLID LINE AND SKIP-DASH LINE SEE TYPICAL TWO-WAY LEFT TURN MARKING DETAIL
CROSSWALK LINES (PEDESTRIAN) A. DIAGONALS (BIKE & EQUESTRIAN) B. LONGITUDINAL BARS (SCHOOL)	2 @ 6 (150) 12 (300) @ 45° 12 (300) @ 90°	SOLID SOLID SOLID	WHITE WHITE WHITE	NOT LESS THAN 6' (1.8 m) APART 2' (600) APART 2' (600) APART SEE TYPICAL CROSSWALK MARKING DETAILS.
STOP LINES	24 (600)	SOLID	WHITE	PLACE 4' (1.2 m) IN ADVANCE OF AND PARALLEL TO CROSSWALK, IF PRESENT. OTHERWISE, PLACE AT DESIRED STOPPING POINT. PARALLEL TO CROSSROAD CENTERLINE, WHERE POSSIBLE
PAINTED MEDIANS	2 @ 4 (100) WITH 12 (300) DIAGONALS @ 45° NO DIAGONALS USED FOR 4' (1.2 m) WIDE MEDIANS	SOLID	YELLOW: TWO WAY TRAFFIC WHITE: ONE WAY TRAFFIC	11 (280) C-C FOR THE DOUBLE LINE SEE TYPICAL PAINTED MEDIAN MARKING.
CORE MARKING AND CHANNELIZING LINES	8 (200) WITH 12 (300) DIAGONALS @ 45°	SOLID	WHITE	DIAGONALS: 15' (4.5 m) C-C (LESS THAN 30MPH (50 km/h)) 20' (6 m) C-C 30MPH (50 km/h) TO 45MPH (70 km/h) 30' (9 m) C-C (OVER 45MPH (70 km/h))
RAILROAD CROSSING	24 (600) TRANSVERSE LINES; "RR" IS 6' (1.8 m) LETTERS; 16 (400) LINE FOR "X"	SOLID	WHITE	SEE STATE STANDARD 780001 AREA OF: "R"=3.6 SQ. FT. (0.33 m <sup>2</sup> ) EACH "X"=54.0 SQ. FT. (5.0 m <sup>2</sup> )
SHOULDER DIAGONALS	12 (300) @ 45°	SOLID	WHITE - RIGHT YELLOW - LEFT	50' (15 m) C-C (LESS THAN 30MPH (50 km/h)) 75' (25 m) C-C 30 MPH (50 km/h) TO 45MPH (70 km/h) 150' (45 m) C-C (OVER 45MPH (70 km/h))

FOR FURTHER DETAILS ON PAVEMENT MARKING REFER TO STANDARD SPECIFICATIONS FOR ROAD AND BRIDGE CONSTRUCTION AND STATE STANDARD 780001.

All dimensions are in inches (millimeters) unless otherwise shown.

FILE NAME =	USER NAME = smthkl	DESIGNED - EVERS	REVISED - T. RAMMACHER 10-27-94
ct:\pwork\p\1007\SMTHKL\0137269\Dist\td.dgn		DRAWN -	REVISED - A. HOUSEH 10-09-96
	PLOT SCALE = 50.0000 "/ IN.	CHECKED -	REVISED - A. HOUSEH 10-17-96
	PLOT DATE = 4/15/2009	DATE - 03-19-90	REVISED - T. RAMMACHER 01-06-00

**STATE OF ILLINOIS  
DEPARTMENT OF TRANSPORTATION**

DISTRICT ONE		F.A.P. RTE.	SECTION	COUNTY	TOTAL SHEETS	SHEET NO.
TYPICAL PAVEMENT MARKINGS		531	2004-044RS	WILL	16	15
SCALE: NONE		SHEET NO. 1 OF 1 SHEETS		STA. TO STA.	CONTRACT NO. 62659	
FED. ROAD DIST. NO. 1 ILLINOIS FED. AID PROJECT						

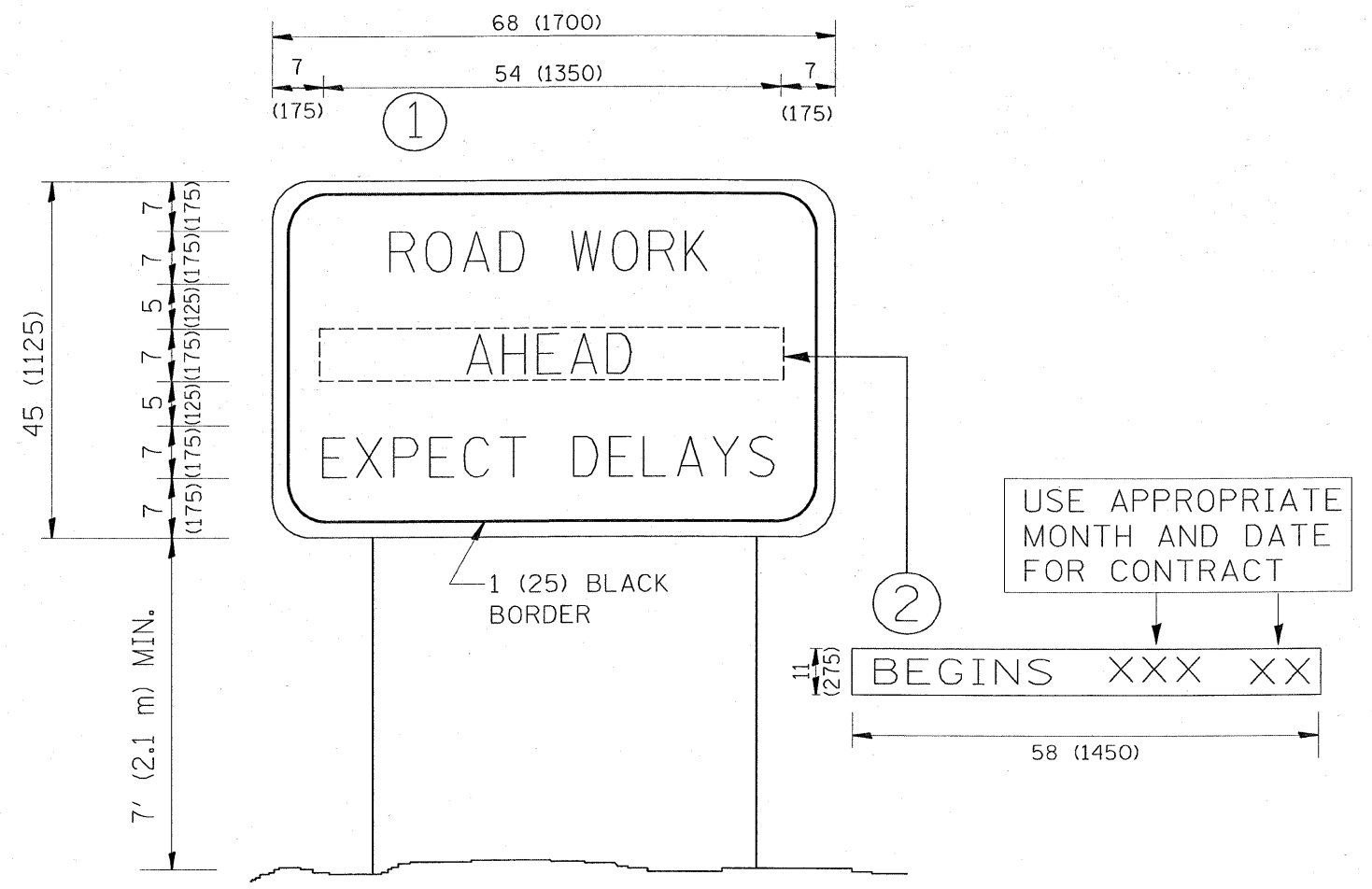

**NOTES:**

1. USE BLACK LETTERING ON ORANGE BACKGROUND.
2. ERECT SIGNS IN ADVANCE OF THE LOCATION FOR THE "ROAD CONSTRUCTION AHEAD" SIGN AT LOCATIONS AS DIRECTED BY THE ENGINEER.
3. ERECT SIGN ① WITH INSTALLED PANEL ② ONE WEEK PRIOR TO THE START OF CONSTRUCTION.
4. REMOVE PANEL ② SOON AFTER THE START OF CONSTRUCTION.
5. SEE SPECIAL PROVISION FOR "TEMPORARY INFORMATION SIGNING" FOR ADDITIONAL INFORMATION.
6. ONE SIGN ASSEMBLY EQUALS 25.70 SQ. FT. (2.3 SQ. M.)
7. SHALL BE PAID FOR AS TEMPORARY INFORMATION SIGNING.

ALL DIMENSIONS ARE IN INCHES (MILLIMETERS) UNLESS OTHERWISE SHOWN.

FILE NAME =	USER NAME = smithkl	DESIGNED -	REVISED - R. MIRS 09-15-97	<b>STATE OF ILLINOIS DEPARTMENT OF TRANSPORTATION</b>	<b>ARTERIAL ROAD INFORMATION SIGN</b>	F.A.P. RTE.	SECTION	COUNTY	TOTAL SHEETS	SHEET NO.	
c:\pwwork\VPWIDOT\SMITHKL\d0137269\dot	td.dgn	DRAWN -	REVISED - R. MIRS 12-11-97			531	2004-044RS	WILL	16	16	
	PLOT SCALE = 50,0000 / IN.	CHECKED -	REVISED - T. RAMMACHER 02-02-99			<b>TC-22</b>		CONTRACT NO. 62659			
	PLOT DATE = 4/15/2009	DATE -	REVISED - C. JUCIUS 01-31-07			SCALE: NONE	SHEET NO. 1 OF 1 SHEETS	STA.	TO STA.	FED. ROAD DIST. NO. 1 ILLINOIS FED. AID PROJECT	