

Bench Mark No. 468. Top of "0" in open fire hydrant NE corner Hunter St. & Jasper St. El. 599.66
No Existing Structure.

STATE OF ILLINOIS
DEPARTMENT OF PUBLIC WORKS & BUILDINGS
DIVISION OF HIGHWAYS

DATE	BY	CHKD	APP'D	SHEET NO.
10/24/61	WILL	197	125	10 SHEETS

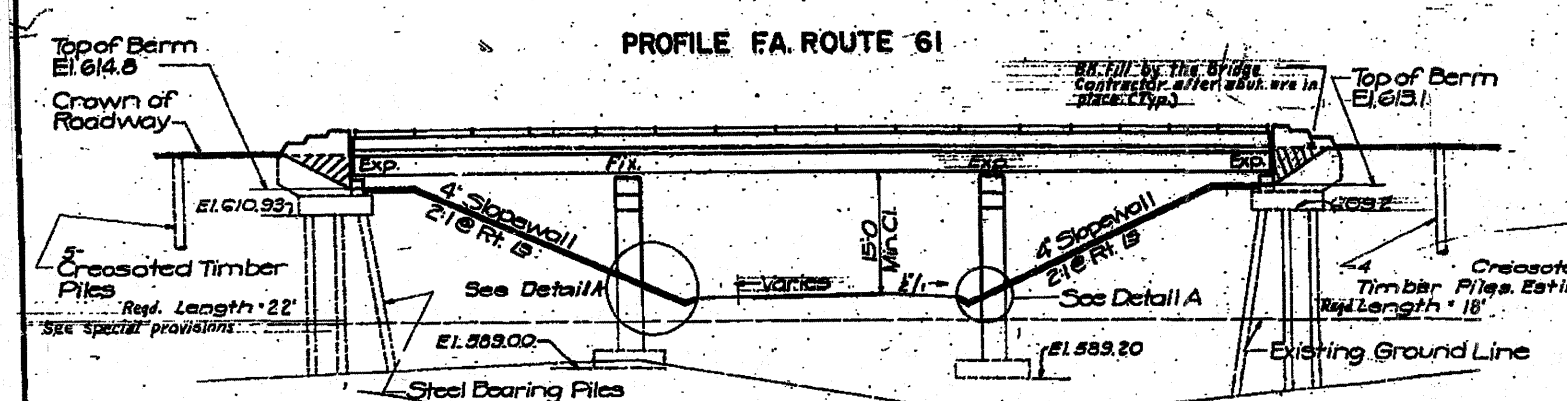

Design Stresses
Reinforced Concrete
fc = 3500 P.S.I.
fs = 20000 P.S.I.
n = 10
fc = 1400 P.S.I. (except footings)
fs = 1000 P.S.I. (footings)
vc = 90 (except footings)
vc = 75 (footings)

Structural Steel
fs = 20000 P.S.I.
Max. Foundation Pressure = 3 1/2 Tons/S.F.
Loading: HS-20-44

GENERAL NOTES

STRUCTURAL STEEL SHALL CONFORM TO THE SPECIFICATIONS FOR STRUCTURAL STEEL, A.S.T.M. DESIGNATION A36.

RIVETS SHALL BE 3/4" WITH 13/16" OPEN HOLES UNLESS NOTED.

CLASS X CONCRETE SHALL BE USED THROUGHOUT. COARSE AGGREGATE USED IN FANAPERS AND RIB POSTS SHALL BE FREE OF CHERT, FLINT, LIMONITE, LIGHTS AND SOFT SANDSTONE.

THE CONCRETE FLOOR SHALL BE FINISHED IN ACCORDANCE WITH ARTICLE 51.19 OF THE STANDARD SPECIFICATIONS.

ALL WELDING SHALL COMPLY WITH THE REQUIREMENTS OF THE STANDARD SPECIFICATIONS FOR WELDED HIGHWAY AND RAILWAY BRIDGES, OF THE AMERICAN WELDING SOCIETY.

ALL ROCKERS, BOLSTERS, BEARING PLATES, LEAD PLATES, PIPES, AND ANCHOR BOLTS SHALL BE FABRICATED AND SET IN ACCORDANCE WITH ARTICLE 51.15 OF THE STANDARD SPECIFICATIONS AND ARE INCLUDED IN QUANTITY OF STRUCTURAL STEEL.

ANCHOR BOLTS SHALL BE SET BEFORE CONNECTING DIAPHRAGMS OVER SUPPORT. SPACE RESPONDING TO MISS ANCHOR BOLTS.

EXPANSION GUARDS AND PLATES SHALL BE FABRICATED AND ERECTED IN ACCORDANCE WITH ARTICLE 51.13 (d) OF THE STANDARD SPECIFICATIONS AND ARE INCLUDED IN QUANTITY OF STRUCTURAL STEEL.

EXCEPT AS OTHERWISE PROVIDED, ALL STRUCTURAL STEEL SHALL RECEIVE ONE SHOP COAT OF RED LEAD PAINT AND TWO FIELD COATS OF ALUMINUM PAINT. SEE ARTICLES 56.1 TO 56.5 INCLUSIVE OF THE STANDARD SPECIFICATIONS.

ALL SURFACES OF EXPANSION GUARDS IMACCESSIBLE AFTER ERECTION SHALL BE GIVEN TWO SHOP COATS OF RED LEAD PAINT. THE 3/4" WELDED SEAMS SHALL NOT BE PAINTED.

THE CONTRACTOR SHALL DRIVE TWO (2) TEST PILES IN PERMANENT LOCATIONS AS SHOWN ON THE PLANS, BEFORE ORDERING REMAINDER OF PILES, WHERE PILES ARE TO BE DRIVEN.

NO ROCK LARGER THAN 3" SHALL BE PLACED IN FILLS IN THE AREA WHERE PILES ARE TO BE DRIVEN.

Excavation for portions of structure in the embankments shall not be classified.

ALL STEEL BEARING PILES ARE TO BE DRIVEN TO REFUSAL.

PERMANENT FORMS WILL NOT BE PERMITTED IN FORMING THE CONCRETE FLOOR.

STATION 69+15.64
BUILT 1961 BY
STATE OF ILLINOIS
FA. RTE. 61 SEC. 10 N 6 E
FA. PROJ. U-184-C20
LOADING HS-20

Note: Approach slab to be constructed in accordance with Method II of Illinois Standard No. 1909-6.

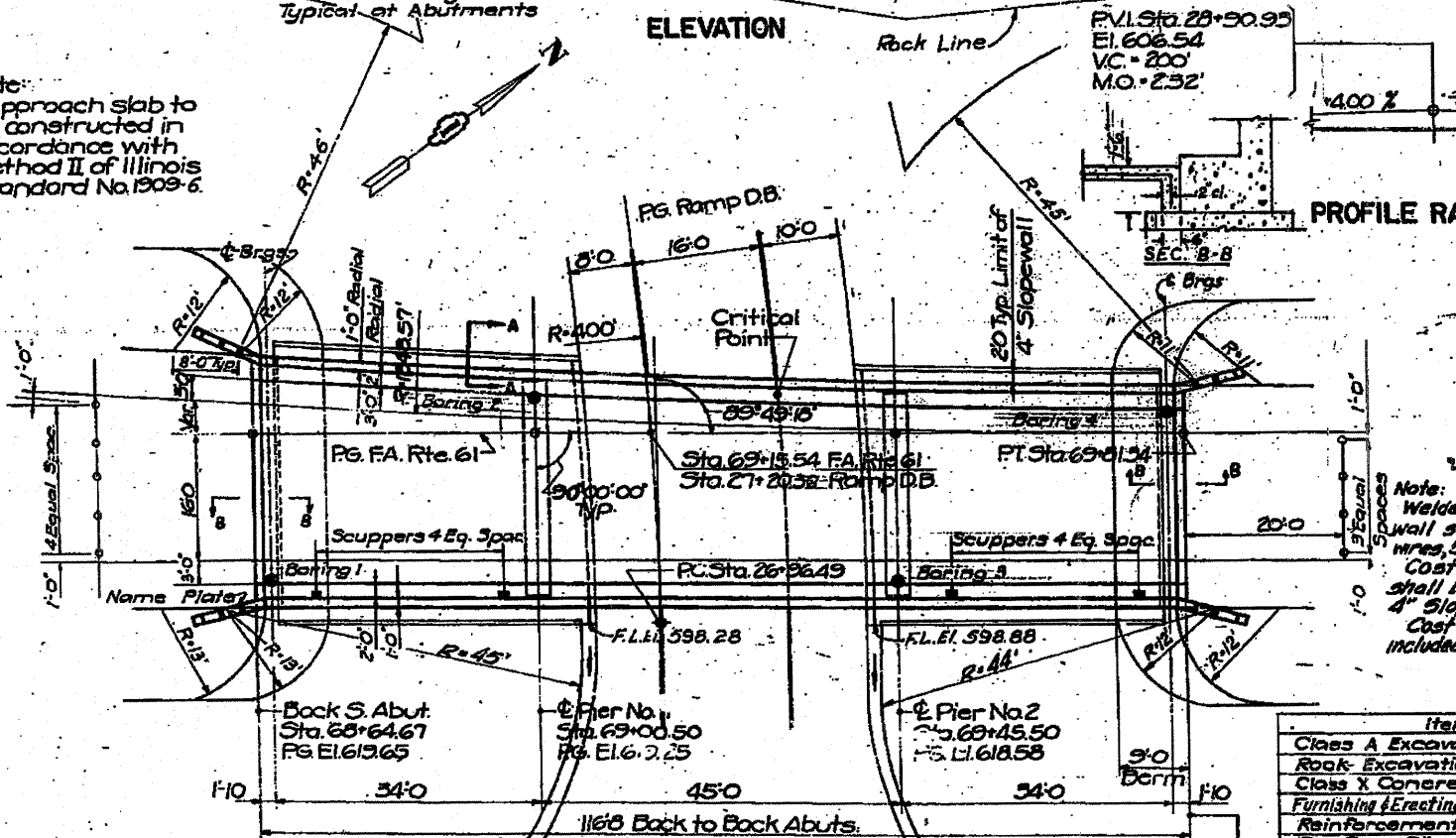

LETTERING FOR NAME PLATE

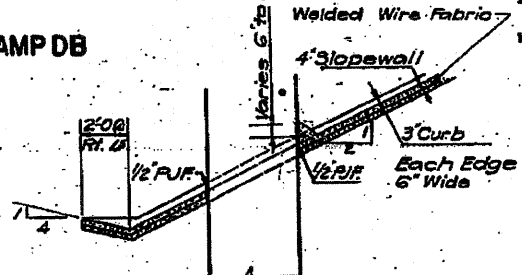

BILL OF MATERIALS
Sec. 10 C 311.67

Item	Unit	Super	Sub	Total
Class A Excavation for Structures	Cu. Yd.		120	120
Rock Excavation for Structures	Cu. Yd.		6	6
Class X Concrete	Cu. Yd.	108.7	170.0	278.7
Furnishing & Erecting Structural Steel	Lb.	63900		63900
Reinforcement Bars	Lb.	24,370	13850	38220
Run Creo Piles 20.1 to 38 feet	Lin. Ft.		110	110
Driving Timber Piles	Lin. Ft.		182	182
Furnishing Steel Piles 10BP42	Lin. Ft.		490	490
Test Pile Steel 10BP42	Each		2	2
Driving Steel Piles	Lin. Ft.		490	490
Name Plates	Each		1	1
Slope Wall 4"	Sq. Yd.		291	291
Aluminum Handrail	Lin. Ft.		229	229
Protective Coat	Sq. Yd.		436	436
Furnishing Creosoted Piles up to 20 ft	Lin. Ft.		72	72
Bridge Seat Sealant	Lump Sum		0.1	0.1

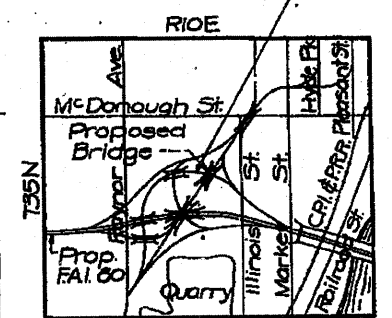

SW 1/4 Sec. 14
LOCATION PLAN
GENERAL PLAN & ELEVATION
FA. ROUTE 61 OVER
RAMP DB
FA. ROUTE 61 STA. 69+15.64
PROJECT U-184-C20
SECTION 10 (S116)
WILL COUNTY
Scale: NO SCALE Date: Nov. 30, 1961
BLAUVELT ENGINEERING CO.
CONSULTING ENGINEERS
WOODBURY, N. J. NEW YORK, N. Y. CRYSTAL LAKE, ILL.

DESIGNED	RDL
CHECKED	MC FJTL
DRAWN	SEF
CHECKED	JL FJTL

Prepared and Recommended by
Blauvelt Engineering Co.
Structural Engineer #1-2251 Russ. H. Wengert

FOR INFORMATION ONLY

Revised: Revise List of Creo Piles from 24 to 22+18. Remove from Bill of Materials Steel Piles ASTM Design A36. Remove F. Sect. 2.4. Revise Bill of Mat'l: Cre. Piles from 261 to 110 Lin. Ft.; Driving Tim. Piles: 261 to 182 Lin. Ft.; Add: Cre. Piles 160' 72 Lin. Ft.