

TYPICAL ENTRANCE/EXIT RAMP COMBINATION PAVEMENT MARKINGS

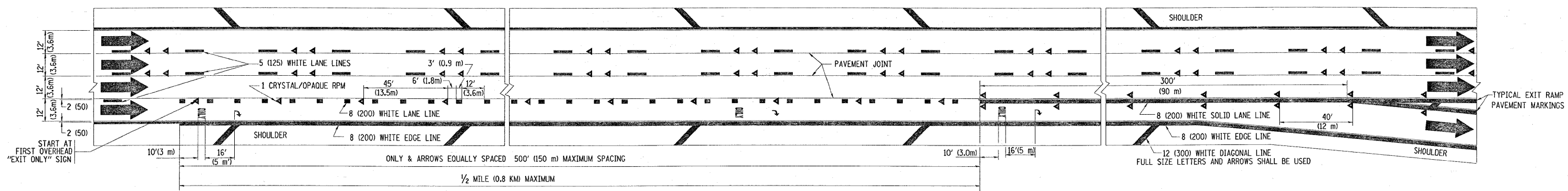

TYPICAL EXIT ONLY LANE PAVEMENT MARKINGS

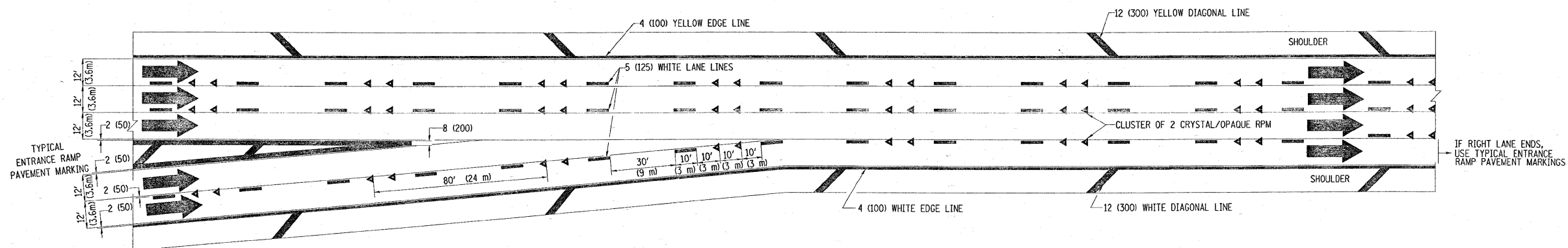

TYPICAL TWO LANE ENTRANCE RAMP PAVEMENT MARKINGS

FILE NAME =	USER NAME = equeiff	DESIGNED - D.W.S.	REVISED - A.H. 03-96	STATE OF ILLINOIS DEPARTMENT OF TRANSPORTATION	MULTI-LANE FREEWAY PAVEMENT MARKING DETAILS	F.A.U. RTE. 316	SECTION (10&1-D-2)RS-4	COUNTY WILL	TOTAL SHEETS 36	SHEET NO. 32		
ea:\pw\work\NPWID07VAQUELEFF\d8120663\Drawings	Std.dgn	DRAWN -	REVISED - D.W.S. 07-96			SCALE: NONE	SHEET NO. 2 OF 2 SHEETS	STA.	TO STA.	CONTRACT NO. 62778		
	PLOT SCALE = 50.0000' / IN.	CHECKED -	REVISED - J.A.F. 02-06			FED. ROAD DIST. NO. 1 ILLINOIS FED. AID PROJECT						
	PLOT DATE = 3/21/2009	DATE - 01-90	REVISED - S.P.B. 01-07									