

LT. STA. 475+64 TO 56+69  
 HMA SHOULDERS, 8" = 1,738 SQ. YD.  
 AGGREGATE SHOULDERS, TYPE B = 257.0 TONS

RT. STA. 476+64 TO 56+96  
 HMA SHOULDERS, 8" = 1,738 SQ. YD.  
 AGGREGATE SHOULDERS, TYPE B = 259.0 TONS

STA. 475+64 TO 56+96  
 HMA SURFACE COURSE MIX "D" N50 = 1,253 TONS  
 POLY. LEVEL BINDER (MACHINE METHOD), IL 4.75, N50 = 626 TONS  
 POLYMERIZED BITUMINOUS MATERIALS (PRIME COAT) = 7.8 TONS  
 AGGREGATE (PRIME COAT) = 45 TONS

VERMONT COMMUNITY  
 UNIT DISTRICT 2

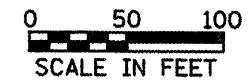
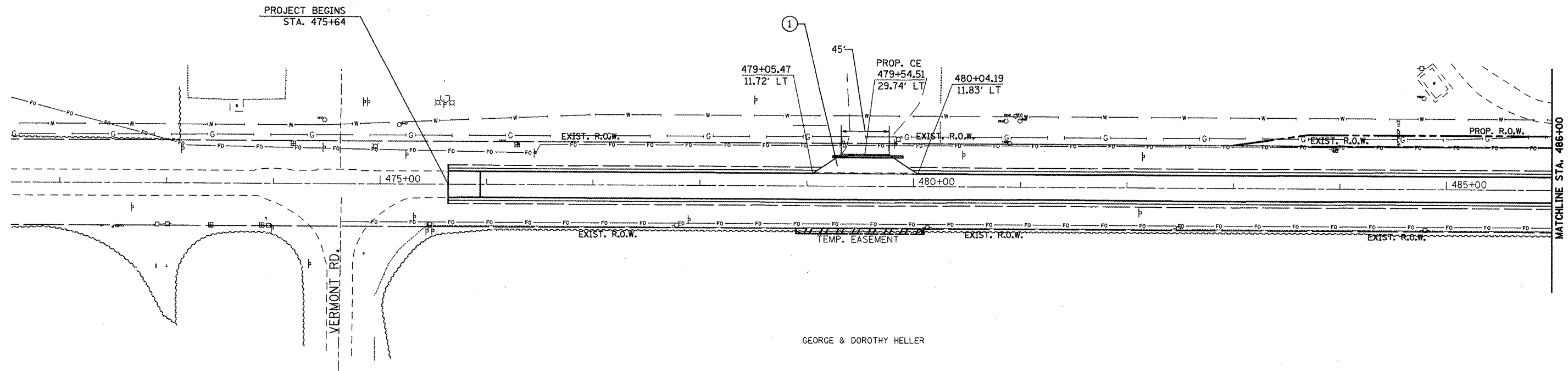

LEGEND	
①	HMA BASE COURSE (6") INCIDENTAL HMA (2")
②	AGGREGATE SURFACE COURSE (8")
•SEE SCHEDULES FOR QUANTITIES	

FILE NAME = propplenshts.dgn	USER NAME = ghidsnaam	DESIGNED -	REVISED -
		DRAWN -	REVISED -
	PLOT SCALE = 100.0000' / IN.	CHECKED -	REVISED -
	PLOT DATE = 3/25/2009	DATE -	REVISED -

**STATE OF ILLINOIS  
 DEPARTMENT OF TRANSPORTATION**

PROPOSED IMPROVEMENT			
SCALE:	SHEET NO. OF SHEETS	STA.	TO STA.

F.A.P. RTE. 315	SECTION 109RS-4,110RS-2	COUNTY FULTON	TOTAL SHEETS	SHEET NO. 37
CONTRACT NO. 68330				ILLINOIS FED. AID PROJECT