

SECTION A-A

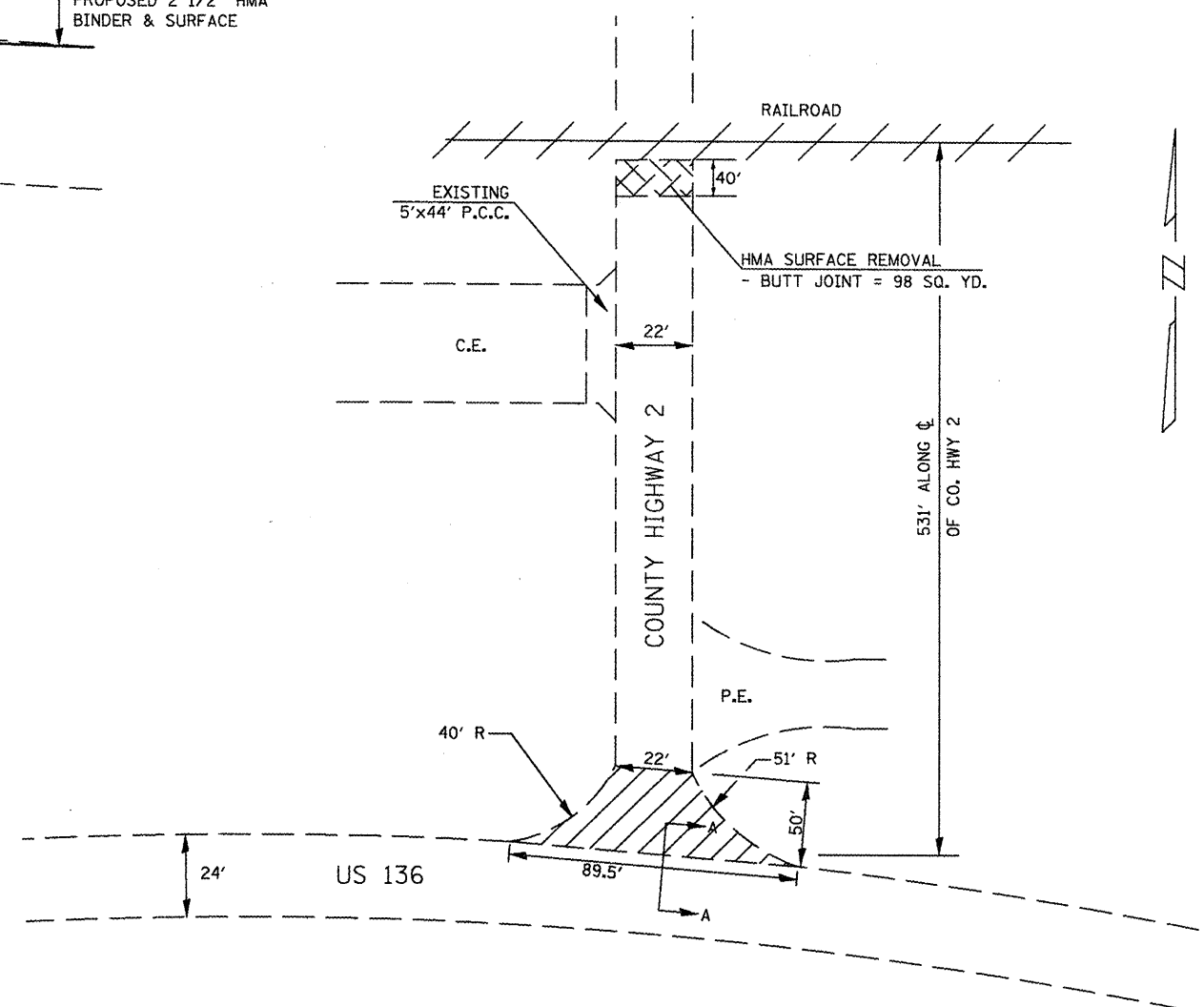

PROPOSED VARIABLE DEPTH MILLING INCLUDED IN THE COST OF 1/2" HMA SURFACE REMOVAL



PLAN VIEW



COST COVERED BY I.D.O.T. (THE REMAINING PORTION OF CO. HWY 2 IS BEING PAID BY FULTON COUNTY)

NOT DRAWN TO SCALE

FILE NAME = propplanshts.dgn	USER NAME = ghidnaem	DESIGNED -	REVISED -	STATE OF ILLINOIS DEPARTMENT OF TRANSPORTATION	COUNTY HIGHWAY 2 DETAIL	F.A.P. RTE. 315	SECTION 109RS-4, 110RS-2	COUNTY FULTON	TOTAL SHEETS 42	SHEET NO. 42	
	PLOT SCALE = 100.0000' / IN.	CHECKED -	REVISED -			SCALE: 1"=50'		SHEET NO. OF SHEETS STA. TO STA.		CONTRACT NO. 68330	
	PLOT DATE = 3/25/2009	DATE -	REVISED -			FED. ROAD DIST. NO. 4 ILLINOIS FED. AID PROJECT					