

Ramp Closure Stage 1- Detour

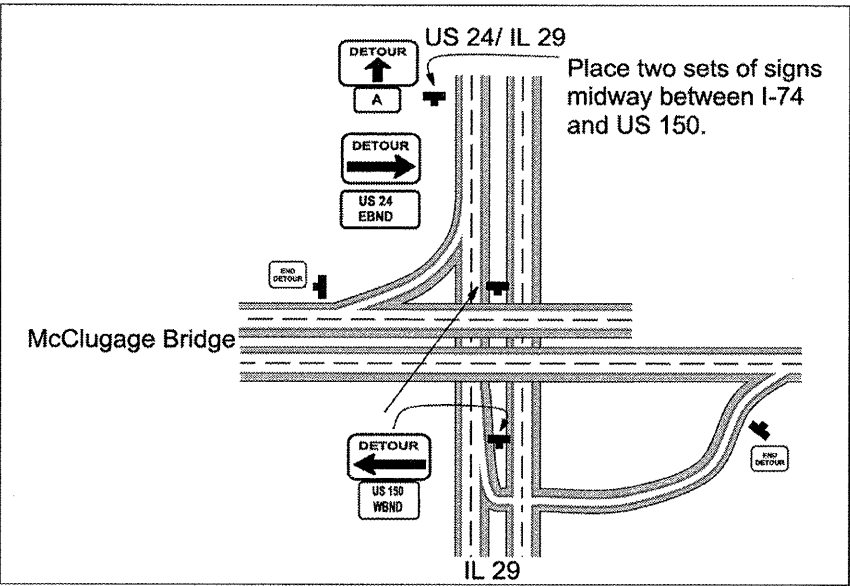
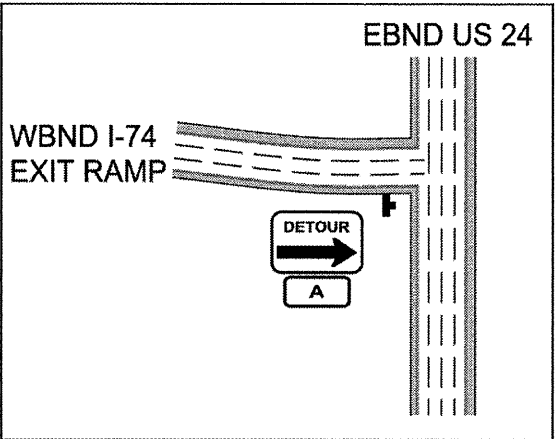
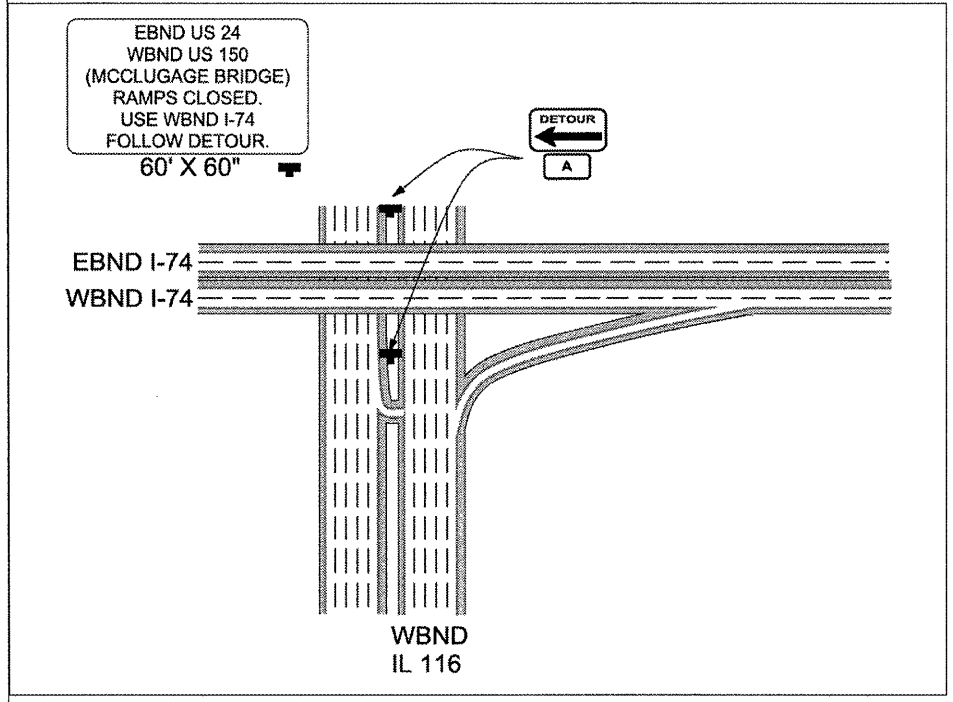

FILE NAME = SCHEDULES.dgn	USER NAME = horstkj	DESIGNED - KJH	REVISED -	STATE OF ILLINOIS DEPARTMENT OF TRANSPORTATION	RAMP STAGING DETAILS	F.A.P. RTE. 317	SECTION (16,131RS-3,17RS-5,14RS-1)	COUNTY PEORIA/TAZEWELL	TOTAL SHEETS 56	SHEET NO. 38		
	PLOT SCALE = 100.0000' / IN.	DRAWN - JGJ	REVISED -			SCALE:	SHEET NO. OF SHEETS STA. TO STA.	CONTRACT NO. 68455				
	PLOT DATE = 4/18/2009	CHECKED -	REVISED -			ILLINOIS FED. AID PROJECT						
		DATE -	REVISED -									