

| F.A.P. RTE. | SECTION | COUNTY | TOTAL SHEETS | SHEET NO. |
|-------------|---------------|--------|--------------|-----------|
| 323 | (149,150)RS-3 | EDGAR | 83 | 21 |

STA. 1675+00 TO STA. 1705+00
 FED. ROAD DIST. NO. ILLINOIS FED. AID PROJECT

**SECTION (149,150)RS-3
 BEGINS STATION 1681+95.00**

STATION EQUATION:
 STA 334+66.00 (FAP 332) AH =
 STA 1484+60.60 (FAP 332) BK =
 STA 1678+98.00 (FAP 323)

SEE STRIPING DETAILS & SCHEDULES
 FOR RUMBLE STRIP LOCATIONS

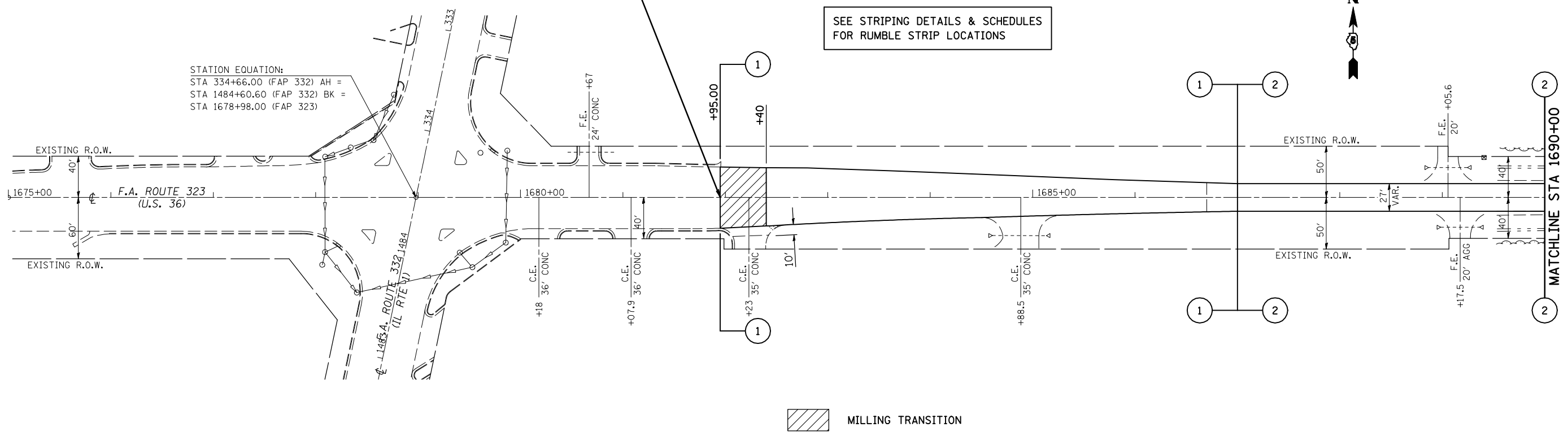

MILLING TRANSITION

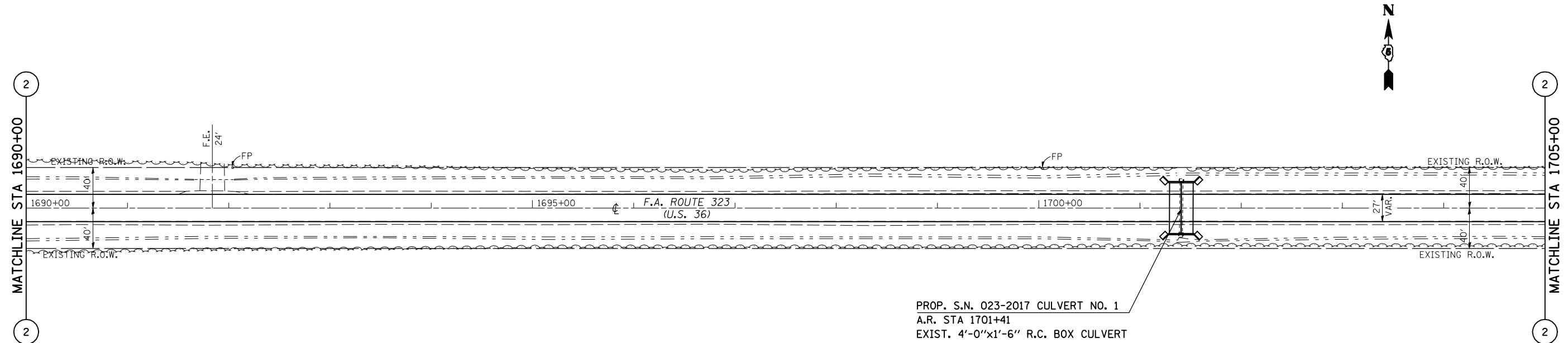

PROP. S.N. 023-2017 CULVERT NO. 1
 A.R. STA 1701+41
 EXIST. 4'-0"X1'-6" R.C. BOX CULVERT
 WITH PRECAST END SECTIONS
 TO BE REMOVED AND REPLACED
 SEE CULVERT DETAILS

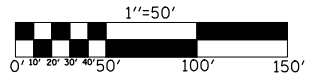

ILLINOIS DEPARTMENT OF TRANSPORTATION
PLAN SHEET
 FAP ROUTE 323 (US 36)
 SECTION (149,150)RS-3
 EDGAR COUNTY

SCALE: 1" = 50'
 DATE: 05/04/2006

DRAWN BY: CADD
 CHECKED BY:

PLOT DATE = 4/4/2009
 FILE NAME = c:\p\...
 PLOT SCALE = 1/8"=50'
 USER NAME = sherer_jm