

F.A.P. RTE.	SECTION	COUNTY	TOTAL SHEETS	SHEET NO.
323	(149,150)RS-3	EDGAR	83	24
STA. 1765+00		TO STA. 1795+00		
FED. ROAD DIST. NO.	ILLINOIS	FED. AID PROJECT		

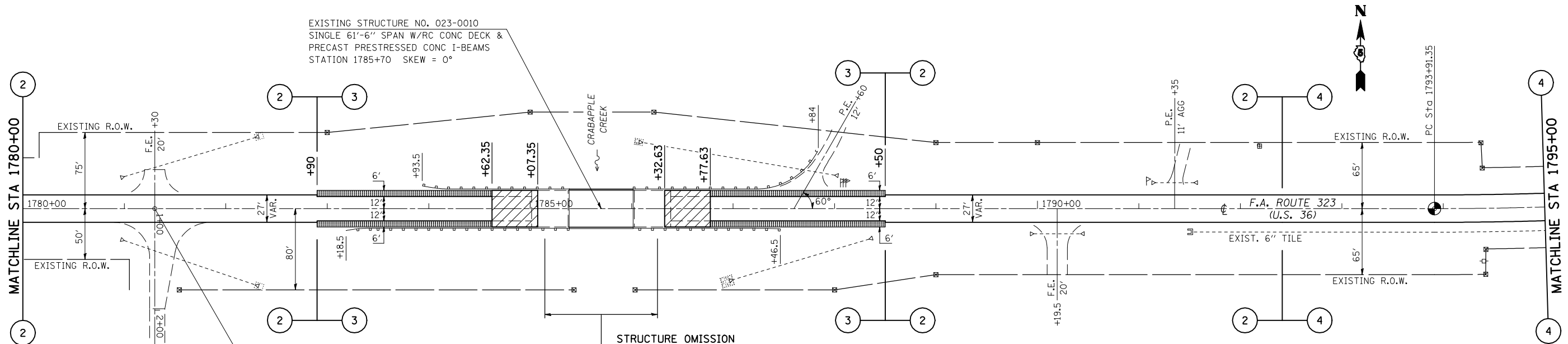
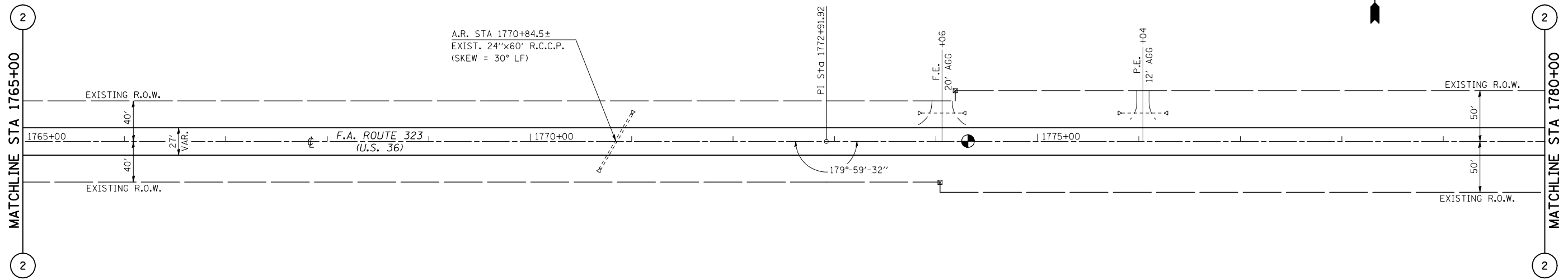

PLOT DATE = 4/4/2009
 FILE NAME = c:\p\c\p\149150\1765\1795\1765.dgn
 PLOT SCALE = 1/85,8824 / IN.
 USER NAME = sherej_m

SEE GUARDRAIL DETAILS FOR GUARDRAIL WORK AT SN 023-0010

- MILLING TRANSITION
- HMA SHOULDERS

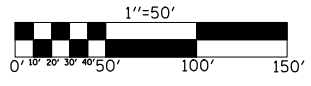

ILLINOIS DEPARTMENT OF TRANSPORTATION

PLAN SHEET

FAP ROUTE 323 (US 36)
 SECTION (149,150)RS-3
 EDGAR COUNTY

SCALE: 1" = 50'
 DATE: 05/04/2006

DRAWN BY: CADD
 CHECKED BY: