

F.A.P. RTE.	SECTION	COUNTY	TOTAL SHEETS	SHEET NO.
323	(149,150)RS-3	EDGAR	83	40
STA.		TO STA.		
FED. ROAD DIST. NO.	ILLINOIS	FED. AID PROJECT		

CAST-IN-PLACE BOX CULVERT END SECTION DETAIL

CULVERT NO. 1 PROPOSED S.N. 023-2017

STATION 1701+41.00

SHEET 6 OF 7

DRAWING NOT TO SCALE

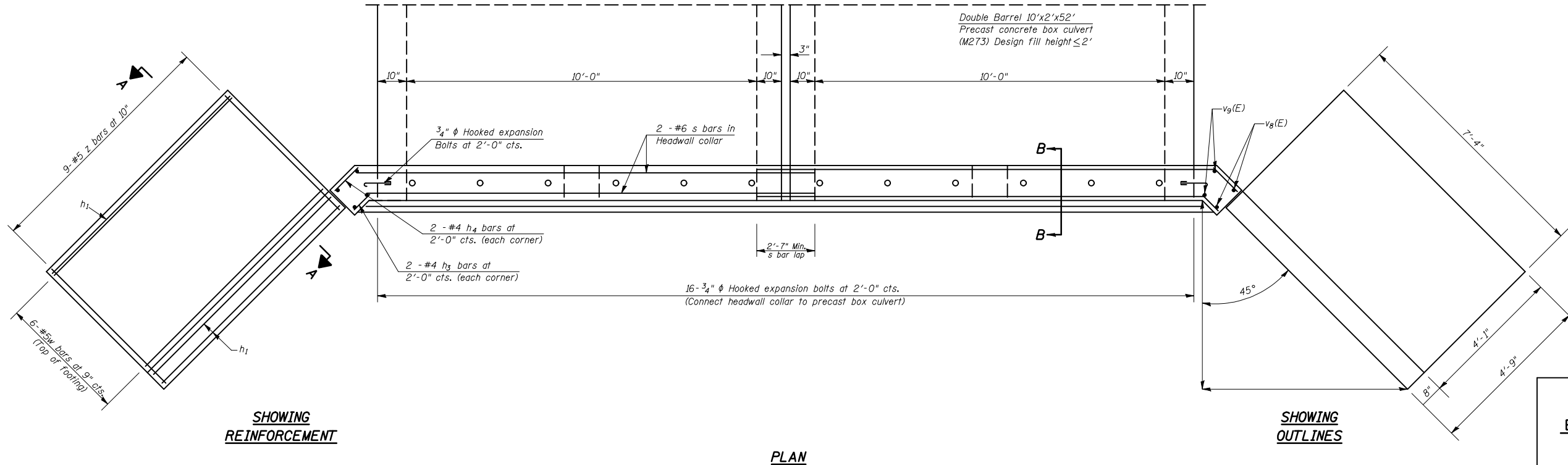
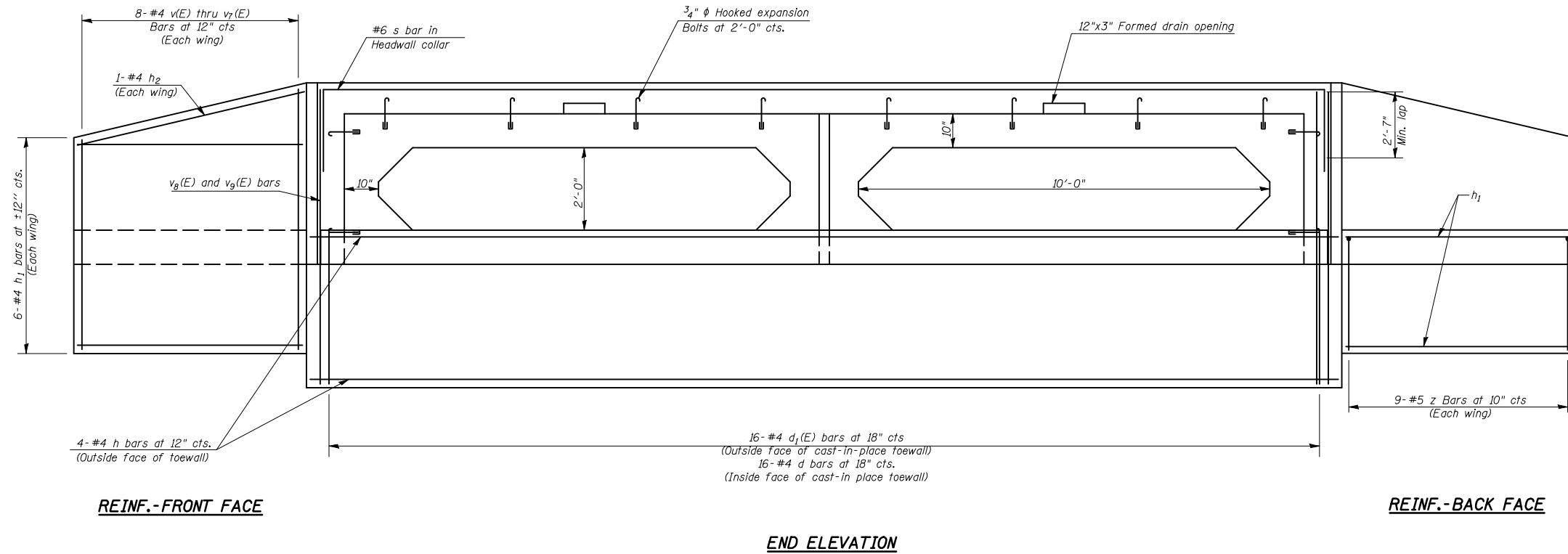

ILLINOIS DEPARTMENT OF TRANSPORTATION
 DETAIL OF BOX CULVERT
 END SECTION (CAST IN PLACE)
 FAP ROUTE 323 (US 36)
 SECTION (149,150)RS-3
 EDGAR COUNTY

SCALE: NOT TO SCALE
 DATE: 06/12/2008

DRAWN BY: JMS
 CHECKED BY:

PLOT DATE = 4/4/2009
 FILE NAME = c:\p\p\proj\149150\170141\Culvert-01Detail.dgn
 PLOT SCALE = 4.23529 / IN.
 USER NAME = sherej_m