

| F.A.P. RTE. | SECTION | COUNTY | TOTAL SHEETS | SHEET NO. |
|---------------------|---------------|------------------|--------------|-----------|
| 323 | (149,150)RS-3 | EDGAR | 83 | 56 |
| STA. | | TO STA. | | |
| FED. ROAD DIST. NO. | ILLINOIS | FED. AID PROJECT | | |

GUARDRAIL DETAILS

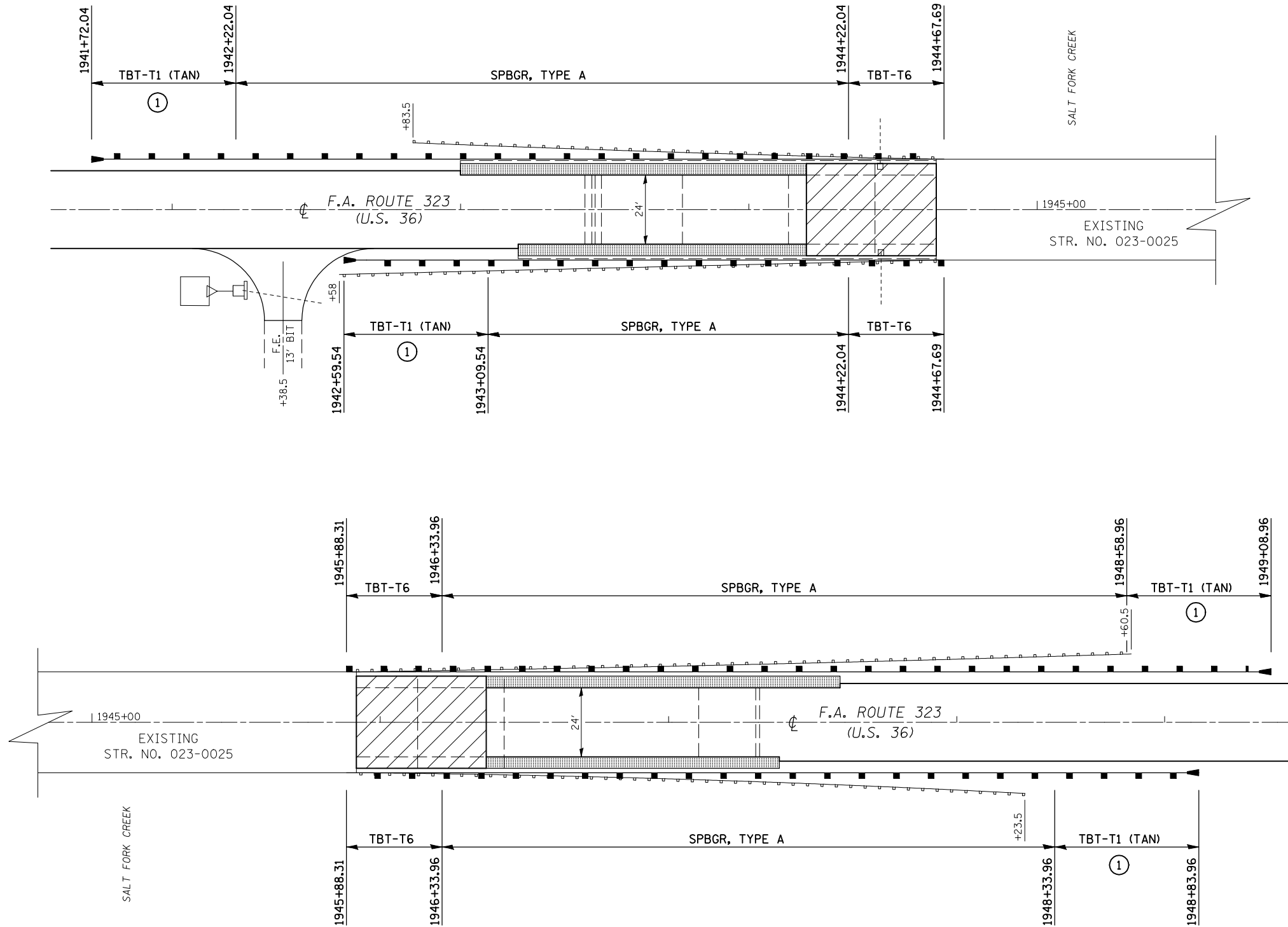

PLAN NOTES

- ① SHOULDER WIDENING FOR TYPE 1 (SPL) TERMINAL SHALL BE CONSTRUCTED PRIOR TO PLACEMENT OF THE NEW GUARDRAIL AND TERMINALS.
- ② THE VARIOUS GUARDRAIL PAY ITEMS REPRESENT THE BEST INFORMATION AVAILABLE AT THE TIME OF COMPLETION OF THE PLANS FOR LETTING. VARIATIONS IN LOCATIONS AND LENGTHS MAY OCCUR.

SHEET 2 OF 3

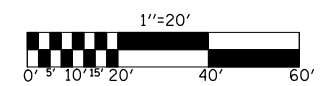

- MILLING TRANSITION
- HMA SHOULDERS

ILLINOIS DEPARTMENT OF TRANSPORTATION
GUARDRAIL DETAILS
 FAP ROUTE 323 (US 36)
 SECTION (149,150)RS-3
 EDGAR COUNTY

SCALE: 1" = 20'
 DATE: 06/09/2006

DRAWN BY: CADD
 CHECKED BY:

PLOT DATE = 4/4/2009
 FILE NAME = c:\p\... \SHERER\JM\dms87384\detail.dgn
 PLOT SCALE = 42,352% / IN.
 USER NAME = sherer_jm