

STATION 1741+62.00
 BUILT 20__ BY
 STATE OF ILLINOIS
 F.A.P. 693 SEC. (21,22)R,RS-1
 LOADING HS-20
 STRUCTURE NO. 057-8213

SEC. 36, T24N, R4E, 3RD P.M.

EXISTING S.N. 057-8163
 8'x4' RC BOX CULVERT
 STATION 1741+62.00
 SKEW = 0°

PROPOSED S.N. 057-8213
 STATION 1741+62.00
 PRECAST BOX CULVERT WITH
 CAST-IN-PLACE END SECTION
 AND UPSTREAM DROP STRUCTURE
 DOUBLE 8' X 4' X 36.5'
 SKEW = 0°
 SEE DETAIL SHEETS 32 & 36

STEEL PLATE BEAM
 GUARDRAIL, TYPE A

NAME PLATE
 See Std. 515001

DATE	
BY	
SURVEYED	
PLOTTED	
CHECKED	
DATE	
BY	
NO. BOOK	
NO.	

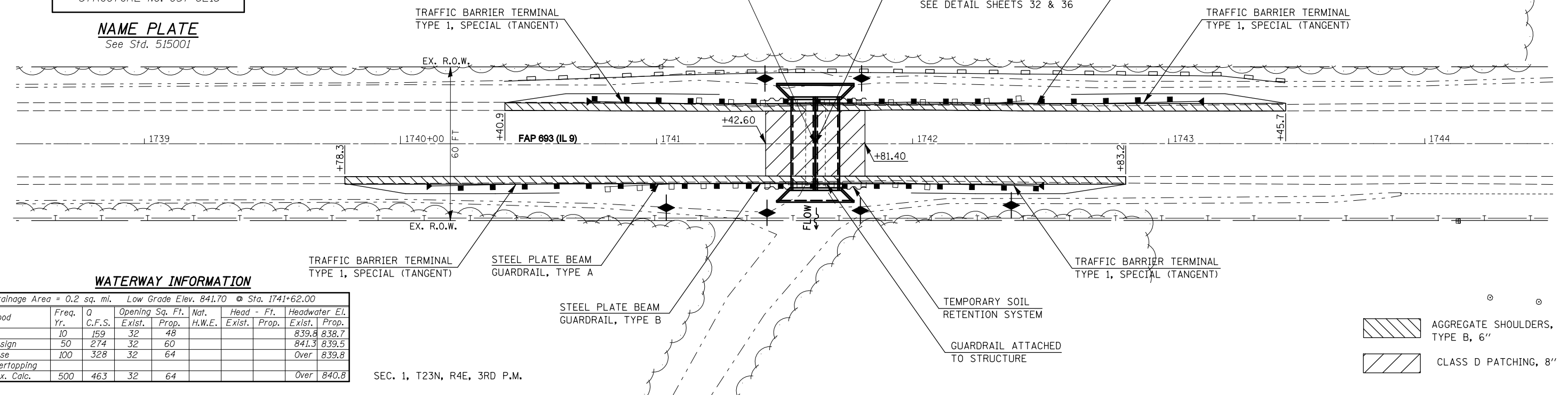

WATERWAY INFORMATION

Drainage Area = 0.2 sq. mi. Low Grade Elev. 841.70 @ Sta. 1741+62.00

Flood	Freq. Yr.	Q C.F.S.	Opening Sq. Ft.		Nat. H.W.E.	Head - Ft.		Headwater El.	
			Exist.	Prop.		Exist.	Prop.	Exist.	Prop.
10	159	32	48					839.8	838.7
Design	50	274	32	60				841.3	839.5
Base	100	328	32	64				Over	839.8
Overtopping									
Max. Calc.	500	463	32	64				Over	840.8

SEC. 1, T23N, R4E, 3RD P.M.

- AGGREGATE SHOULDERS, TYPE B, 6"
- CLASS D PATCHING, 8"

DATE	
BY	
SURVEYED	
PLOTTED	
CHECKED	
DATE	
BY	
NO. BOOK	
NO.	

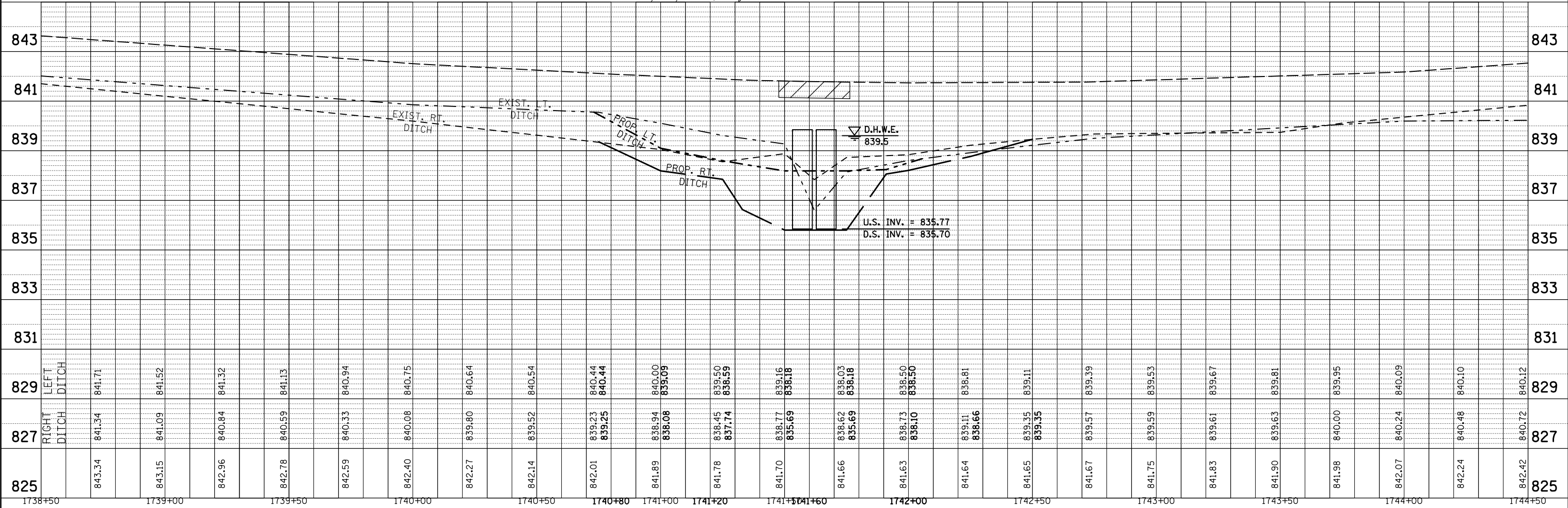

FILE NAME =	USER NAME = carrollrt	DESIGNED -	REVISED -	STATE OF ILLINOIS DEPARTMENT OF TRANSPORTATION	GENERAL PLAN AND PROFILE PROPOSED S.N. 057-8213				F.A.P. RTE. 693	SECTION (21,22)R,RS-1	COUNTY MCLEAN	TOTAL SHEETS 105	SHEET NO. 24
ct:\pwwork\pwwid01\CARROLLRT\0104712\70509\Plan&Profile.dgn		DRAWN -	REVISED -		SCALE:	SHEET NO.	OF SHEETS	STA.	TO STA.	CONTRACT NO. 70509			
		CHECKED -	REVISED -		FED. ROAD DIST. NO. ILLINOIS FED. AID PROJECT								
		DATE -	REVISED -										