

EXIST. CURVE 7
 PI STA. = 6+02.39
 $\Delta = 40^\circ 00' 14''$ (RT)
 $D = 5^\circ 10' 13''$
 $R = 1,108.20'$
 $T = 403.40'$
 $L = 773.75'$
 $E = 71.14'$
 $e = \text{-----}$
 $T.R. = \text{-----}$
 $S.E. \text{ RUN} = \text{-----}$
 $P.C. \text{ STA.} = 1+98.99$
 $P.T. \text{ STA.} = 9+72.74$

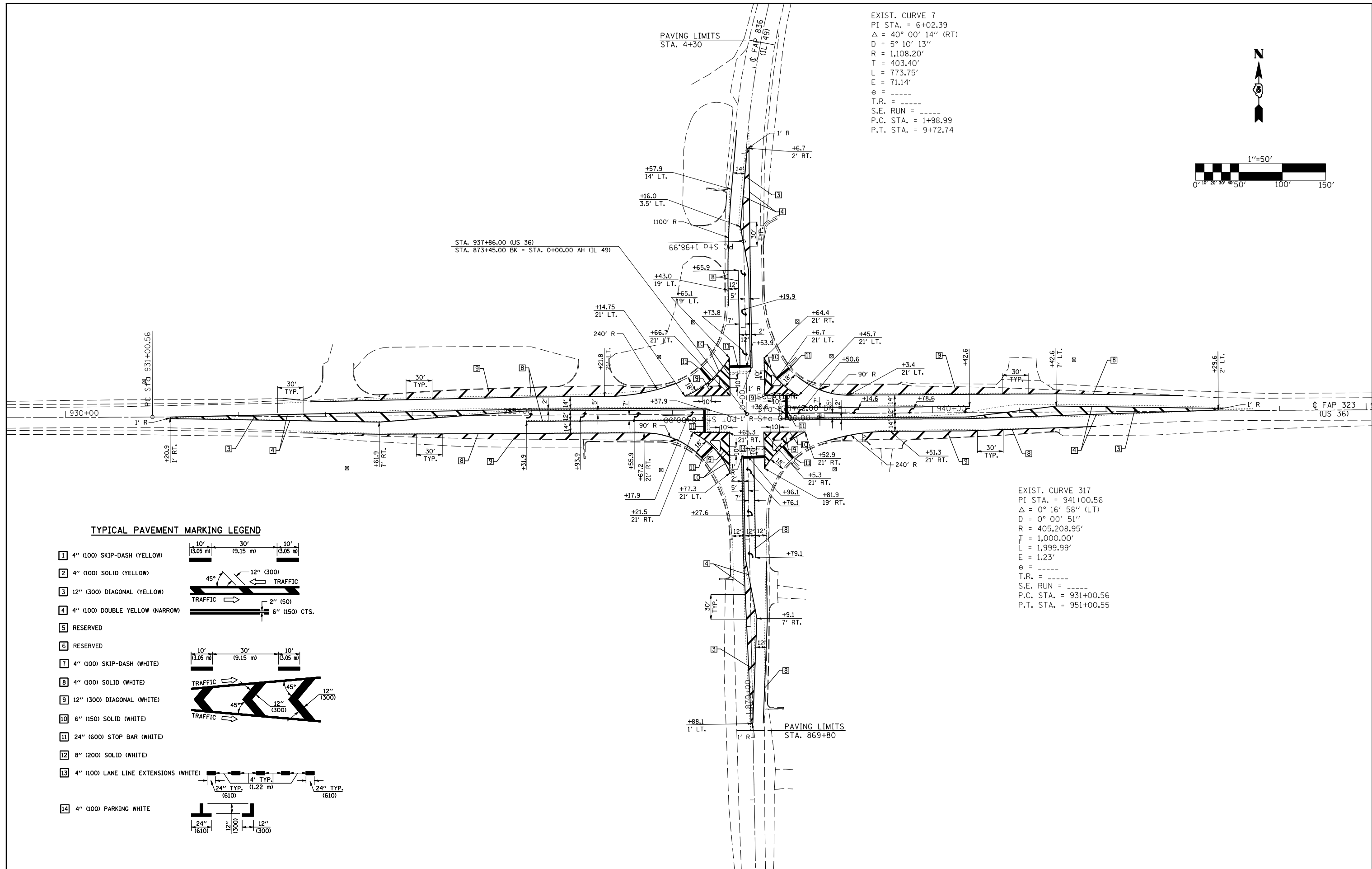
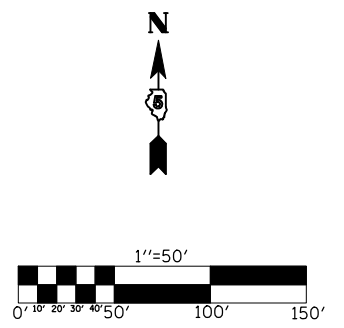

TYPICAL PAVEMENT MARKING LEGEND

- 1 4" (100) SKIP-DASH (YELLOW)
- 2 4" (100) SOLID (YELLOW)
- 3 12" (300) DIAGONAL (YELLOW)
- 4 4" (100) DOUBLE YELLOW (NARROW)
- 5 RESERVED
- 6 RESERVED
- 7 4" (100) SKIP-DASH (WHITE)
- 8 4" (100) SOLID (WHITE)
- 9 12" (300) DIAGONAL (WHITE)
- 10 6" (150) SOLID (WHITE)
- 11 24" (600) STOP BAR (WHITE)
- 12 8" (200) SOLID (WHITE)
- 13 4" (100) LANE LINE EXTENSIONS (WHITE)
- 14 4" (100) PARKING WHITE

EXIST. CURVE 317
 PI STA. = 941+00.56
 $\Delta = 0^\circ 16' 58''$ (LT)
 $D = 0^\circ 00' 51''$
 $R = 405,208.95'$
 $T = 1,000.00'$
 $L = 1,999.99'$
 $E = 1.23'$
 $e = \text{-----}$
 $T.R. = \text{-----}$
 $S.E. \text{ RUN} = \text{-----}$
 $P.C. \text{ STA.} = 931+00.56$
 $P.T. \text{ STA.} = 951+00.55$

FILE NAME =	USER NAME = keyarb	DESIGNED - MWM	REVISED -
ct:\pw\work\PWIDOT\KEYSRB\d0124768\d570714-shd-strt\striping.dgn		DRAWN -	REVISED -
		CHECKED -	REVISED -
		DATE -	REVISED -

**STATE OF ILLINOIS
 DEPARTMENT OF TRANSPORTATION**

**STRIPING DETAIL FOR
 INTERSECTION OF US 36 & IL 49**

F.A.P. RTE.	SECTION	COUNTY	TOTAL SHEETS	SHEET NO.
323	(147,148,149)RS-4	Edgar	23	14
CONTRACT NO. 70714				
ILLINOIS FED. AID PROJECT				

SCALE: 1" = 50' SHEET NO. 1 OF 3 SHEETS STA. TO STA.