

DETAILED LOCATION MAP #1

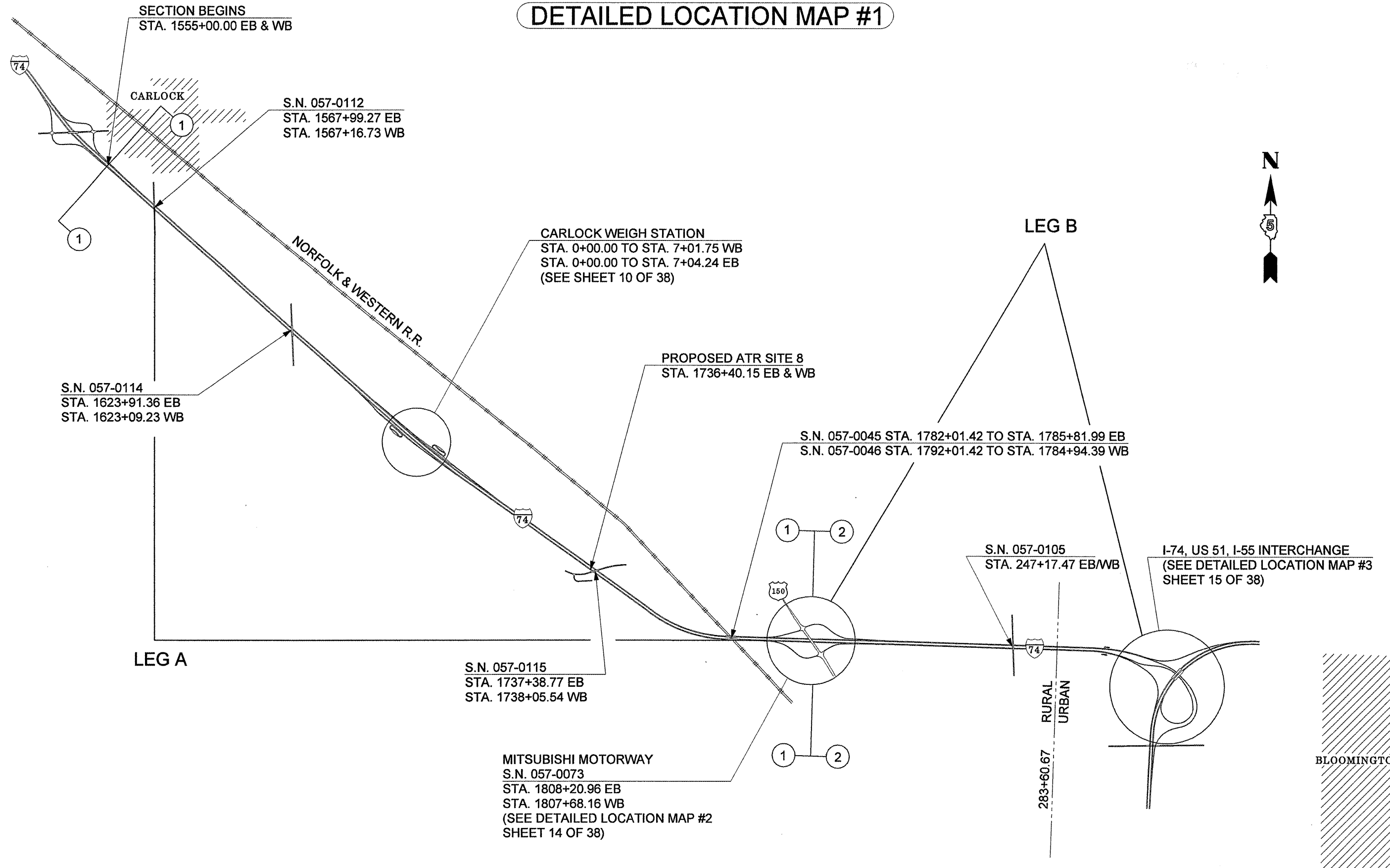

SECTION BEGINS
STA. 1555+00.00 EB & WB

S.N. 057-0112
STA. 1567+99.27 EB
STA. 1567+16.73 WB

S.N. 057-0114
STA. 1623+91.36 EB
STA. 1623+09.23 WB

CARLOCK WEIGH STATION
STA. 0+00.00 TO STA. 7+01.75 WB
STA. 0+00.00 TO STA. 7+04.24 EB
(SEE SHEET 10 OF 38)

PROPOSED ATR SITE 8
STA. 1736+40.15 EB & WB

S.N. 057-0045 STA. 1782+01.42 TO STA. 1785+81.99 EB
S.N. 057-0046 STA. 1792+01.42 TO STA. 1784+94.39 WB

S.N. 057-0105
STA. 247+17.47 EB/WB

I-74, US 51, I-55 INTERCHANGE
(SEE DETAILED LOCATION MAP #3
SHEET 15 OF 38)

S.N. 057-0115
STA. 1737+38.77 EB
STA. 1738+05.54 WB

MITSUBISHI MOTORWAY
S.N. 057-0073
STA. 1808+20.96 EB
STA. 1807+68.16 WB
(SEE DETAILED LOCATION MAP #2
SHEET 14 OF 38)

283+60.67
RURAL
URBAN

BLOOMINGTON

FILE NAME =	USER NAME = sherer,jm	DESIGNED -	REVISED -
c:\pwwork\FWIDOT\SHERRERJM\d0115027\d57	0761-sht-location.drawing.dgn	DRAWN -	REVISED -
	PLOT SCALE = 50.0000' / IN.	CHECKED -	REVISED -
	PLOT DATE = 4/14/2009	DATE -	REVISED -

**STATE OF ILLINOIS
DEPARTMENT OF TRANSPORTATION**

DETAILED LOCATION MAPS

SCALE: SHEET NO. 1 OF 3 SHEETS STA. TO STA.

F.A.I. RTE.	SECTION	COUNTY	TOTAL SHEETS	SHEET NO.
74	(57-18,19)RS-2(9-1,57-5)RS	McLean	38	13
CONTRACT NO. 70761				
ILLINOIS FED. AID PROJECT				