

F.A.S. RTE.	SECTION	COUNTY	TOTAL SHEETS	SHEET NO.
1613	21N	SANGAMON	46	20
FED. ROAD DIST. NO.	ILLINOIS	FED. AID PROJECT		

ELEVATIONS AT 25 FOOT INTERVALS UNLESS OTHERWISE NOTED.

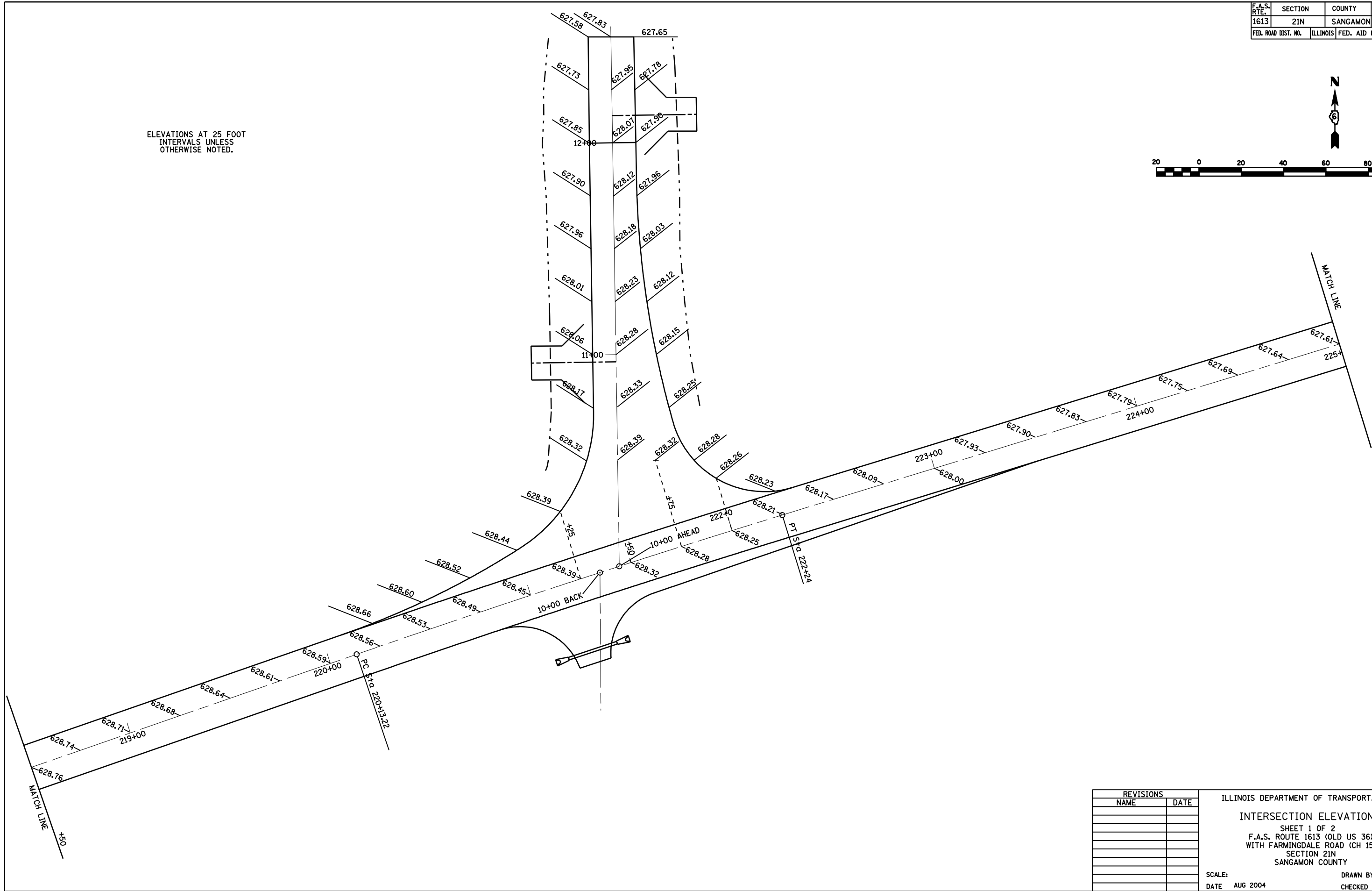
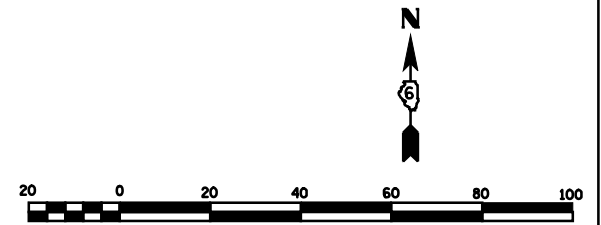

REVISIONS	
NAME	DATE

ILLINOIS DEPARTMENT OF TRANSPORTATION
 INTERSECTION ELEVATIONS
 SHEET 1 OF 2
 F.A.S. ROUTE 1613 (OLD US 36)
 WITH FARMINGDALE ROAD (CH 15)
 SECTION 21N
 SANGAMON COUNTY

SCALE: DRAWN BY DJK
 DATE AUG 2004 CHECKED BY DBS