

F.A.S. RTE.	SECTION	COUNTY	TOTAL SHEETS	SHEET NO.
1613	21N	SANGAMON	46	21
FED. ROAD DIST. NO.	ILLINOIS	FED. AID PROJECT		

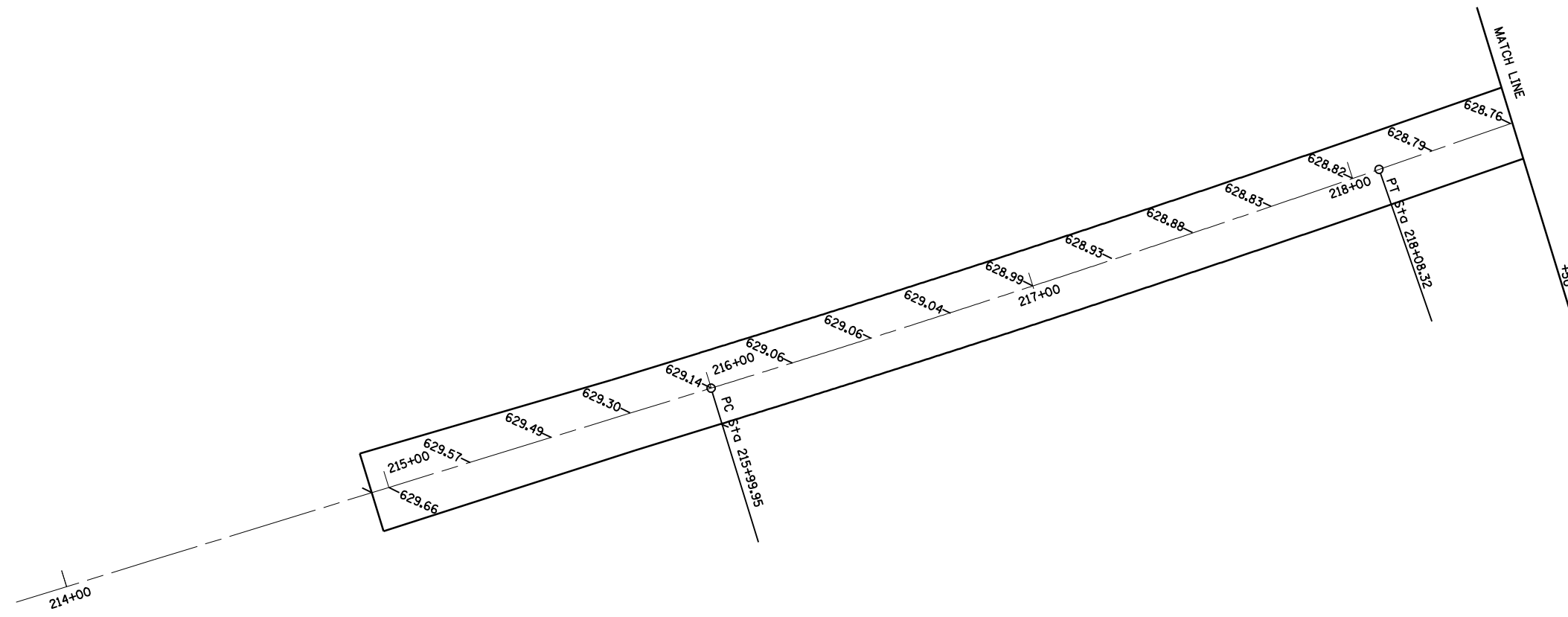

SEE PREVIOUS SHEET

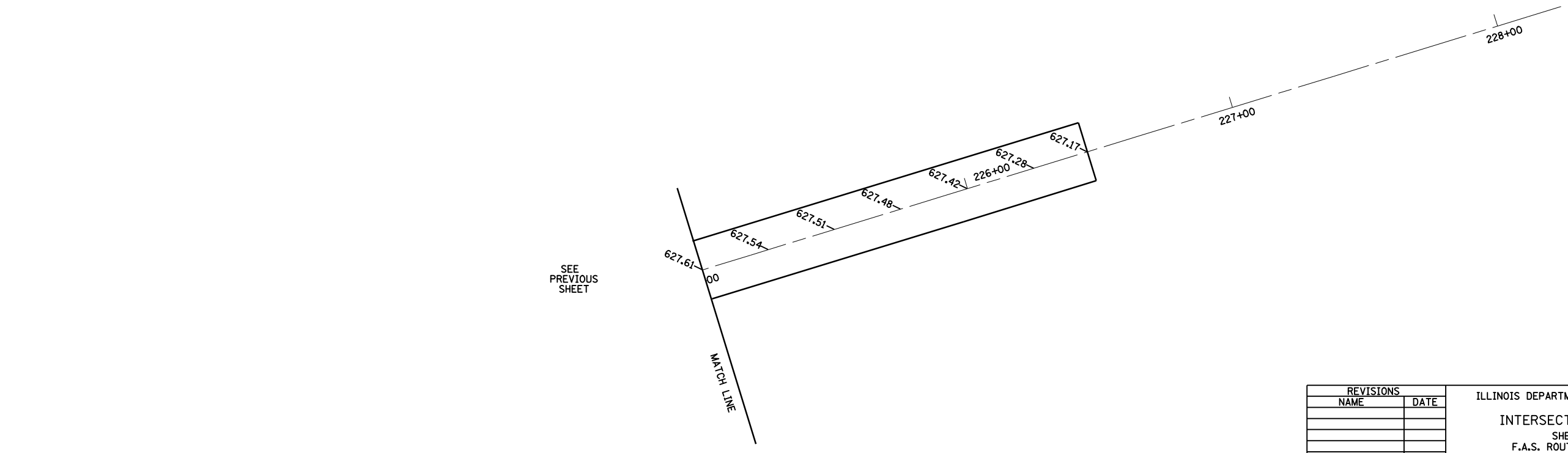
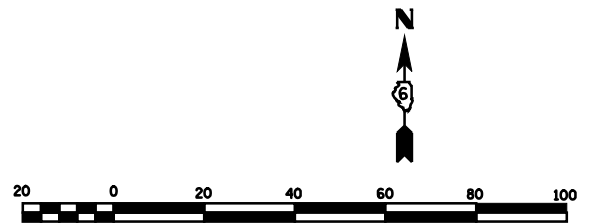

SEE PREVIOUS SHEET

REVISIONS	
NAME	DATE

ILLINOIS DEPARTMENT OF TRANSPORTATION
 INTERSECTION ELEVATIONS
 SHEET 2 OF 2
 F.A.S. ROUTE 1613 (OLD US 36)
 WITH FARMINGDALE ROAD (CH 15)
 SECTION 21N
 SANGAMON COUNTY
 SCALE: DATE AUG 2004
 DRAWN BY DJK
 CHECKED BY DBS