

STATE OF ILLINOIS
DEPARTMENT OF TRANSPORTATION
DIVISION OF HIGHWAYS

**PROPOSED
HIGHWAY PLANS**

FAS ROUTE 743 (HILLVIEW BLACK TOP)
SECTION 19RS-6

MICROSURFACING
SCOTT COUNTY

C-96-065-09

F.A. RTE.	SECTION	COUNTY	TOTAL SHEETS	SHEET NO.
743	19RS-6	SCOTT	5	1
ILLINOIS CONTRACT NO. 72C73				

FOR INDEX OF SHEETS, SEE SHEET NO. 2

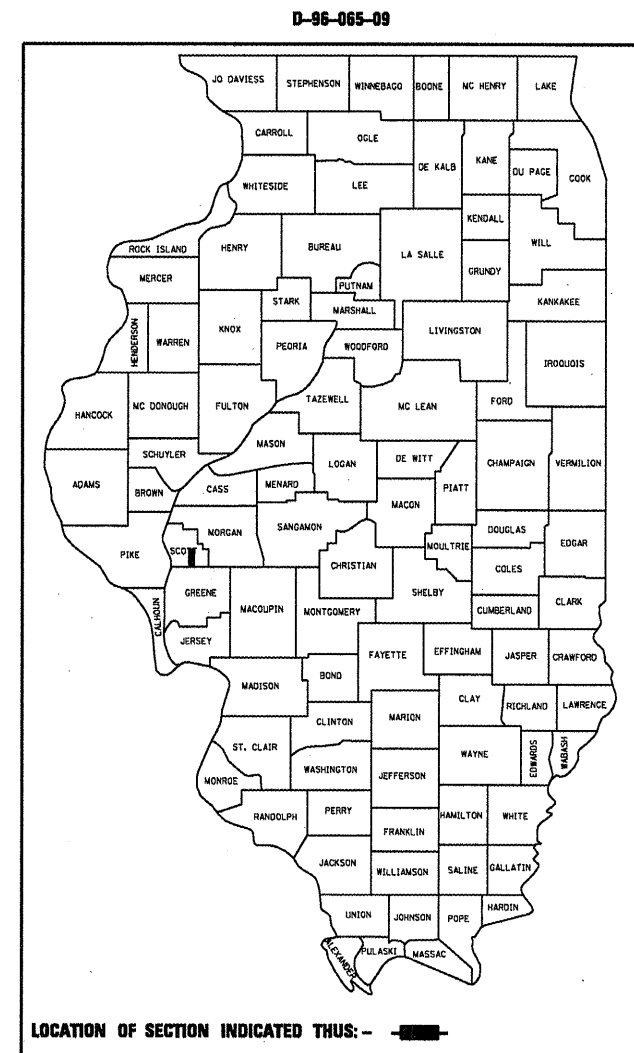

IMPROVEMENT BEGINS
STA 12+54

IMPROVEMENT ENDS
STA 414+14

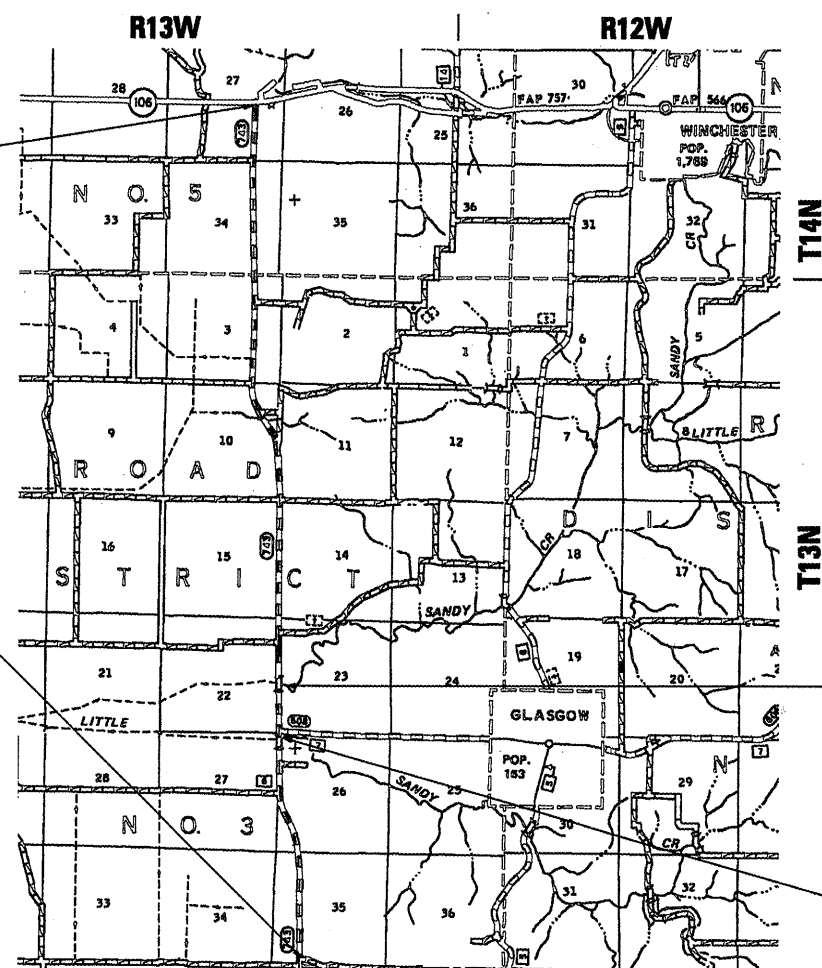

BRIDGE OMISSION
STA 280+87 TO
STA 284+89

BRIDGE OMISSION
STA 306+27.9 TO
STA 308+83.4

ADT
1,150 (2007)

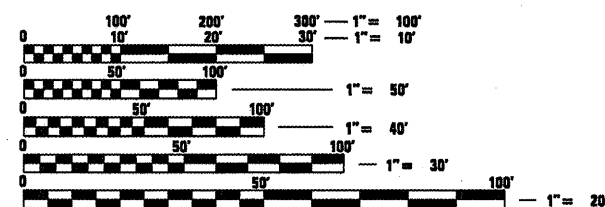

FULL SIZE PLANS HAVE BEEN PREPARED USING STANDARD ENGINEERING SCALES. REDUCED SIZED PLANS WILL NOT CONFORM TO STANDARD SCALES. IN MAKING MEASUREMENTS ON REDUCED PLANS, THE ABOVE SCALES MAY BE USED.

J.U.L.I.E.
JOINT UTILITY LOCATION INFORMATION FOR EXCAVATION
1-800-892-0123
OR 811

PROJECT ENGINEER: JOHN NEGANGARD 217-782-6990
PROJECT MANAGER: VINCE MADONIA 217-785-9046

CONTRACT NO. 72C73

GROSS LENGTH = 40233.6 FT. = 7.62 MILE
NET LENGTH = 39600 FT. = 7.50 MILE

STATE OF ILLINOIS
DEPARTMENT OF TRANSPORTATION
DIVISION OF HIGHWAYS

SUBMITTED *March 27* 20 *09*
Ray Z. Omer
DEPUTY DIRECTOR OF HIGHWAYS, REGION ENGINEER

May 1 20 *09*
Charles J. Ingersoll
ENGINEER OF DESIGN AND ENVIRONMENT

May 1 20 *09*
Christine M. Reed
DIRECTOR OF HIGHWAYS, CHIEF ENGINEER

**PRINTED BY THE AUTHORITY
OF THE STATE OF ILLINOIS**