

STATE OF ILLINOIS
DEPARTMENT OF TRANSPORTATION
DIVISION OF HIGHWAYS

**PROPOSED
HIGHWAY PLANS**

FAS ROUTE 743 (HILLVIEW BLACK TOP)
SECTION 19RS-6

MICROSURFACING
SCOTT COUNTY

C-96-065-09

F.A. RTE.	SECTION	COUNTY	TOTAL SHEETS	SHEET NO.
743	19RS-6	SCOTT	5	1
ILLINOIS CONTRACT NO. 72C73				

FOR INDEX OF SHEETS, SEE SHEET NO. 2

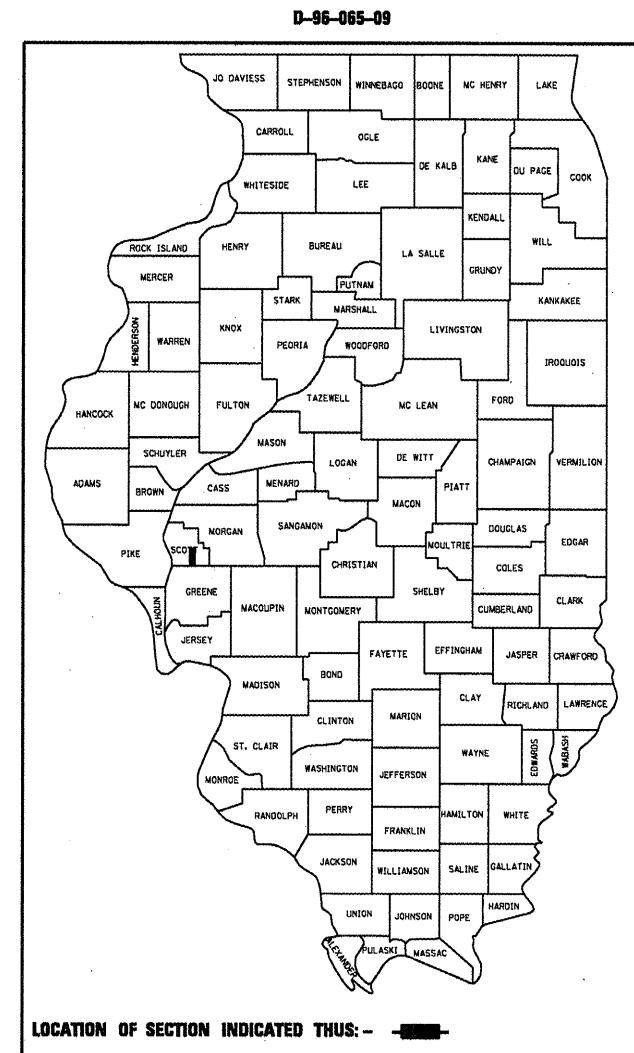

IMPROVEMENT BEGINS
STA 12+54

IMPROVEMENT ENDS
STA 414+14

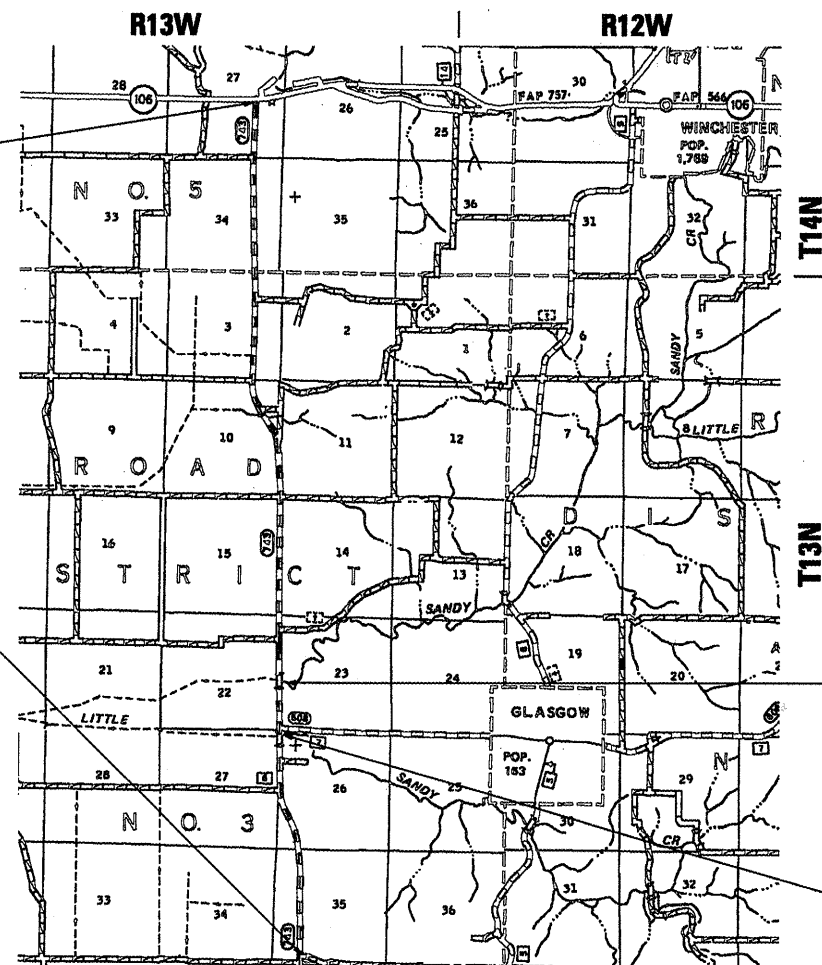

BRIDGE OMISSION
STA 280+87 TO
STA 284+89

BRIDGE OMISSION
STA 306+27.9 TO
STA 308+83.4

GROSS LENGTH = 40233.6 FT. = 7.62 MILE
NET LENGTH = 39600 FT. = 7.50 MILE

ADT
1,150 (2007)

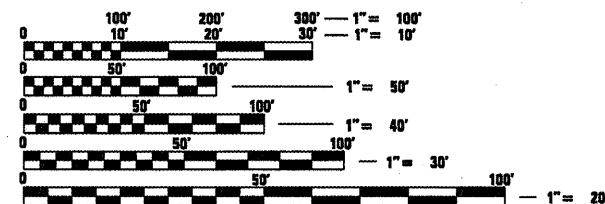

FULL SIZE PLANS HAVE BEEN PREPARED USING STANDARD ENGINEERING SCALES. REDUCED SIZED PLANS WILL NOT CONFORM TO STANDARD SCALES. IN MAKING MEASUREMENTS ON REDUCED PLANS, THE ABOVE SCALES MAY BE USED.

J.U.L.I.E.
JOINT UTILITY LOCATION INFORMATION FOR EXCAVATION
1-800-892-0123
OR 811

PROJECT ENGINEER: JOHN NEGANGARD 217-782-6990
PROJECT MANAGER: VINCE MADONIA 217-785-9046

CONTRACT NO. 72C73

STATE OF ILLINOIS
DEPARTMENT OF TRANSPORTATION
DIVISION OF HIGHWAYS

SUBMITTED March 27 2009
Ray Z. Ombler
DEPUTY DIRECTOR OF HIGHWAYS, REGION ENGINEER

May 1 2009
Charles G. Ingersoll
ENGINEER OF DESIGN AND ENVIRONMENT

May 1 2009
Christine M. Reed
DIRECTOR OF HIGHWAYS, CHIEF ENGINEER

**PRINTED BY THE AUTHORITY
OF THE STATE OF ILLINOIS**

GENERAL NOTES:

1. ANY REFERENCE TO THE STANDARDS THROUGHOUT THE PLANS SHALL BE INTERPRETED TO BE THE LATEST STANDARDS OF THE DEPARTMENT AS INCLUDED IN THE PLANS.
2. NO EXCAVATION ANTICIPATED ON THIS PROJECT WHICH WOULD AFFECT UTILITIES. SHOULD ANY EXCAVATION BE REQUIRED, J.U.L.I.E. SHALL BE NOTIFIED A MINIMUM OF 48 HOURS IN ADVANCE - (800) 892-0123.
3. EXISTING RAISED REFLECTIVE PAVEMENT MARKERS SHALL BE REMOVED PRIOR TO RESURFACING.
4. VOIDS RESULTING FROM REMOVAL OF RAISED REFLECTIVE PAVEMENT MARKERS TO BE FILLED WITH AN APPROVED MIX THAT WILL NOT REACT WITH THE SURFACE TREATMENT. COST TO BE INCLUDED WITH COST FOR RAISED REFLECTIVE PAVEMENT MARKER REMOVAL.
5. ALL CONFLICTING EXISTING STRIPING WILL BE REMOVED.
6. ALL PAVEMENT MARKINGS SHALL BE VERIFIED BY RESIDENT/FIELD ENGINEER PRIOR TO THEIR PLACEMENT.
7. EXISTING PAVEMENT DAMAGED DUE TO THE CONTRACTOR'S OPERATIONS, NOT OTHERWISE NECESSARY TO REPLACE, SHALL BE REPLACED AT THE EXPENSE OF THE CONTRACTOR.
8. THE FOLLOWING APPLICATION RATES WERE USED FOR QUANTITY CALCULATIONS:

PRIME COAT (BIT)	0.00038 Ton / Sq. Yd.
BIT. COVER & SEAL COAT	0.00146 Ton / Sq. Yd.
BIT. MIXES	112.0 lb * in / Sq. Yd.
AGGREGATES	2.05 Ton / Cu. Yd

MIXTURE REQUIREMENTS	
Mixture Use(s):	Pavement Patching
PG:	PG 64-22
Design Air Voids:	4.0% @ N Design = 50
Mixture Composition: (Gradation Mixture)	IL 19.0
Friction Aggregate:	N/A

INDEX OF SHEETS:

1. COVER SHEET
2. GENERAL NOTES
3. SUMMARY OF QUANTITIES
4. SCHEDULE OF QUANTITIES
5. TYPICAL SECTIONS

LIST OF STANDARDS:

- 701001-02
- 701006-03
- 701011-02
- 701201-03
- 701301-03
- 701306-02
- 701311-03
- 701901-01
- 780001-02
- 781001-03

DISTRICT SIX	
EXAMINED <u>March 19</u> 20 <u>09</u>	<i>Sam J. Hoast</i>
OPERATIONS ENGINEER	
EXAMINED <u>March 19</u> 20 <u>09</u>	<i>Sam J. Hoast</i>
PROGRAM IMPLEMENTATION ENGINEER	
EXAMINED <u>March 27</u> 20 <u>09</u>	<i>Sam J. Hoast</i>
PROGRAM DEVELOPMENT ENGINEER	

NOTE:
THE FINE AGGREGATE USED WITHIN THE A-1 TREATMENT FOR THE CAPE SEAL SHALL BE CA-16.

HILLVIEW BLACKTOP
100% STATE
CONST CODE F000

Code No.	Item	Unit	Total	
44200140	PAVEMENT PATCHING, ^{TYPE} I, 12 INCH	SQ YD	25	25
48101200	AGGREGATE SHOULDERS, TYPE B	TON	2,998	2,998
* 63100167	TRAFFIC BARRIER TERMINAL, TYPE 1 (SPECIAL) TANGENT	EACH	4	4
63200310	GUARDRAIL REMOVAL	FOOT	200	200
67100100	MOBILIZATION	L SUM	1	1
70100450	TRAFFIC CONTROL AND PROTECTION, STANDARD 701201	L SUM	1	1
70100460	TRAFFIC CONTROL AND PROTECTION, STANDARD 701306	L SUM	1	1
70300100	SHORT-TERM PAVEMENT MARKING	FOOT	3,950	3,950
70301000	WORK ZONE PAVEMENT MARKING REMOVAL	SQ FT	1,646	1,646
* 78001120	PAINT PAVEMENT MARKING - LINE 5"	FOOT	111,263	111,263
* 78100100	RAISED REFLECTIVE PAVEMENT MARKER	EACH	495	495
* 78201000	TERMINAL MARKER - DIRECT APPLIED	EACH	4	4
78300200	RAISED REFLECTIVE PAVEMENT MARKER REMOVAL	EACH	495	495
X0324951	CAPE SEAL	SQ YD	96,560	96,560
X0326217	TEMPORARY RAISED PAVEMENT MARKER	EACH	1,975	1,975

*specialty items

FILE NAME *	USER NAME * laughlin-1	DESIGNED -	REVISED -
en\pwork\PWID001\LAUGHLIN\RL\d0125383\0672C73-shr-500.dgn		DRAWN -	REVISED -
		CHECKED -	REVISED -
		DATE -	REVISED -

**STATE OF ILLINOIS
DEPARTMENT OF TRANSPORTATION**

SUMMARY OF QUANTITIES			
SCALE:	SHEET NO. 3 OF 5 SHEETS	STA. 12+54	TO STA. 41+14

F.A.S. RTE.	SECTION	COUNTY	TOTAL SHEETS	SHEET NO.
743	19RS-6	SCOTT	5	3
CONTRACT NO. 72C73				
ILLINOIS FED. AID PROJECT				

Sta to Sta		Agg Shoulder Type B (TON)	Short Term Pav't mka (FT)	Work Zone Mkg Rem (SQ FT)	Paint Pav't Mkg Line 5" (FT)	RRPM Removal (EACH)	RRPM (EACH)	Temp RPM (EACH)	Cape Seal (SY)
12+54	280+87	2,036	2,683	1,118	73,791	336	336	1,342	65,592
280+87	284+89				1,608				
284+89	306+10	162	212	88	5,833	27	27	106	5,184
306+10	308+66				1,024				
308+66	322+47	104	138	58	3,798	18	18	69	3,376
322+47	414+14	696	917	382	25,209	114	114	458	22,408
TOTAL		2,998	3,950	1,646	111,263	495	495	1,975	96,560

Sandy Creek Bridge Omission: STA 280+87 to STA 284+89
 Little Sandy Creek Bridge Omission: STA 306+10 to STA 308+66

PAVEMENT PATCHING		
Sta to Sta		(SY)
12+54	414+14	25.0
TOTAL		25

GUARDRAIL REMOVAL		
Sta to Sta		(FT)
306+10	308+66	200.0
TOTAL		200

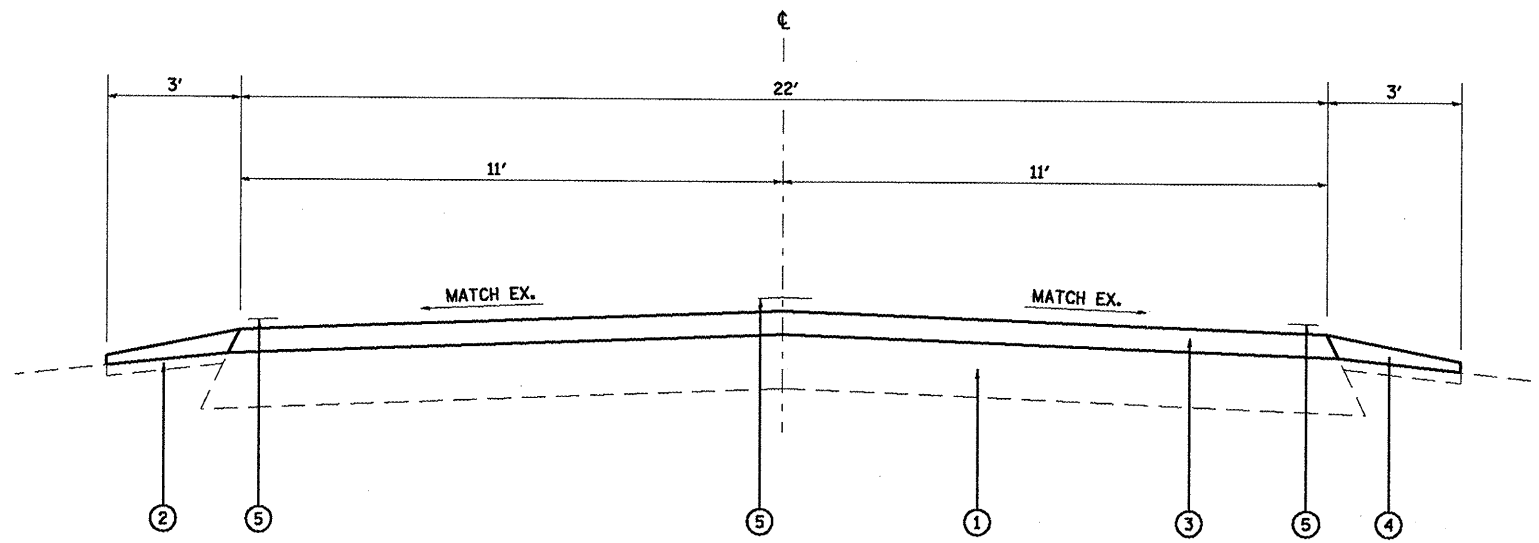

- ① EX PVMT (TYPE AND THICKNESS VARIES)
- ② EX AGG SHOULDERS (WIDTH AND THICKNESS VARIES)
- ③ PROPOSED CAPE SEAL
- ④ PROPOSED AGG. SHOULDERS, TYPE B
- ⑤ PROPOSED PAINT PVMT MARKING LINE, 5"

STA 12+54 TO STA 414+14
 BRIDGE OMISSION
 STA 280+87 TO STA 284+89
 STA 306+10 TO STA 308+66

FILE NAME =	USER NAME = laughlin	DESIGNED -	REVISED -	STATE OF ILLINOIS DEPARTMENT OF TRANSPORTATION	TYPICAL SECTIONS				F.A.S. RTE.	SECTION	COUNTY	TOTAL SHEETS	SHEET NO.
o:\pwork\pwork\DOT\LAUGHLIN\1225383\0672C73-ah-typicel.dgn		DRAWN -	REVISED -		743	19RS-6	SCOTT	5	5				
PLOT SCALE = 1/80.0000' / IN.		CHECKED -	REVISED -		CONTRACT NO. 72C73								
PLOT DATE = Apr-02-2009 12:33:00PM		DATE -	REVISED -		ILLINOIS FED. AID PROJECT								
				SCALE:	SHEET NO. 5 OF 5 SHEETS	STA. 12+54	TO STA. 414+14						