

**PROPOSED ENTRANCE WORK**  
(TYPICAL, 3'-0" WIDTH):

- \* HOT-MIX ASPHALT SURFACE REMOVAL - BUTT JOINT
- \* INCIDENTAL HOT-MIX ASPHALT SURFACING

**PROPOSED SIDEROAD WORK:**

- \* HOT-MIX ASPHALT SURFACE REMOVAL - BUTT JOINT
- \* INCIDENTAL HOT-MIX ASPHALT SURFACING

**PROPOSED PAVEMENT RESURFACING:**

- \* HOT-MIX ASPHALT SURFACE REMOVAL - 2 1/4"
- \* POLYMERIZED HOT-MIX ASPHALT SURFACE COURSE, MIX E, N90, 2"

SOUTH LIVINGSTON STREET

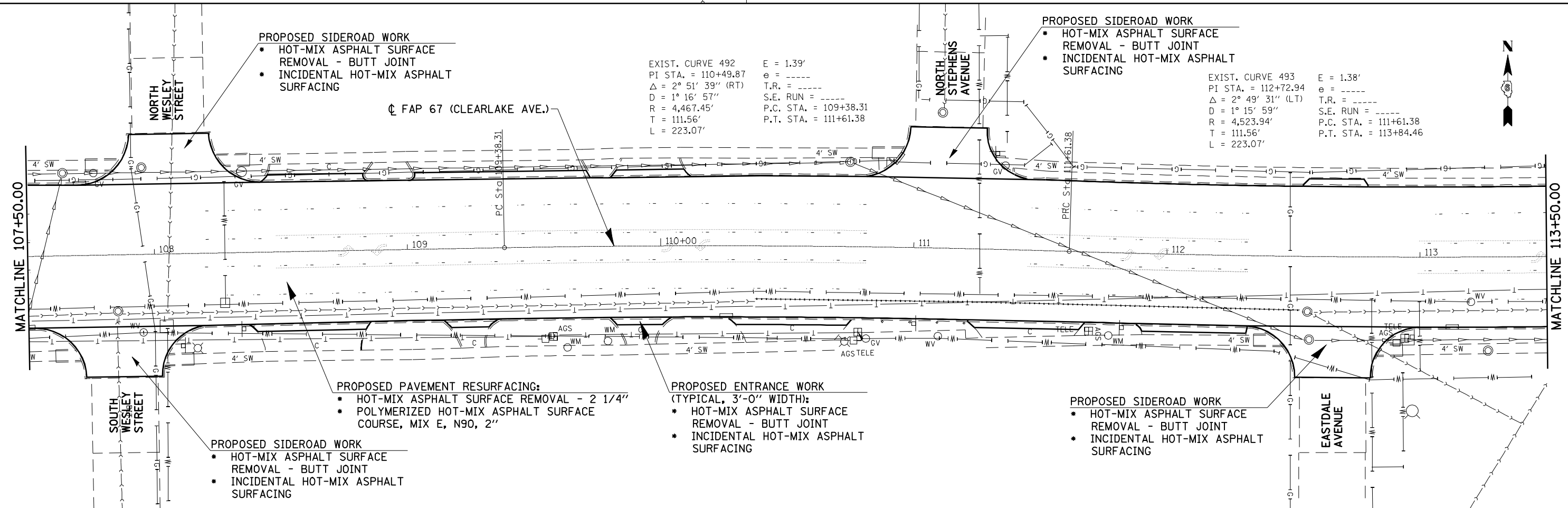

**PROPOSED SIDEROAD WORK**

- \* HOT-MIX ASPHALT SURFACE REMOVAL - BUTT JOINT
- \* INCIDENTAL HOT-MIX ASPHALT SURFACING

EXIST. CURVE 492  
 PI STA. = 110+49.87  
 $\Delta = 2^\circ 51' 39''$  (RT)  
 $D = 1^\circ 16' 57''$   
 $R = 4,467.45'$   
 $T = 111.56'$   
 $L = 223.07'$

$E = 1.39'$   
 $e = \text{-----}$   
 $T.R. = \text{-----}$   
 $S.E. RUN = \text{-----}$   
 $P.C. STA. = 109+38.31$   
 $P.T. STA. = 111+61.38$

**PROPOSED SIDEROAD WORK**

- \* HOT-MIX ASPHALT SURFACE REMOVAL - BUTT JOINT
- \* INCIDENTAL HOT-MIX ASPHALT SURFACING

EXIST. CURVE 493  
 PI STA. = 112+72.94  
 $\Delta = 2^\circ 49' 31''$  (LT)  
 $D = 1^\circ 15' 59''$   
 $R = 4,523.94'$   
 $T = 111.56'$   
 $L = 223.07'$

$E = 1.38'$   
 $e = \text{-----}$   
 $T.R. = \text{-----}$   
 $S.E. RUN = \text{-----}$   
 $P.C. STA. = 111+61.38$   
 $P.T. STA. = 113+84.46$

**PROPOSED PAVEMENT RESURFACING:**

- \* HOT-MIX ASPHALT SURFACE REMOVAL - 2 1/4"
- \* POLYMERIZED HOT-MIX ASPHALT SURFACE COURSE, MIX E, N90, 2"

**PROPOSED ENTRANCE WORK**  
(TYPICAL, 3'-0" WIDTH):

- \* HOT-MIX ASPHALT SURFACE REMOVAL - BUTT JOINT
- \* INCIDENTAL HOT-MIX ASPHALT SURFACING

**PROPOSED SIDEROAD WORK**

- \* HOT-MIX ASPHALT SURFACE REMOVAL - BUTT JOINT
- \* INCIDENTAL HOT-MIX ASPHALT SURFACING

**PROPOSED SIDEROAD WORK**

- \* HOT-MIX ASPHALT SURFACE REMOVAL - BUTT JOINT
- \* INCIDENTAL HOT-MIX ASPHALT SURFACING

FILE NAME =	USER NAME = laughlinr1	DESIGNED - RTS	REVISED -	<b>STATE OF ILLINOIS DEPARTMENT OF TRANSPORTATION</b>	<b>PLAN SHEET</b>			F.A.P. RTE. 67	SECTION (107ZRS-8, (B-19)RS-4	COUNTY SANGAMON	TOTAL SHEETS 28	SHEET NO. 17
es:\pwwork\PWIDOT\LAUGHLINRL\dms21748\1072C98-shr-plan.dgn	PLOT SCALE = 40.0000' / IN.	DRAWN - RTS	REVISED -		SCALE: 20	SHEET NO. 4 OF 5 SHEETS	STA. 101+50.0 TO STA. 113+50.0	CONTRACT NO. 72C98				
PLOT DATE = Apr-10-2009 01:45:44PM	DATE - 04-09-09	CHECKED - MEB	REVISED - RTS 04-10-2009		FED. ROAD DIST. NO. ILLINOIS FED. AID PROJECT							
		DATE - 04-09-09	REVISED -									