

LEGEND

- ① THERMOPLASTIC PAVEMENT MARKING - LINE 5" (30' SKIP-10' DASHED) WHITE
- ② THERMOPLASTIC PAVEMENT MARKING - LINE 5" SOLID WHITE
- ③ THERMOPLASTIC PAVEMENT MARKING - LINE 5" SOLID YELLOW
- ④ THERMOPLASTIC PAVEMENT MARKING - LINE 5" SKIP-DASHED YELLOW
- ⑤ THERMOPLASTIC PAVEMENT MARKING - LINE 6" WHITE
- ⑥ PREFORMED PLASTIC PAVEMENT MARKING, TYPE B - INLAID - LINE 6" WHITE
- ⑦ PREFORMED PLASTIC PAVEMENT MARKING, TYPE B - INLAID - LINE 24" WHITE
- ⑧ PREFORMED PLASTIC PAVEMENT MARKING, TYPE B - INLAID - LETTERS AND SYMBOLS
- ◁ RAISED REFLECTIVE PAVEMENT MARKER (ONE-WAY CRYSTAL)
- ◄ RAISED REFLECTIVE PAVEMENT MARKER (ONE-WAY AMBER)
- ◆ RAISED REFLECTIVE PAVEMENT MARKER (TWO-WAY AMBER)

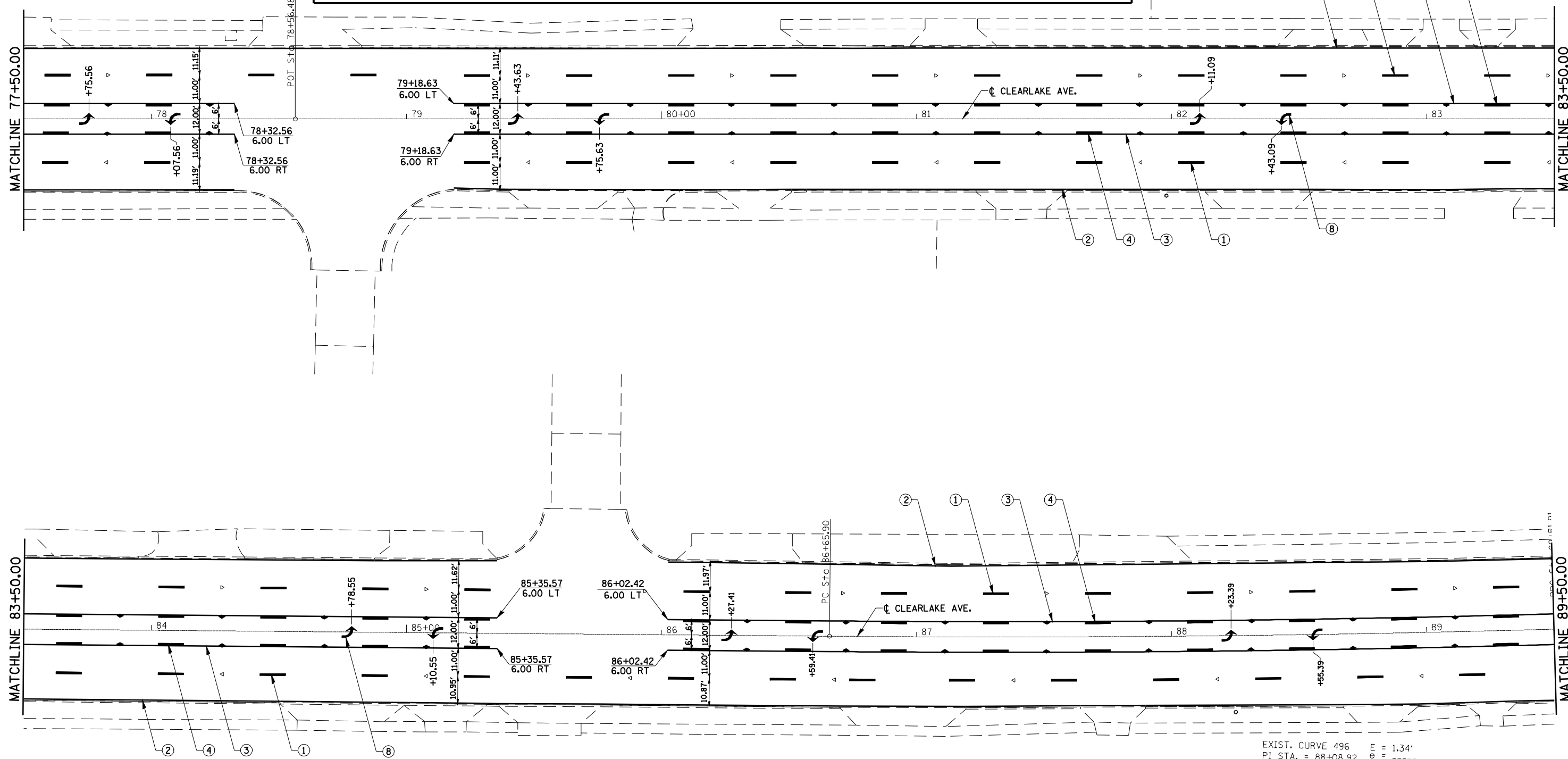

EXIST. CURVE 496
 PI STA. = 88+08.92
 $\Delta = 2^\circ 08' 40''$ (LT)
 $D = 0^\circ 44' 59''$
 $R = 7,641.25'$
 $T = 143.02'$
 $L = 286.01'$
 $E = 1.34'$
 $\theta = \text{-----}$
 $T.R. = \text{-----}$
 $S.E. \text{ RUN} = \text{-----}$
 $P.C. \text{ STA.} = 86+65.90$
 $P.T. \text{ STA.} = 89+51.91$

FILE NAME =	USER NAME = laughlinr1	DESIGNED - RTS	REVISED -
es:\pwork\PWIDOT\LAUGHLINRL\dms21748\10672C98-sh-t-pmk.dgn		DRAWN - RTS	REVISED -
PLOT SCALE = 48.0000' / IN.		CHECKED - RTS	REVISED -
PLOT DATE = Apr-10-2009 01:45:54PM		DATE - 04-05-09	REVISED -

**STATE OF ILLINOIS
DEPARTMENT OF TRANSPORTATION**

PAVEMENT MARKING LAYOUT
 SCALE: SHEET NO. 2 OF 5 SHEETS STA. 67+50 TO STA. 89+50

F.A.P. RTE.	SECTION	COUNTY	TOTAL SHEETS	SHEET NO.
67	(107)RS-8, (B-19)RS-4	SANGAMON	28	20
CONTRACT NO. 72C98				
ILLINOIS FED. AID PROJECT				