

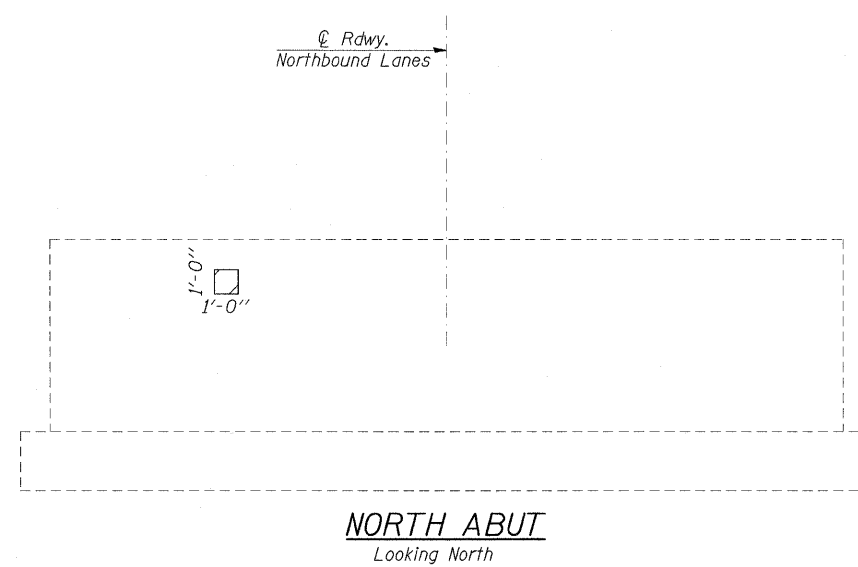

Structural Repair of Concrete $\leq 5''$

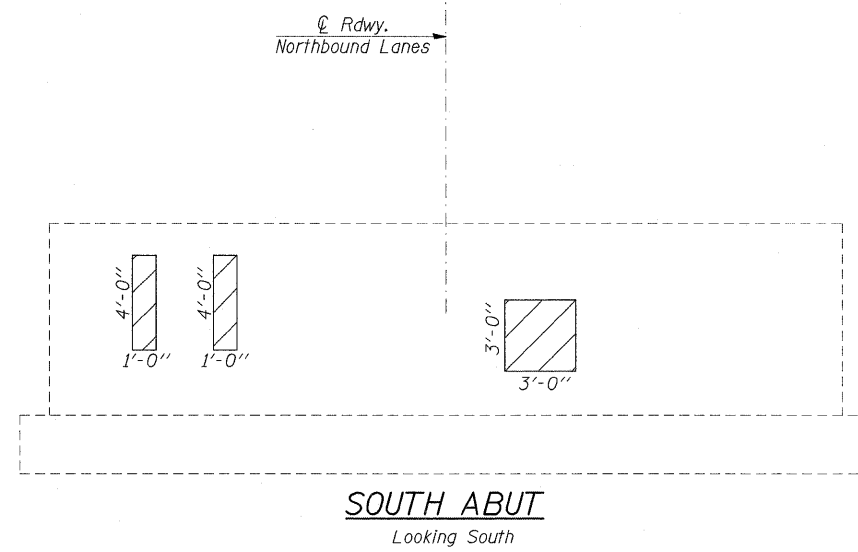

SUBSTRUCTURE REPAIRS
NORTH AND SOUTH ABUTMENTS
ALEXANDER COUNTY
002-0023 & 002-0024

FILE NAME =	USER NAME = halsteadw	DESIGNED -	REVISED -	STATE OF ILLINOIS DEPARTMENT OF TRANSPORTATION	SUBSTRUCTURE REPAIRS SN 002-0023 & 002-0024	F.A.I RTE.	SECTION	COUNTY	TOTAL SHEETS	SHEET NO.	
ca\pwwork\PWIDOT\HALSTEADW\d0113592\002-0023.dgn		DRAWN -	REVISED -			57	D9 BSMART FY09-2	ALEXANDER	45	31	
PLOT SCALE = 4.0000 "/> IN.		CHECKED -	REVISED -			CONTRACT NO. 78111					
PLOT DATE = 4/3/2009		DATE -	REVISED -			SCALE:	SHEET NO.	OF	SHEETS	STA.	TO STA.